





LEGEND

-  Integral Bat Roost Unit i.e. Pro UK Build-in Woodstone Bat Box - installed at high level to gable ends (1 per dwelling)
-  Barn/ Little Owl Nest Feature (built in accordance with details submitted in Protected Species Survey dated Feb 22)
-  Downlighter
-  Wall mounted light

Mitigating Impacts of External Lighting
 External lighting will be minimal and limited to low lux level lighting fixtures with no upwards luminance, in accordance with the guidance issued by the Bat Conservation Trust and Institute of Lighting Professionals.

It is proposed to illuminate the approach of each dwelling with a down-lighter installed into the soffit over the covered entrance. No external lighting is proposed on the North-West and South-East Elevations as these aspect include the proposed Bat Roosts. The rear gardens are to be illuminated with wall mounted down-lighting fixtures, with an upward lighting ratio of zero to avoid light spill.

Light Sources
 The use of LED lamps in the lighting fixtures will minimise UV emissions as well as improve overall efficiency. The choice of 'warm white' lamps with a colour temperature circa 2700K will also limit the amount of blue light, as recommended in the Protected Species Survey.

Reduced Operation
 Installing all lights on switches so they can be turned permanently off during night time hours (e.g midnight to 6am). The use of motion sensors will also be avoided to prevent unnecessary illumination during the night.

Barn/ Little Owl Nest Feature to be installed, immediately upon approval, circa 2.5m above ground to South East Gable of retained Farm Building (away from prevailing wind).

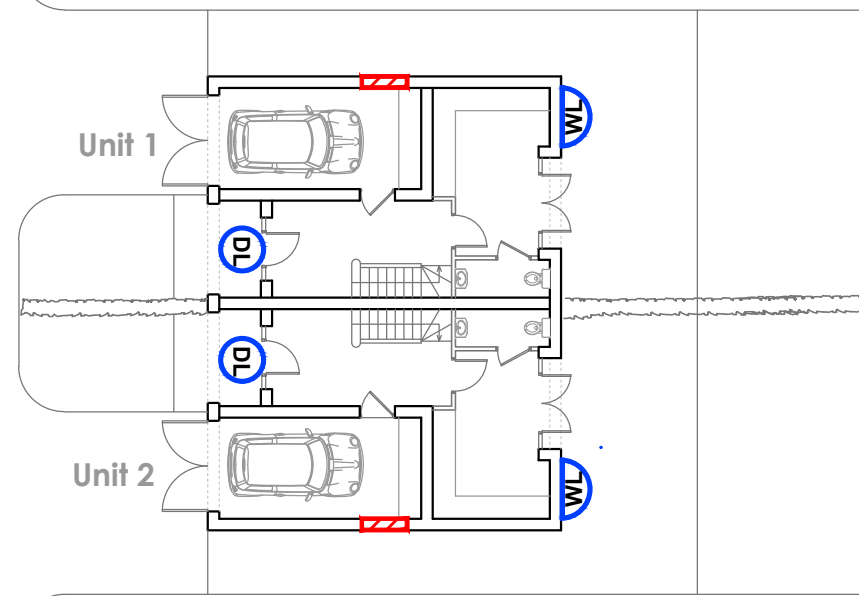
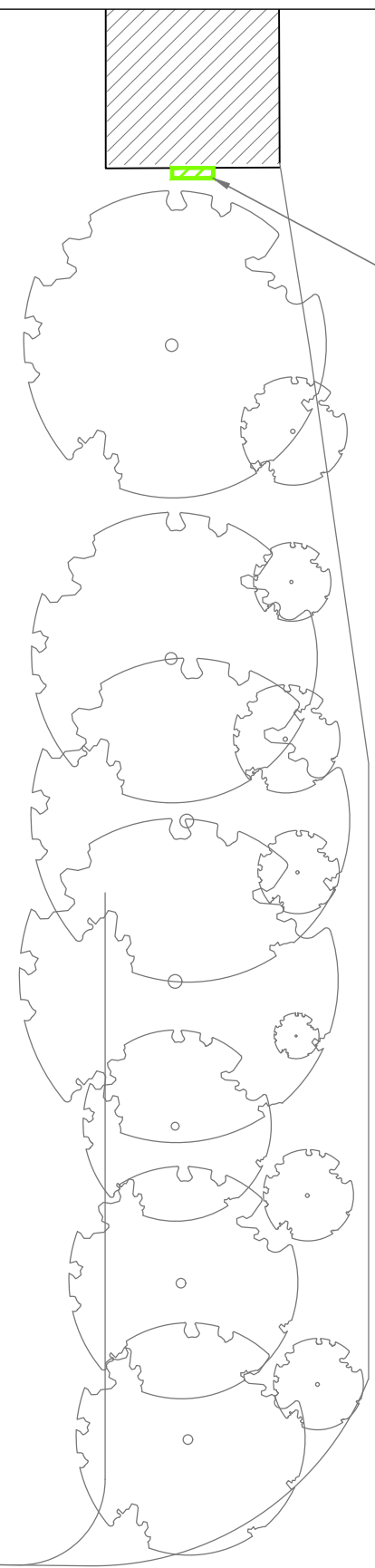

New Road

guyforman
 ARCHITECT & PLANNERS

The Old Mill - Chapel Hill - Lincolnshire - LN4 4QB
 guy@guyformanarchitects.com
 Office: 01526 268181

Scottish 58, Blankney Fen
 Demolition of Blockwork Barns & Erection of 2 x New Dwellings

Proposed Site Plan: Bat Roosts & Low Impact Lighting Scheme

Do not scale off this drawing - All dimensions and setting out to be verified on site. If in doubt contact the originator for clarification. The contents of this drawing are covered by copyright and remain the property of Guy Forman Architect. The drawing is issued on the condition that it is not copied, reproduced, retained or disclosed to any unauthorised person, either wholly or in part without the consent in writing of Guy Forman Architect.

Rev	Description	Date	By	Chk
For Condition Discharge				
Scale:	Date:	Drawn:	Checked:	
1:200 @ A3	05/02/24	DW	GF	
Drawing No.:				Rev:
490-CD-01				-