

EXISTING

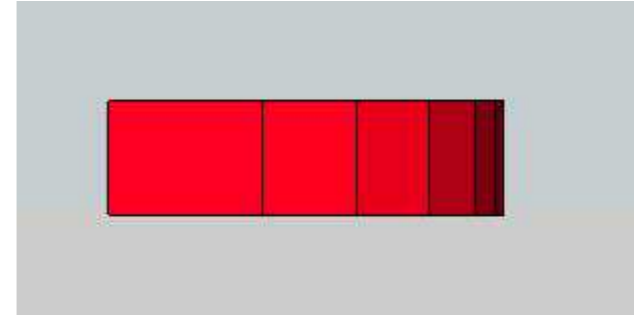

BUILDING TO BE REMOVED 07 FRONT ELEVATION



BUILDING TO BE REMOVED 07 SIDE ELEVATION

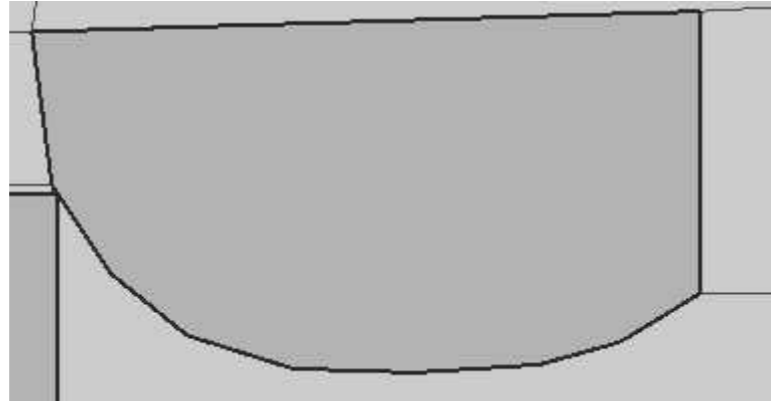

BUILDING TO BE REMOVED 07 OUTLINE OF FLOORPLAN

GROUND FLOOR OUTLINE, FRONT & SIDE OUTLINE ELEVATIONS OF BUILDING 07 WHICH IS TO BE REMOVED

SCALE BAR 1:100

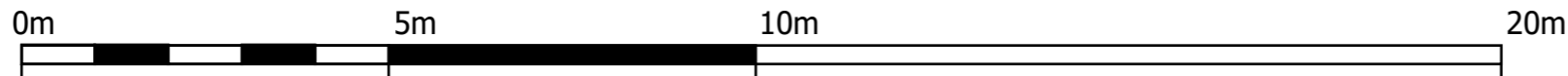

REVISION	DATE	FEB 24	D
TO LPA REQUIREMENTS			
REVISION	DATE	JAN 24	C
TO LPA REQUIREMENTS			
REVISION	DATE	NOV 23	B
TO LPA REQUIREMENTS			
REVISION	DATE	AUG 23	A
TO LPA REQUIREMENTS			
			DRAWN BY
			SH

CLIENT
Ms Jessica Mills

PROJECT ADDRESS
115b TILE KILN LANE, BEXLEY



2-4c Jubilee House, 3 The Drive, Brentwood, Essex, CM13 3FR
 Tel: 01277 725252
 Email: info@2-4c.co.uk
 Web: http://2-4c.co.uk

IF THIS LINE ABOVE MEASURES 100mm THE DRAWING IS SCALED AS SHOWN
 DO NOT SCALE FROM THIS DRAWING. ALL DIMENSIONS & LEVELS TO BE CHECKED ON SITE PRIOR TO THE COMMENCEMENT OF ANY WORK. CHECK THAT THIS DRAWINGS IS THE LATEST REVISION. REFER ANY DISCREPANCY TO 2-4C. IF IN DOUPT ASK.
 ALL DIMENSIONS ARE IN MILLIMETRES. THIS DRAWING IS COPYRIGHT

PROJECT DESCRIPTION
 PROPOSED HOUSING DEVELOPMENT
 ELEVATIONS OF BUILDINGS REMOVED

SCALE	JOB NO.
1:100@A3	23-638
DATE	DWG.NO. REV.NO.
Feb, 24	P 21 D