

NOTES

- all boundary treatment to remain as existing
- all new materials to match existing
- any new shrub and hedge planting to be agreed with the LPA
- new hard surface materials to be agreed with the LPA
- all surface water and foul water drainage as existing
- existing car park to St John's Church

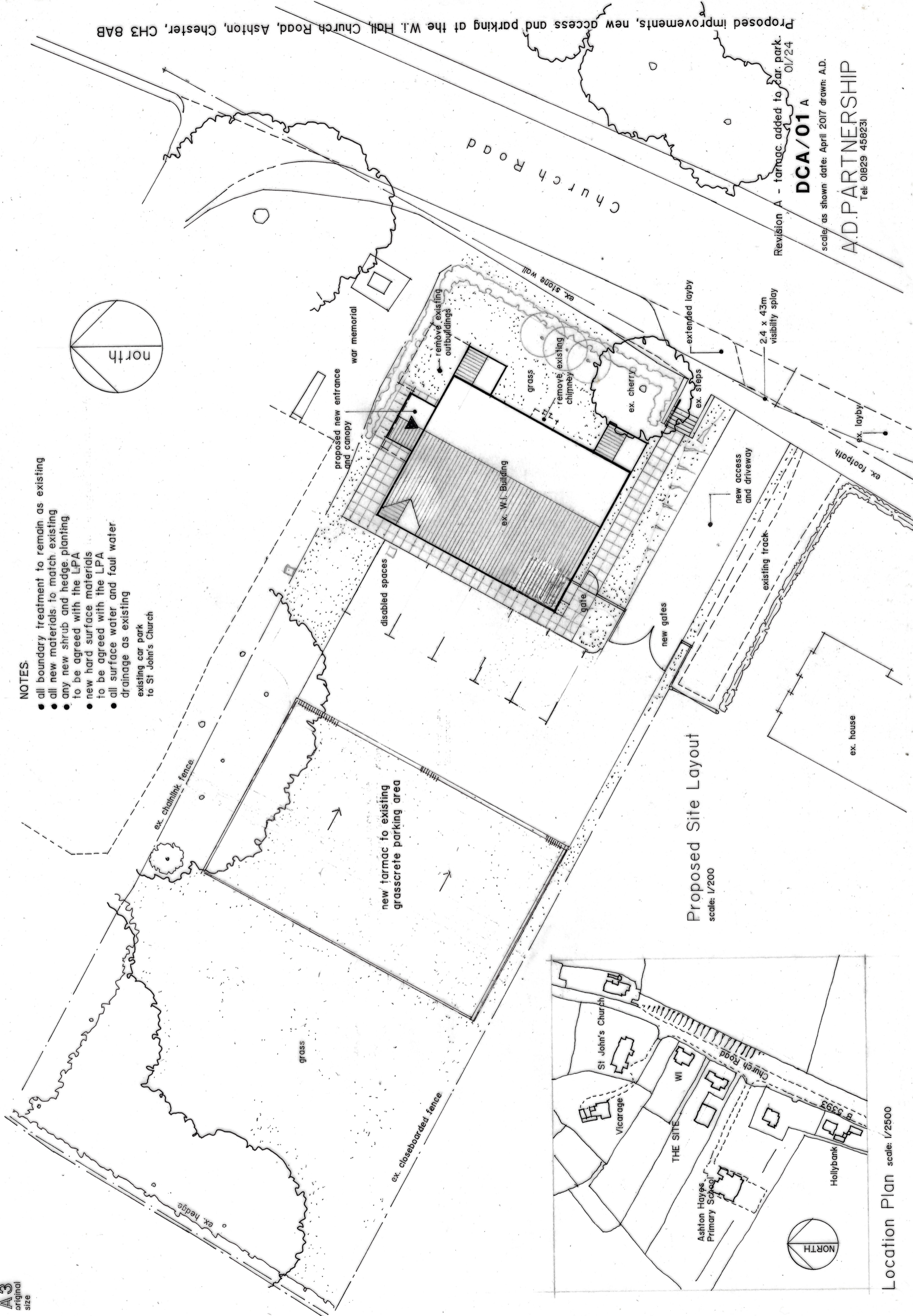

Proposed Site Layout  
scale: 1/200

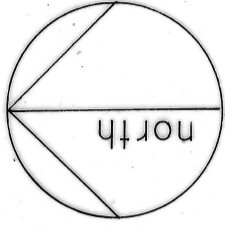
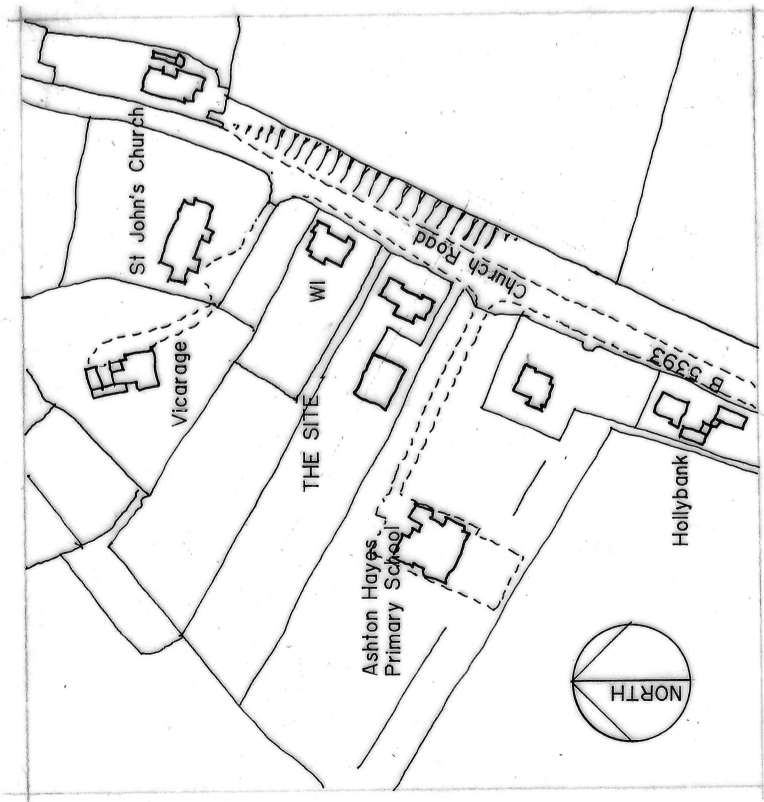

Location Plan scale: 1/2500

Proposed improvements, new access and parking at the W.I. Hall, Church Road, Ashton, Chester, CH3 8AB

Revision A - tarmac added to car park. 01/24

DCA/01 A

scale: as shown date: April 2017 drawn: A.D.

A.D. PARTNERSHIP  
Tel: 01829 458231