

- SITE CLEARANCE KEY**
- EXTENT OF S278 WORKS
 - EXTENT OF PRIVATE WORKS EXCLUDED FROM THIS APPLICATION
 - EXTENT OF EXISTING FOOTWAY TO REMAIN
 - EXISTING VEHICULAR CROSSOVER TO BE REUSED. SURFACE COURSE AND BEDDING COURSE TO BE PLANNED BACK TO A DEPTH OF 65mm READY FOR NEW SURFACE AND BINDER COURSE
 - EXISTING FOOTWAY TO BE CAREFULLY BROKEN OUT TO A DEPTH OF 213mm. SLABS TO BE SET ASIDE FOR REUSE WHERE POSSIBLE.
 - EXISTING FOOTWAY TO BE CAREFULLY BROKEN OUT TO A DEPTH OF 88mm. SLABS TO BE SET ASIDE FOR REUSE WHERE POSSIBLE.
 - VERGE TO BE EXCAVATED TO A DEPTH OF 415mm TO ALLOW FOR NEW VEHICULAR CROSSOVER CONSTRUCTION.
 - VERGE TO BE CAREFULLY REGRADED TO SUIT NEW FOOTWAY AND CROSSOVER LEVELS. CARE TO BE TAKEN WHEN EXCAVATING AROUND EXISTING TREE AND LAMP POST.
 - EXISTING KERB TO BE REMOVED
 - EXISTING GRANITE SETTS TO BE CAREFULLY REMOVED AND SET ASIDE FOR REUSE
 - EXISTING KERB TO REMAIN
 - CROSSOVER TO BE TIED INTO EXISTING CARRIAGEWAY WITH 150mm STEP JOINTS WITHIN FLEXIBLE BITUMINOUS LAYER

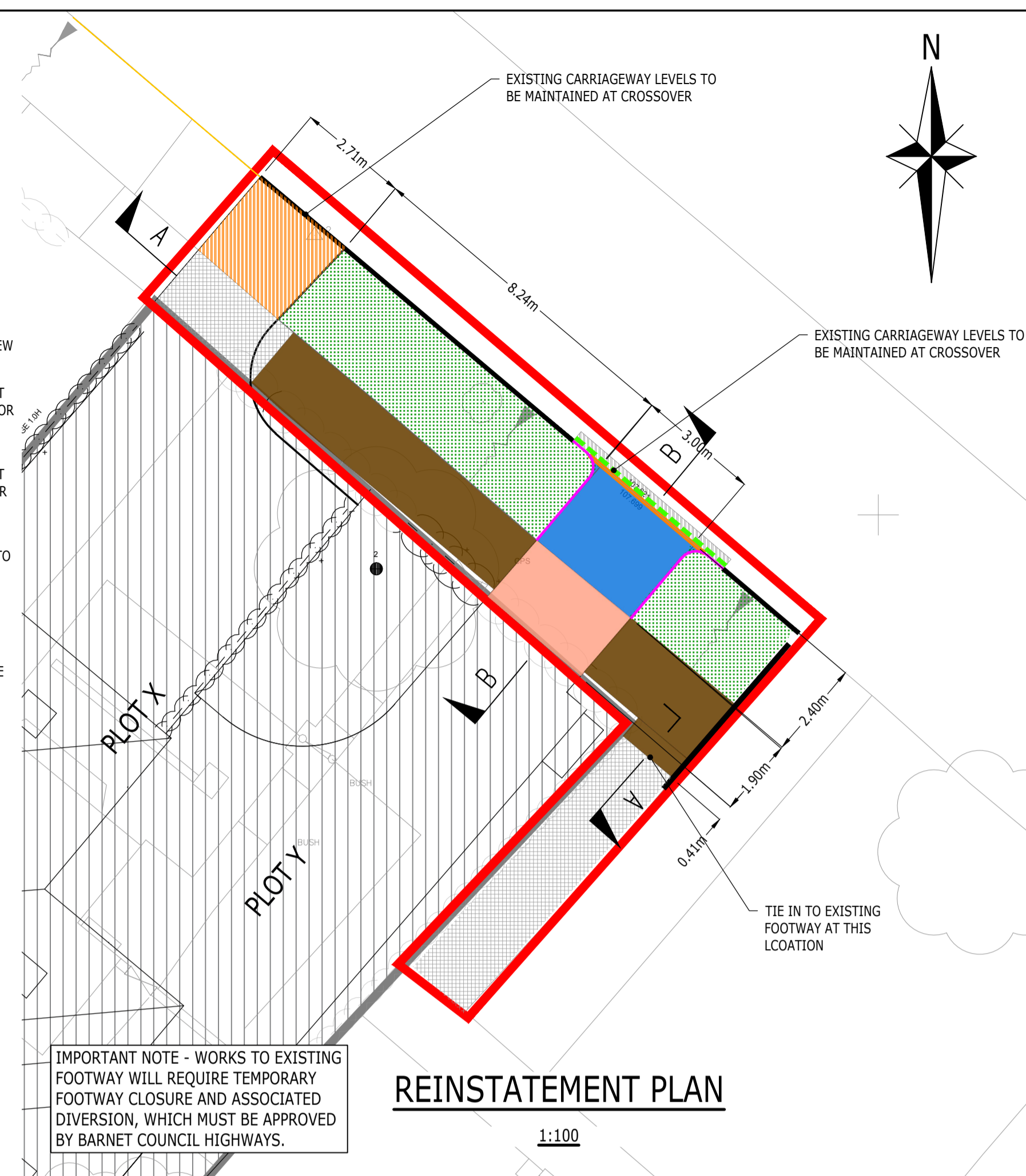

- REINSTATEMENT KEY**
- EXTENT OF S278 WORKS
 - EXTENT OF PRIVATE WORKS EXCLUDED FROM THIS APPLICATION
 - EXTENT OF EXISTING FOOTWAY TO REMAIN
 - VEHICULAR CROSSOVER SUB-BASE TO BE REUSED, BUT RE-SURFACED. 25mm AC6 DENSE SURFACE COURSE TO BS EN 13108 40mm THICK AC14 CLOSE GRADED BINDER COURSE 100/150 TO BS EN 13108 ON TOP OF EXISTING CONSTRUCTION. LEVELS TO MATCH EXISTING
 - 750 x 600 x 63mm ASP PAVING SLABS TO BE REUSED WHERE IN GOOD CONDITION. 25mm THICK LIME MORTAR BEDDING. 125mm THICK AC20 DENSE BASE COURSE TO BS EN 13108
 - MINIMUM OF 175mm THICK GRANULAR SUB BASE TYPE 1 TO CLAUSE 803 DOT SPEC. THICKNESS OF TYPE 1 VARIES AS REQUIRED.
 - 750 x 600 x 63mm ASP PAVING SLABS TO BE REUSED WHERE IN GOOD CONDITION. 25mm THICK LIME MORTAR BEDDING. 175mm THICK AC20 DENSE BASE COURSE TO BS EN 13108
 - MINIMUM OF 175mm THICK GRANULAR SUB BASE TYPE 1 TO CLAUSE 803 DOT SPEC. THICKNESS OF TYPE 1 VARIES AS REQUIRED.
 - FLEXIBLE CARRIAGEWAY CONSTRUCTION 25mm THICK AC6 DENSE SURFACE COURSE TO BS EN 13108 40mm THICK AC14 CLOSE GRADED BINDER COURSE 100/150 TO BS EN 13108 175mm THICK AC20 DENSE BASE COURSE TO BS EN 13108 175mm THICK GRANULAR SUB BASE TYPE 1 TO CLAUSE 803 DOT SPEC
 - VERGE TO BE CAREFULLY REGRADED TO SUIT NEW FOOTWAY AND CROSSOVER LEVELS. TO BE SEEDED WITH SUITABLE GRASS MIX
 - PCC KERB SUNK TO PROJECT 25mm ABOVE CARRIAGEWAY CHANNEL LEVEL FOR FULL WIDTH OF CROSSING. FOR DETAILS REFER TO DRAWING XXX
 - 2 No. ROWS OF GRANITE SETTS TO BE RECOVERED AND REUSED AS DEMARCATION OF PUBLIC BOUNDARY
 - PCC 50mm x 150mm EDGING KERB
 - EXISTING KERB TO REMAIN
 - CROSSOVER TO BE TIED INTO EXISTING CARRIAGEWAY WITH 150mm STEP JOINTS WITHIN FLEXIBLE BITUMINOUS LAYER

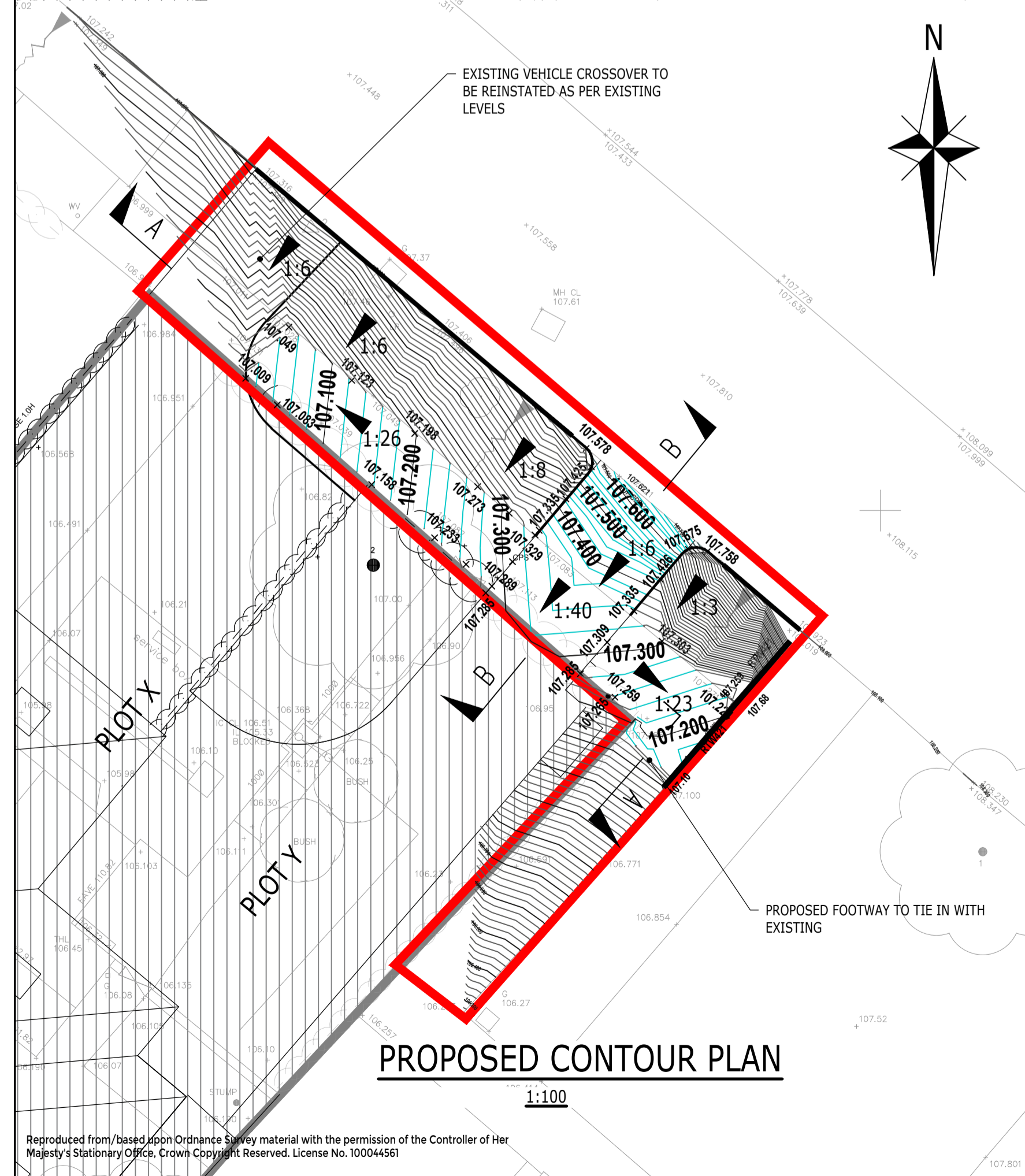

- PROPOSED CONTOURS AND LEVELS KEY**
- EXTENT OF S278 WORKS
 - EXTENT OF PRIVATE WORKS EXCLUDED FROM THIS APPLICATION
 - MAJOR CONTOUR LINES 0.100m INTERVALS
 - MINOR CONTOUR LINES 0.020m INTERVALS
 - PROPOSED LEVELS
 - DIRECTION OF FALL

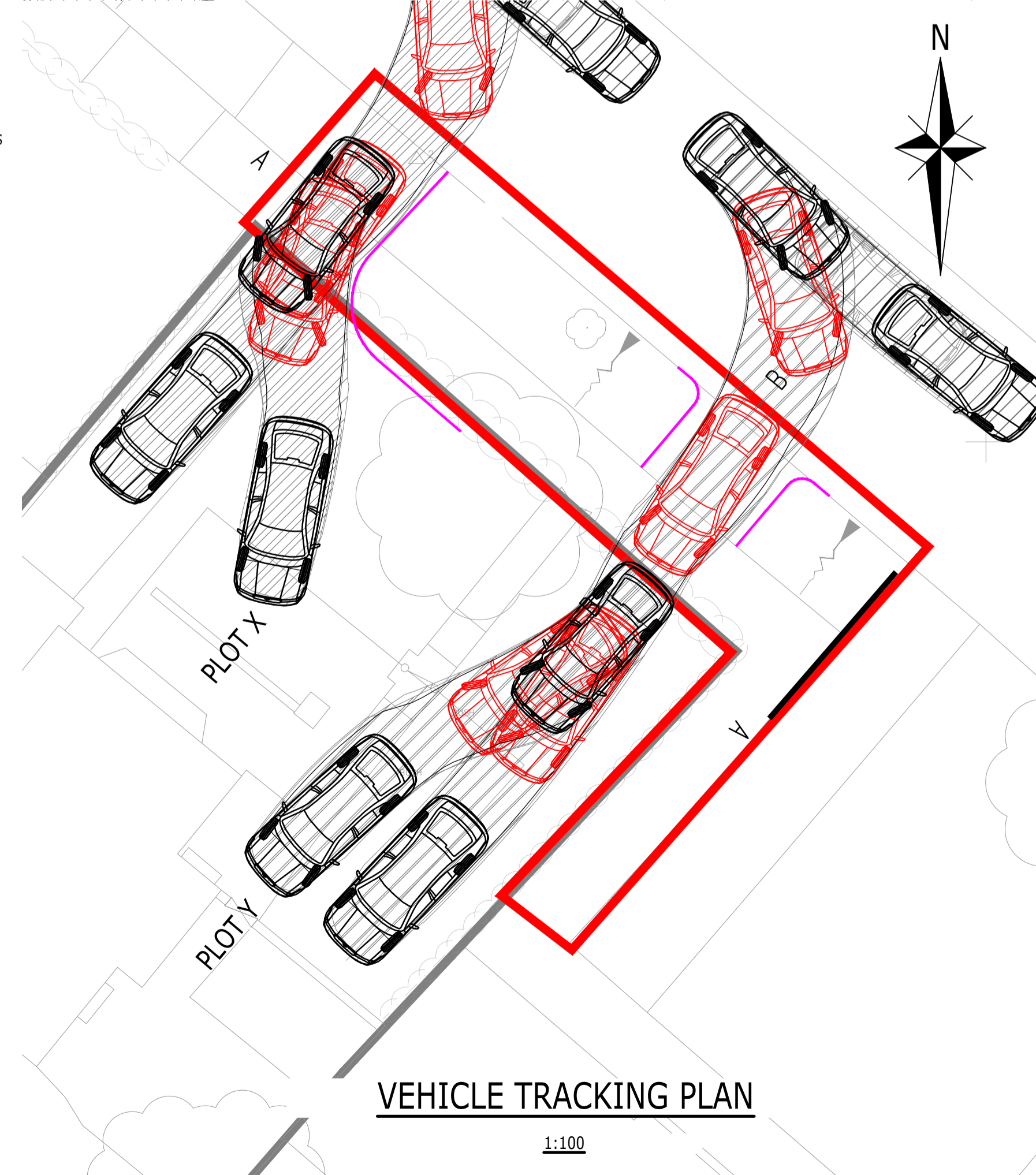

- VEHICLES USED:**
- | | |
|-----------------------------|--------|
| Car | 4.572m |
| Overall Length | 1.769m |
| Overall Body Height | 1.488m |
| Min Body Ground Clearance | 0.249m |
| Max Track Width | 1.713m |
| Lock to lock time | 4.00s |
| Kerb to kerb Turning Radius | 5.100m |

IMPORTANT NOTE - WORKS TO EXISTING FOOTWAY WILL REQUIRE TEMPORARY FOOTWAY CLOSURE AND ASSOCIATED DIVERSION, WHICH MUST BE APPROVED BY BARNET COUNCIL HIGHWAYS.

SECTIONS A-A AND B-B SHOWN ON CONSTRUCTION DETAILS DRAWING 2307801-D010

1. THIS DRAWING IS TO BE READ IN CONJUNCTION WITH ALL OTHER DRAWINGS ISSUED BY THE DESIGN TEAM, PLUS ANY ASSOCIATED SPECIFICATIONS, (SEE CDM NOTES) AND ALL OTHER RELATED DRAWINGS ISSUED BY THE ENGINEER.

2. DO NOT SCALE FROM THIS DRAWING. WORK FROM FIGURED DIMENSIONS ONLY.

3. ALL DIMENSIONS SHOWN ON THIS DRAWING ARE IN METRES, UNLESS OTHERWISE STATED.

4. ALL DIMENSIONS, LEVELS AND SURVEY GRID CO-ORDINATES ARE TO BE CHECKED ON SITE AND THE ENGINEER NOTIFIED IMMEDIATELY OF ANY DISCREPANCIES PRIOR TO THE COMMENCEMENT OF THE WORKS.

5. NO DEVIATION FROM THE DETAILS SHOWN ON THIS DRAWING IS PERMITTED WITHOUT PRIOR PERMISSION FROM THE ENGINEER.

6. THIS DRAWING HAS BEEN BASED UPON TOPOGRAPHICAL SURVEY BY TERRAIN SURVEYS. DRAWING No. TS24-049-1 DATED JANUARY 2024.

7. ALL MATERIALS AND WORKMANSHIP SHALL COMPLY FULLY WITH THE MANUAL OF CONTRACT DOCUMENTS FOR HIGHWAY WORKS, VOLUME ONE, SPECIFICATION FOR HIGHWAY WORKS, AND, BARNET BOROUGH COUNCIL'S REQUIREMENTS AND SPECIFICATIONS.

8. THE CONTRACTOR SHALL UNDERTAKE SUCH MATERIALS TESTING AS INDICATED IN THE SPECIFICATIONS AND SHALL INCLUDE THE COST OF TESTING IN THE TENDER.

9. UNLESS STATED OTHERWISE, ALL EXCAVATED MATERIAL SHALL BE DISPOSED OF AT AN APPROVED TIP OFF-SITE.

10. THE PUBLIC HIGHWAY AND WORKS WILL BE KEPT CLEAN AND FREE OF DEBRIS BY USE OF WHEEL WASHING FACILITIES AND ROAD SWEEPERS TO THE COUNCIL'S SATISFACTION.

11. ALL SETTING OUT SHALL BE AGREED ON-SITE WITH THE HIGHWAYS INSPECTOR, PRIOR TO THE COMMENCEMENT OF THE WORKS.

12. UPON COMPLETION OF THE WORKS, THE CONTRACTOR SHALL UNDERTAKE ALL NECESSARY MAINTENANCE REPAIRS TO RETURN THE HIGHWAY TO ITS FORMER CONDITION.

13. THE CONTRACTOR SHALL BE RESPONSIBLE FOR OBTAINING ALL NECESSARY APPROVALS FROM THE LOCAL AUTHORITY PRIOR TO COMMENCING WORKS ON THE HIGHWAY.

TRAFFIC MANAGEMENT (INCLUDING TEMPORARY DIVERSION MEASURES OF EXISTING FOOTPATH)

1. THE CONTRACTOR IS RESPONSIBLE FOR ESTABLISHING AND MAINTAINING A SATISFACTORY TRAFFIC MANAGEMENT SYSTEM FOR THE DURATION OF THE WORKS TO THE SATISFACTION OF THE HIGHWAYS INSPECTOR.

CDM NOTES:

THE ATTENTION OF THE CLIENT, PRINCIPAL DESIGNER, PRINCIPAL CONTRACTOR, DESIGNERS AND CONTRACTORS IS DRAWN TO THE FOLLOWING POTENTIAL RISKS IN CONJUNCTION WITH THE PROPOSED ON-SITE AND OFF-SITE WORKS AS DESIGNED FOR THIS PROJECT:

1. WORKS IN THE VICINITY OF LIVE SERVICES INCLUDING GAS, ELECTRICITY AND BT WILL BE NECESSARY AND THE ADVICE OF ALL STATUTORY SERVICE COMPANIES MUST BE SOUGHT BEFORE ANY WORKS COMMENCE.

2. WORKS WITHIN AND ABUTTING THE EXISTING HIGHWAY WILL ENTAIL TRAFFIC HAZARDS AND ALL APPROPRIATE SAFETY MEASURES INCLUDING BARRIERS, SIGNS AND LIGHTING MUST BE UNDERTAKEN TO THE APPROVAL OF THE LOCAL AUTHORITY, THE HIGHWAY AUTHORITY AND THE POLICE DEPARTMENT.

3. HAZARDOUS MATERIALS INCLUDING CEMENT AND BITUMINOUS MATERIALS ARE SPECIFIED AND THE MANUFACTURERS ADVICE ON SAFE HANDLING PROCEDURES MUST BE OBTAINED AND MADE CLEAR TO ALL OPERATIVES.

4. THE CONTRACTOR WILL BE RESPONSIBLE FOR LOCATING ALL EXISTING SERVICES WITHIN THE VICINITY OF THE WORKS HAND DUG AND ENSURE THESE ARE PROTECTED THROUGHOUT THE DURATION OF THE WORKS. ALL UTILITY PLANT SHOULD BE CLEARLY MARKED ON THE GROUND PRIOR TO COMMENCEMENT OF THE WORKS.

5. THE CONTRACTOR MUST ENSURE ALL WORKING AREAS ARE FULLY SECURE.

6. REFER TO DESIGNER'S RISK REGISTER DOC NO. 193845-01.

FOR APPROVAL

THIS DRAWING MUST BE PRINTED IN COLOUR

PI	FIRST ISSUE	MC	MC	SDB	14.02.24
Rev	Description	Drn	Chk	App	Date

ARDENT CONSULTING ENGINEERS

Third Floor
The Hallmark Building
52-56 Leadenhall Street
London
EC3M 5JE
Tel: 020 7680 4088
Web: www.ardent-ce.co.uk
E-mail: enquiries@ardent-ce.co.uk

Client
BURLEIGH DELL DEVELOPMENTS LTD

Project Title
5 LAWRENCE GARDENS, BARNET

Drawing Title
SITE WORKS

AT Scale	1:200	Date	FEB 24	Designed by	MC
Drawn by	MC	Checked by	MC	Approved by	SDB
Drawing Number	2307801-D002				Rev
					P1

Reproduced from / based upon Ordnance Survey material with the permission of the Controller of Her Majesty's Stationary Office. Crown Copyright Reserved. License No. 100044561

File Location: y:\client\projects\2307801 - 5 Lawrence gardens, barnet (00)\technical\cad\drawings\2307801-d002 site works.dwg

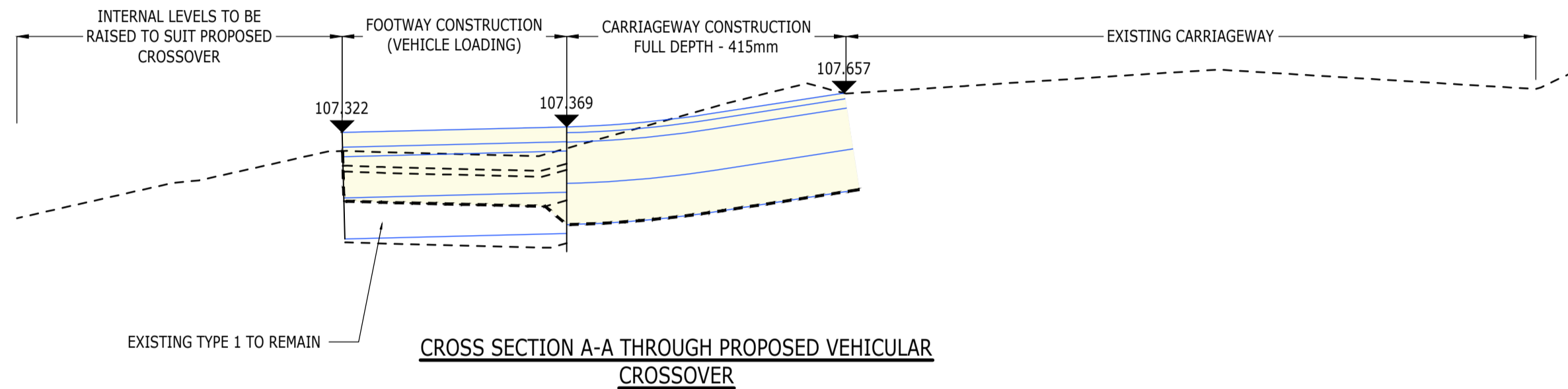
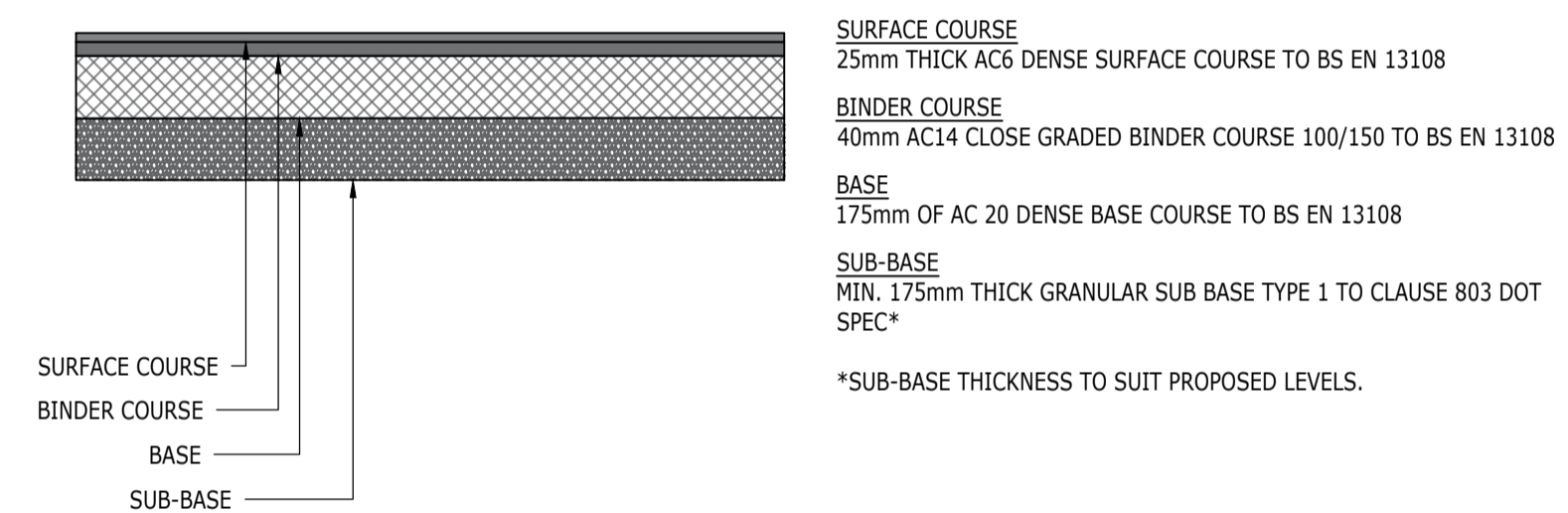
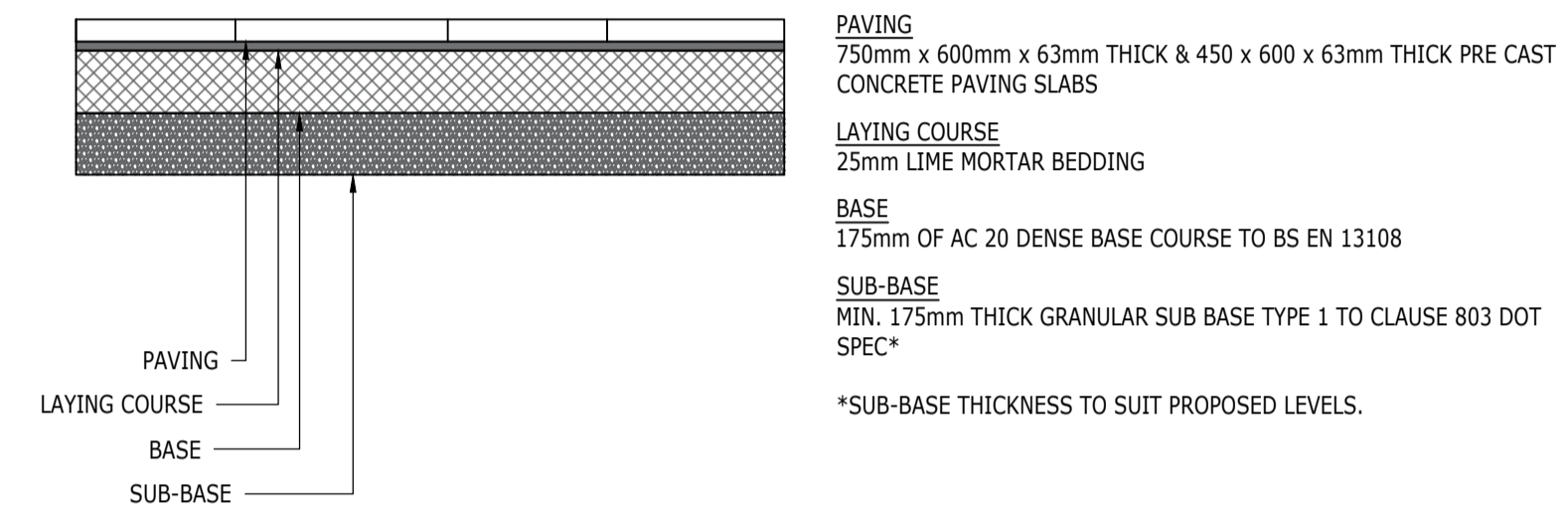
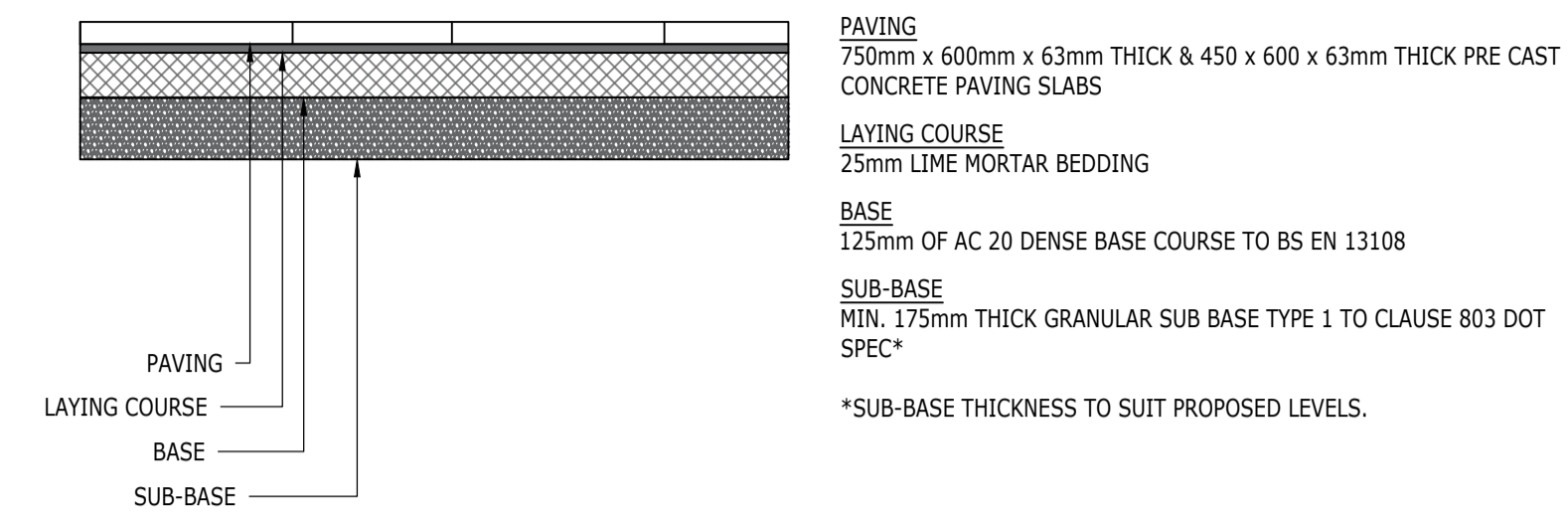
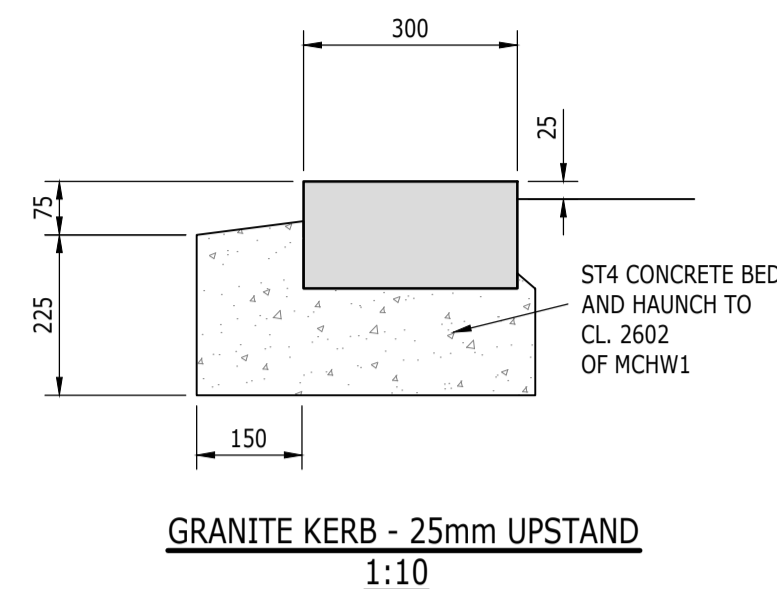
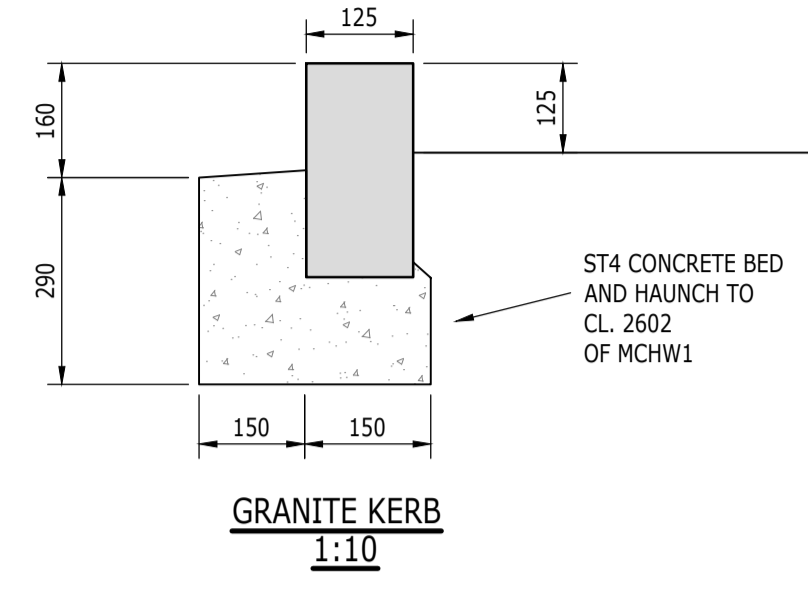
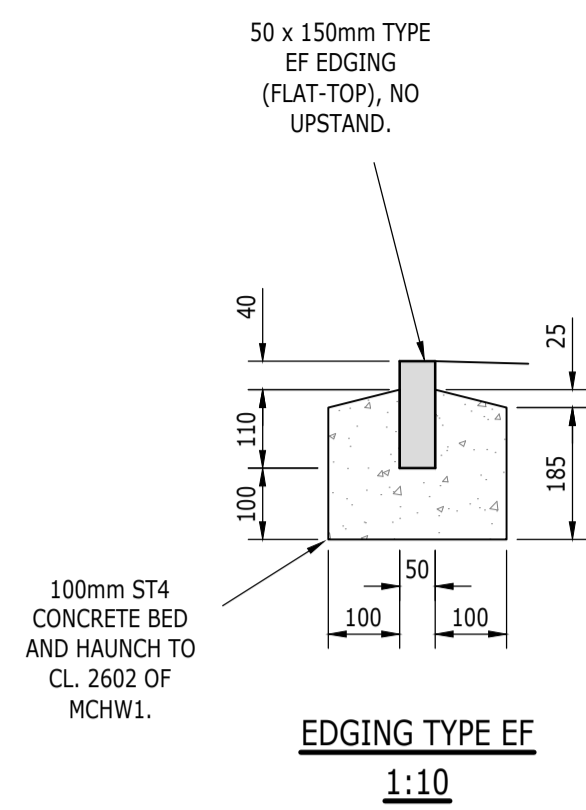

LOCATION OF SECTIONS A-A AND B-B SHOWN ON DRAWING 2307801-D002

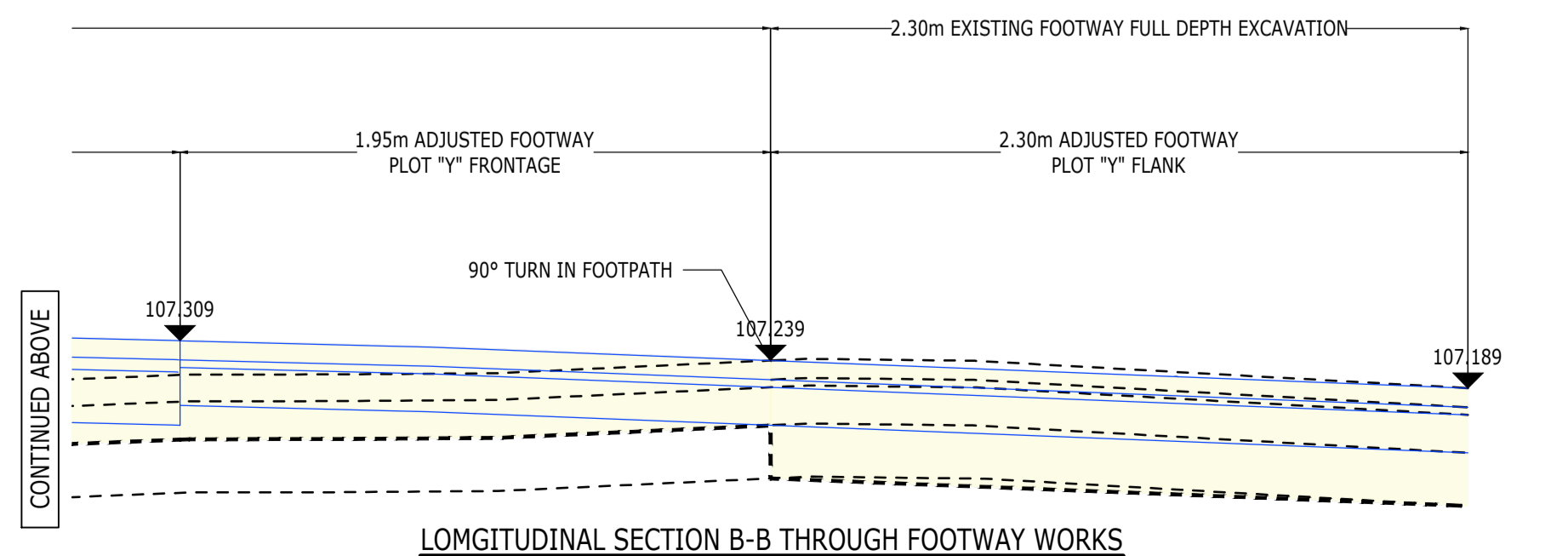
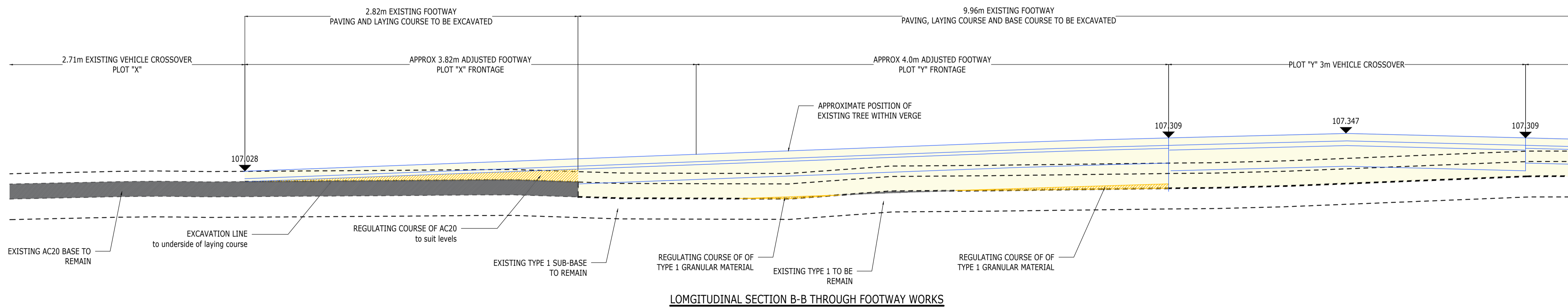

- THIS DRAWING IS TO BE READ IN CONJUNCTION WITH ALL OTHER DRAWINGS ISSUED BY THE DESIGN TEAM, PLUS ANY ASSOCIATED SPECIFICATIONS, (SEE CDM NOTES) AND ALL OTHER RELATED DRAWINGS ISSUED BY THE ENGINEER.
- DO NOT SCALE FROM THIS DRAWING. WORK FROM FIGURED DIMENSIONS ONLY.
- ALL DIMENSIONS SHOWN ON THIS DRAWING ARE IN METRES, UNLESS OTHERWISE STATED.
- ALL DIMENSIONS, LEVELS AND SURVEY GRID CO-ORDINATES ARE TO BE CHECKED ON SITE AND THE ENGINEER NOTIFIED IMMEDIATELY OF ANY DISCREPANCIES PRIOR TO THE COMMENCEMENT OF THE WORKS.
- NO DEVIATION FROM THE DETAILS SHOWN ON THIS DRAWING IS PERMITTED WITHOUT PRIOR PERMISSION FROM THE ENGINEER.
- THIS DRAWING HAS BEEN BASED UPON TOPOGRAPHICAL SURVEY BY TERRAIN SURVEYS, DRAWING No. TS24-049-1 DATED JANUARY 2024.
- ALL MATERIALS AND WORKMANSHIP SHALL COMPLY FULLY WITH THE MANUAL OF CONTRACT DOCUMENTS FOR HIGHWAY WORKS, VOLUME ONE, SPECIFICATION FOR HIGHWAY WORKS, AND, BARNET BOROUGH COUNCIL'S REQUIREMENTS AND SPECIFICATIONS.
- THE CONTRACTOR SHALL UNDERTAKE SUCH MATERIALS TESTING AS INDICATED IN THE SPECIFICATIONS AND SHALL INCLUDE THE COST OF TESTING IN THE TENDER.
- UNLESS STATED OTHERWISE, ALL EXCAVATED MATERIAL SHALL BE DISPOSED OF AT AN APPROVED TIP OFF-SITE.
- THE PUBLIC HIGHWAY AND WORKS WILL BE KEPT CLEAN AND FREE OF DEBRIS BY USE OF WHEEL WASHING FACILITIES AND ROAD SWEEPERS TO THE COUNCIL'S SATISFACTION.
- ALL SETTING OUT SHALL BE AGREED ON-SITE WITH THE HIGHWAYS INSPECTOR, PRIOR TO THE COMMENCEMENT OF THE WORKS.
- UPON COMPLETION OF THE WORKS, THE CONTRACTOR SHALL UNDERTAKE ALL NECESSARY MAINTENANCE REPAIRS TO RETURN THE HIGHWAY TO ITS FORMER CONDITION.
- THE CONTRACTOR SHALL BE RESPONSIBLE FOR OBTAINING ALL NECESSARY APPROVALS FROM THE LOCAL AUTHORITY PRIOR TO COMMENCING WORKS ON THE HIGHWAY.

TRAFFIC MANAGEMENT (INCLUDING TEMPORARY DIVERSION MEASURES OF EXISTING FOOTPATH)

- THE CONTRACTOR IS RESPONSIBLE FOR ESTABLISHING AND MAINTAINING A SATISFACTORY TRAFFIC MANAGEMENT SYSTEM FOR THE DURATION OF THE WORKS TO THE SATISFACTION OF THE HIGHWAYS INSPECTOR.

- CDM NOTES:**
- THE ATTENTION OF THE CLIENT, PRINCIPAL DESIGNER, PRINCIPAL CONTRACTOR, DESIGNERS AND CONTRACTORS IS DRAWN TO THE FOLLOWING POTENTIAL RISKS IN CONJUNCTION WITH THE PROPOSED ON-SITE AND OFF-SITE WORKS AS DESIGNED FOR THIS PROJECT:
- WORKS IN THE VICINITY OF LIVE SERVICES INCLUDING GAS, ELECTRICITY AND BT WILL BE NECESSARY AND THE ADVICE OF ALL STATUTORY SERVICE COMPANIES MUST BE SOUGHT BEFORE ANY WORKS COMMENCE.
 - WORKS WITHIN AND ABUTTING THE EXISTING HIGHWAY WILL ENTAIL TRAFFIC HAZARDS AND ALL APPROPRIATE SAFETY MEASURES INCLUDING BARRIERS, SIGNS AND LIGHTING MUST BE UNDERTAKEN TO THE APPROVAL OF THE LOCAL AUTHORITY, THE HIGHWAY AUTHORITY AND THE POLICE DEPARTMENT.
 - HAZARDOUS MATERIALS INCLUDING CEMENT AND BITUMINOUS MATERIALS ARE SPECIFIED AND THE MANUFACTURERS ADVICE ON SAFE HANDLING PROCEDURES MUST BE OBTAINED AND MADE CLEAR TO ALL OPERATIVES.
 - THE CONTRACTOR WILL BE RESPONSIBLE FOR LOCATING ALL EXISTING SERVICES WITHIN THE VICINITY OF THE WORKS HAND DUG AND ENSURE THESE ARE PROTECTED THROUGHOUT THE DURATION OF THE WORKS. ALL UTILITY PLANT SHOULD BE CLEARLY MARKED ON THE GROUND PRIOR TO COMMENCEMENT OF THE WORKS.
 - THE CONTRACTOR MUST ENSURE ALL WORKING AREAS ARE FULLY SECURE.
 - REFER TO DESIGNER'S RISK REGISTER DOC NO. 193845-01.

PI	Rev	Description	MC	MC	SDB	14.02.24
Drn	Chk	App	Date			

ARDENT CONSULTING ENGINEERS

Third Floor
The Hallmark Building
52-56 Leadenhall Street
London
EC3M 5JE

Tel: 020 7680 4088
Web: www.ardent-ce.co.uk
E-mail: enquiries@ardent-ce.co.uk

worksafe consultant
www.smasistd.com

SSIP

Client
BURLEIGH DELL DEVELOPMENTS LTD

Project Title
5 LAWRENCE GARDENS, BARNET

Drawing Title
CONSTRUCTION DETAILS

AT Scale	Date	Designed by
1:200	FEB 24	MC
Drawn by	Checked by	Approved by
MC	MC	SDB
Drawing Number	2307801-D010	
Rev	P1	