

Contact

Web: www.consultconstruct.co.uk  
Email: info@consultconstruct.co.uk  
Office: 01227 767770  
Mobile: 07855 548979 & 07764497586



Regulated by the Royal Institution of Chartered Surveyor

The Copyright of this drawing remains with Consult Construct and is not to be reproduced without written approval. Dimensions are not to be scaled from this drawing. The Contractor is to check all dimensions on site and report any discrepancies to the Contract Administrator. This drawing is to be read in conjunction with all other standard documentation.

Revisions

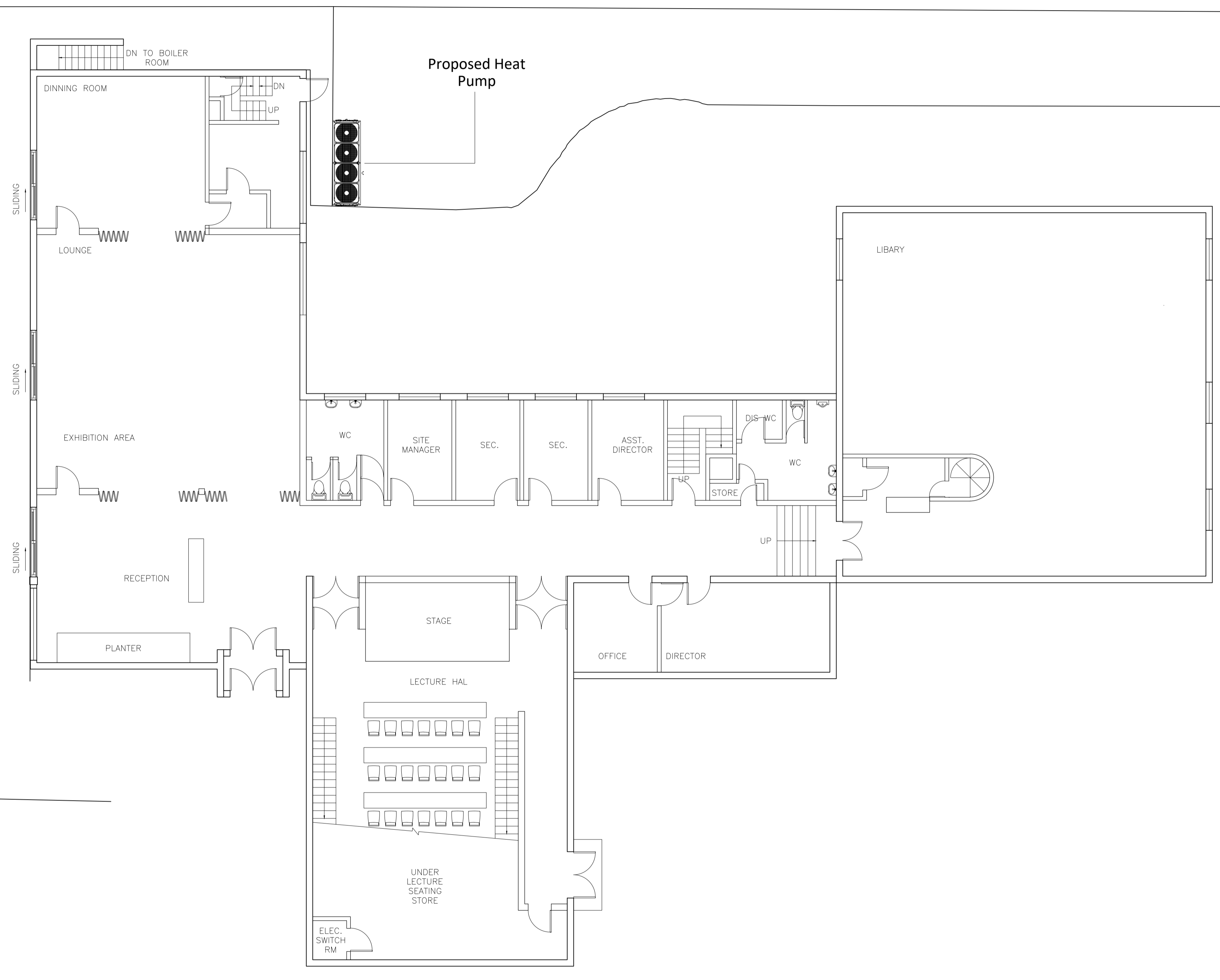

PROPOSED GROUND FLOOR PLAN - 1:100 (A1)

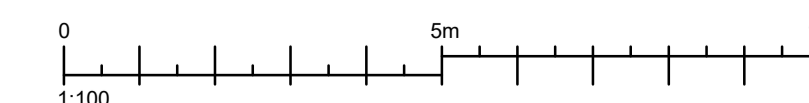

**Consult Construct**

PROPERTY CONSULTANTS AND CONTRACTORS

project :  
Maison Française d'Oxford  
2-10 Norham Rd  
Oxford OX2 6SE

client:  
French Embassy

drawing title :  
Proposed Ground Floor Plan

project no :	drawing no :	rev :	scale :	date :
22.2633	08	-	1:100 (A1)	January 2024