

THIS DRAWING CONSISTS OF INFORMATION FROM THE FOLLOWING DRAWINGS:

TOPOGRAPHICAL SURVEY Received from Fosse Surveying Ltd 2259 dated 11/08/2023 and Received 22/08/2023.

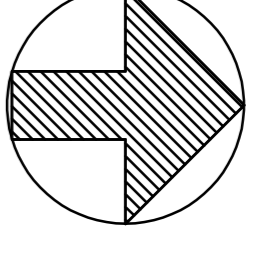

N

- KEY:**
- BLACK - Existing Levels
 - BLUE - Proposed Levels
 - RED - Former Levels
 - BLUE - Proposed Finished Floor Levels

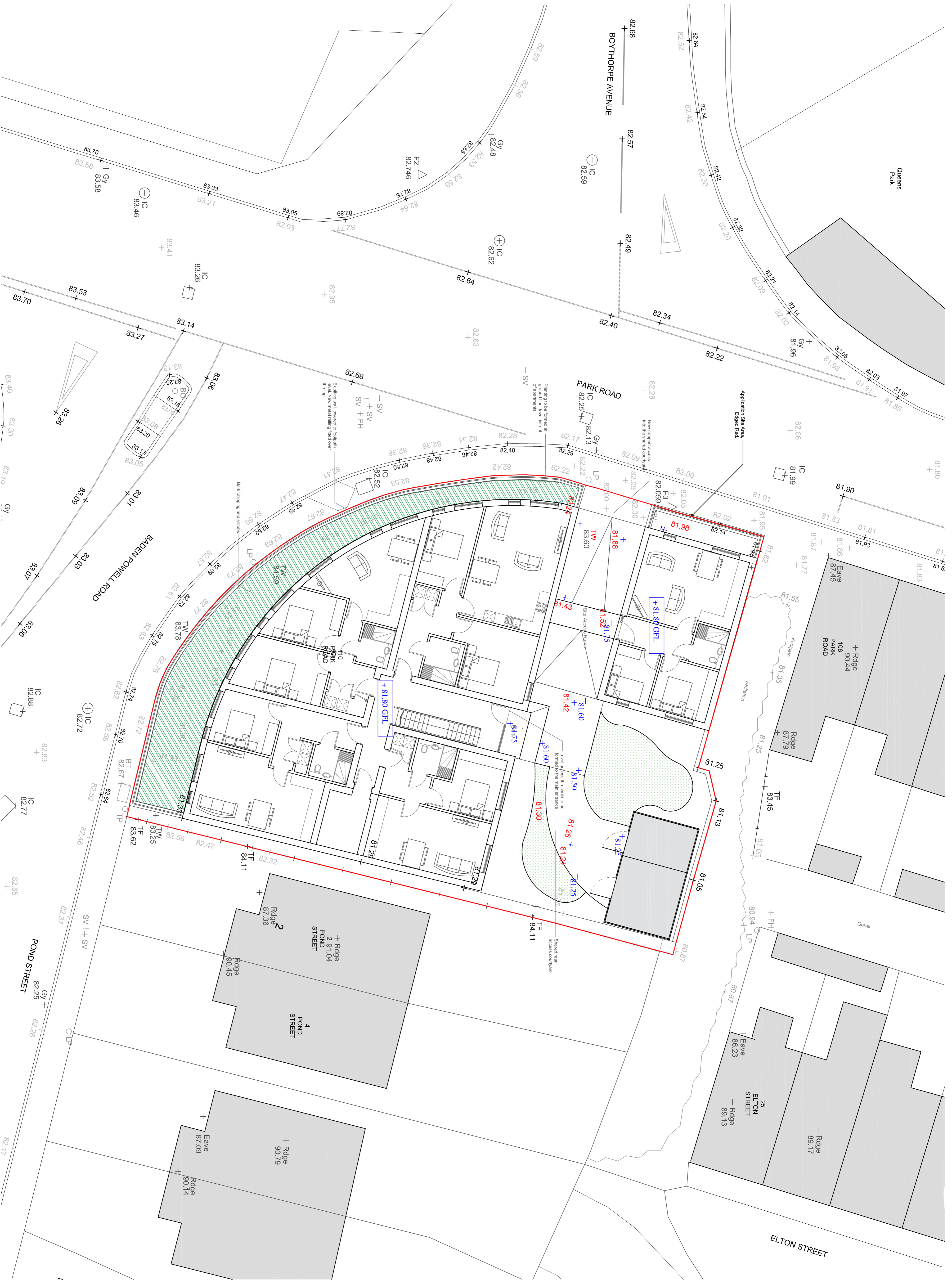

Design Studio @ 32 Causeway Head Road, Dore, Sheffield, S17 3DT
 Tel, Chesterfield: 01246 383707
 email: info@bcaarchitects.co.uk
 Tel, Sheffield: 0114 2361366
 web - www.bcaarchitects.co.uk
 © Copyright. This drawing is the property of Brightman Clarke Architects and shall not be loaned, copied or distributed to any third party without prior written consent of Brightman Clarke Architects

Client: A-Rock Construction Ltd
 Project: Proposed Redevelopment of Site at 110 Park Road, Chesterfield into Residential Apartments
 Drawing No: 23-030-P09
 Drawing Title: Planning Drawings
 Proposed Site Levels Plan
 Scale @ A1: 1:100

Rev: A Rev Date: 09/02/2024 Drawn By: JLC
 Rev Details: Application Boundary Updated to match site location plan
 Rev: Rev Date: 21/12/2023 Drawn By: JLC
 Rev Details: Initial Issue
PLANNING DRAWINGS