



01 Existing South West Elevation
Scale 1:50@A1; 1:100@A3

0m 1m 2m 5m 10m

Revisions		
P1	05/02/24	Issued for Planning

Information contained within this drawing is the sole copyright of HDIA Ltd. and is not to be reproduced without express permission. No implied licence exists. This drawing not to be used for land transfer or valuation purposes. Do not scale from this drawing. All dimensions & levels are to be checked on site by the contractor. Issued for purposes indicated only. Drawing errors and omissions to be reported to the architect.

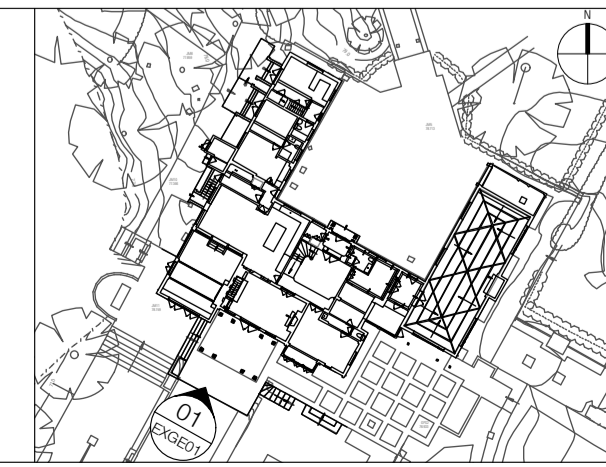

Client	Clare and Chris Mathis		
Project	Woodland Drive, East Horsley, Inn Innisfree KT24 5AS		
Drawing Title	Existing Elevations South West Elevation		
Status	Ar	Drawn	Checked
Scale	1:50@A1 ; 1:100@A3	Date	DE
Drwg. No. & Revision		Date	
1153-ExGE-01-P1		Sept 2023	

		4th Floor 104-110 Goswell Road London EC1V 7DH	
		T +44 20 7490 7674 studio@hdiar.uk www.hdiar.uk	