

APPENDIX I RE PLAN/2022/1133

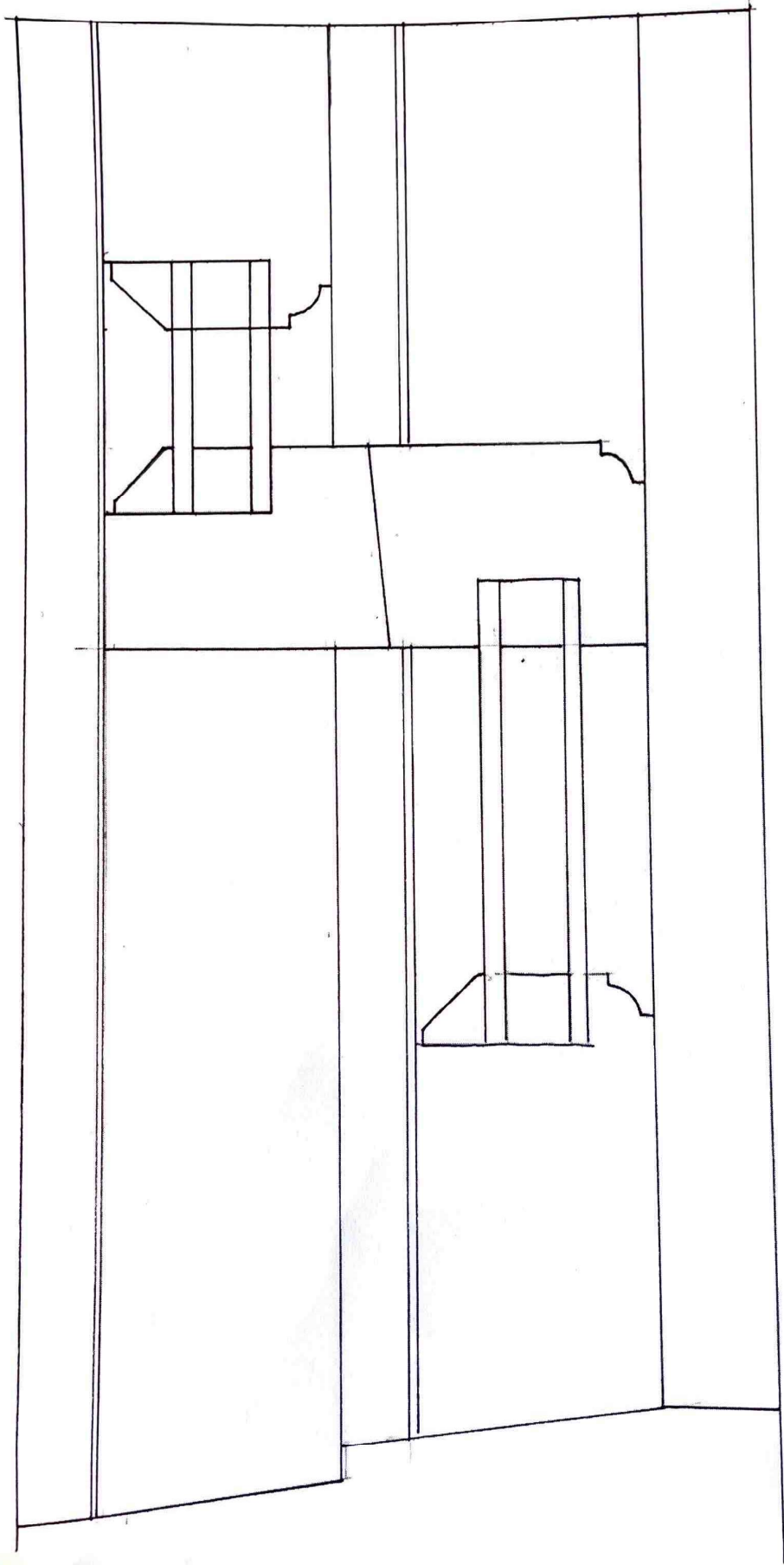

Appendix 2

Re PLAN/2022/1133

I have included a copy of a cross section diagram prepared by the Carpenter who will make the replacement sash window. He has constructed other windows for us at 1 Horsell Grange, all of which we have obtained Listed Building consent for prior to construction. The window in question will be the same height and width as the one being replaced and the two sashes, the same size as those being replaced. The windows themselves (i.e. the glass panes) will be 5 mm deeper than the existing windows would allow for. This is due to the fact that there will be two panes of glass with the double glazing void in between.

To honour the previous window, the replacement will not contain any horns on the upper sash and the sashes will be hung with traditional weights and pulleys.

The vertical glazing bar will be an Ovolo moulding to match the bars on the window being replaced.