

A Proposed Site Plan
S.01 1:100 @ A1; 1:200 @ A3

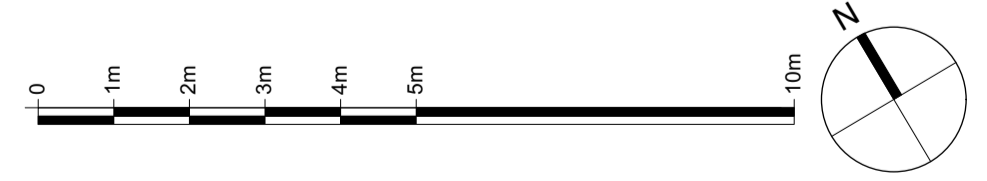

| Revisions | | |
|-----------|----------|-------------------------|
| H | 22.01.24 | Issued for comment. |
| I | 24.01.24 | Issued for comment. |
| J | 24.01.24 | Window amended. |
| K | 01.02.24 | Issued for comment. |
| L | 14.02.24 | Issued for application. |

| Landscape Key | |
|---------------|-------------------------|
| | Pebble Blockwork Paving |
| | Patio |
| | Grass |

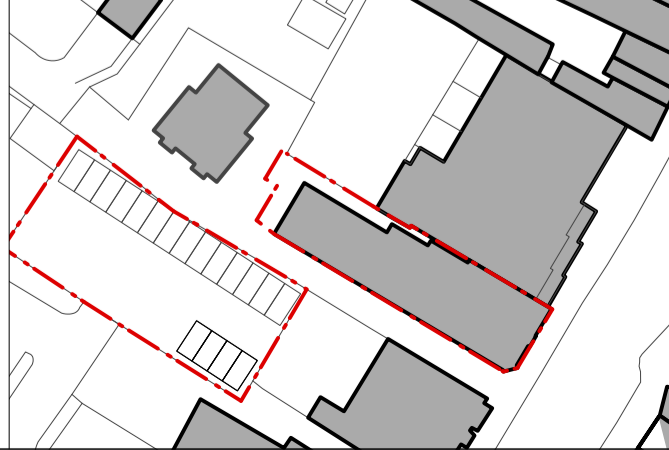

| | | |
|---------------|---|--|
| Client | Klara Homes | |
| Project | 89 High Street, Billericay | |
| Drawing Title | Proposed Site Plan General Arrangement | |

| | | | | |
|--|-----------|-------------------------|----------|----------|
| T25 ARCHITECTURE LTD <small>A: LMF.302, The Leather Market Weston St., London, SE1 3ER M: +44 208 066 7078 E: admin@t25architecture.com W: www.t25architecture.com</small> | Status | Planning | Checked | TJS |
| | Scale | 1:100 @ A1 ; 1:200 @ A3 | Date | Nov 2023 |
| | Drwg. No. | 133_PL2_S_01 | Revision | L |

Information contained within this drawing is the sole copyright of T25 Architecture Ltd, and is not to be reproduced without express permission. No implied licence exists. This drawing not to be used for land transfer or valuation purposes. Do not scale from this drawing. All dimensions & levels are to be checked on site by the contractor. Issued for purposes indicated only. Drawing errors and omissions to be reported to the architect.