

These drawings form part of Planning Application no 100660452-001
 Nicola Campbell Feb 2024

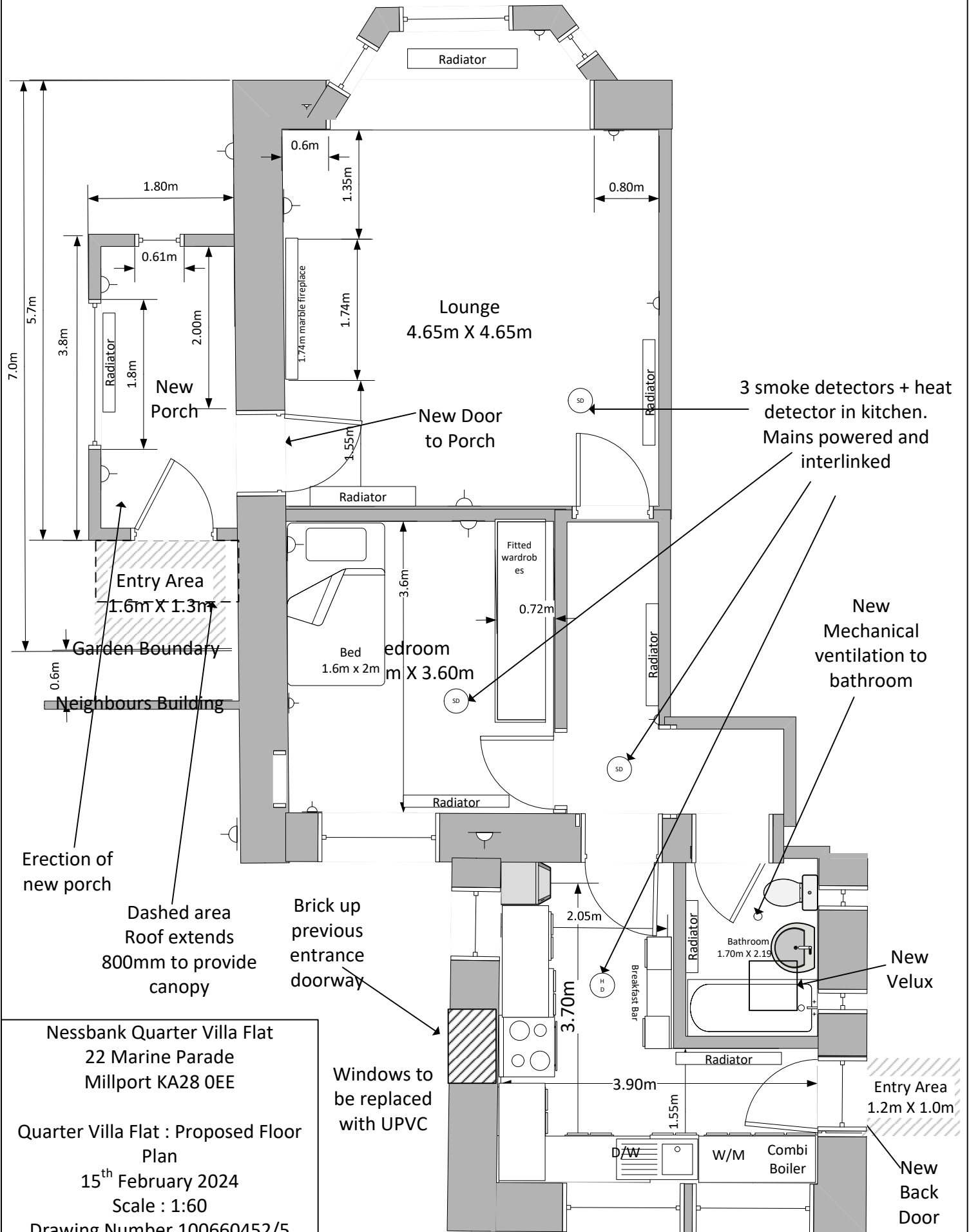

Nessbank Quarter Villa Flat
 22 Marine Parade
 Millport KA28 0EE

Quarter Villa Flat : Proposed Floor Plan
 15th February 2024
 Scale : 1:60
 Drawing Number 100660452/5