

Key:

1. Existing access to be retained.
2. Red dashed lines denote existing drive
3. Proposed driveway and parking to be finished in 20mm loose gravel chippings.
4. Existing tree's and hedgerow to remain.
5. Surface water to discharge to existing proprietary Aeration System treatment plant. Size to be checked to confirm adequate capacity.
6. Drive to allow for safe access and turning for emergency vehicles
7. New barn owl box installed
8. Electric Vehicle charging point provided
9. Retaining wall to be constructed out of concrete panels to engineers specifications.

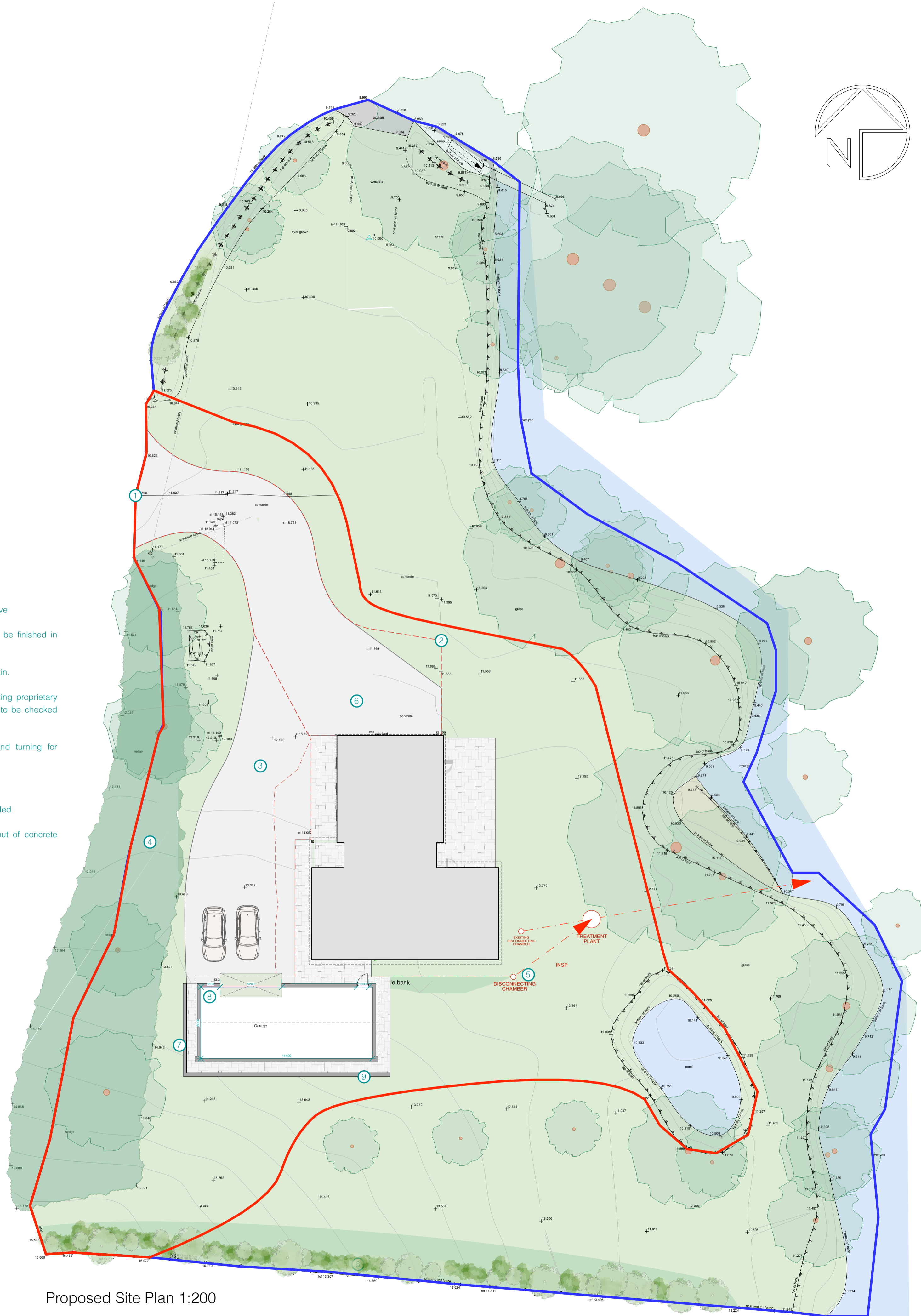

Proposed Site Plan 1:200

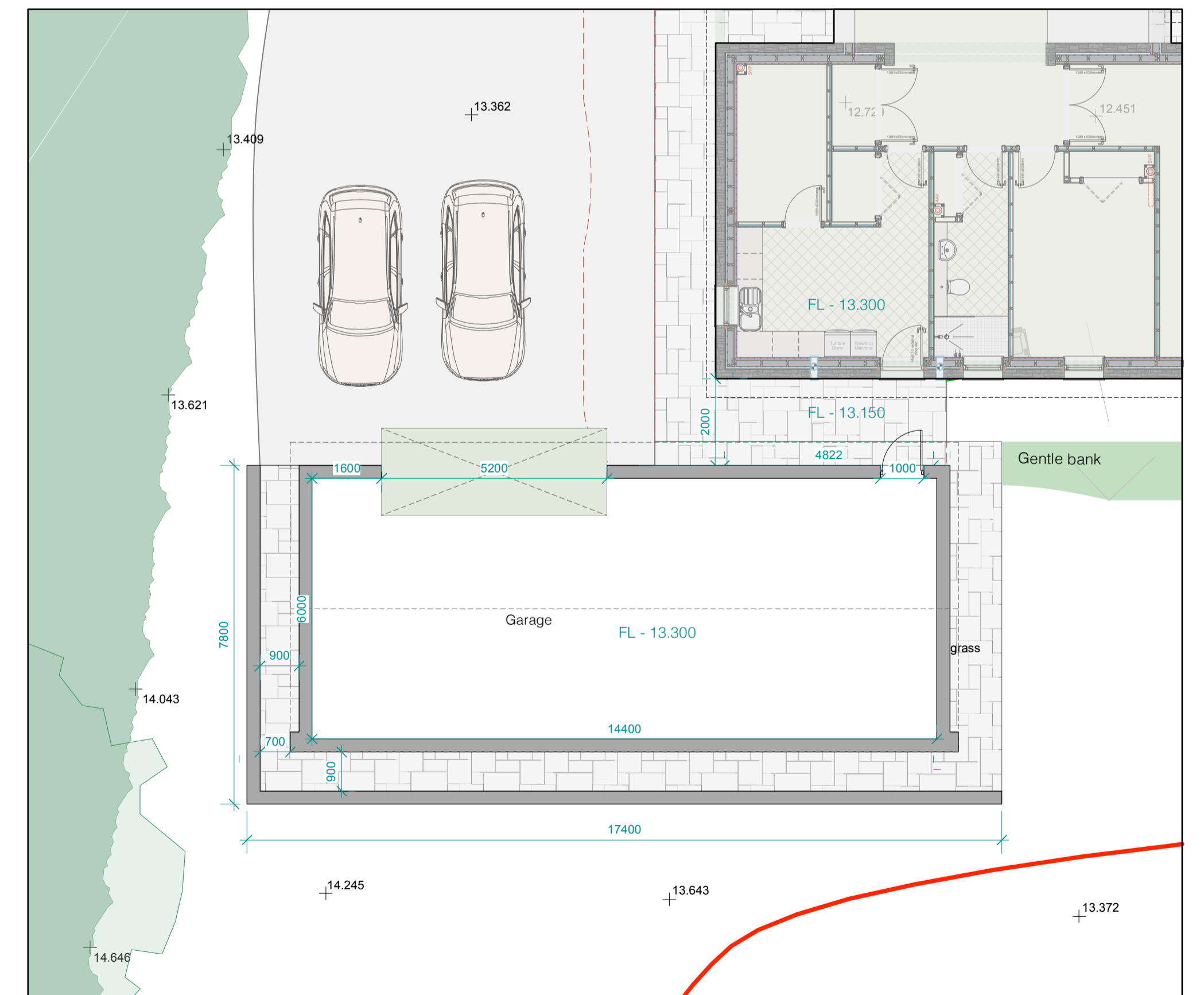

Proposed plan in context 1:100