

**NOTES**  
 Do not scale from this drawing. Only figured dimensions are to be taken from this drawing.  
 The contractor must verify all dimensions on site before commencing any work or shop drawings. The contractor must report any discrepancies to the designer before commencing work. If this drawing exceeds the quantities taken in any way, the designer is to be informed before the work is initiated.  
 Work within The Construction (Design and Management) Regulations 2020 is not to start until a Health and Safety Plan has been produced.

© Copyright  
 All rights prescribed in Chapter IV of the Copyright and Patents Act 1988 have been generally asserted.

Revision Schedule				
Ref	Description	To	By	Date
A	Planning Submission		Client	HAJB   30/01/24

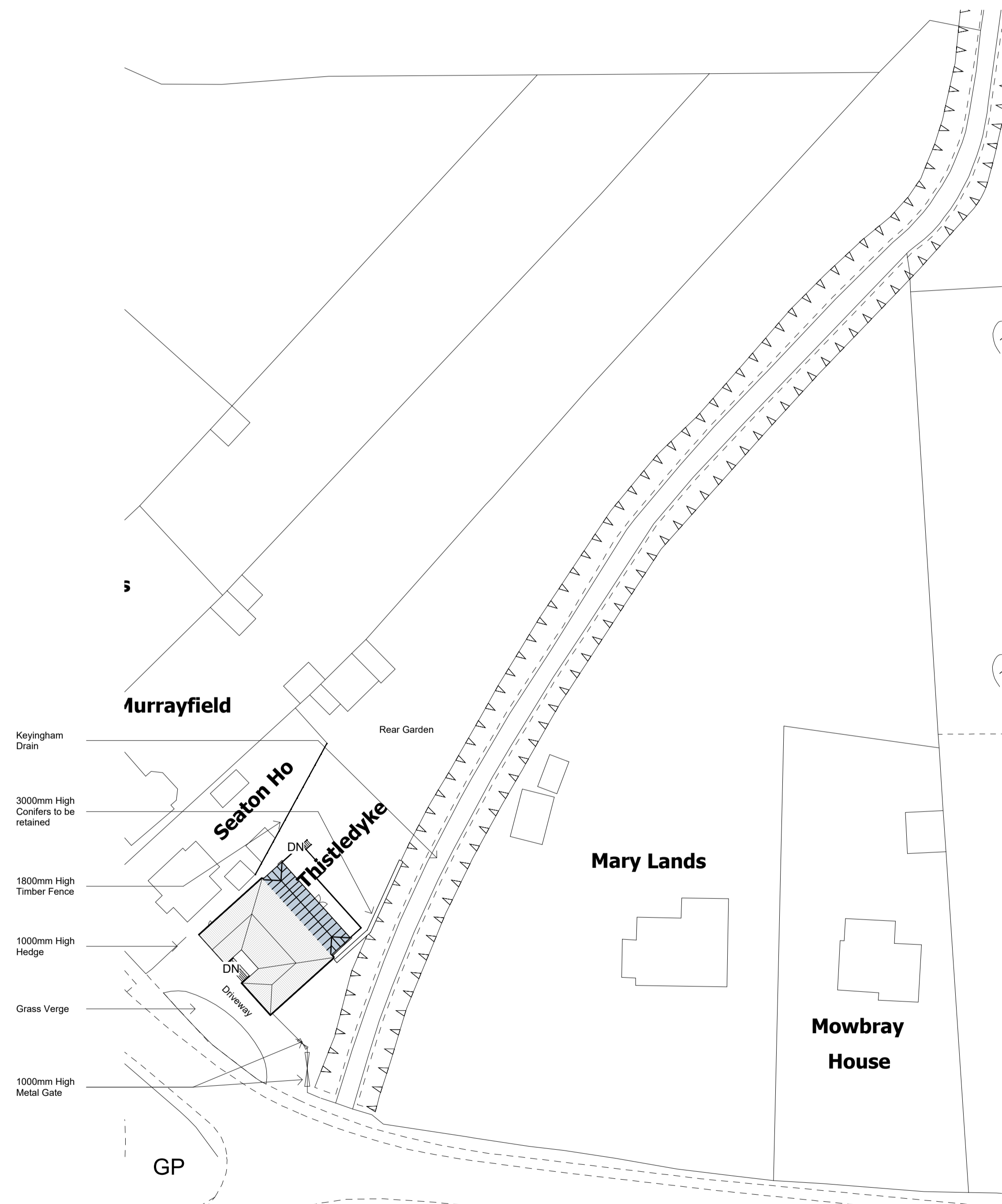

**Block Plan**  
 1 : 500

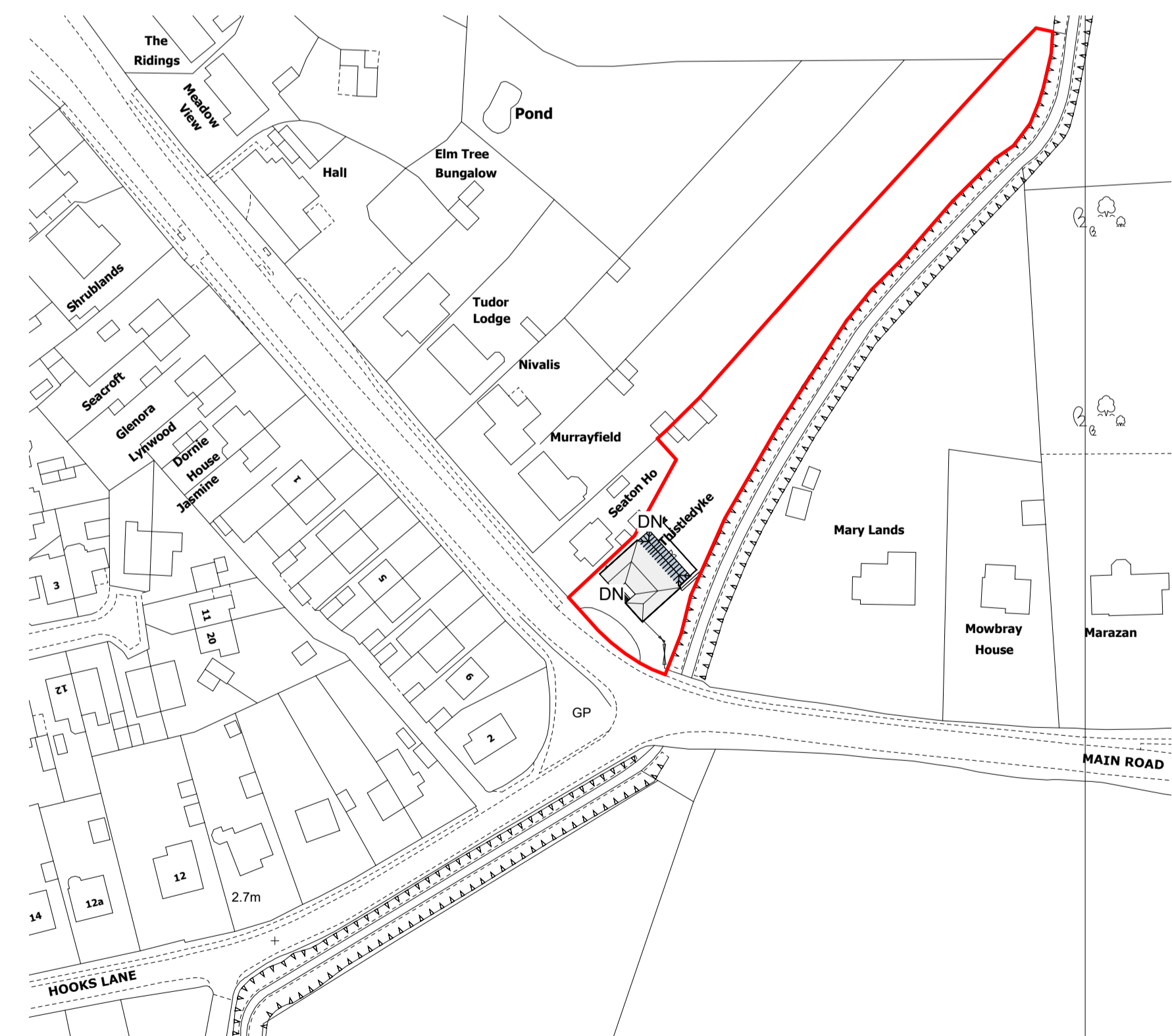

**Location Plan**  
 1 : 1250