

Disclaimer:
 Do not scale from this drawing.
 All particulars and dimensions must be checked on site prior to commencement and not scaled from the drawings.
 This document is copyright and may not be reproduced without permission of the owner.

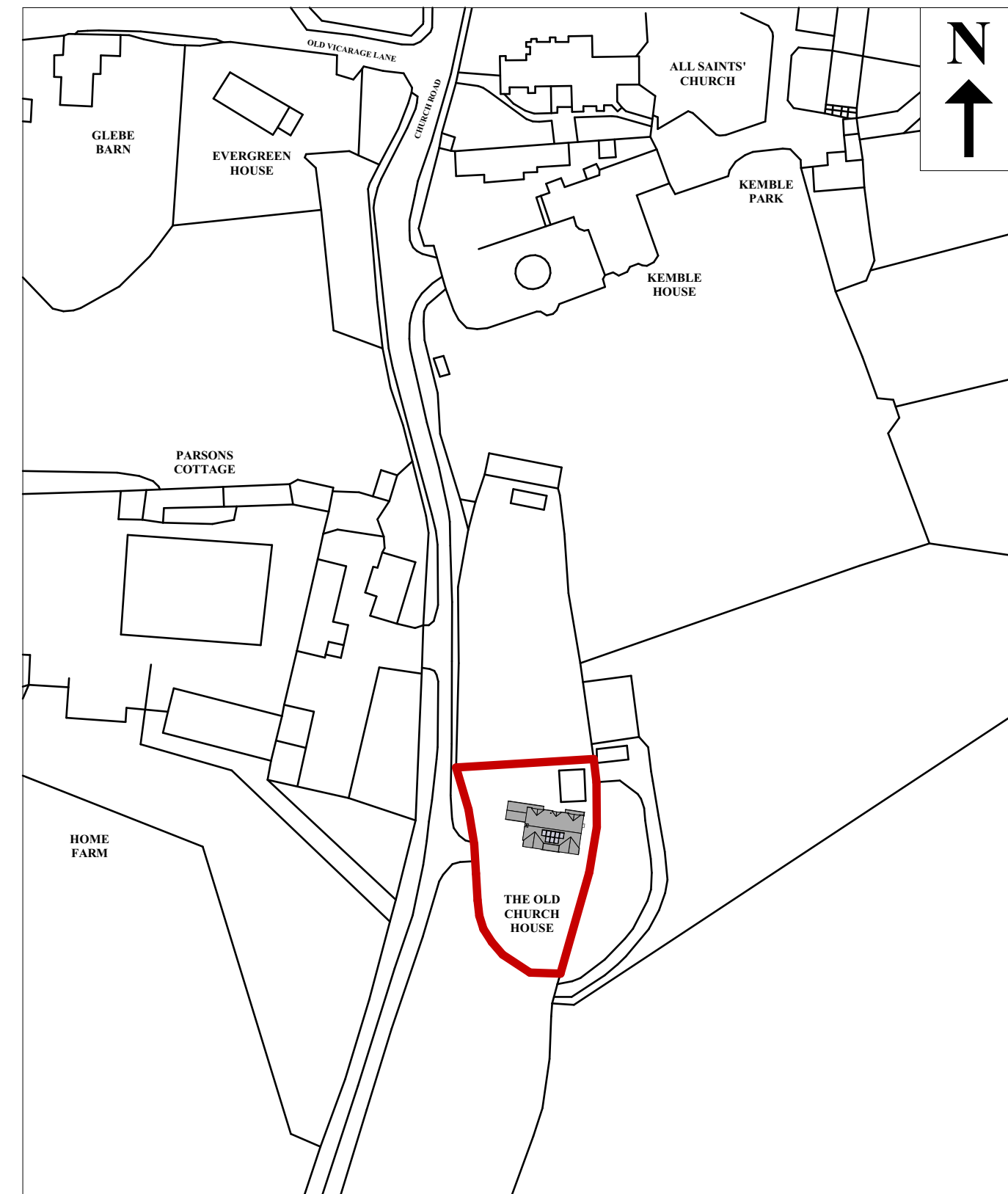

Site Plan

900mm high black painted metal agricultural railings applied to the inside of the stone boundary wall by specialist.



Precedent Image

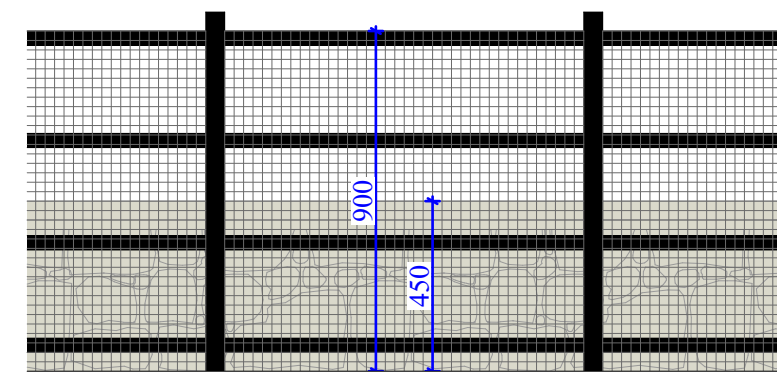

Internal Elevation

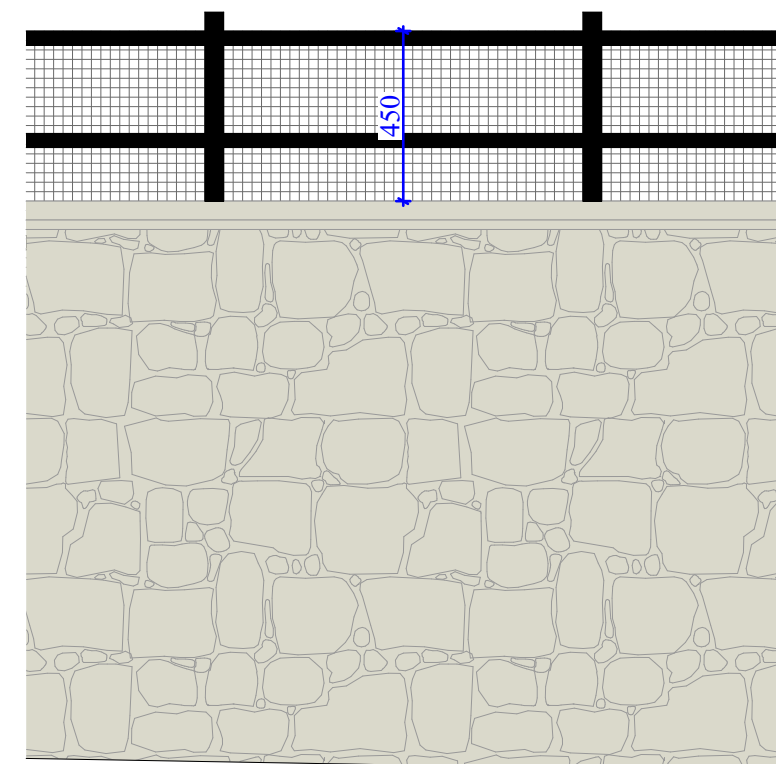

External Elevation

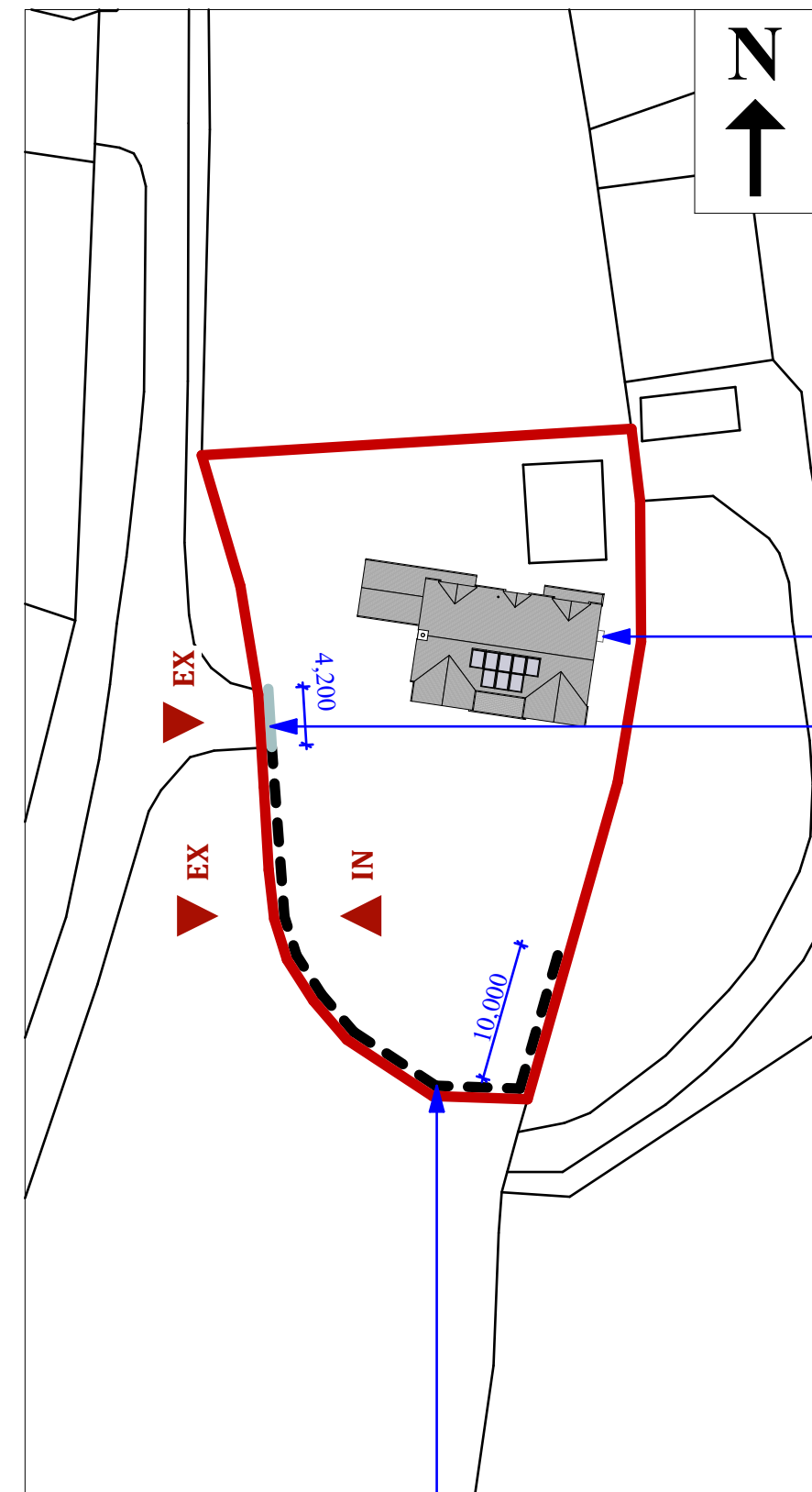

Block Plan

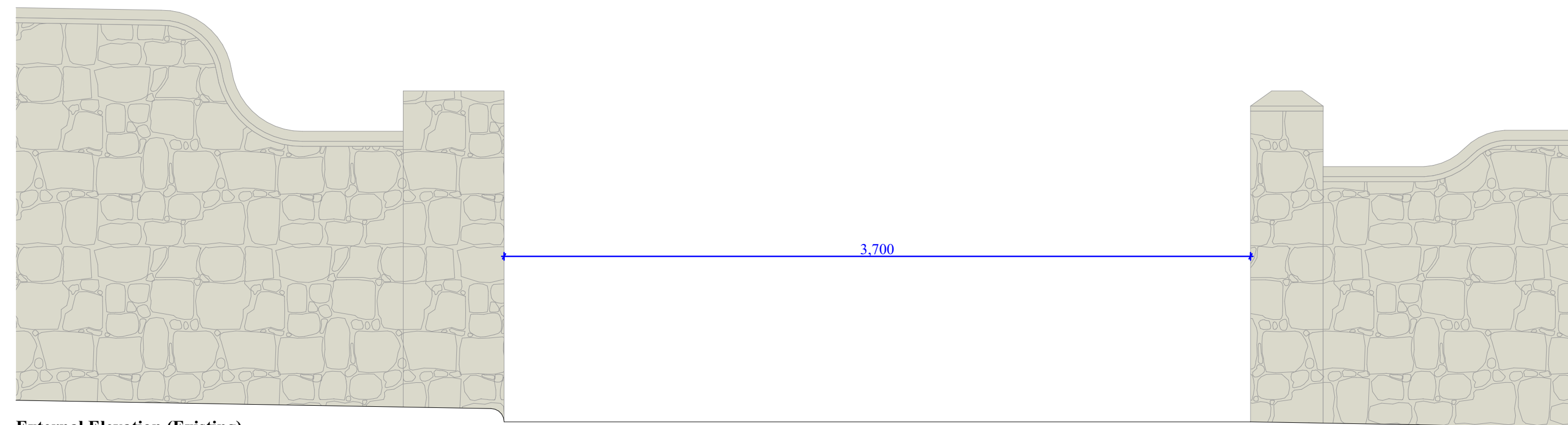

External Elevation (Existing)

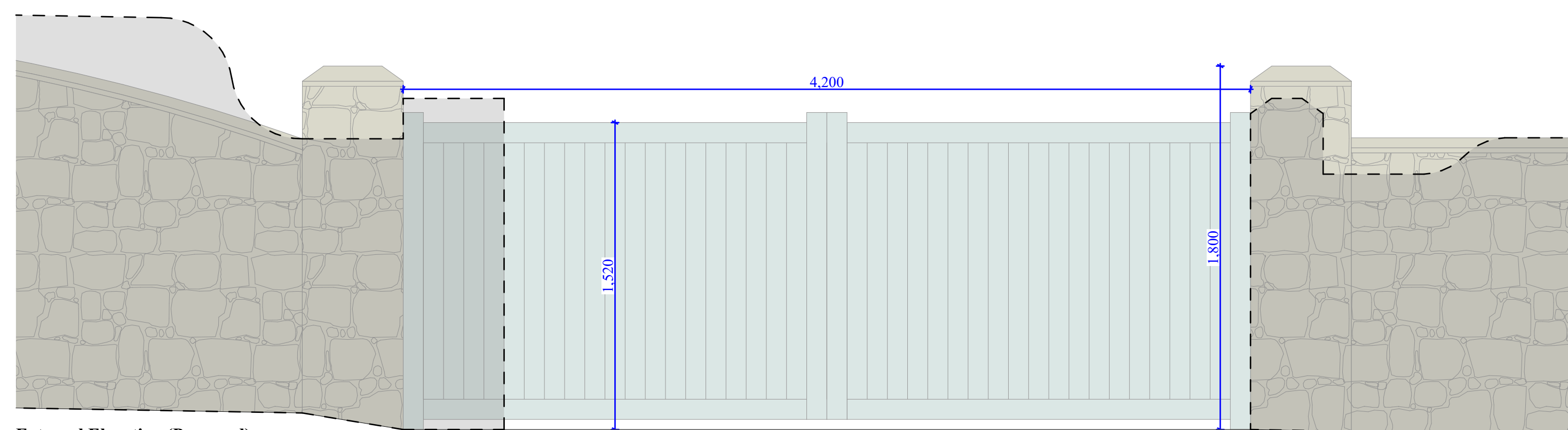

External Elevation (Proposed)

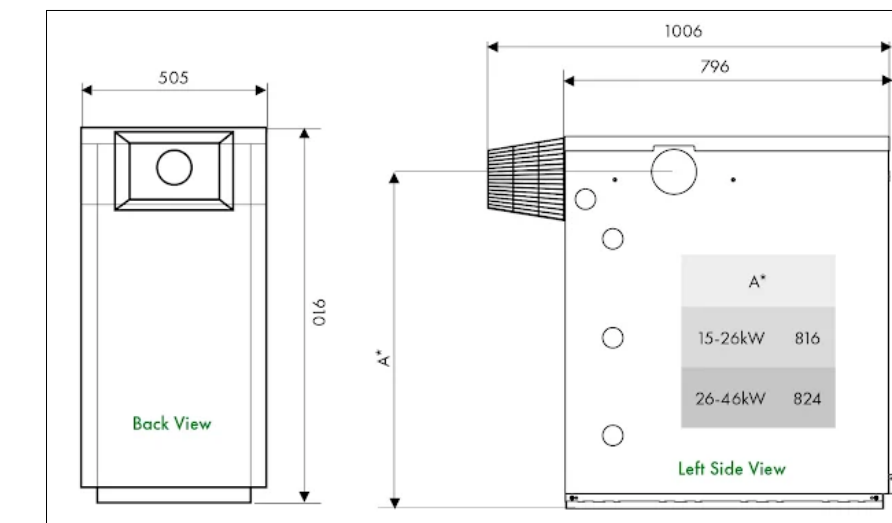

Product Dimensions



Product Image

Grant Vortex Pro 26/46kW external oil boiler replacing the existing, installed to manufacturers details to the rear of the property, away from the highway by specialist.

1,520mm high x 4,200mm wide timber electric gates to reconstructed 1,800 high stone pillars by specialist. Stone boundary walls rebuilt to matching heights in accordance with the reconstructed stone pillars by specialist. New gates to replace historic timber gates.

Project: Extensions & Alterations:
 The Old Church House
 Kemble
 GL7 6AD

Client: Arge:
 The Old Church House
 Kemble
 GL7 6AD

Proposed Site, Block Plans & External Elevations

Scale (A1): 1:20, 1:500 & 1:1250

Drawing: 66-011

barnaby
 ARCHITECTURE

Email: barnaby@barnabyarchitecture.info