

PROPOSED ROOF PLAN

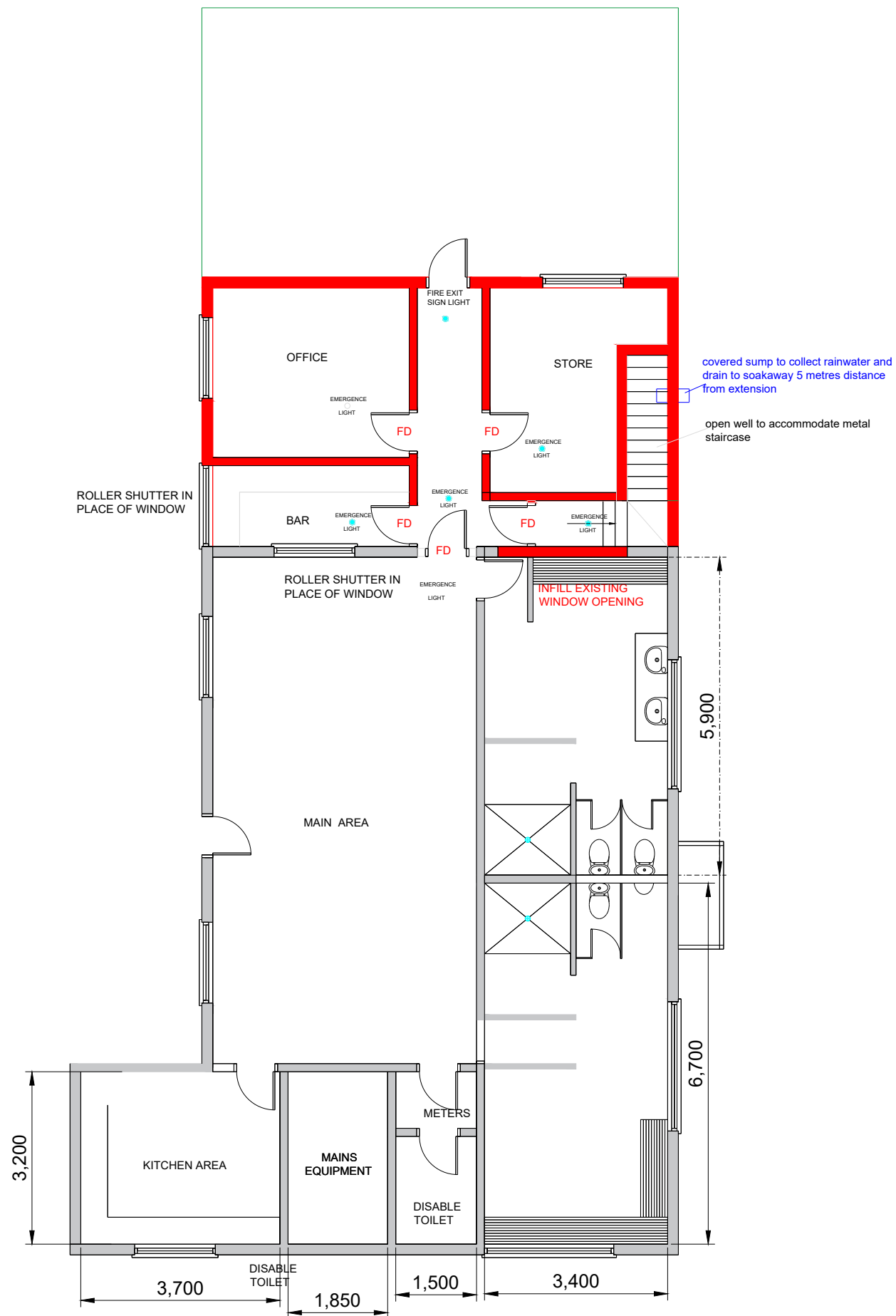

PROPOSED FLOOR PLAN

CLIENT: FRINDBURY LAWN TENNIS CLUB

PROJECT: NEW SINGLE STOREY SIDE EXTENSION

ADDRESS: FRINDBURY LAWN TENNIS CLUB UPNOR ROAD

TITLE: EXISTING ELEVATIONS

SCALE: 1:100 @ A3

DRWG No: BR/2806/106

DATE: JANUARY 2024

GENERAL NOTES:

1. The Contractor is responsible for the correct setting out of the work.
2. All building materials, components, workmanship to comply with the appropriate Building Regulations. British Standards Codes of Practice and manufacturers' recommendations.
3. All equipment installed in connection with Gas, Electricity and Water Services shall conform to the supply Authorities Bye-laws and Regulations and shall be subject to their Officer's inspection and approval.
4. These drawings are to be read in conjunction with all other Architect's, Consultants and Specialist sub-contractors drawings.
5. All structural timber to be pre-treated stress graded to BS4978 and to be stamped KD (kiln dried)
6. All external softwood to be pre-treated with preservative.
7. All dimensions and levels to be checked on site prior to construction and/or the manufacture of steelwork, architectural ironmongery, stonework and any other purpose made item.
8. All specialist details are Design intent only & subject to specialist design and detailing.



W.D.EVANS BUILDING SERVICES
 45 GALLEON WAY
 UPNOR
 ROCHESTER
 KENT
 ME2 4GX
 Tel : 01634 714202
 mob : 07958 492935
 e-mail: dedesign101@gmail.com