

- NOTES**
- All dimensions and levels are to be checked on site.
  - Any discrepancies are to be reported to the architect before any work commences.
  - This drawing shall not be scaled to ascertain any dimensions. Work to figured dimensions only.
  - This drawing shall not be reproduced without express written permission from AEW.
  - Title overlay drawings and ownership boundaries are produced using all reasonable endeavours. AEW cannot be responsible for the accuracy or scale discrepancy of base plans supplied to them.
  - All works are to be undertaken in accordance with Building Regulations and the latest British Standards.
  - All proprietary materials and products are to be used strictly in accordance with the manufacturers recommendations.

**CDM 2015**  
 Client notified of duties: **At Design Workshops**  
 Principal Designer: **CS**  
 Unless noted below, all known hazards have been highlighted on the drawing.

- Drawing Based on Four By Two, Drawing No. 1063\_0646\_04 Rev'd dated 20/07/17 and 02/08/17.
- Scale for planning purposes only.
- Extent of McDonald's Demise Indicated:

**Notes:**  
 All drawings to be read in conjunction with all other drawings as noted on issue sheet.

Schedule of Areas	
Existing Site Area (Includes Existing Car & Pedestrian Drives)	3,200.2 m <sup>2</sup>
Existing Building (GFA - net)	284.4 m <sup>2</sup>
Proposed Site Area (Includes Proposed Building (GFA - net) (Including Car & Pedestrian Drives)	271.8 m <sup>2</sup>

Schedule of Parking	
Existing Accessible Bays	02
Existing General Bays	02
Existing Access & Cycle Bays	27
Existing Motorway Bays	24
Proposed Accessible Bays	02
Proposed General Bays	28
Proposed Access & Cycle Bays	02
Proposed Motorway Bays	01
Proposed Total Bays	92

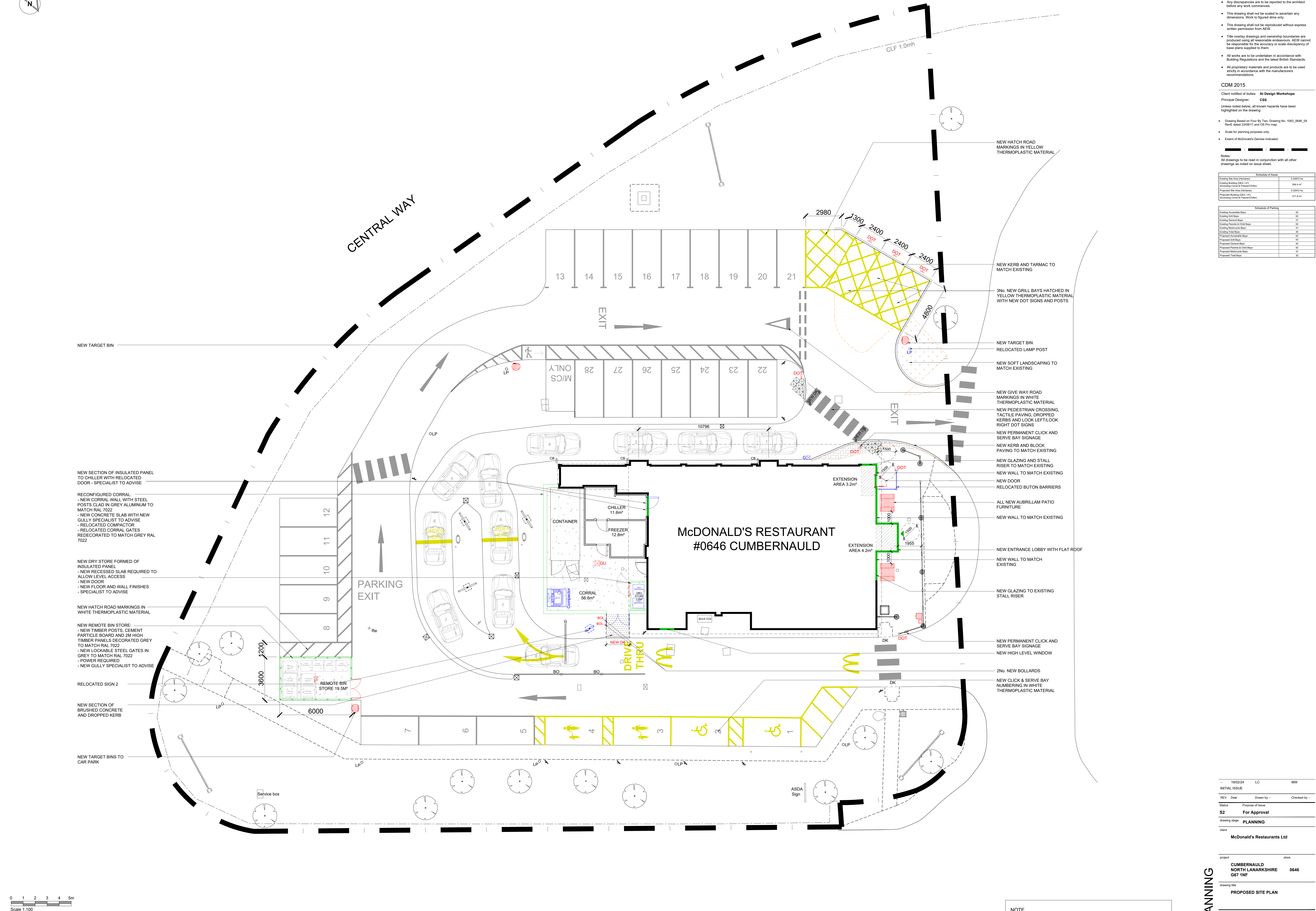

NEW TARGET BIN

NEW SECTION OF INSULATED PANEL TO CHILLER WITH RELOCATED DOOR - SPECIALIST TO ADVISE

RECONFIGURED CORRAL:  
 - NEW CORRAL WALL WITH STEEL POSTS CLAD IN GREY ALUMINIUM TO MATCH RAL 7022  
 - NEW CONCRETE SLAB WITH NEW GULLY SPECIALIST TO ADVISE  
 - RELOCATED COMPACTOR  
 - RELOCATED CORRAL GATES REDECORATED TO MATCH GREY RAL 7022

NEW DRY STORE FORMED OF INSULATED PANEL  
 - NEW RECESSED SLAB REQUIRED TO ALLOW LEVEL ACCESS  
 - NEW DOOR  
 - NEW FLOOR AND WALL FINISHES  
 - SPECIALIST TO ADVISE

NEW HATCH ROAD MARKINGS IN WHITE THERMOPLASTIC MATERIAL

NEW REMOTE BIN STORE:  
 - NEW TIMBER POSTS, CEMENT PARTICLE BOARD AND 2M HIGH TIMBER PANELS DECORATED GREY TO MATCH RAL 7022  
 - NEW LOCKABLE STEEL GATES IN GREY TO MATCH RAL 7022  
 - POWER REQUIRED  
 - NEW GULLY SPECIALIST TO ADVISE

RELOCATED SIGN 2

NEW SECTION OF BRUSHED CONCRETE AND DROPPED KERB

NEW TARGET BINS TO CAR PARK

NEW HATCH ROAD MARKINGS IN YELLOW THERMOPLASTIC MATERIAL

NEW KERB AND TARMAC TO MATCH EXISTING

3No. NEW GRILL BAYS HATCHED IN YELLOW THERMOPLASTIC MATERIAL WITH NEW DOT SIGNS AND POSTS

NEW TARGET BIN

RELOCATED LAMP POST

NEW SOFT LANDSCAPING TO MATCH EXISTING

NEW GIVE WAY ROAD MARKINGS IN WHITE THERMOPLASTIC MATERIAL

NEW PEDESTRIAN CROSSING, TACTILE PAVING, DROPPED KERBS AND LOOK LEFT/LOOK RIGHT DOT SIGNS

NEW PERMANENT CLICK AND SERVE BAY SIGNAGE

NEW KERB AND BLOCK PAVING TO MATCH EXISTING

NEW GLAZING AND STALL RISER TO MATCH EXISTING

NEW WALL TO MATCH EXISTING

NEW DOOR

RELOCATED BUTON BARRIERS

ALL NEW AUBRILLAM PATIO FURNITURE

NEW WALL TO MATCH EXISTING

NEW ENTRANCE LOBBY WITH FLAT ROOF

NEW WALL TO MATCH EXISTING

NEW GLAZING TO EXISTING STALL RISER

NEW PERMANENT CLICK AND SERVE BAY SIGNAGE

NEW HIGH LEVEL WINDOW

2No. NEW BOLLARDS

NEW CLICK & SERVE BAY NUMBERING IN WHITE THERMOPLASTIC MATERIAL

**McDONALD'S RESTAURANT #0646 CUMBERNAULD**

**NOTE**  
 ALL DRAINAGE & SERVICES TO BE CHECKED BY OTHERS

0 1 2 3 4 5m  
 Scale 1:100  
**PROPOSED SITE PLAN 1:100**

**PLANNING**

date	19/02/2024	drawn	LC
checked		checked	MW
scale	1:100	scale	1:100

client: **McDonald's Restaurants Ltd**

project: **CUMBERNAULD NORTH LANARKSHIRE G67 1NF 0646**

drawing title: **PROPOSED SITE PLAN**

Job No: **13208\_AEW\_0646\_1004**  
 www.aewarchitects.com  
 0185 214 4370