

Adverts Schedule								
Signage Reference:	QTY	Size mm (WxDxH)	Materials	Colour	Height above ground (mm)	Extent of Projection (mm)	Height of Text (mm)	Illumination
Sign 1 Double Digital Menu Board	3 ( 3 Existing )	1648 x 108 x 2167	Steel framework clad in PPC aluminium panels finished in Grey RAL 7022	Grey	2167	N/A	N/A	2No. 55" Monitor Illuminated Only
Sign 2 Single Digital Menu Board	1 (Existing Relocated)	853 x 108 x 2167	Steel framework clad in PPC aluminium panels finished in Grey RAL 7022	Grey	2167	N/A	N/A	1No. 55" Monitor Illuminated Only

Planning & Signage Schedule								
Signage Reference:	QTY	Size mm (WxDxH)	Materials	Colour	Height above ground (mm)	Extent of Projection (mm)	Height of Text (mm)	Illumination
COD	2 (Existing Retained)	710 x 414 x 1482	COD - PPC Alu customer order display unit including speaker point, microphone, camera and illuminated letters	Grey RAL 7022 PPC Alu & Acrylic	N/A	1482	N/A	Monitor illuminated only
Gallow Height Restrictor	1 (Existing Retained)	330 x 3650 x 2055	Black PPC Alu Gallow Hight restrictor with 1500x300 max high panel.	Black PPC Alu	2055	N/A	N/A	N/A
Banner Sign	3 (Existing Retained)	5365 x 100 x 2880	Post mounted banner unit. Aluminum side panels in grey RAL 7022 with perforated metal "McDonald's" text.	Grey RAL 7022 PPC Alu	2200	N/A	800	N/A

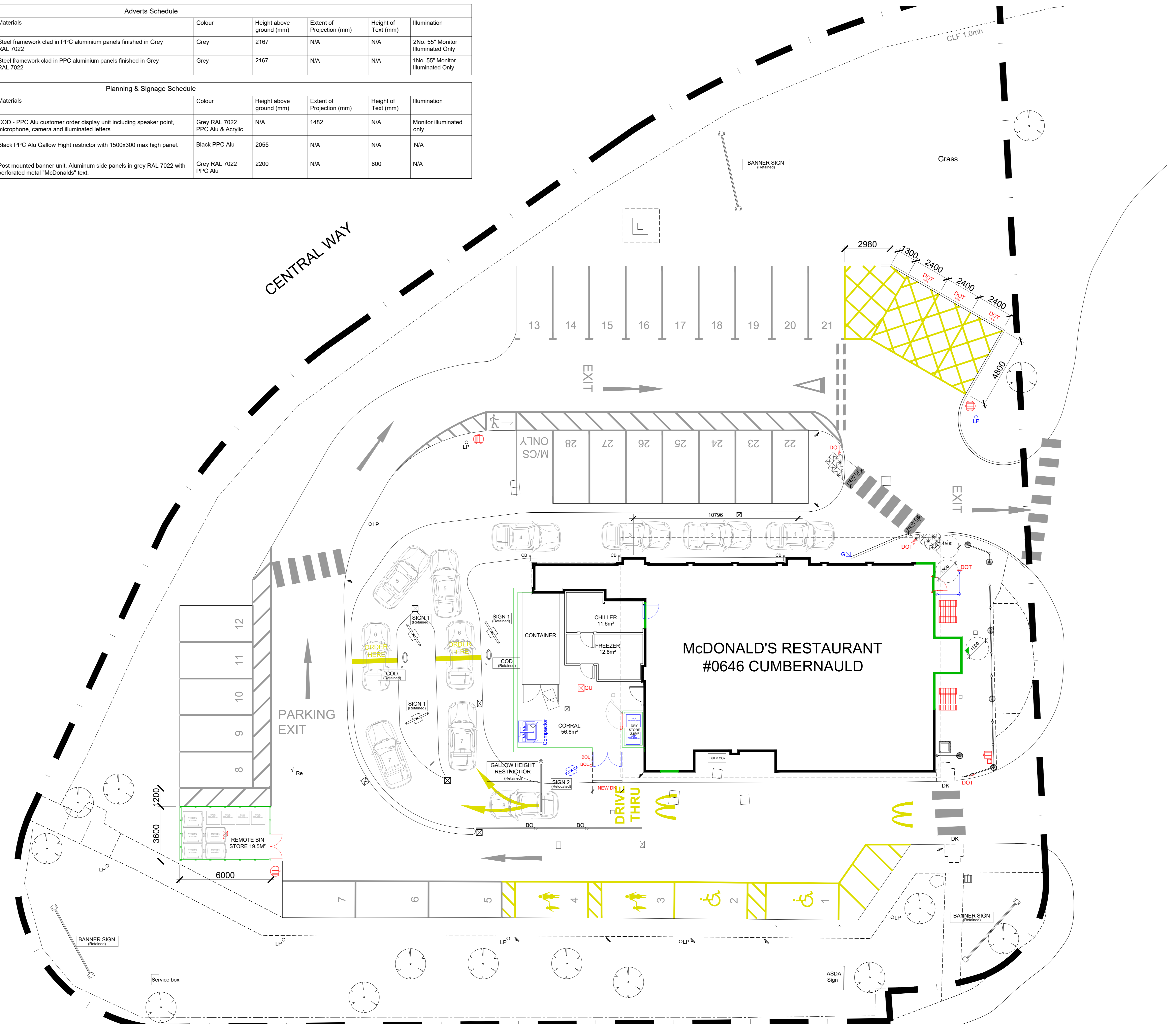

**NOTES**

- All dimensions and levels are to be checked on site.
- Any discrepancies are to be reported to the architect before any work commences.
- This drawing shall not be scaled to ascertain any dimensions. Work to figured dims only.
- This drawing shall not be reproduced without express written permission from AEW.
- Title overlay drawings and ownership boundaries are produced using all reasonable endeavours. AEW cannot be responsible for the accuracy or scale discrepancy of base plans supplied to them.
- All works are to be undertaken in accordance with Building Regulations and the latest British Standards.
- All proprietary materials and products are to be used strictly in accordance with the manufacturers recommendations.

**CDM 2015**

Client notified of duties: **At Design Workshops**  
 Principal Designer: **CSS**

Unless noted below, all known hazards have been highlighted on the drawing.

- Drawing Based on For by Two Consultants Limited As-built Drawing No: 1907/1100; 3d model saved 27/05/2018. CR Proj name A CAD file no: 151876-STL-MCD-00-ORA-A-S1206-McDonalds - Denise Plan
- Scale for planning purposes only.
- Extent of McDonald's Denise Indicated:

**Notes:**  
 All drawings to be read in conjunction with all other drawings as noted on issue sheet.

0 1 2 3 4 5m  
 Scale 1:100  
**PROPOSED SITE ADVERTS PLAN 1:100**

**PLANNING**

19/02/24	LC	MW	
INITIAL ISSUE			
REV	Date	Drawn by -	Checked by -
S2		For Approval	
Drawing Stage		PLANNING	
Client			
McDonald's Restaurants Ltd			
Project			
CUMBERNAULD NORTH LANARKSHIRE 0646 G67 1NF			
Drawing title			
PROPOSED SITE ADVERTS PLAN			
Date	19/02/2024	Drawn	LC
Scale	1:100	Checked	MW

Job No: **13208\_AEW\_0646\_1008**  
 AEW Architects  
 0185 214 4370  
 www.aewarchitects.com

