

PROPOSED GROUND FLOOR 1:50

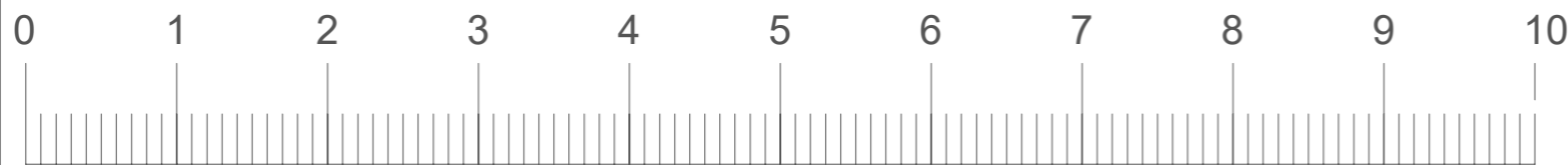

SCALE

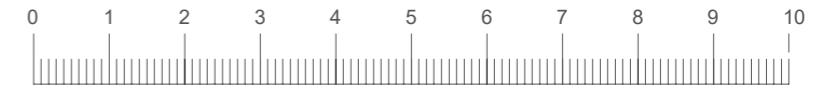

SCALE

VENTILATION

PURGE VENTILATION

Minimum total area of opening in accordance with Table 1.4 Approved Document F1.
 Hinged pivot windows with an opening angle of 15 to 30 degrees to have an openable area in excess 1/10 of the floor area of the room.
 Sash windows, external doors or hinged pivot windows with an opening angle of equal to or greater than 30 degrees to have an openable area in excess of 1/20 of the floor area of the room.
 Purge ventilation should be capable of extracting at least 4 air changes per hour per room directly to the outside.
 Internal doors should be provided with a 10mm gap below the door to aid air circulation.

EXTRACT FOR SHOWER ROOM

Provide mechanical extract ventilation to shower room ducted to external air capable of extracting at a rate of not less than 15 litres per second. Vent to be connected to light switch and to have 15 minute over run if no window in the room. Internal doors should be provided with a 10mm gap below the door to aid air circulation. Ventilation provision in accordance with the Domestic Ventilation Compliance Guide. Intermittent extract fans to BS EN 13141-4. All fixed mechanical ventilation systems, where they can be tested and adjusted, shall be commissioned and a commissioning notice given to the Building Control Body.

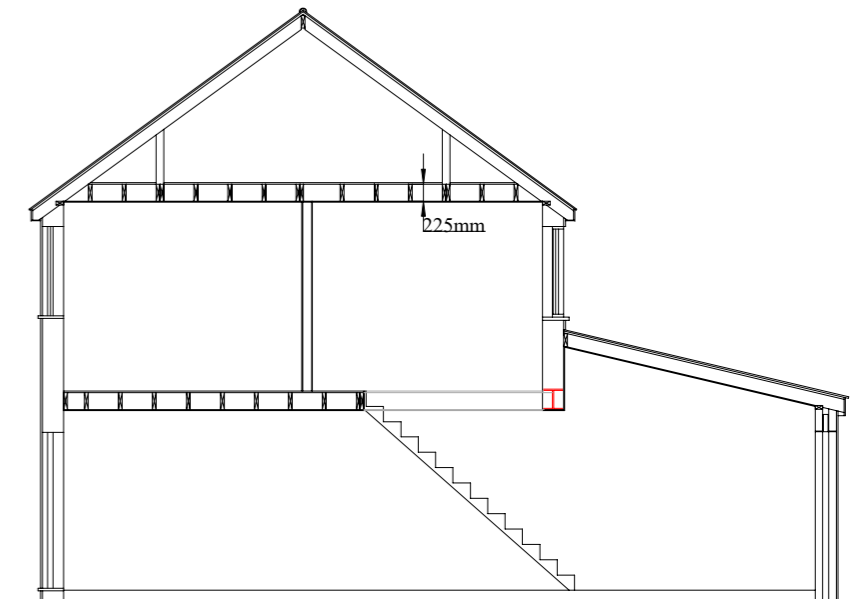

EXISTING SECTION 1:100



THIS DRAWING MUST NOT BE SCALED (Unless for planning authority purposes) PRIOR TO THE COMMENCEMENT OF ANY WORKS THE BUILDER IS TO CHECK AND/OR DETERMINE ALL CONSTRUCTION DETAILS INCLUDING CHECKING EXISTING SITE LEVELS AND DIMENSIONS. THE DRAWING IS TO BE READ IN CONJUNCTION WITH ALL OTHER PROJECT DRAWINGS, CONSTRUCTION NOTES AND/OR PROJECT SPECIFICATION. ALL DISCREPANCIES SHOULD BE REPORTED IMMEDIATELY.

CDM Regulations 2007. Party Wall Act 1996, Clients and contractors are reminded that the project is within the scope of these regulations MBL Associates Ltd engaged as designers will not accept any liability for failure of these parties to carryout their duties as required by these statutes

PLANNING CLIENTS & CONTRACTORS ARE REMINDED THAT IF THE PROJECT REQUIRES AN APPLICATION FOR PLANNING, THIS APPLIES TO PRIOR APPROVAL, LAWFUL DEVELOPMENT APPROVAL, PERMITTED DEVELOPMENT RIGHTS TO RECENTLY BUILT PROPERTY'S AND HOUSES IN CONSERVATION AREAS. MBL ASSOCIATES Ltd WILL NOT BE RESPONSIBLE IF WORKS COMMENCE AGAINST THIS ADVICE AND ENFORCEMENT ACTION IS TAKEN AGAINST YOU. MBL ASSOCIATES Ltd ADVISE THAT ALL CERTIFICATION OF PLANNING APPROVAL HAS BEEN GRANTED BEFORE ANY BUILDING WORK COMMENCES.

ALL STRUCTURAL INFORMATION TO BE IN CONNECTION WITH STRUCTURAL ENGINEERS CALCULATION AND DRAWINGS
 COPYRIGHT MBL ASSOCIATES LIMITED

ADDRESS

176A, Henley Avenue,
 Sutton,
 Greater London
 SM3 9SA

DESCRIPTION

PROPOSED GROUND FLOOR
 EXISTING SECTION

Scale:
 1:100 & 1:50 @ A3

Date:
 22/01/2024

Drawing No

HA176A/003