

Timbervale Sowton Village

Arboricultural Impact Assessment, Tree Protection Plan and Arboricultural Method Statement

Tom Hurley, BSc(For)Hons, MArborA

21st February 2024

Advanced Arboriculture
Venmore Barn
Woodbury
Devon EX5 1LD
t: 01395 239002
e: info@advancedarb.com
w: www.advancedarb.com

The logo for Advanced Arboriculture, featuring a large, stylized letter 'A' that incorporates a tree silhouette within its structure.

Arb Impact Assessment and Tree Protection Statement

Introduction

Heads of Terms

This document provides information for the benefit of the local planning authority and the project team, however, the specific tree protection details are contained within the attached Tree Protection Plan, Arboricultural Method Statement and Arboricultural Guidance Sheets.

The document has been prepared based on information available to Advanced Arboriculture Ltd at the time of writing, however, further technical, topographical, arboricultural, architectural, ecological or engineering information may come to light after the relevant arboricultural conditions have been cleared. It is the responsibility of the project manager to draw any changes in the project scope to our attention at the earliest opportunity.

The scheduling and implementation of the tree protection measures detailed in the report also remains the responsibility of the client. Whilst the project team may appoint a suitably qualified third party arboricultural supervisor, Advanced Arboriculture Ltd are able to take on this role subject to the client's formal instruction.

Advanced Arboriculture Ltd shall not be held liable for any unauthorised deviation from the tree protection measures and scheduling detailed within this report.

Tree Protection Overview

The included Tree Protection Plan and Arboricultural Method Statement detail the tree protection measures required for the proposals, the timing of the provision of tree protection measures, and the retention of a suitably qualified arboricultural supervisor in the event of any accidental damage to the trees.

This document must be reviewed by the client or their delegated project manager and/or site manager with the arboricultural supervisor prior to the commencement of any works to ensure that both the scheduling and protection measures detailed within the Arboricultural Method Statement remain achievable and realistic. Once the Tree Protection Plan and Arboricultural Method Statement Plans have been reviewed and signed off by both the client/site manager and arboricultural supervisor, these drawings must be held on site for ongoing reference and to allow the local planning authority to check them at any reasonable time. Any variations to the Tree Protection Plan or Arboricultural Method Statement must be copied to the local planning authority; in the case of major variations to these documents, written approval may be required.

Arboricultural Impact Assessment

Discussion

The proposed redevelopment of the site at Timbervale shows the demolition of a single, detached bungalow, and its replacement with a new, larger residential property which is stepped into the hillside. The proposals also show the construction of a separate detached store and garage, along with a driveway, parking and landscaping.

The existing property does not feature any trees at all, however, there is a line of stems which comprise area A1 growing on a Devon bank on the opposite side of a little-used agricultural access which runs along the eastern boundary of the site.

Area A1 is a reasonable landscape feature which can be seen from the lane (see photographs 2 and 3 attached). It includes a mix of Oak, Beech, Holly, Sycamore and Laurel, though none of these stems would be considered individually outstanding, with some basal decay noted within the Oaks.

An appraisal of the rooting systems of these trees indicates that the significant majority of the trees' root protection areas are entirely contained within the track, however, where the larger stems' rooting systems extend further to the west, these will be laterally truncated by the boundary wall. The field to the east of area A1 will certainly offer a conducive rooting environment for these trees in perpetuity.

It is clear that there are no rooting or canopy incursion issues presented by A1, and whilst there will be some morning shade cast over the proposed dwelling, this only affects the eastern aspect, with the south-facing frontage remaining unshaded. By midday, the entire dwelling will benefit from full sunlight, noting that the proposed new planting opportunities shown on proposals (and replicated on the Tree Constraints Plan) will allow for pockets of selective shade for future occupants.

All services can be installed without any need for incursion into the trees' root protection areas, and there is a negligible risk of harm to the trees within area A1 during construction, which can be further mitigated by the provision of a section of high-visibility fencing along the boundary to act as a visual reminder for any crane or excavator operatives working nearby.

Conclusions and Recommendations

Overall, the proposals allow for the retention of all of the trees surrounding the site with a negligible risk of any harm as a consequence of construction activities. The site layout is therefore considered to be sustainable from an arboricultural point of view subject to the appropriate care being taken during construction as detailed within the Tree Protection Plan and Arboricultural Method Statement.

Tree Protection Measures Overview

Arboricultural Supervision

An ad-hoc arboricultural inspection programme is shown on the Arboricultural Method Statement Plans. Inspections must be requested by the client, project manager and/or site manager where the project scope changes, or where unforeseen construction activities may present a threat to retained trees on or adjacent to the site. The attached Arboricultural Supervision Record Sheet must be filled in on an ongoing basis and retained on site for inspection by the local planning authority at any reasonable time.

Staff Induction

The Arboricultural Method Statement references the attached Arboricultural Staff Induction Sheet. This must be read, understood and signed by all site operatives, including sub-contractors, as an integral element of their initial site induction. The purpose of this is to minimise the potential for damage to trees during construction.

Protective Fencing

A total of 35 metres of high visibility fencing (see Arboricultural Guidance Sheet AGS105) is shown on the Tree Protection Plan. The purpose of this is to act as a visual demarcation of the construction exclusion zones where there is considered to be a low risk of damage to retained trees from plant, materials or personnel.

All fencing must be erected prior to the commencement of any mobilisation to site by contractors, plant or materials and must remain in situ until all construction works have been completed and approval for removal is granted by the arboricultural supervisor.

Site Organisation

Prior to the commencement of any demolition or construction activities on site, the locations for site offices, welfare facilities, parking, a materials storage area and a concrete/plaster mixing area must be designated and marked on the Tree Protection Plan.

If bonfires are permitted, these must remain at least ten metres from either the construction exclusion zone, root protection area or crown spread of any tree, whichever is closer; this is to minimise any risk of heat damage to either the rooting system or crown of any retained tree.

Demolition of Existing Structures and Surfaces

Care will be required when undertaking demolition works on site. Demolition activities must be informed by the diagrams and information detailed within Arboricultural Guidance Sheet AGS408. A copy of this document must be included within all tender documents to ensure that the appointed contractor factors tree constraints and protection into their workflow and costings.

Services

The location of proposed new services has not been made available to Advanced Arboriculture Ltd at the time of this report's preparation. All services must be routed outside of the root protection areas of all retained trees. Where this is not possible, alternative installation methods must be investigated, including manual digging, directional boring, etc.

Engineering drawings showing the proposed service routes should be forwarded to Advanced Arboriculture Ltd for review prior to the commencement of any ground works or services installation. Advanced Arboriculture is able to forward a PDF or AutoCAD DWG file directly to the project engineers on request showing the accurate locations of the root protection areas.

Hard and Soft Landscaping

Any hard landscaping within the root protection area of any retained trees which includes changes in ground levels (cut or fill), new walls or new paths will require further arboricultural review to ensure that any detrimental impact is limited. If unsustainable damage is considered to be unavoidable then the landscaping scheme will require revision.

Soft landscaping near retained trees, including the planting of new trees and shrubs, must be undertaken with considerable care due to the potential for rooting damage. Mechanical rotovation or cultivation within the construction exclusion zones shown on the Tree Protection Plan must be avoided as this can cause significant damage to the rooting system of adjacent trees.

All new trees must be sourced from a reputable nursery and planted in accordance with the recommendations detailed within British Standard 8545:2014. We are able to provide an independent verification of the quality of new trees prior to planting on request.

Attachments

- Arboricultural Data Tables
- Photographs
- Tree Location Plan
- Tree Constraints Plan
- Tree Protection Plan
- Arb Method Statement Plan
- Arboricultural Induction Sheet
- Arboricultural Supervision Inspection Record
- AGS105 High-Visibility Barrier Fencing
- AGS408 Demolition of Structures and Surfaces Near Trees
- AGS801 Protective Fencing Poster
- AGS802 Site Office Tree Poster

Document Title:

Background Information

Location:

Timbervale Sowton Village

Date:	Project Reference:	Revision:
21.02.2024	TH/B978/0224	1.0
Scale:	Paper Size:	Drawn By:
n/a	A3	TH

Advanced Arboriculture
Venmore Barn
Woodbury
Devon EX5 1LD
t: 01395 239002
e: info@advancedarb.com
w: www.advancedarb.com

Arboricultural Data Tables

Notes

- The categorisation of trees in accordance with British Standard 5837:2012 is a subjective exercise and may be subject to variation when compared with other professionals' evaluations.
- Trees are dynamic structures and advice should be taken on validity two years after the survey was undertaken.
- The survey data may not be considered valid after more than three years.
- The survey has been prepared using all reasonable skill and care.
- Opinions are provided in good faith.

Data Table Fields and Abbreviations

Abbreviations used in the survey are as follows:

Tree No	Corresponding to plan
Species	Common name
Ht	Height in metres
Crown Spread	Crown spread in metres as measured at the four cardinal points of the compass
Stem Dia	Diameter at breast height in mm (1.5 metres above ground level), or measured in accordance with the prescribed British Standard protocol in the case of multi-stemmed specimens (see Annex C in British Standard 5837:2012 for full details)
RPA	Root Protection Area radius in metres (derived from the British Standard 5837:2012 formulae)
Ht to L/B	Crown height in metres as measured to the height of the lowest branch
Dir	Direction from which the lowest branch arises
Cr Ht	Height of crown in metres above ground level
Age Class	<p>Y Young (grown to less than one third of life expectancy)</p> <p>MA Middle Aged (grown to between one to two-thirds of life expectancy)</p> <p>M Mature (grown to over two thirds of normal life expectancy)</p> <p>OM Over Mature</p> <p>V Veteran</p>
SULE	Safe useful life expectancy range in years
Cond	Condition, both physiological and structural: <p>G Good (trees with no significant defects)</p> <p>F Fair (trees with some defects amenable to surgery)</p> <p>P Poor (trees with significant defects)</p>
BS Cat	British Standard 5837:2012 Category (see Cascade Chart adjacent for full details)
m/s	Denotes multistem tree along with the individual stem diameters
#	Denotes estimated value where access was not possible

British Standard 5837:2012 Cascade Chart For Tree Quality Assessment

Category and definition **Criteria (including subcategories where appropriate)**

Trees unsuitable for retention

Category U

Those in such a condition that they cannot realistically be retained as living trees in the context or the current land use for longer than 10 years

Trees that have a serious, irremediable, structural defect, such that their early loss is expected due to collapse including those that will become unviable after removal of other category U trees (e.g. where, for whatever reason, the loss of companion shelter cannot be mitigated by pruning)

Trees that are dead or are showing signs of significant, immediate, and irreversible overall decline
Trees infected with pathogens of significance to the health and/or safety of other trees nearby, or very low quality trees suppressing adjacent trees of better quality

Note: Category U trees can have existing or potential conservation value which it may be desirable to preserve

1. Mainly arboricultural qualities

2. Mainly landscape qualities

3. Mainly cultural values, including conservation

Trees to be considered for retention

Category A

Trees of high quality with an estimated life expectancy of at least 40 years

Trees that are particularly good examples of their species, especially if rare or unusual: or those that are essential components of groups or formal or semi-formal arboricultural features (e.g. the dominant and/or principal trees within an avenue)

Trees, groups or woodlands of particular visual importance as arboricultural and/or landscape features

Trees, groups or woodlands of significant conservation, historical, commemorative or other value (e.g. veteran trees or wood-pasture)

Category B

Trees of moderate quality with an estimated remaining life expectancy of at least 20 years

Trees that might be included in category A, but are downgraded because of impaired condition (e.g. presence of significant though remediable defects, including unsympathetic past management and storm damage), such that they are unlikely to be suitable for retention for beyond 40 years; or trees lacking the special quality necessary to merit the category A designation

Trees present in numbers, usually growing as groups or woodlands, such that they attract a higher collective rating than they might as individuals; or trees occurring as collectives but situated so as to make little visual contribution to a wider locality

Trees, groups or woodlands of significant conservation, historical, commemorative or other value (e.g. veteran trees or wood-pasture)

Category C

Trees of low quality with an estimated remaining life expectancy or at least 10 years, or young trees with a stem diameter below 150mm

Unremarkable trees of a very limited merit or of such an impaired condition that they do not qualify in higher categories

Trees present in groups or woodlands, but without this conferring on them significantly greater collective landscape value; and/or trees offering low or only temporary/transient landscape benefits

Trees with no material conservation or other cultural value

Document Title:

Arboricultural Data Tables

Location:

**Timbervale
Sowton Village**

Date: 21.02.2024 Project Reference: TH/B978/0224 Revision: 1.0

Scale: n/a Paper Size: A3 Drawn By: TH

Advanced Arboriculture
Venmore Barn
Woodbury
Devon EX5 1LD
t: 01395 239002
e: info@advancedarb.com
w: www.advancedarb.com

Ref No.	Species	Height (m)	Cr Sprd (m)	Stem Dia (mm)	RPA Rad (m)	RPA Area (m ²)	LB Ht (m)	Cr Ht (m)	Age Cl	SULE	Cond Phys/ Str	Observations	Recommendations	BS Cat
A1	<ul style="list-style-type: none"> • Oak • Beech • Holly • Sycamore • Laurel 	<17.0	Max: 7.0m	<1040	<12.60	<499	>=0.0	>=0.0	Y-M	>40	F-G/P-G	<ul style="list-style-type: none"> • Line of trees on opposite side of compacted access track running to the east of the proposed development plot • Trees all in third-party ownership • Some basal decay noted in the Oaks • No rooting anticipated to the west of the boundary wall • Laurels are considered to be a British Standard 5837:2012 category C feature while the remaining trees are category B features • Trees form effective landscape feature 	<ul style="list-style-type: none"> • No works required at the present time 	B2



Photograph 1



Photograph 2



Photograph 3

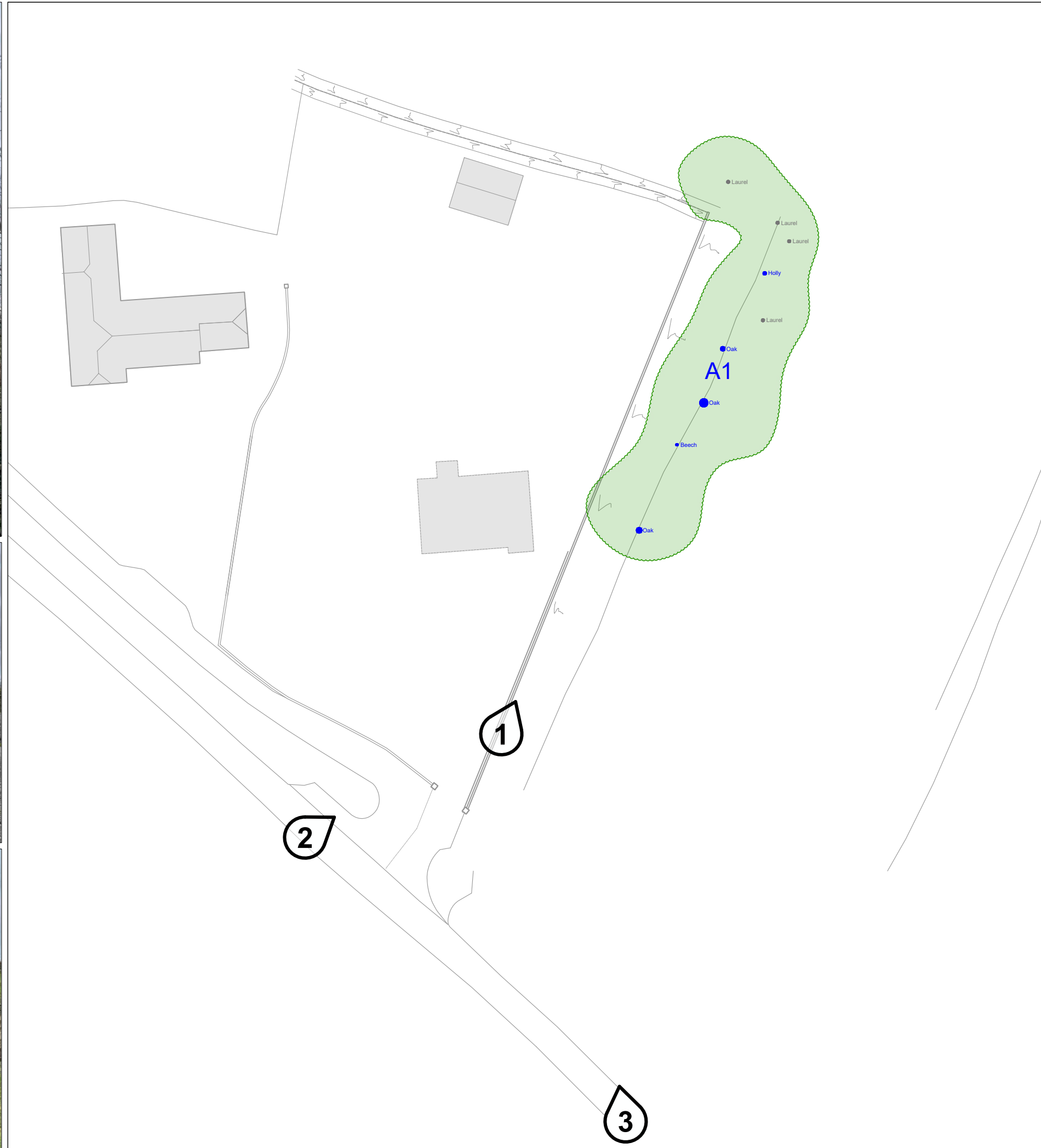

Notes

- Numbers relate to the photographs in the following section.
- Photograph locations and directions are indicative.
- Copies of these photographs in JPEG format are available from Advanced Arboriculture on request.

Drawing Title:

Photographs

Location:

**Timbervale
Sowton Village**

Date:	Project Reference:	Revision:
21.02.2024	TH/B978/0224	1.0
Scale:	Paper Size:	Drawn By:
1:500	A3	TH

Advanced Arboriculture
 Venmore Barn
 Woodbury
 Devon EX5 1LD
 t: 01395 239002
 e: info@advancedarb.com
 w: www.advancedarb.com

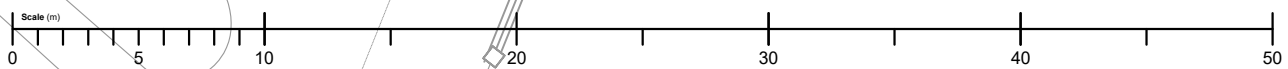

Key

- T_n Category A tree
- T_n Category B tree
- T_n Category C tree
- T_n Category U tree
- Collective crown spreads
- Root protection area
- BS5837:2012 shade path
- Proposed development footprint
- Construction exclusion zone
- High-visibility barrier fencing (see AGS105)



Notes

-

Drawing Title:
Tree Location Plan

Location:
**Timbervale
Sowton Village**

Date:	Project Reference:	Revision:
21.02.2024	TH/B978/0224	1.0
Scale:	Paper Size:	Drawn By:
1:300	A3	TH

Advanced Arboriculture
 Venmore Barn
 Woodbury
 Devon EX5 1LD
 t: 01395 239002
 e: info@advancedarb.com
 w: www.advancedarb.com

Note: The original of this drawing was produced in colour - a monochrome copy should not be relied upon. All drawings © Advanced Arboriculture.

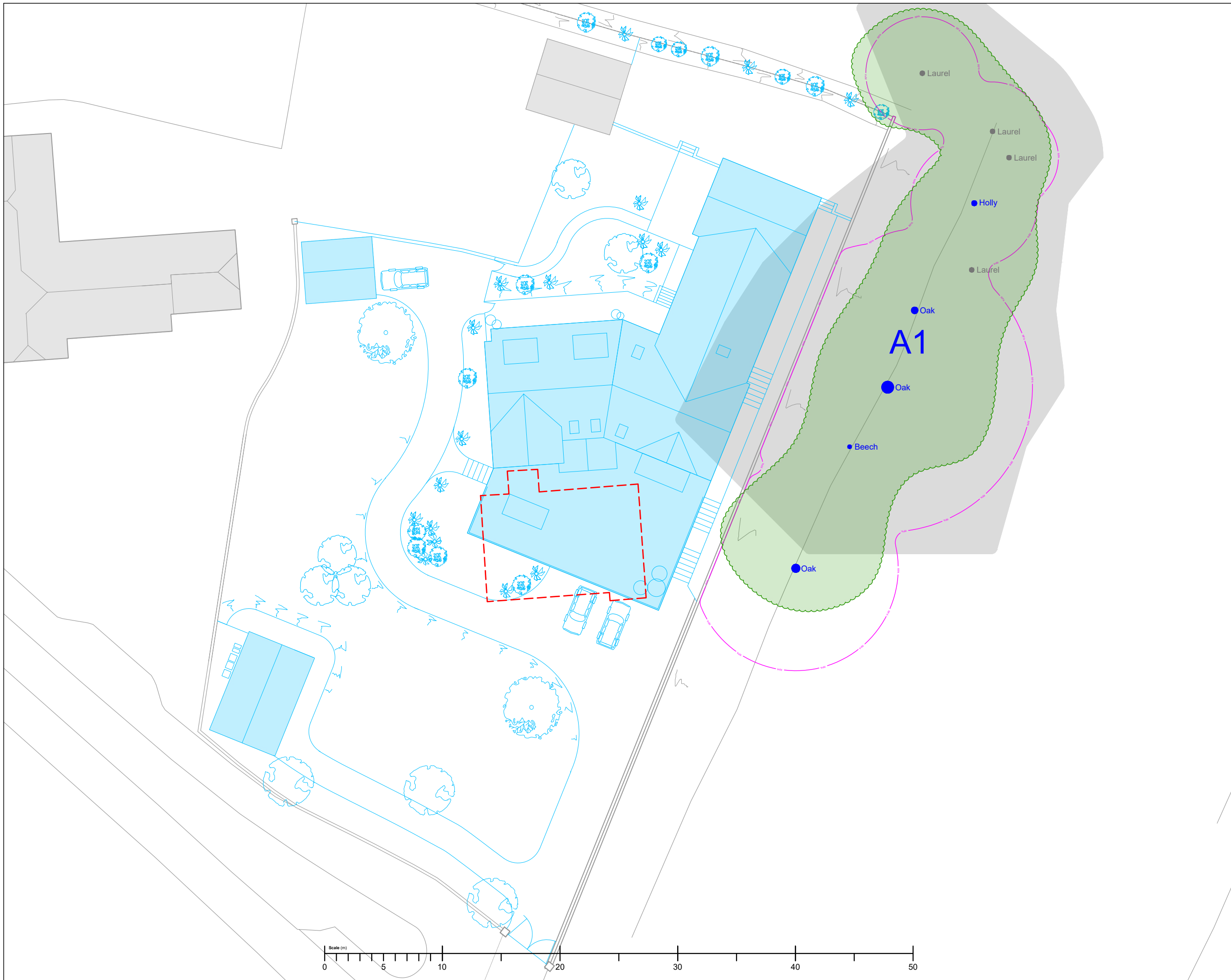

Key

- T_n Category A tree
- T_n Category B tree
- T_n Category C tree
- T_n Category U tree
- Collective crown spreads
- Root protection area
- BS5837:2012 shade path
- Proposed development footprint
- Construction exclusion zone
- High-visibility barrier fencing (see AGS105)

Notes

-

Drawing Title:
Tree Constraints Plan

Location:
**Timbervale
 Sowton Village**

Date:	Project Reference:	Revision:
21.02.2024	TH/B978/0224	1.0
Scale:	Paper Size:	Drawn By:
1:300	A3	TH

Advanced Arboriculture
 Venmore Barn
 Woodbury
 Devon EX5 1LD
 t: 01395 239002
 e: info@advancedarb.com
 w: www.advancedarb.com

Note: The original of this drawing was produced in colour - a monochrome copy should not be relied upon. All drawings © Advanced Arboriculture.

Tree Protection Statement - Key Information

- **Once planning consent has been granted, this Tree Protection Statement is a legally binding document.**
- **All planning conditions must be read and fully implemented, including the arboricultural supervision inspection programme.**
- **Failure to follow the measures detailed within the drawings and method statement can lead to the issue of a Stop Notice or further enforcement action.**
- **The drawings and method statement must be reviewed by the demolition/groundwork/construction/landscape teams to ensure that all works can be completed without encroachment into the Construction Exclusion Zones. If this is not possible then any issues must be raised with Advanced Arboriculture and alternative solutions found.**

Document Downloads:

Scan these QR codes with your mobile device to download PDF versions of the Arboricultural Guidance Sheets referred to within this document.



AGS105



AGS408



AGS901



AGS902



FENCE SIGN



OFFICE SIGN

Advanced Arboriculture
Venmore Barn
Woodbury
Devon EX5 1LD
t: 01395 239002
e: info@advancedarb.com
w: www.advancedarb.com



Key

- T_n Category A tree
- T_n Category B tree
- T_n Category C tree
- T_n Category U tree
- Collective crown spreads
- Root protection area
- BS5837:2012 shade path
- Proposed development footprint
- Construction exclusion zone
- High-visibility barrier fencing (see AGS105)



- ### Notes
- **Protective fencing must not be breached or dismantled at any point during the construction programme without the written consent of the local planning authority.**
 - **Failure to fully comply with this Tree Protection Plan may result in the local planning authority pursuing enforcement action.**
 - **It is the Site Manager's responsibility to ensure that all site personnel, plant and materials remain outside of the Construction Exclusion Zones and protective fencing at all times.**

Drawing Title:
Tree Protection Plan

Location:
**Timbervale
 Sowton Village**

Date:	Project Reference:	Revision:
21.02.2024	TH/B978/0224	1.0
Scale:	Paper Size:	Drawn By:
1:300	A3	TH

Advanced Arboriculture
 Venmore Barn
 Woodbury
 Devon EX5 1LD
 t: 01395 239002
 e: info@advancedarb.com
 w: www.advancedarb.com

Note: The original of this drawing was produced in colour - a monochrome copy should not be relied upon. All drawings © Advanced Arboriculture.

Arboricultural Method Statement

All works to be undertaken sequentially in accordance with the following schedule:

1. Tree Protection Plan and Arboricultural Method Statement to be reviewed and signed off by the Site Manager and Arboricultural Supervisor (see below). Any amendments to be made and a copy of all revised documents sent to the local planning authority as necessary. Signed off copy to be held on file in the site office for the duration of construction works.
2. All site personnel, including sub-contractors, to be advised of tree protection requirements during induction (see Arboricultural Induction Sheet).
3. All tree works to be undertaken in accordance with British Standard 3998:2010.
4. Protective fencing to be installed as per the specification detailed within Arboricultural Guidance Sheet AGS105.
5. Arboricultural supervisor to attend site to inspect tree protection measures prior to the commencement of any construction activities (may be done via Skype/Facetime where practicable).
6. Demolition to be completed in accordance with methodology detailed within Arboricultural Guidance Sheet AGS408.
7. Construction to commence in accordance with approved site layout.
8. Advanced Arboriculture to undertake inspections at key trigger points (see Arboricultural Supervision Inspection Record) along with ad hoc inspections at the request of the site manager or client. All inspections to be logged on the Arboricultural Supervision Inspection Record and any issues to be raised within an Exception Report to the client.
9. Any accidental damage to trees to be reported immediately to Advanced Arboriculture with any necessary remedial works to be agreed with the local planning authority.
10. Fencing to be dismantled only on completion of all construction works and to allow for soft landscaping.
11. Signed copy of this drawing and Arboricultural Supervision Inspection Record to be held on project files on completion of all construction works.



Notes

- The arboricultural supervision requirements are detailed within the attached supervision record but may be further modified by a planning condition.
- The arboricultural supervision schedule must be incorporated into the project programme, ensuring that the arboricultural supervisor is contacted with a minimum of five working days before the identified key trigger points.
- Failure to fully comply with this Arboricultural Method Statement and supervision programme may result in the local planning authority refusing to sign off any tree-related planning conditions, or pursuing enforcement action.
- It is the client's responsibility to appoint an arboricultural supervisor prior to the commencement of the project on site. Advanced Arboriculture Ltd cannot be held liable for any failure to follow this schedule or for non-compliance with the prescribed tree protection measures and method statements.
- The client may appoint any suitably qualified and experienced arboricultural consultant to fulfil the role of arboricultural supervisor, but Advanced Arboriculture Ltd are able to take on this role on request.

Document Review

The Arboricultural Method Statement must be reviewed and signed off by the Site Manager and Arboricultural Supervisor prior to the commencement of works to ensure that it is fit for purpose.

Site Manager: _____
 Arb Supervisor: _____
 Date: _____

Document reviewed?	<input type="checkbox"/>	<input type="checkbox"/>
Issues raised?	<input type="checkbox"/>	<input type="checkbox"/>
Revised document required?	<input type="checkbox"/>	<input type="checkbox"/>

Arboricultural Method Statement Plan

Location:
Timbervale
Sowton Village

Date:	Project Reference:	Revision:
21.02.2024	TH/B978/0224	1.0
Scale:	Paper Size:	Drawn By:
1:300	A3	TH

Advanced Arboriculture
 Venmore Barn
 Woodbury
 Devon EX5 1LD
 t: 01395 239002
 e: info@advancedarb.com
 w: www.advancedarb.com

Tree Protection Information



Trees on this site are legally protected by the Local Planning Authority.

- Planning conditions, Tree Preservation Orders and Conservation Area regulations mean that damage to trees may result in enforcement action and all site works being stopped.



Protective fencing must not be moved or dismantled under any circumstances.

- The protective fencing for the trees is there to protect the trees and their rooting systems.
- The fencing must not be moved for any reason unless it has been approved by the Site Manager and the Arboricultural Supervisor.



The Construction Exclusion Zones are not to be used for any reason.

- These areas are there for a reason: to protect the tree above and below the ground.
- Storage of materials, the mixing of concrete, the fueling of machines, the parking of vehicles, etc. all cause damage to a tree's roots so use a designated zone for these activities.



Trees are not to be used for any purpose - they are there for the future.

- Trees are not to be used as a place to screw signs onto, or as cable supports.
- Fires can do massive damage to trees, both above and below ground, and even some distance away. If a fire is permitted on site, it must be at least ten metres from the nearest branch of any retained tree.



Extra care will always be required when craning or using excavators.

- It's too easy to accidentally swing an excavator boom, HIAB, crane jib or load into the branches or trunk of a tree so extra care is always required.
- Plan all movements carefully, make sure the operator has good visibility and, where possible, use an experienced banksman.



What to do if it all goes wrong?

- Accidents can happen so if a tree is damaged, even only slightly, this must be reported to the Site Manager immediately.
- If the Site Manager is not available then contact Advanced Arboriculture immediately to seek further advice.

All site staff including archaeologists, consultants, contractors, sub-contractors, arborists and landscapers must sign below to confirm that they have read and understood this information

Full Name: _____ Company: _____	Signature: _____ Date: _____	Full Name: _____ Company: _____	Signature: _____ Date: _____
Full Name: _____ Company: _____	Signature: _____ Date: _____	Full Name: _____ Company: _____	Signature: _____ Date: _____
Full Name: _____ Company: _____	Signature: _____ Date: _____	Full Name: _____ Company: _____	Signature: _____ Date: _____
Full Name: _____ Company: _____	Signature: _____ Date: _____	Full Name: _____ Company: _____	Signature: _____ Date: _____
Full Name: _____ Company: _____	Signature: _____ Date: _____	Full Name: _____ Company: _____	Signature: _____ Date: _____
Full Name: _____ Company: _____	Signature: _____ Date: _____	Full Name: _____ Company: _____	Signature: _____ Date: _____
Full Name: _____ Company: _____	Signature: _____ Date: _____	Full Name: _____ Company: _____	Signature: _____ Date: _____
Full Name: _____ Company: _____	Signature: _____ Date: _____	Full Name: _____ Company: _____	Signature: _____ Date: _____
Full Name: _____ Company: _____	Signature: _____ Date: _____	Full Name: _____ Company: _____	Signature: _____ Date: _____
Full Name: _____ Company: _____	Signature: _____ Date: _____	Full Name: _____ Company: _____	Signature: _____ Date: _____

Notes for Site Manager

- **Damage to trees during construction can result in enforcement action, including the local authority issuing Stop Notices or pursuing prosecution for damage to trees covered by a Tree Preservation Order.**
- It is essential that all staff working on site, including contractors, sub-contractors and delivery drivers, are made aware of the tree protection measures in operation on this site.
- It may be necessary to read the sheet out to personnel with limited literacy or language skills.
- Every member of staff must sign this sheet to confirm that they have fully understood the tree protection measures. The sheet must remain on site with the Tree Protection Plan and Arboricultural Method Statement to allow for inspection at any reasonable time by the Arboricultural Supervisor or the Local Planning Authority Arboricultural Officer.
- In the event of any queries, concerns or amendments, please contact Advanced Arboriculture at the earliest opportunity.
- **It is essential that the project has a designated Arboricultural Supervisor. If this role has not been assigned then please contact the client or Project Manager to request authorisation to appoint an Arboricultural Supervisor.**
- **It is the Site Manager's responsibility to ensure that all staff are fully inducted, that all tree protection measures are installed and maintained correctly, and that the scheduling detailed within the Arboricultural Method Statement is followed.**

Arboricultural Supervisor

(unless otherwise instructed)

Name: Tom Hurley
Company: Advanced Arboriculture
Tel: 01395 239002
Mobile: 07967 384910
Email: th@advancedarb.com

Drawing Title:

Arboricultural Site Induction Sheet

Location:

**Timbervale
Sowton Village**

Date:	Project Reference:	Revision:
21.02.2024	TH/B978/0224	1.0
Scale:	Paper Size:	Drawn By:
n/a	A3	TH

Advanced Arboriculture

Venmore Barn
Woodbury
Devon EX5 1LD
t: 01395 239002
e: info@advancedarb.com
w: www.advancedarb.com

Arboricultural Supervision Inspection Record

Notes for Site Manager

- Where arboricultural supervision is included as a condition of a planning consent, there is a legal obligation to ensure that it is complied with in full.
- It is the site manager's responsibility to ensure that the arboricultural supervisor is appointed and inspections commissioned as per the planning consent. Failure to comply with the prescribed arboricultural supervision requirements remains the responsibility of the client.
- Reasons for requesting additional ad hoc inspections may include accidental damage to trees, an amendment to proposals, or to clarify a detail on the Tree Protection Plan or Arboricultural Method Statement. The Arboricultural Supervisor shall make every effort to attend site within 48 hours of receiving a request from the Site Manager.
- Inspections at key trigger points may coincide with scheduled inspections
- Local planning authority officers may ask to see the completed Arboricultural Supervision Inspection Record at any reasonable time.
- Any issues raised during an inspection may require the Arboricultural Supervisor to prepare an Exception Report detailing remedial works or actions; these must also be kept on file in the site office.
- On completion of all construction works, a copy of this completed document must be sent to the local planning authority by the Arboricultural Supervisor to discharge the relevant conditions of the planning consent.

Inspection Trigger Point Stages

The following project stages will trigger the need for an inspection by the arboricultural supervisor (tick all that apply):

- A Tree Protection Statement review
- B Tree protection inspection
- C Pre-site-enabling inspection*
- D Pre-demolition inspection
- E Pre-groundworks inspection
- F Pre-construction inspection
- G Mid-construction inspection**
- H Construction completion inspection
- I Pre-landscaping inspection
- J Project completion inspection
- S Scheduled inspections
- X Ad-hoc inspection (client request)
- Y Ad-hoc inspection (LPA request)
- Z Unannounced inspection

Note:

The number of inspections will be determined during the preparation of the Tree Protection Statement based on anticipated risk of harm to trees. These trigger points may be modified by the local planning authority and included as a condition of any planning consent.

- * Site enabling includes construction of access routes, site compound setup, materials storage setup, etc.
- ** Timing of mid-construction to be defined at Tree Protection Statement Review stage

Tree Protection Statement Review

Date: _____

Inspector: _____

Meeting: On-site
On-line

Consultees: Client
Architect
Project Engineer
Project Manager
Site Manager
Demolition Contractor
Groundworks Contractor
Landscape Contractor
LPA Tree Officer

Others: _____
(Please specify)

Comments: _____

Planning conditions checked? Yes No

All concerns addressed/resolved? Yes No

Tree issues? Yes No

Fencing issues? Yes No

Document revision required? Yes No

Inspection Record

Stage (see trigger points): _____

Date: _____

Inspector: _____

Meeting: On-site
On-line

Comments: _____

All concerns addressed/resolved? Yes No

Tree issues? Yes No

Fencing/ground protection issues? Yes No

Document revision required? Yes No

Inspection Record

Stage (see trigger points): _____

Date: _____

Inspector: _____

Meeting: On-site
On-line

Comments: _____

All concerns addressed/resolved? Yes No

Tree issues? Yes No

Fencing/ground protection issues? Yes No

Document revision required? Yes No

Inspection Record

Stage (see trigger points): _____

Date: _____

Inspector: _____

Meeting: On-site
On-line

Comments: _____

All concerns addressed/resolved? Yes No

Tree issues? Yes No

Fencing/ground protection issues? Yes No

Document revision required? Yes No

Inspection Record

Stage (see trigger points): _____

Date: _____

Inspector: _____

Meeting: On-site
On-line

Comments: _____

All concerns addressed/resolved? Yes No

Tree issues? Yes No

Fencing/ground protection issues? Yes No

Document revision required? Yes No

Inspection Record

Stage (see trigger points): _____

Date: _____

Inspector: _____

Meeting: On-site
On-line

Comments: _____

All concerns addressed/resolved? Yes No

Tree issues? Yes No

Fencing/ground protection issues? Yes No

Document revision required? Yes No

Inspection Record

Stage (see trigger points): _____

Date: _____

Inspector: _____

Meeting: On-site
On-line

Comments: _____

All concerns addressed/resolved? Yes No

Tree issues? Yes No

Fencing/ground protection issues? Yes No

Document revision required? Yes No

Inspection Record

Stage (see trigger points): _____

Date: _____

Inspector: _____

Meeting: On-site
On-line

Comments: _____

All concerns addressed/resolved? Yes No

Tree issues? Yes No

Fencing/ground protection issues? Yes No

Document revision required? Yes No

Inspection Record

Stage (see trigger points): _____

Date: _____

Inspector: _____

Meeting: On-site
On-line

Comments: _____

All concerns addressed/resolved? Yes No

Tree issues? Yes No

Fencing/ground protection issues? Yes No

Document revision required? Yes No

Inspection Record

Stage (see trigger points): _____

Date: _____

Inspector: _____

Meeting: On-site
On-line

Comments: _____

All concerns addressed/resolved? Yes No

Tree issues? Yes No

Fencing/ground protection issues? Yes No

Document revision required? Yes No

Project Completion Inspection (Stage H)

Date: _____

Inspector: _____

Meeting: On-site
On-line

Comments: _____

All concerns addressed/resolved? Yes No

Tree issues? Yes No

Fencing/ground protection issues? Yes No

Document revision required? Yes No

Arboricultural Supervisor

(unless otherwise instructed)

Name: Tom Hurley
Company: Advanced Arboriculture
Tel: 01395 239002
Mobile: 07967 384910
Email: th@advancedarb.com

Arboricultural Supervision Log

Location: **Timbervale Sowton Village**

Date: 21.02.2024 Project Reference: TH/B978/0224 Revision: 1.0

Scale: n/a Paper Size: A3 Drawn By: TH

Advanced Arboriculture
 Venmore Barn
 Woodbury
 Devon EX5 1LD
 t: 01395 239002
 e: info@advancedarb.com
 w: www.advancedarb.com

Notes

- These specifications are for guidance only.
- A check for underground services must be completed before driving any stakes into the ground. Where underground services may prevent safe use of stakes driven into the ground, consent must be sought from the local planning authority for the use of rigid plastic construction barriers or a water-filled plastic barrier block system.
- This information must accompany all tender documents to enable contractors to include tree protection measures in their costings.
- Local planning authority consent for these specifications cannot be assumed and must be sought prior to commencement of any construction works.

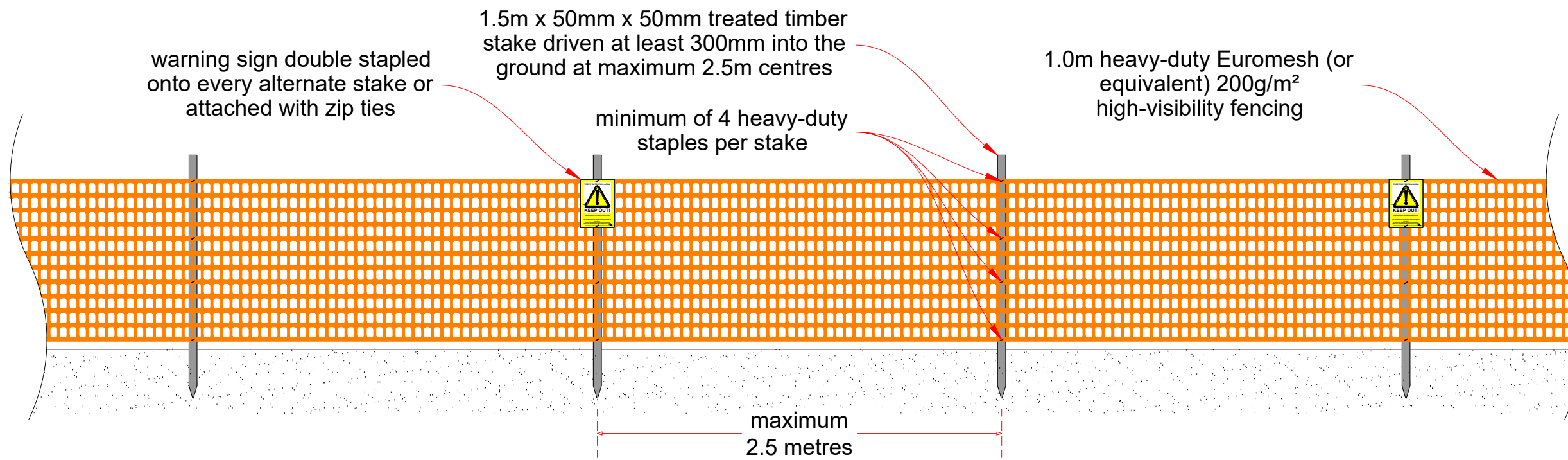

High-Visibility Barrier Fencing

Date:	Drawing Number:	Revision:
01.02.2021	AGS105	2.0
Scale:	Paper Size:	Drawn By:
1:30	A3	TH

Advanced Arboriculture
Venmore Barn
Woodbury
Devon EX5 1LD
t: 01395 239002
e: info@advancedarb.com
w: www.advancedarb.com

Demolition Zone Working Directions

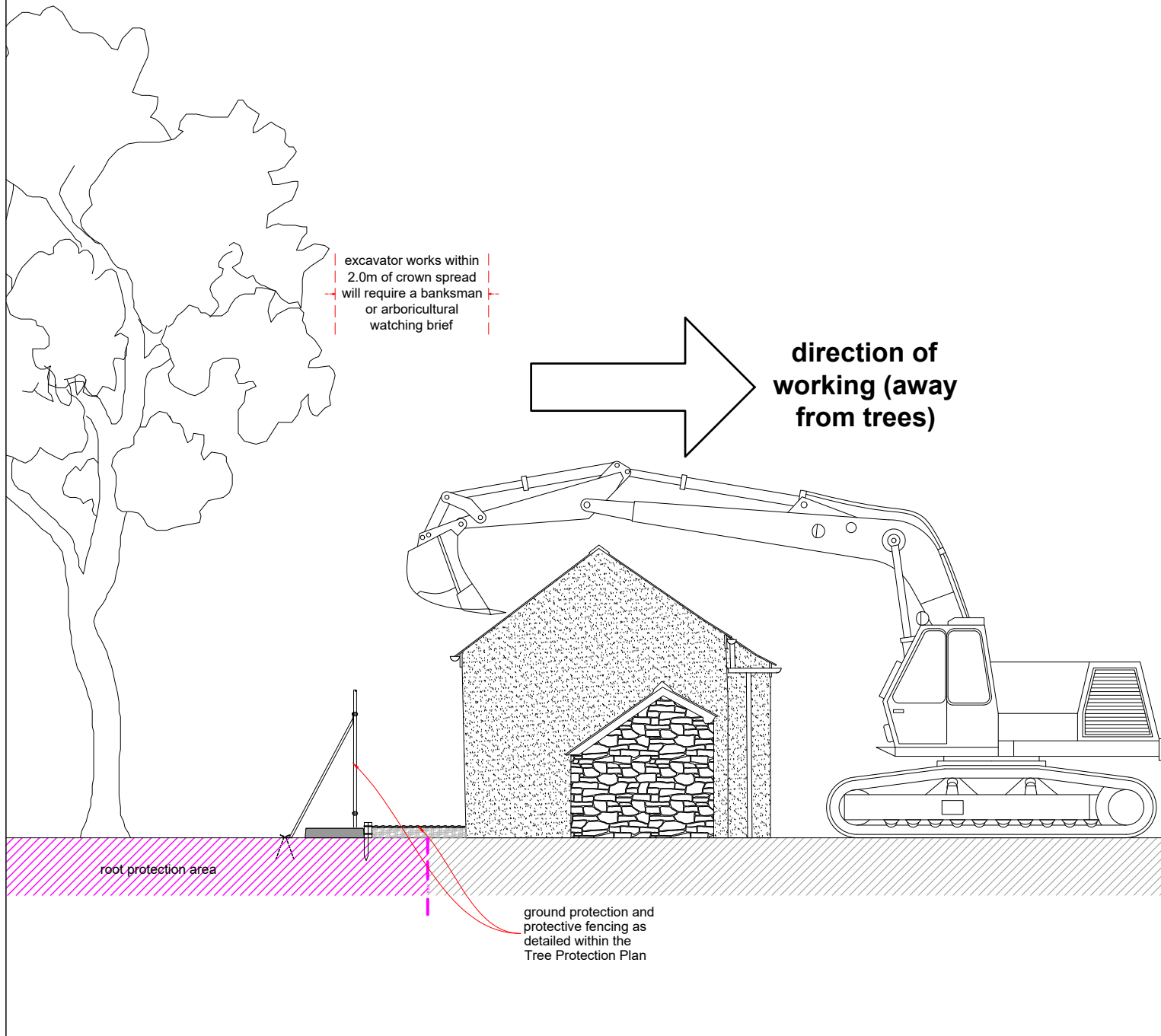

Removal of Hard Surfaces Near Trees

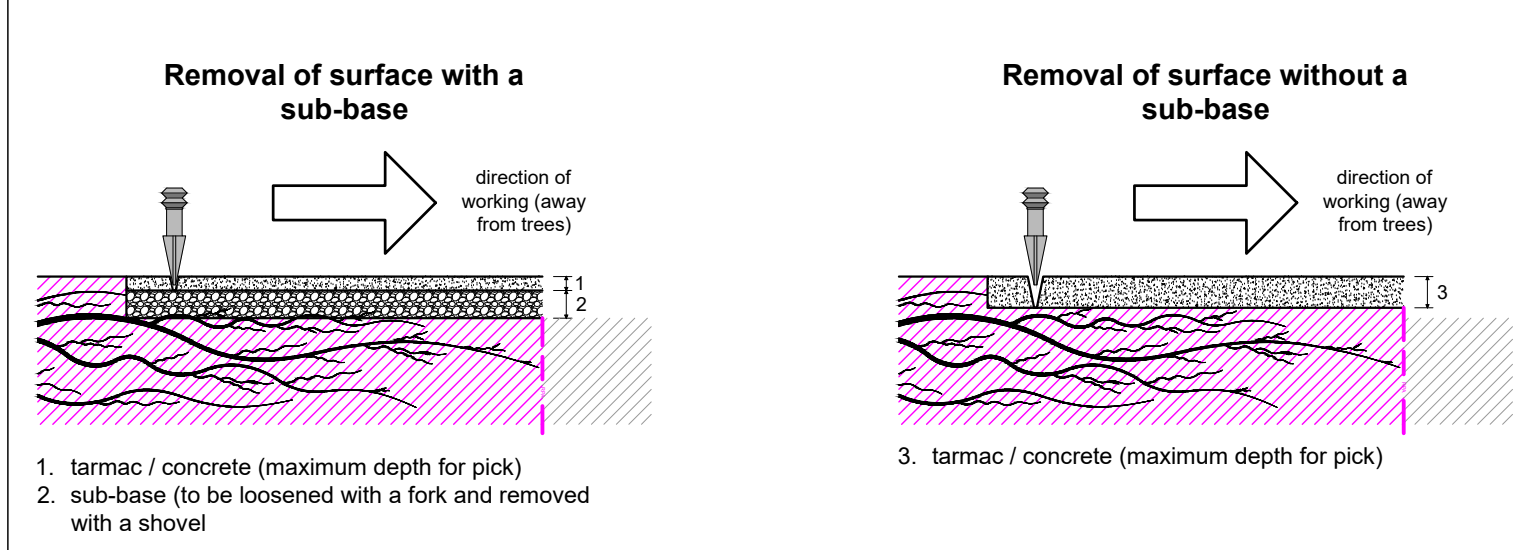

1. tarmac / concrete (maximum depth for pick)
2. sub-base (to be loosened with a fork and removed with a shovel)

3. tarmac / concrete (maximum depth for pick)

Mechanical Plant Operations Near Trees

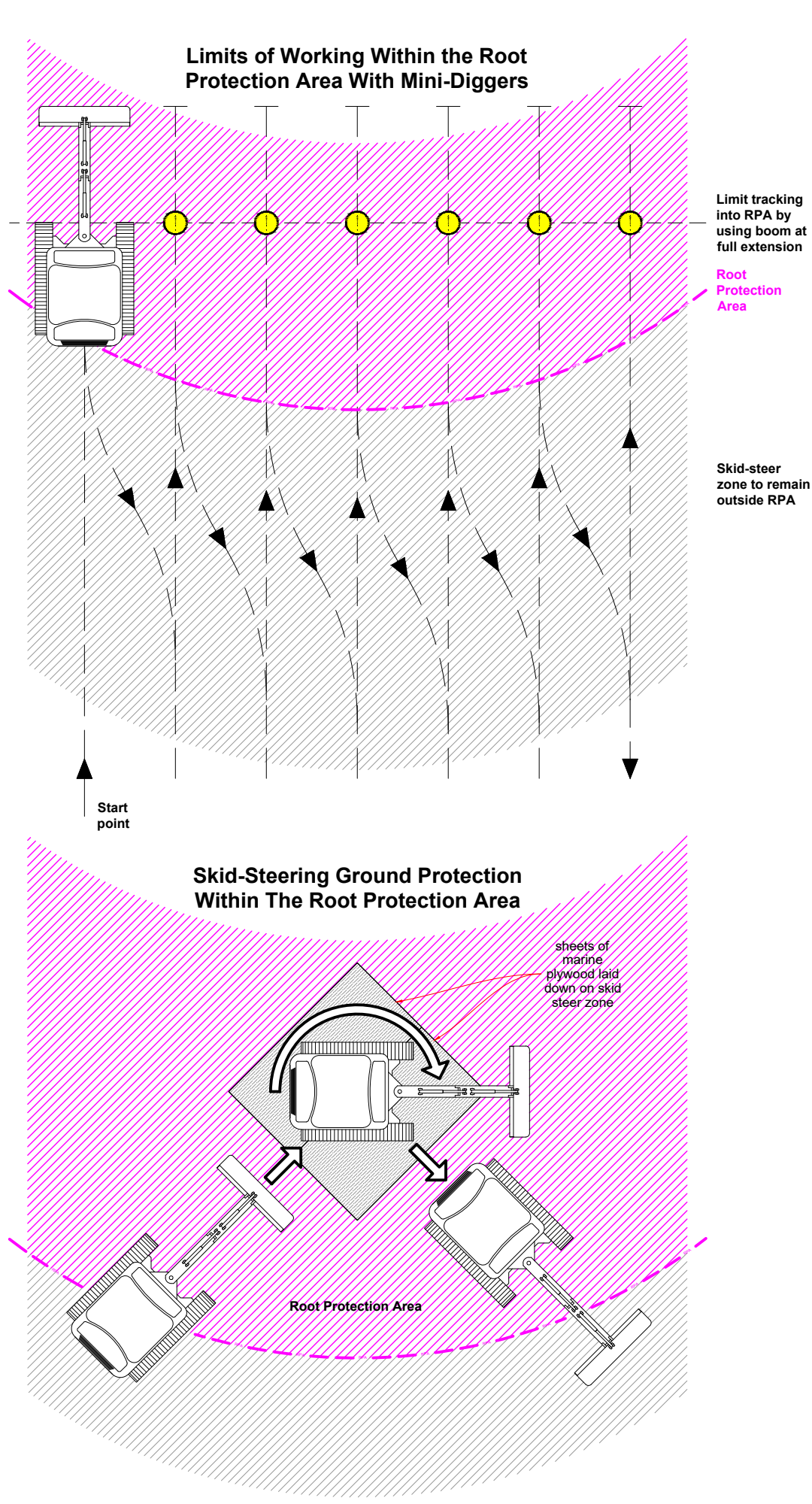

- Notes**
- These specifications are for guidance only and must be reviewed by the Project Manager, Demolition Contractor and Arboricultural Supervisor prior to commencement of any works on site.
 - This information must accompany all tender documents to enable contractors to include for specific working requirements in their costings.
 - Local planning authority consent for these specifications cannot be assumed and may need to be sought prior to commencement of any demolition works.

- Site Organisation**
1. All works to be undertaken from outside of the root protection areas.
 2. Tree protection measures to be installed prior to mobilisation to site by demolition contractors.
 3. Any excavator or crane works within 2.0m of the crown spread of retained trees will require an experienced banksman or arboricultural watching brief.
 4. Structures to be demolished in opposite direction from retained trees.
 5. All arisings to be stored outside of the root protection areas in a location that allows rubble, etc. to be collected without unnecessary HGV movements across any root protection areas.
 6. Any crushed rubble piles to be located so that fine particles cannot be carried towards root protection areas by rainfall.
 7. All hard surfacing within root protection areas to be removed as detailed, working away from retained trees.

- Arboricultural Method Statement**
1. All permitted tree works, including access facilitation pruning or felling, to be undertaken as per permitted tree works specification and in accordance with BS3998:2010 and any relevant ecological legislation.
 2. Ground protection measures (as detailed within the Tree Protection Plan) which may include protective fencing, ground protection, signage, or other elements to be installed prior to demolition contractor mobilising to site.
 3. Layout of site for demolition to be set out as agreed with Arboricultural Supervisor
 4. Schedule of demolition to be agreed with Arboricultural Supervisor to allow for pre-booking of arboricultural watching brief if required.
 5. Demolition works to commence as agreed.
 6. Arboricultural Supervisor to undertake ad hoc inspections at the request of the site manager or client. All inspections to be logged on the Arboricultural Supervision Inspection Record and any issues to be raised within an Exception Report to the client.
 7. Any accidental damage to trees to be reported immediately to Advanced Arboriculture with any necessary remedial works to be agreed with the local planning authority.

Drawing Title:
Demolition of Structures and Surfaces Near Trees

Date:	Drawing Number:	Revision:
13.10.2021	AGS408	1.0
Scale:	Paper Size:	Drawn By:
n/a	A3	TH

Advanced Arboriculture
 Venmore Barn
 Woodbury
 Devon EX5 1LD
 t: 01395 239002
 e: info@advancedarb.com
 w: www.advancedarb.com

TREE PROTECTION AREA



KEEP OUT

(TOWN AND COUNTRY PLANNING ACT 1990)

TREES ENCLOSED BY THIS FENCE ARE LEGALLY PROTECTED BY PLANNING CONDITIONS AND MAY BE THE SUBJECT OF A TREE PRESERVATION ORDER.

ANY INCURSION INTO THE PROTECTED AREA MUST HAVE THE WRITTEN PERMISSION OF THE LOCAL PLANNING AUTHORITY.

IN CASE OF ANY DAMAGE TO PROTECTIVE FENCING OR TREES, CALL ADVANCED ARBORICULTURE ON 01395 239002.

Advanced Arboriculture • www.advancedarb.com • office@advancedarb.com • 01395 239002

Notes

This poster may be printed out and laminated or requested electronically as an A4 PDF or ready printed on laminated board.

Printing Instructions (A4 printing only):

- For the best results, this document should be printed using a colour laser printer and laminated.
- Open this file in Adobe Acrobat Reader or Acrobat Pro.
- Select *File > Print*.
- Choose the printer and make sure it is set to print on A4 paper.
- Under *Size Options*, choose "Actual size".
- Under *Orientation*, choose "Portrait".
- Select *Print*.

Electronic Copies:

- This document may be downloaded directly from the Advanced Arboriculture website using the following links:

A4: <http://www.advancedarb.com/download/A4.pdf>

A3: <http://www.advancedarb.com/download/A3.pdf>

These documents may only be used for projects where Advanced Arboriculture have been appointed as the arboricultural supervisors.

All documents are © Advanced Arboriculture.

Arboricultural Supervisor

(unless otherwise instructed)

Name: Tom Hurley
Company: Advanced Arboriculture
Tel: 01395 239002
Mobile: 07967 384910
Email: th@advancedarb.com

Drawing Title:

Protective Fencing Poster

Date:	Drawing Number:	Revision:
01.02.2021	AGS801	1.0
Scale:	Paper Size:	Drawn By:
n/a	A3	TH

Advanced Arboriculture
Venmore Barn
Woodbury
Devon EX5 1LD
t: 01395 239002
e: info@advancedarb.com
w: www.advancedarb.com

CAUTION



PROTECTED TREES ON SITE

- DO NOT ENTER TREE PROTECTION FENCING
- ALWAYS USE DESIGNATED STORAGE, MIXING AND PARKING AREAS
- TAKE ADDITIONAL CARE WHEN DRIVING HIGH SIDED VEHICLES
- ALWAYS USE A BANKSMAN WHEN USING HIABS, CRANES AND EXCAVATORS NEAR TREES

REPORT ANY TREE DAMAGE TO SITE MANAGER IMMEDIATELY

Notes

The poster must be put up on the site office board and in the workforce welfare facilities at the commencement of construction and must remain clearly visible for the duration of the project.

The Site Manager must enter their name and mobile telephone number in the box on the poster. In the event of any accidental damage to any trees (including rooting damage), the Site Manager must contact the Arboricultural Supervisor immediately to seek further advice.

This poster may be printed out and laminated or requested electronically as an A4 PDF or ready printed on laminated board.

Printing Instructions (A4 printing only):

- For the best results, this document should be printed using a colour laser printer and laminated.
- Open this file in Adobe Acrobat Reader or Acrobat Pro.
- Select *File > Print*.
- Choose the printer and make sure it is set to print on A4 paper.
- Under *Size Options*, choose "Actual size".
- Under *Orientation*, choose "Portrait".
- Select *Print*.

Electronic Copies:

- This document may be downloaded directly from the Advanced Arboriculture website using the following links:

A4: <http://www.advancedarb.com/download/siteposterA4.pdf>
A3: <http://www.advancedarb.com/download/siteposterA3.pdf>

These documents may only be used for projects where Advanced Arboriculture have been appointed as the arboricultural supervisors.

All documents are © Advanced Arboriculture.

Arboricultural Supervisor

(unless otherwise instructed)

Name: Tom Hurley
Company: Advanced Arboriculture
Tel: 01395 239002
Mobile: 07967 384910
Email: th@advancedarb.com

Drawing Title:

Site Office Tree Poster

Date:	Drawing Number:	Revision:
01.02.2021	AGS802	1.0
Scale:	Paper Size:	Drawn By:
n/a	A3	TH

Advanced Arboriculture
Venmore Barn
Woodbury
Devon EX5 1LD
t: 01395 239002
e: info@advancedarb.com
w: www.advancedarb.com