

NOTE - Detailed design of extract ventilation system and air intake system by Specialist sub-contractor. Layout shown on drawing is indicative only.

DELTA BRAVO GROUP LTD NOTES:
 Proposed plans & elevations have been prepared on the basis of measured survey 50399YOLS 01 provided by Survey Solutions to Delta Bravo Ltd.
 Delta Bravo Ltd accept no liability for the accuracy or completeness of the original drawings. "As-built" unit must be checked against the drawings prior to any works.
 Delta Bravo Group Ltd copyright. This drawing shall not be reproduced without express written permission from DBG.
 Delta Bravo Group accept no responsibility or liability for drawing alterations carried out by others and have not checked such alterations. This drawing shall not be scaled to ascertain any dimensions. Asbestos survey required prior to commencement.
 Contractor/Structural Engineer to confirm load bearing walls.

- Existing external walls insulated internally to achieve U value max 0.3W/sqm2 K- TBC on site
- USB - Exlg beams/bulkheads to be retained
- New internal walls : 70mm track + stud, x1 layer 12.5mm plasterboard each side, taped and jointed.
- New perimeter walls : 50mm track + stud, x1 layer 12.5mm plasterboard, taped and jointed.

**GROSS INTERNAL FLOOR AREA
135m² [1453.13ft²]**

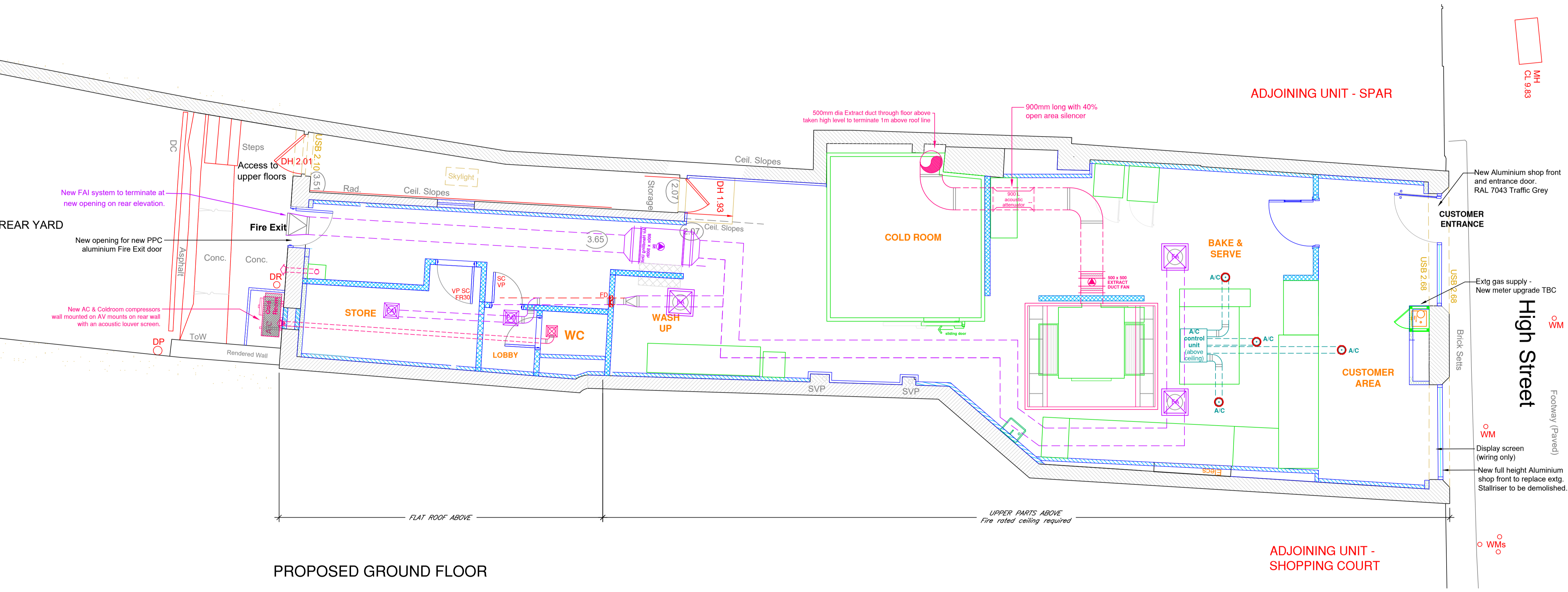
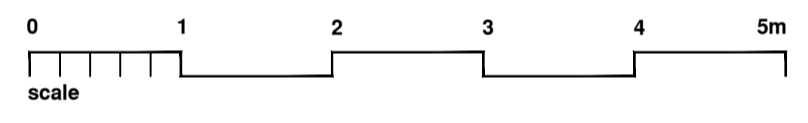
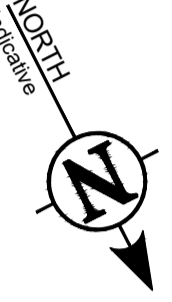

PROPOSED GROUND FLOOR

A	Assted abstractor/denoter as built		14.02.24
REV	AMENDMENT	DATE	

NOTES:
 CONTRACTORS MUST VERIFY ALL DIMENSIONS ON SITE BEFORE COMMENCEMENT OF ANY WORK OR PREPARING MANUFACTURING DRAWINGS
 ANY DISCREPANCIES ON THIS DRAWING ARE TO BE NOTIFIED TO THE DESIGNER IMMEDIATELY



CLIENT	THE MSG GROUP	
PROJECT	86 High St, Honiton, EX14 1JN	
TITLE	PROPOSED GROUND FLOOR PLAN	
SCALE @ A1	DRAWN BY	DATE
1:50	M W	19.06.23
DRAWING No	REVISION	
DB500- A504	A	