

Explanation of Landscape & Environmental Labels

XXXXXX - EFX/EFY/EFZ	Mitigation ID (Planting plot no.)	
	Environmental function (primary function listed first - See table below for codes)	
Code	Sub-code	Function
EFA		Visual Screening
EFB		Landscape Integration
EFC		Enhancing the Built Environment
EFD		Nature Conservation and Biodiversity
	EFD-1	Nature Conservation and Biodiversity - Habitat connectivity
	EFD-2	Nature Conservation and Biodiversity - Habitat creation
	EFD-3	Nature Conservation and Biodiversity - Habitat enhancement
	EFD-4	Nature Conservation and Biodiversity - Habitat compensation
	EFD-5	Nature Conservation and Biodiversity - Watercourse realignment
	EFD-6	Nature Conservation and Biodiversity - Habitat retention
EFE		Visual Amenity
EFF		Heritage
EFG		Auditory Amenity
EFH		Water Quality

Species Function Codes

Code	Group
-1	Bats
-2	Great Crested Newt
-3	Birds
-4	Otter
-5	Water Vole
-6	Badger
-7	Invertebrates
-8	Reptiles
-9	Early Works Contractor (EWC)

Ecology Table

Category	Number
Amphibian and Reptile Structure	1
Badger Sett Structure	0
Bat Structure	0
Bird Nesting Structure	0
Dormhouse Structure	0
Invertebrate Structure	1
Otter Holt Structure	0
Other Structure	0

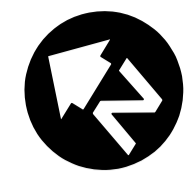

Birmingham ←

London →

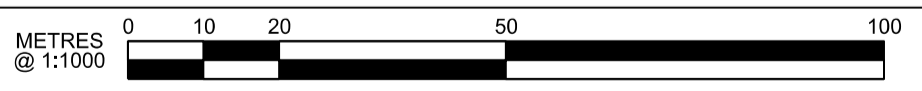
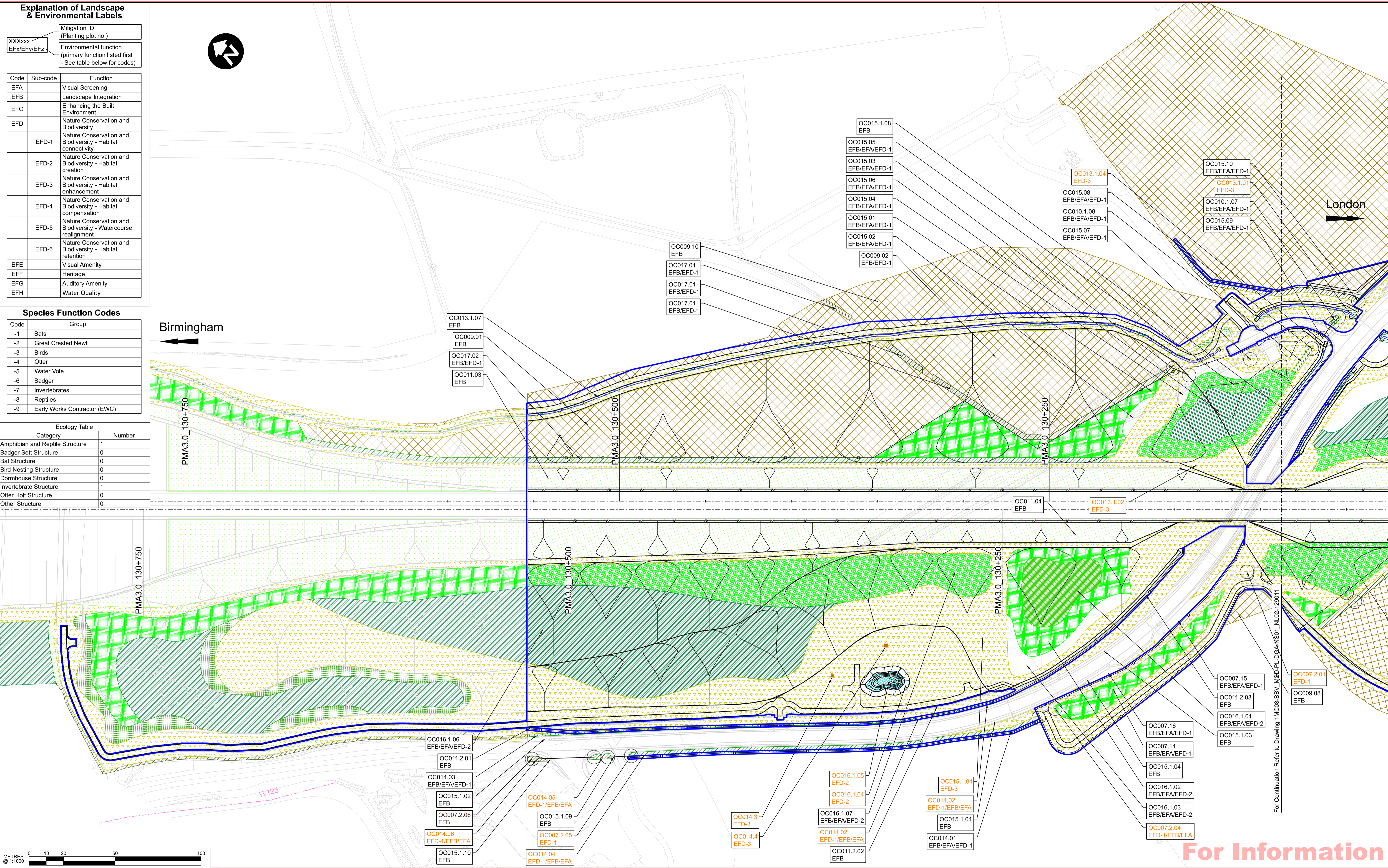

For Information

Rev	Description	Drawn	Checked	Approved	Con.App	Scale with caution as distortion can occur.
C02	For Information	SBAR	JDGR	NBEA	RCOX	15/02/24
P04	For Information	SBAR	JDGR	NBEA	---	---
P03	For HS2 Acceptance	SBAR	SGAI	NBEA	---	---
P02	For HS2 Acceptance	SBAR	SGAI	JMBO	---	---
C01	For HS2 Acceptance	NDUN	SGAI	JMBO	EJOH	11/08/22

Legends/Notes:

- Asset Boundary within Act
- Ecological Mitigation Site
- Line-side Vegetation Zone of Influence
- Program Asset(s) Boundary
- Ecological Asset(s) Boundary
- Line-side Vegetation Zone of Influence
- Existing Tree
- Existing Tree Group
- Existing Woodland
- Existing Hedgerow
- Existing Ancient Woodland
- Existing Pond
- Existing Public Right of Way
- Proposed Public Right of Way
- Proposed HS2 Corridor
- Limit of Land to be Acquired or Used
- Noise Barrier
- Permanent Boundary Fence
- Permanent Security Fence
- Security-Ecological Fence
- Ecological Fence
- Gate
- Drainage Pipe
- Drainage Ditch
- Contour Lines - Existing and proposed
- Bat Structure
- Invertebrate Structure
- Dormouse Structure
- Badger Sett Structure
- Bird Nesting Structure
- Other Holt Structure
- Amphibian & Reptile Structure
- Other Structure

Registered in England: Registration No. 06791686
Registered office: 2 Snow Hill, Queensway, Birmingham, B4 6GA

Official

Creator/Originator
Balfour Beatty VINCI

Project/Contract (N1) Long Itchington Wood Tunnel to Birmingham Interchange Station			
Zone Ufton To Cubbington	Drawn SBAR	Checked JDGR	Approved NBEA
Drawing Title Grand Union Canal Embankment HS2 Consent ID: WAC.PS.10039 Landscaping and Environmental Masterplan Sheet 2 of 2 Schedule 17	Date 07/02/24	Scale 1:1000	Size A1
Deliverable Yes (MIDP)	Gate DD	Submittal S2	Rev. C02
Drawing No. 1MC08-BBV_MSD-PL-DGA-NS01_NL02-129012			

This document is issued for the party who commissioned it and for specific purposes connected with the captioned project only. It should not be relied upon by any other party or used for any other purpose. We accept no responsibility for the consequences of this document being relied upon by any other party, or being used for any other purpose, or containing any error or omission which is due to an error or omission in data supplied to us by other parties.