

ELEVATIONS @1:100

- Structural Works Notes:**
- For beam and block floors, the final beams must be installed end-to-end to avoid floor blocks being visible externally. Therefore a pier in the footings at either end is required, to support the beam ends.
 - Reinforced Concrete shall be a minimum of RC35 to BS8500 Part 1 and BS EN 206-1.7
 - Mesh reinforcement shall be deformed Type 2 high yield steel to BS4483. Minimum lap = 450mm.
 - All concrete to be cured and protected from frost for a minimum of 7 days after casting.
 - The ground is to be stripped of topsoil, vegetation and unsuitable fill before the raft construction begins.
 - Where ground levels are being considered to be raised with site arising fill material placed below the raft foundations, site material is to be tested to determine the material classification in accordance with Table 6/1 of Specification of Highway Works (Vol 1) by suitably qualified person.

Notes:
 Sketch schemes may be based on plan information of unknown origin and is subject to verification and survey.
 Contractors must verify all dimensions on site before commencing any work or shop drawings. This drawing is not to be scaled. Use figured dimensions only.
 Building areas are liable to adjustment over the course of the design process due to ongoing construction detailing developments.
 Subject to statutory approvals and survey.

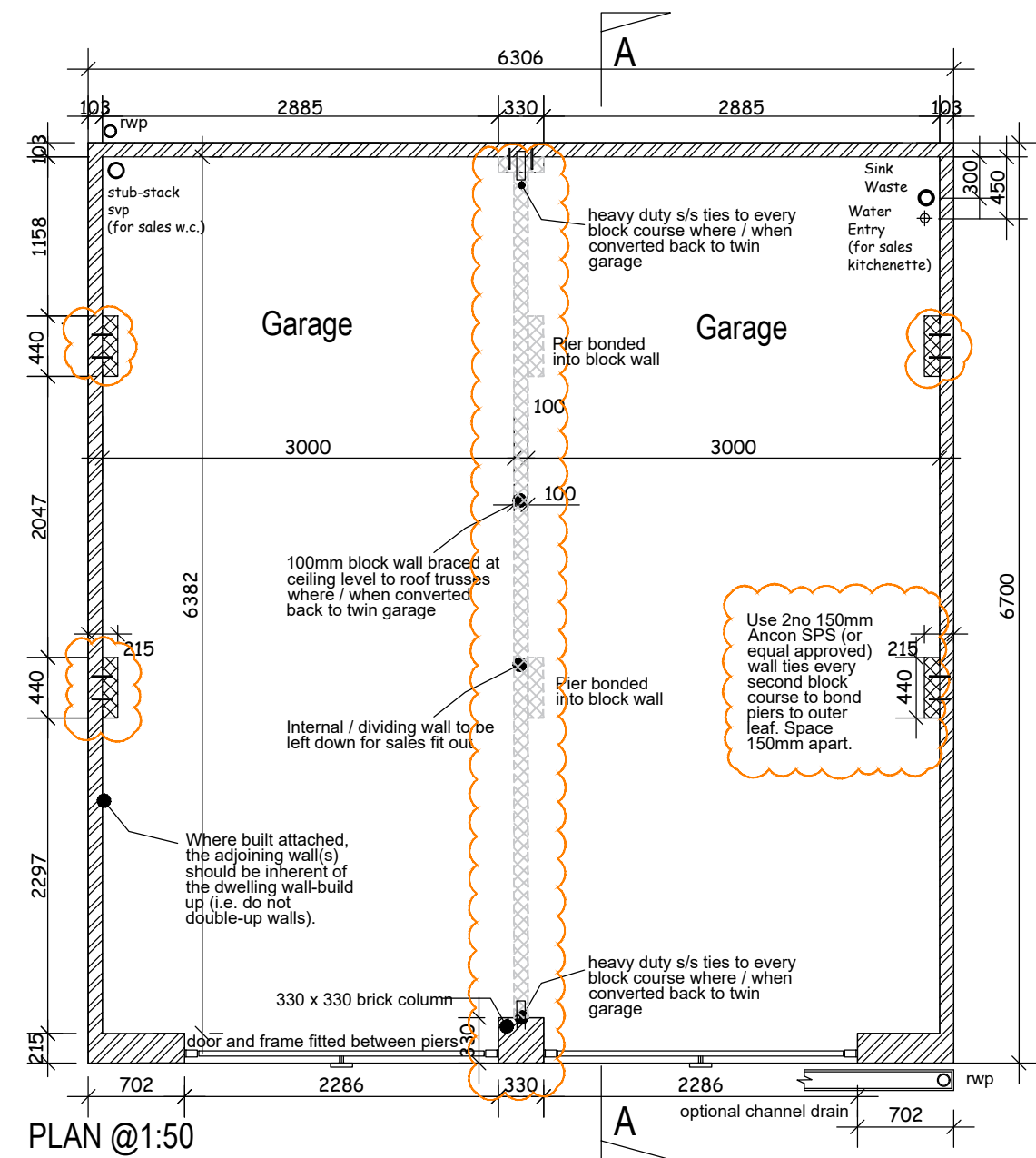
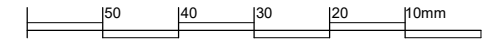

PLAN @1:50

Roof construction to be designed, fixed & braced in accordance with B.S 5268 pt 3 . Refer to truss manufacturers drawings for details

Blockwork taken up to underside of felt and firestopped using 50mm Rockwool blanket above, and below felt

75mm fall from rear to front of garage (100mm tapering down to 25mm - to avoid cracking at the thin end).

225mm (min) concrete base slab reinforced with A393 mesh (installed to achieve minimum 50mm cover).

50mm (min) sand blinding

175mm compacted non-frost susceptible granular layer

Ground to be compacted material capable of a safe ground bearing capacity of 50kN/m². Any material within 450mm of the external ground level to be non-frost susceptible.

Roof construction to be designed, fixed & braced in accordance with B.S 5268 pt 3 . Refer to truss manufacturers drawings for details

Concrete interlocking roof tiles are to be fixed strictly in accordance with the manufacturers recommendations.

Tiling battens to be 50 x 25mm in accordance with B.S 5534: 1997 on untearable roofing felt to B.S 747 type 1F or equivalent.

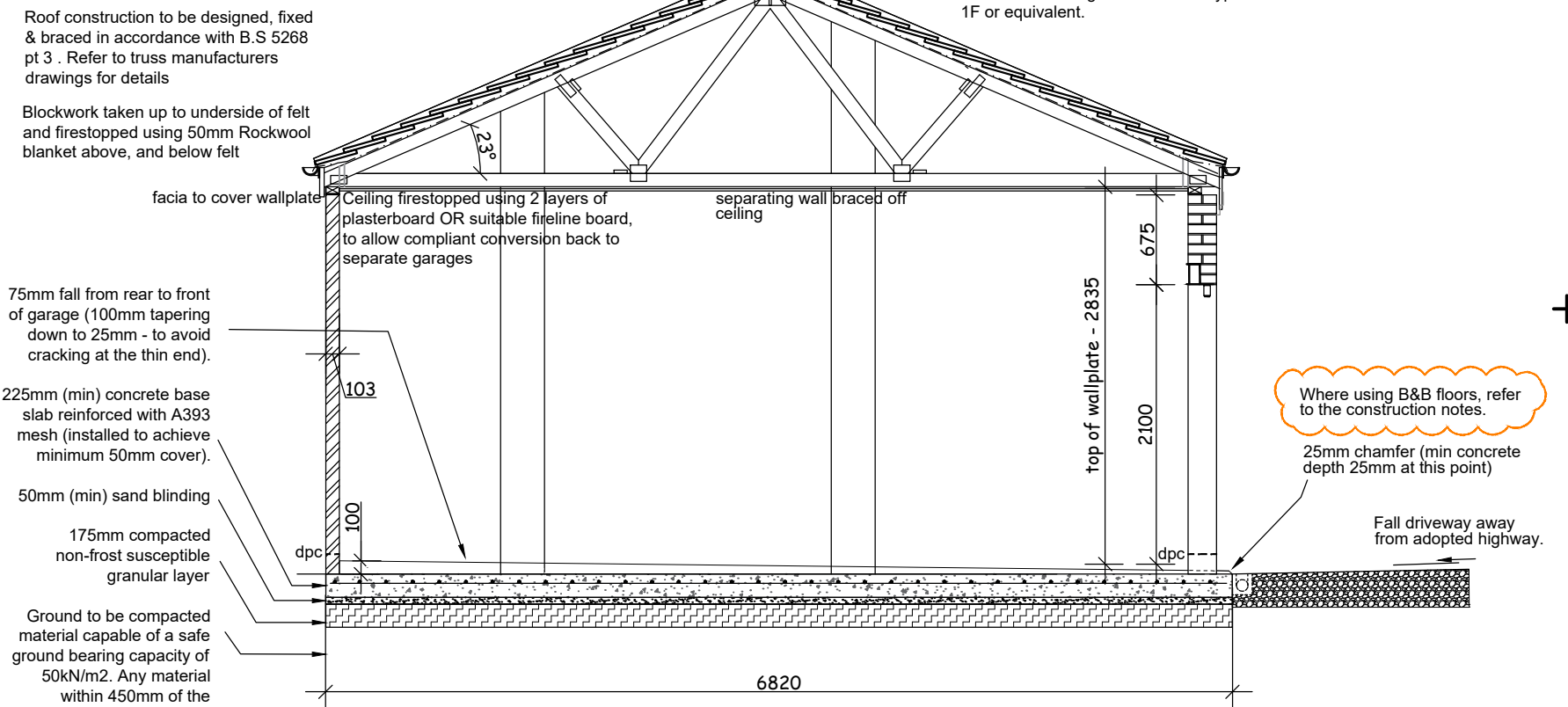

SECTION A-A @1:50 (Showing Rural Eaves Treatment)

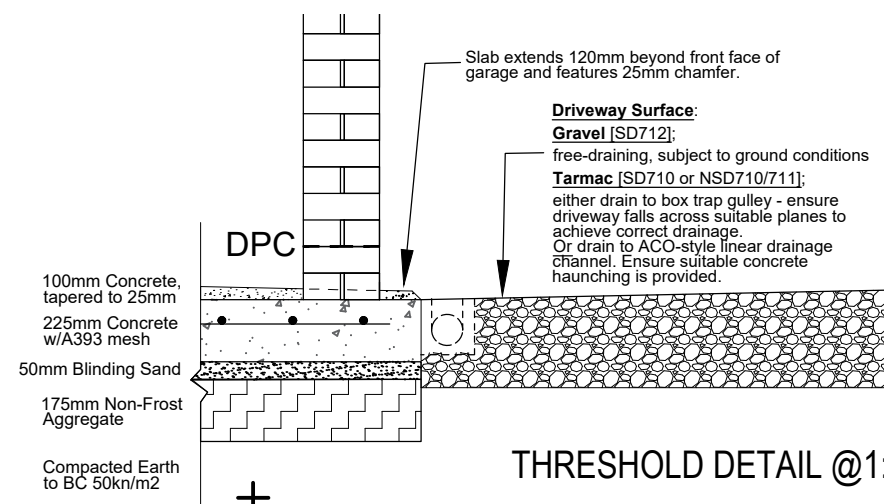

THRESHOLD DETAIL @1:20

E	Pier wall tie reqs. changed, hatch updates	02.05.23	AB
D	Eaves options clarified	04.10.21	AB
C	Slab and threshold details added	11.03.21	AB
B	Updated to indicate location of services	17.06.20	DJR
A	Updated to indicate location of services	01.06.20	DJR

gleeson

revisions status -
 project Standard Details
 client Gleeson Homes & Regeneration
 title Sales Garage Details

drawn DJB checked . date 17.12.19 scale As Indc.@A3
 job no 0282 drawing no SD704 rev E