

- NOTES:
1. All dimensions must be checked on site and not scaled from this drawing.
 2. The Contractor shall make a survey of the site and shall be responsible for obtaining all dimensions and levels necessary for the proper fabrication of the structure as indicated.
 3. All levels shown on this drawing are relative to Agreed Datum.
 4. This drawing is to be read in conjunction with 30047/100 Series Drawings.
 5. All existing invert levels are to be confirmed by contractor prior to construction. Connection subject to approval.

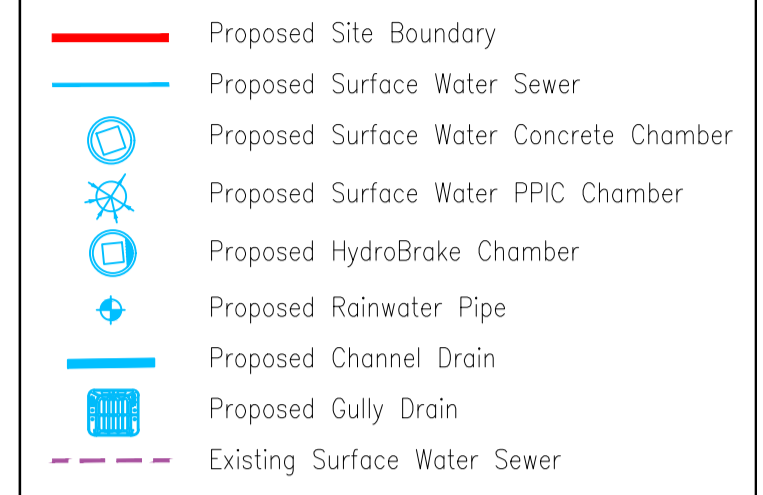

Cover Level of +33.700 has been used across the full scheme. Confirmation of proposed levels to be undertaken prior to construction

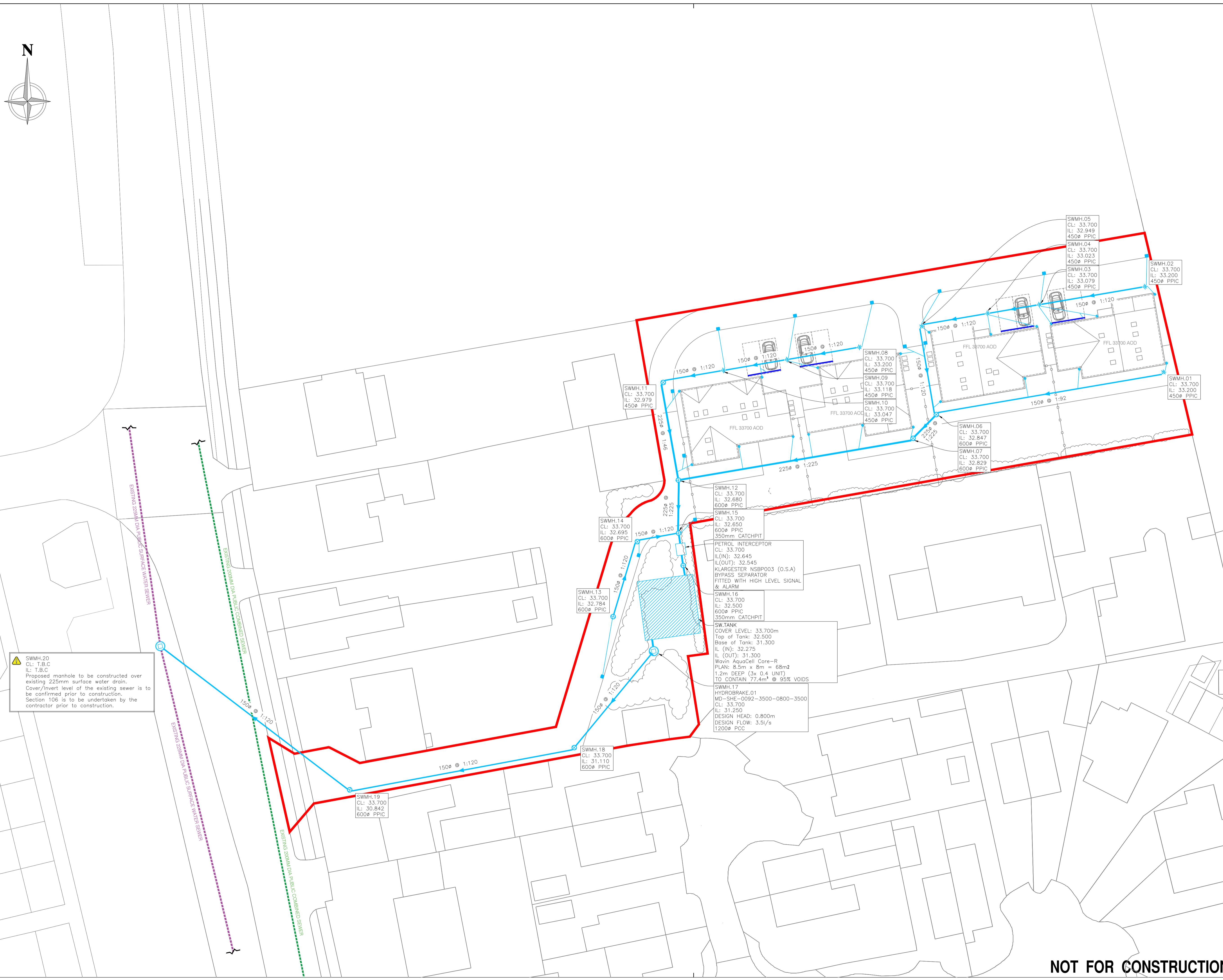

SWMH.20
CL: T.B.C
IL: T.B.C
Proposed manhole to be constructed over existing 225mm surface water drain.
Cover/Invert level of the existing sewer is to be confirmed prior to construction.
Section 106 is to be undertaken by the contractor prior to construction.

Rev	Date	Description	DR	CH
A	15/02/24	ISSUED FOR APPROVAL	W.P.	J.H.C.

© copyright

GGP CONSULT
CONSULTING ENGINEERS
ARCHITECTS
PROJECT MANAGEMENT
2 Hallam Road
Priory Park East
HULL HU4 7DY
United Kingdom
Telephone(+44) 01482 627963
Fax (+44) 01482 641736
Email info@ggpconsult.co.uk

Client
H. Linford
J. Harris

Job Title
Land to rear of 132,
Scarborough Road
Bridlington,
East Yorkshire

Drawing Title
**Proposed Surface Water
Drainage Layout**

Status	APPROVAL		
Scale	1:200 @ A1	Date	Feb' 2024
Drawn By	W. Brown	Checked	J.H.C.
Approved	J.H.C.		
Dwg. No.	30047 / 103	Rev	A

NOT FOR CONSTRUCTION