

© This drawing is copyright.
It is sent to you in confidence and must not be reproduced or disclosed to third parties without our prior permission.

Do not scale from this drawing, other than for Local Authority Planning purposes.

This drawing is to be read in conjunction with all relevant consultants, specialist manufacturers drawings and specifications.

Any discrepancies in dimensions or details on or between these drawings should be drawn to our attention.

All dimensions are in millimetres unless noted otherwise.



Ordnance Survey, (c) Crown Copyright 2021. All rights reserved. Licence number 100022432

REV	DATE	DESCRIPTION	INITIAL	CHECKED
PLANNING				

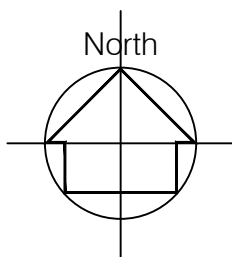

harding rose architects

CLIENT	MR G AHMED
PROJECT	54 Poyle Road, Tongham GU10 1DU
TITLE	Location Plan

SCALE	DATE	L.301
1:1250@A4	26.01.24	
DRAWN	PROJECT NO.	
AC	21.926	

