

© This drawing and design are copyright.

Do not scale from this drawing. Use only figured dimensions. If in doubt, ask. All dimensions are to be checked on site. Any discrepancies should be reported immediately to the Architect.

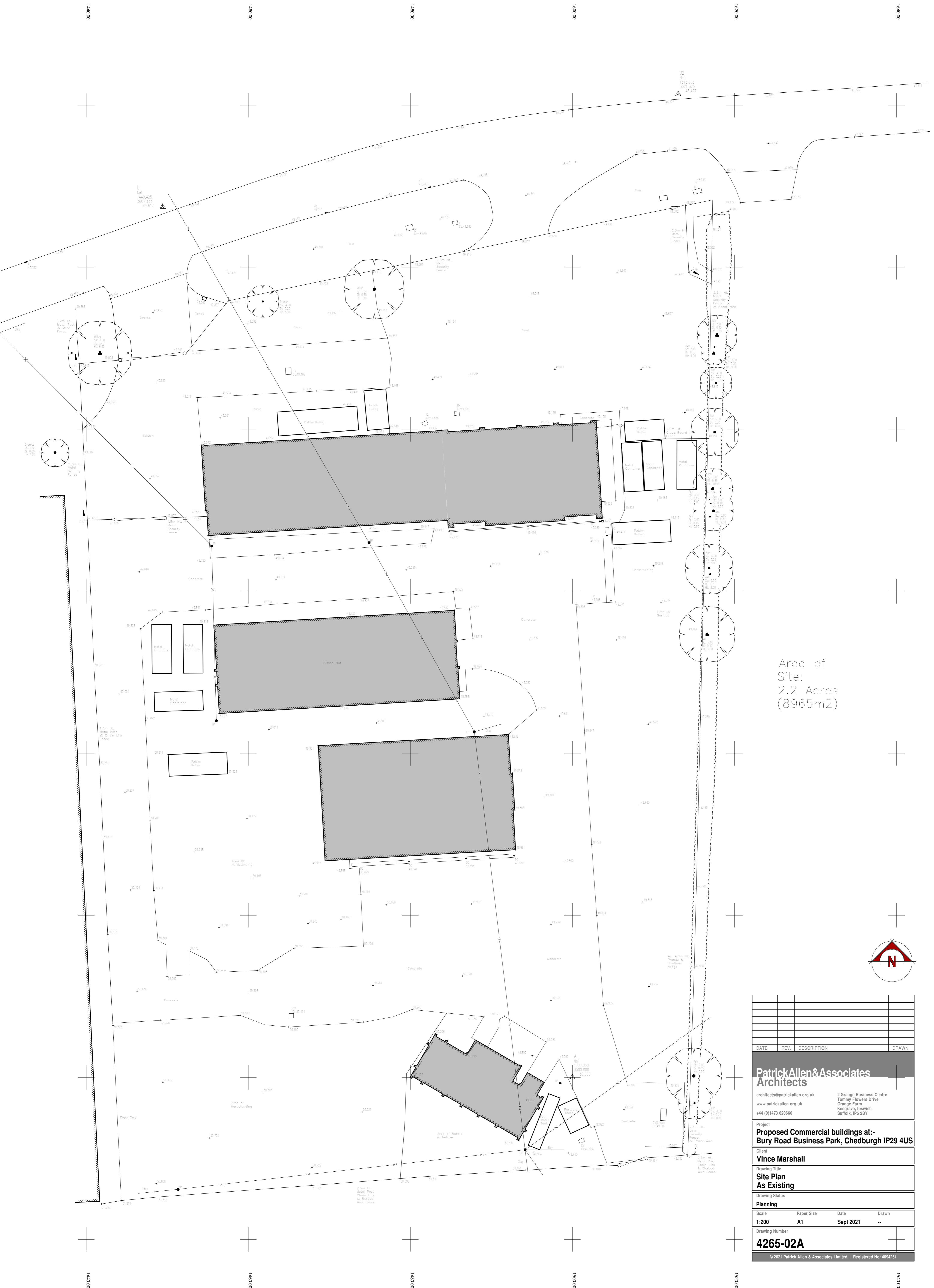

Area of Site:
2.2 Acres
(8965m²)

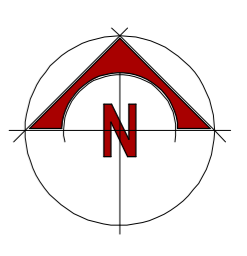

DATE	REV	DESCRIPTION	DRAWN

Patrick Allen & Associates Architects
 architects@patrickallen.org.uk
 www.patrickallen.org.uk
 +44 (0)1473 620660

2 Grange Business Centre
 Tommy Flowers Drive
 Grange Farm
 Kesgrave, Ipswich
 Suffolk, IP5 2BY

Project
**Proposed Commercial buildings at:-
 Bury Road Business Park, Chedburgh IP29 4US**

Client
Vince Marshall

Drawing Title
**Site Plan
 As Existing**

Drawing Status
Planning

Scale	Paper Size	Date	Drawn
1:200	A1	Sept 2021	--

Drawing Number
4265-02A

© 2021 Patrick Allen & Associates Limited | Registered No: 4694261