

On sites where space is limited it is permissible to accommodate roof mounted plant if/where required above Warehouse area.  
 The design of the plant arrangement must allow for appropriate means of access and for future maintenance in accordance with CDM 2015 requirements. When used as a plant zone overflows must be incorporated in addition to the main drainage 2 No. 400 x 100mm slots

Minimum clear distance from Fall protection System to edge of roof to be in line with manufacturer and CDM specific requirements.  
 External fixed ladder restrained to steel support as Structural Engineer's detail, bracket to be sealed to cladding panel to maintain air seal/thermal/fire performance as required. Ladder walkway to extend to man-safe connection point to enable safe access for PV maintenance, exact length of walkway to be determined on a site by site basis. CAT ladder to comply with BS 4211 & BS 5395.  
 Indicative layout of Fall Protection System as per manufacturer information.

Gutter & drainage design to be in accord with BS EN 12056-3:2000 rainwater calculations are to be provided for site specific geographical location.  
 Gutters and downpipes to be colour coded to match cladding RAL 9006

400x100mm overflow to canopy  
 Canopy roof to be insulated above Customer WC to avoid cold bridging

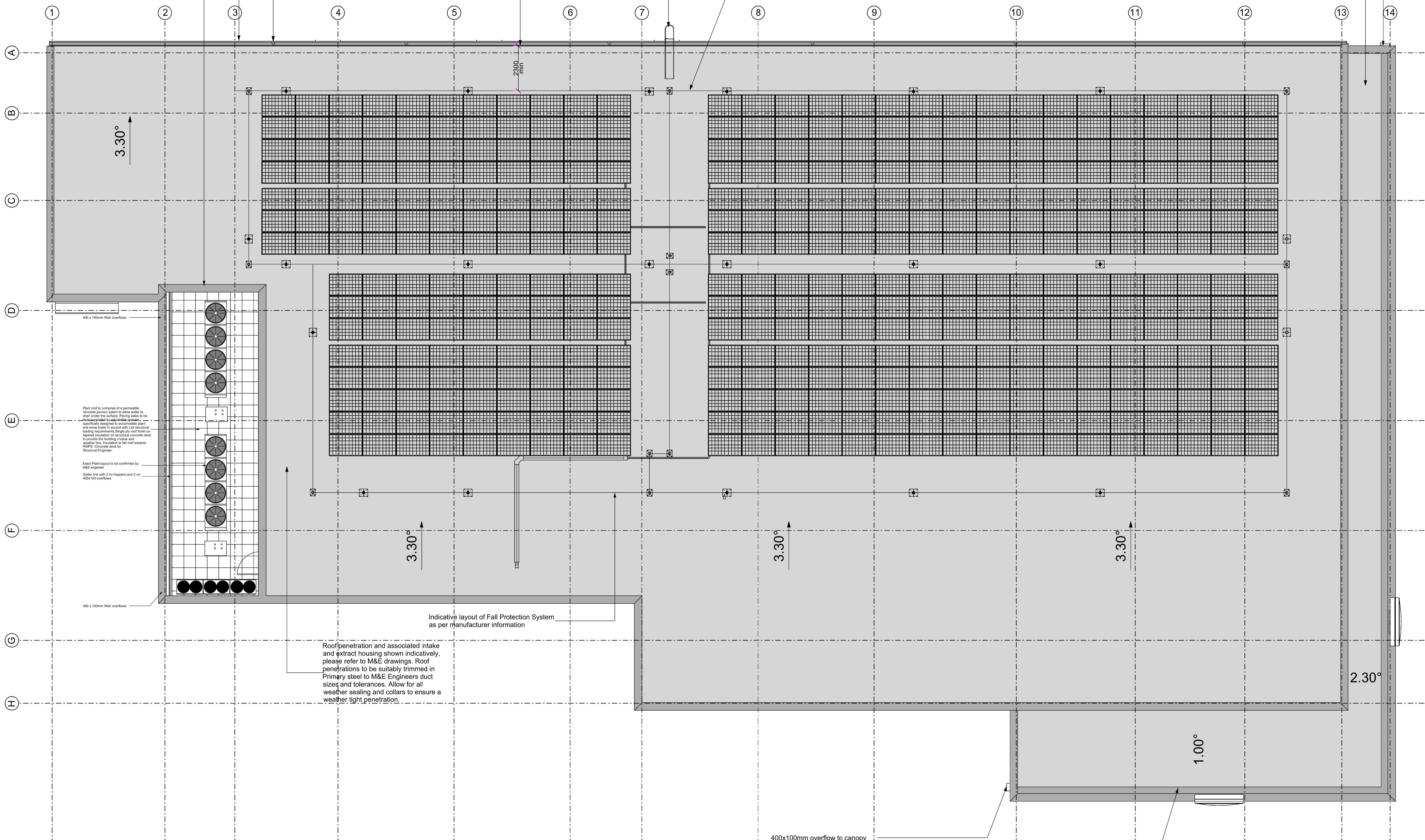

400 x 100mm Weir overflows

Plant roof to comprise of a permeable concrete paving system to allow water to drain under the surface. Paving slabs to be manufactured to BS EN 12404-1. The structural design to accommodate plant and snow loads in accord with L18 structural loading requirements. Single ply roof fleece on tapered insulation on structural concrete deck to provide the building's thermal and weather air. Insulation to fall roof towards BMS's. Concrete deck by Structural Engineer.

Exact Plant layout to be confirmed by M&E engineer  
 Gutterline with 2 no hoppers and 2 no 400x100 overflows

Indicative layout of Fall Protection System as per manufacturer information

Roof penetration and associated intake and extract housing shown indicatively, please refer to M&E drawings. Roof penetrations to be suitably trimmed in Primary steel to M&E Engineers duct sizes and tolerances. Allow for all weather sealing and collars to ensure a weather tight penetration.

400x100mm overflow to canopy  
 Syphonic drainage design by specialist to BS 8590:2007 down corner locations to coordinate with site specific steel/structural design to include for emergency overflows.  
 Refer to drawing LD(14)-RP-02 - Syphonic Drainage Proposals within latest BBS 2020 Specification.

REV	DATE	DRAWN	DESCRIPTION	CHECK	APP'D
B	24.10.23	AF	ROOF PLAN UPDATED TO LID, BBS 2023 (TYPE 1300) SPECIFICATION		
A	27.06.23	AF	ROOF PLAN UPDATED TO LID, BBS 2023 SPECIFICATION		

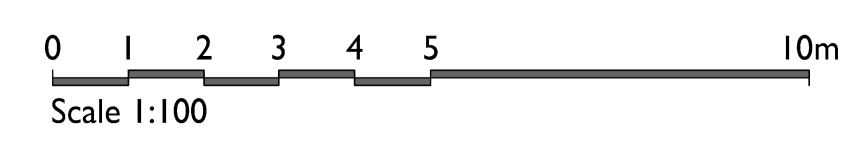

CLIENT	Lidl Great Britain Ltd
JOB	Proposed Lidl Foodstore Perth
DRAWING	Proposed Lidl Roof Plan
STATUS	<b>PLANNING</b>
Drawn	SM
Checked	...
Approved	...
DATE	Jun 21
JOB NO	144618 DR NO (PL)-04
REV	B
SCALE	1:100
SHEET	A1

yeomanmcallister

EDINBURGH - Waterloose Studios, 54 Colinton Avenue, Edinburgh EH10 5AW, Tel: 0131 346 1845, Fax: 0131 346 1850, info@yeomanmcallister.com

LONDON - 33 Monument Street, London, EC3R 8JH, Tel: 020 7923 1955, Fax: 020 7923 1936, info@yeomanmcallister.com