

- 0 - 0.5m High Retaining Wall
- 0.5 - 1.0m High Retaining Wall
- 1.0 - 1.5m High Retaining Wall
- 1.5 - 2.0m High Retaining Wall
- 2.0 - 2.5m High Retaining Wall
- 2.5 - 3.0m High Retaining Wall
- + 34.500m Proposed Site Levels
- Site Application Boundary
- Lidl Ownership Boundary

Site	Perth New Store
Sales Area (m <sup>2</sup> )	1331
Warehouse Area (m <sup>2</sup> )	405
Ancillary (m <sup>2</sup> )	213
External Plant (m <sup>2</sup> )	On Roof
Asises	5
Total G.J.F.A (m <sup>2</sup> )	1949
External Floorspace inc. Canopy	2153
Planning application Site Area (m <sup>2</sup> )	11,863
Lidl site area (m <sup>2</sup> )	8366
Car Spaces (Total)	103
Scale	1:500 @ A3

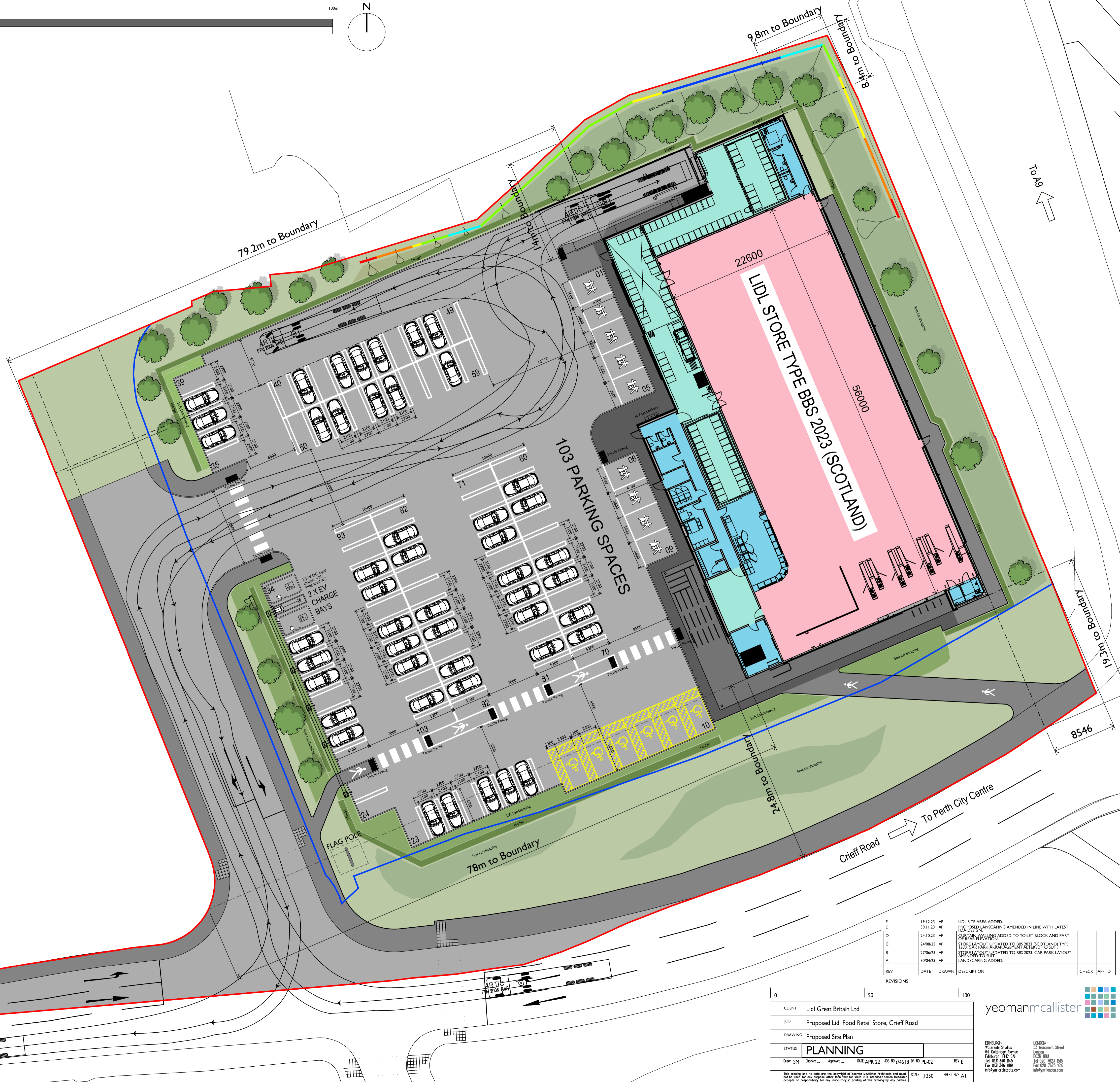

REV	DATE	DRAWN	DESCRIPTION	CHECK	APP'D
F	19.12.23	AF	LIDL SITE AREA ADDED.		
E	30.11.23	AF	PROPOSED LANDSCAPING AMENDED IN LINE WITH LATEST PDX DESIGN.		
D	24.10.23	AF	CURTAIN WALLING ADDED TO TOILET BLOCK AND PART OF REAR ELEVATION.		
C	24/08/23	AF	FLOOR CAR PARK MANAGERY REDESIGNED TO TYPE BBS 2023 (SCOTLAND).		
B	27/06/23	AF	FLOOR CAR PARK MANAGERY REDESIGNED TO TYPE BBS 2023 (SCOTLAND).		
A	30/04/23	AF	AMENDED TO SUPPLEMENT TO BBS 2023. CAR PARK LAYOUT LANDSCAPING ADDED.		

CLIENT	Lidl Great Britain Ltd
JOB	Proposed Lidl Food Retail Store, Crieff Road
DRAWING	Proposed Site Plan
STATUS	PLANNING
Drawn	SM
Checked	...
Approved	...
DATE	APR 22
JOB NO	S/14618
PR NO	PL-02
REV	E
SCALE	1:250
SHEET SIZE	A1

This drawing and its data are the copyright of Yeoman McCullister Architects and must not be used for any purpose other than that for which it is intended. Yeoman McCullister accepts no responsibility for any inaccuracy in printing of this drawing by any parties.

**yeomanmccullister**

Water side Studios  
24 Colindale Avenue  
London NW9 4EQ  
Tel: 020 346 3463  
Fax: 020 346 3639  
info@ym-architects.com

LONDON:  
33 Monmouth Street  
EC3R 8BU  
Tel: 020 7323 8215  
Fax: 020 7323 8216  
info@ym-architects.com