



adp architects ltd
architects & urban designers

Tel: 01489 584503
Email: mail@adp-ltd.co.uk
www.adparchitects.co.uk
Richmond Court, 94 Botley Road, Park Gate, Southampton, SO31 1BA

project name/address:
**Nursery School
 Holy Trinity Church Hall
 Millbrook Road West
 S015 0JZ**

client:
Tiny Toes
 drawing title:
Location Plan

job number: **1997** drawing number: **L20** revision: **A**

drawing scale/size: **1:1250 (A4)** date: **Feb 24** drawn:

Copyright
 Reproduced from Ordnance Survey's 1:1250 scale map
 with permission of Controller, HMSO Crown copyright.
 ADP Architects Ltd AR 100010061

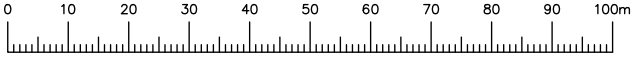

LINEAR SCALE 1:1250
 A4@1:1250

rev:	date:	note:

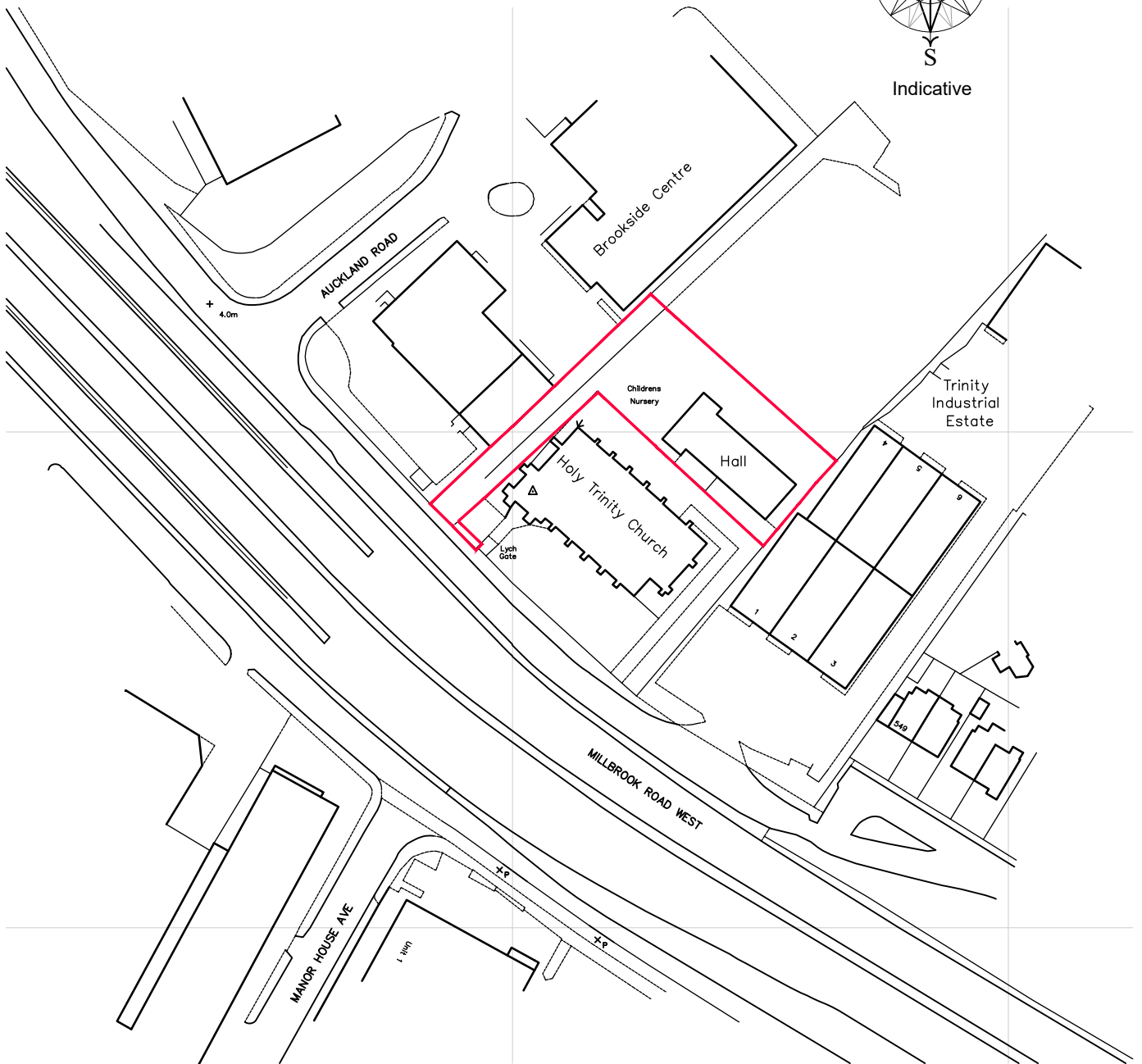
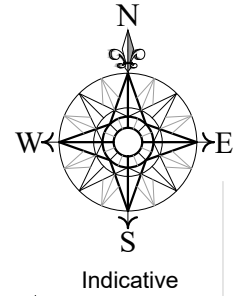

PROPOSED SITE LAYOUT 1:200

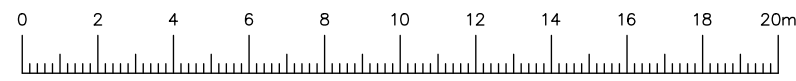

LINEAR SCALE 1:200
A2 @ 1:200

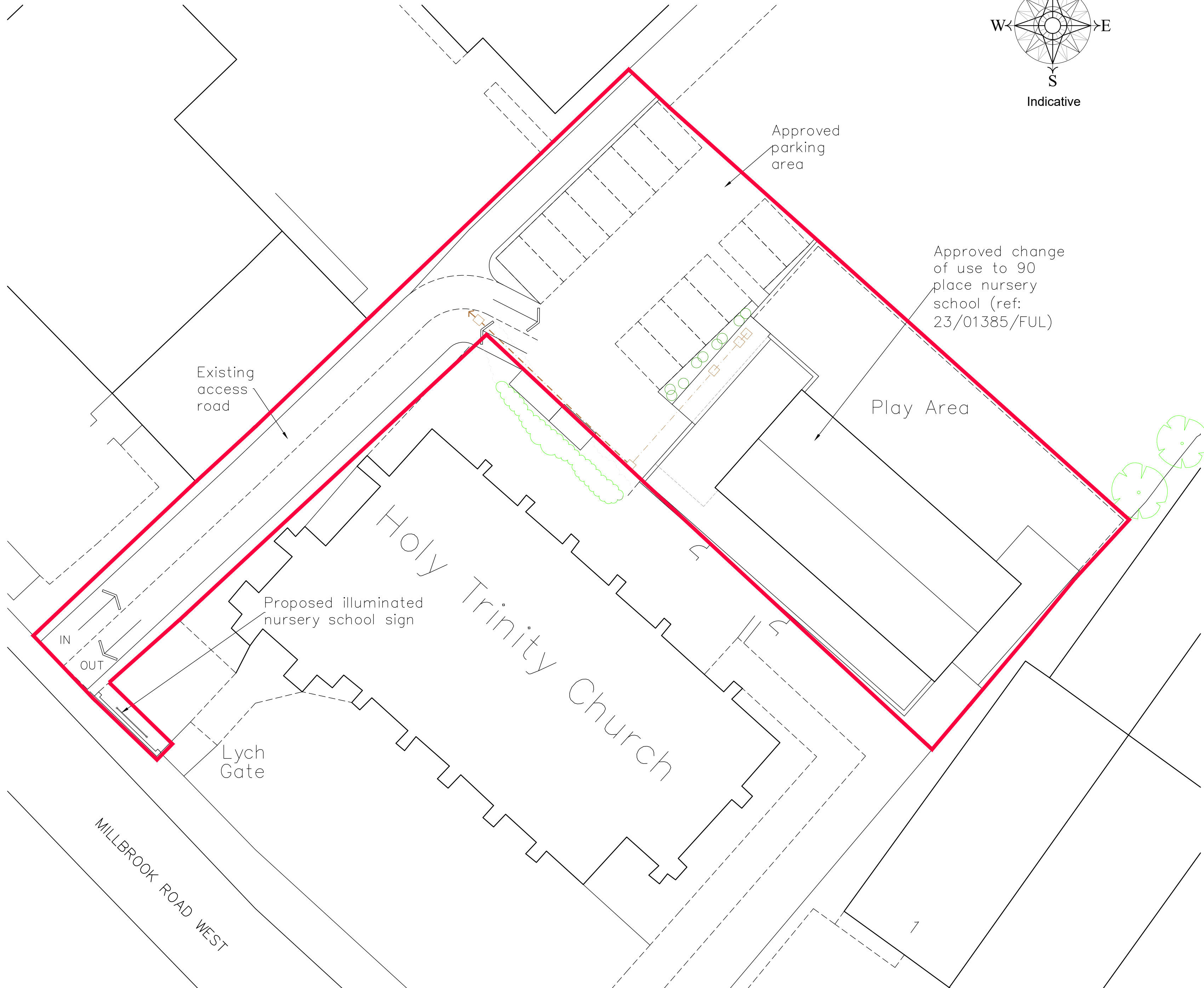
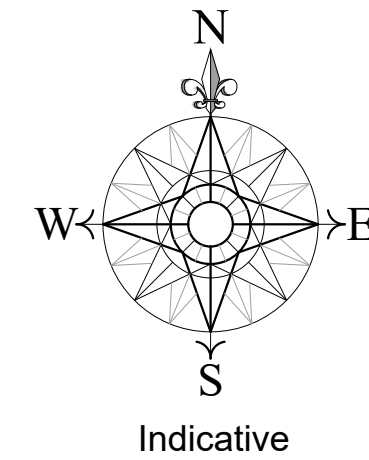

A | 21.02.24 | Red line amended
rev: date: note:

adp architects ltd
architects & urban designers
Tel: 01489 584503
Email: mail@adp-ld.co.uk
www.adparchitects.co.uk
Richmond Court, 94 Bolley Road, Park Gate, Southampton, SO31 1BA

project name/address:
**Nursery School Sign
Holy Trinity Church Hall
Millbrook Road West
Southampton**

client:
Tiny Toes
drawing title:
Proposed Site Layout

job number:	drawing number:	revision:
1997	201	A
drawing scale/size:	date:	drawn:
1:200 (A2)	Feb 2024	PJL

DETAIL/INFORMATION SHEET



ADP CHARTERED ARCHITECTS

94 BOTLEY ROAD
PARK GATE,
SOUTHAMPTON,
HANTS SO31 1BA
tel. LOCKS HEATH (01489) 584503

project
Nursery School Sign
Holy Trinity Church
Millbrook Road West
Southampton
client
Tiny Toes

drawn PJL	date Feb 24	scale 1:20
---------------------	-----------------------	----------------------

title
Signage Detail

revision

job no. 1997	dwg. no. 202	revision

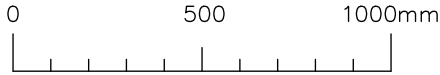

LINEAR SCALE 1:20

A4 @ 1:20

For General Guidance Only
To be read in conjunction with
manufacturers details

