

KEY

- WORKS TO WALLS**
- Removal of localised area of fire damaged daub panel, replace daub on existing laths
 - Plasterboard reinstatement to walls
 - Treated softwood studwork to form mills and whole wall replacement. New timber studwork to match original as closely as possible, mill studs with softwood board insulation
 - New riven laths and haired lime plaster (3 coat work)
 - Hacking off loose / fire damaged plaster, prepare solid wall surfaces and replaster walls with 3 coat lime plaster - Render and float (NHL2) Finish coat Lime putty plaster.
 - Washing cleaning down, prepare and apply skim coat of non hydraulic lime putty to existing wall surfaces. To include for removal of any wall paper prior to work. Provisional - removal of loose lime to lath (renew lath)
 - Dry Lining to internal wall surfaces
 - Insulated Dry Lining to external facing solid wall surfaces - Insulate dry lining to external wall face PL3000 (25mm thick board 0.54 U value)
 - Insulation to sloping ceilings - Sheepswool (0.51 u value)
 - Insulation to loft spaces using sheepswool (0.16 u value)
- INSULATION**
- Complete removal and reinstatement of lath & plaster ceiling. New riven laths and haired lime plaster (3 coat work)
 - Complete removal and reinstatement of plasterboard ceiling. Replaster as 12.5mm plaster board with gypsum skim finish
 - Windows to be cleaned and fire damage charring removed for assessment of work

NON FIRE DAMAGED SECTION OF DWELLING (requiring decoration only)

FIRE DAMAGED SECTION OF DWELLING

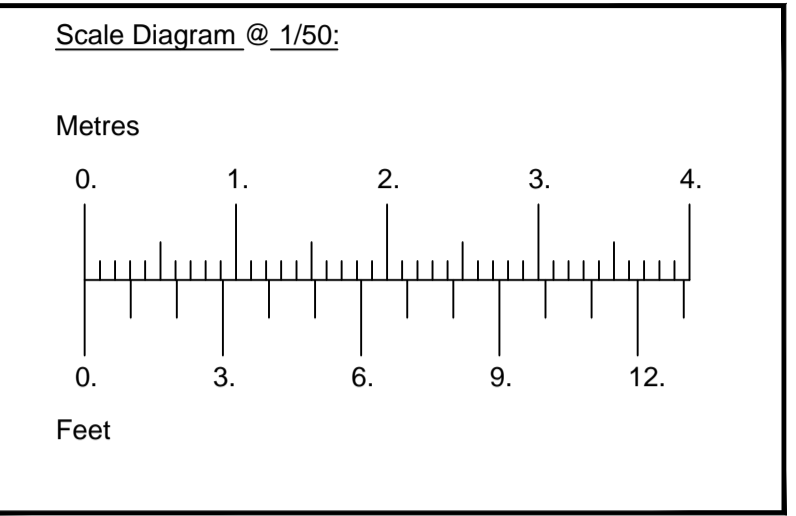
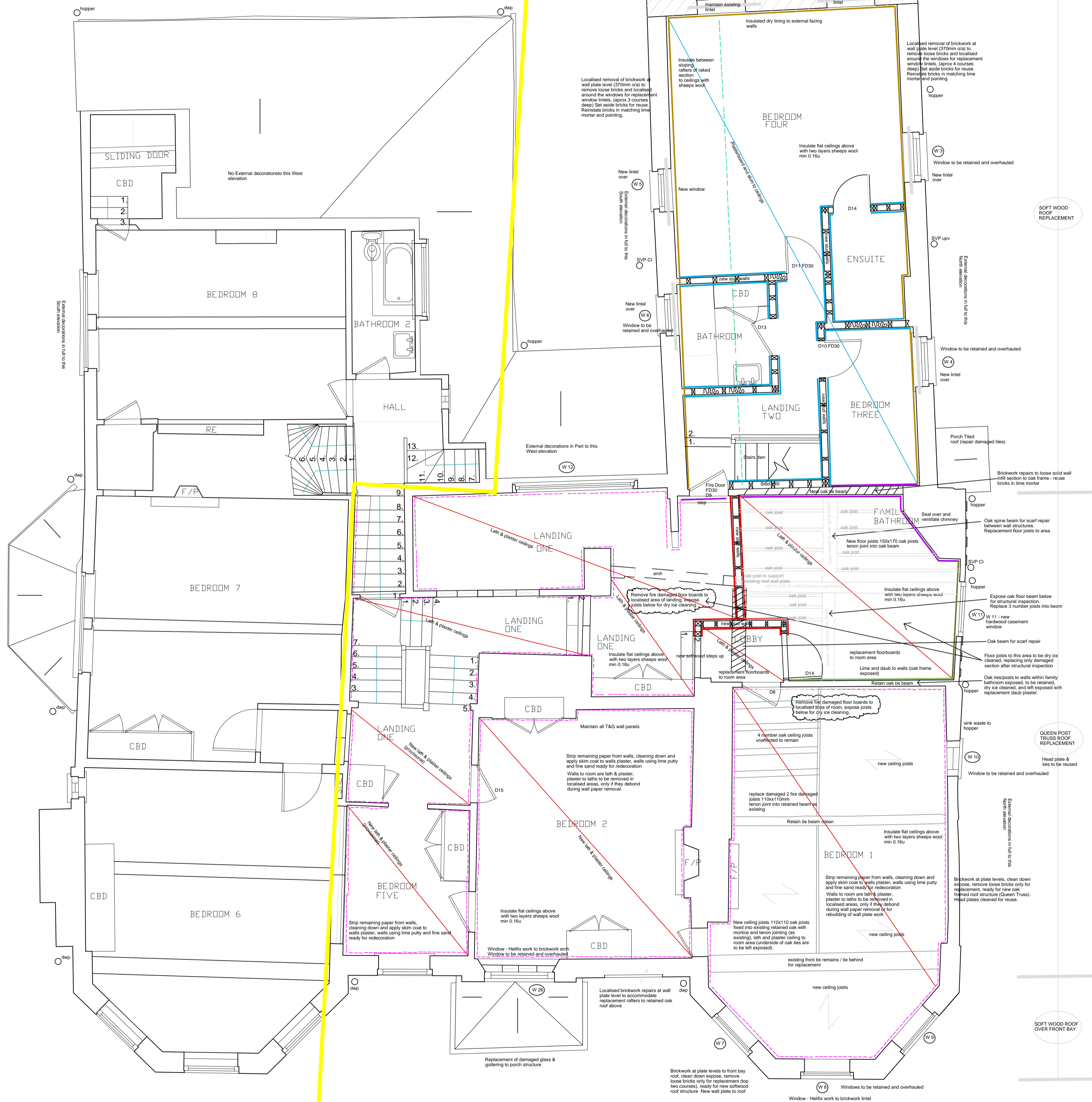

LEGEND

FIRST FLOOR

Rev.	Date	Revisions

Project Title:	THE OLD RECTORY, CHURCH ROAD, EVERSLEY		
Client:	MR SUTHERLAND		
Description:	FIRST FLOOR PLAN		

Date	SEPT 22	Scale	1/50 @ A1
Job No.	MS/2100	Surveyor	BL
Drawn	02	Drawn	BL