

This drawing has been prepared for the sole purpose of obtaining Building Regulations Planning and does not constitute a full detailed design for the safety of the building or any other aspect of the works shown. The drawings do not show structural design: all structural requirements instructions should be obtained from a structural engineer. Unforeseen works and items requiring further design by the contractor is the responsibility of the home owner to use a contractor with experience in the relevant area. The contractor is responsible for carrying out a Health and Safety Risk Assessment to cover all operations involved under the works specified and for providing the client with the necessary information (including the contractor to obtain completion certificate at completion of work. All works and materials shall comply with the latest British Standards and Codes of Practice, Building Regulations and Part W and 1988. The Contractor shall comply with manufacturer's instructions. The Contractor is responsible for carrying out a Health and Safety Risk Assessment to cover all operations involved under the works specified and for providing the client with the necessary information (including the contractor to obtain completion certificate at completion of work. Electrical work to be installed, tested and commissioned by competent Building Regulations and BS7671. Energy efficient lighting to be installed within proposed work. Gas work to be installed, tested and commissioned by 'Gas Safe' registered competent person. Existing structure (insufficiently) will and left to be improved in accordance with Part L of the current Building Regulations.

DOMESTIC CLIENTS
 The domestic client is to appoint a principal designer and a principal contractor when there is more than one contractor. If not, your duties will automatically be referred to the contractor or principal contractor. The designer can take on the duties, provided there is a written agreement between you and the designer to do so. Before construction work starts if the works:
 (a) Last longer than 30 working days and has more than 20 workers working simultaneously at any point in the project.
 (b) Exceeds 500 person days.

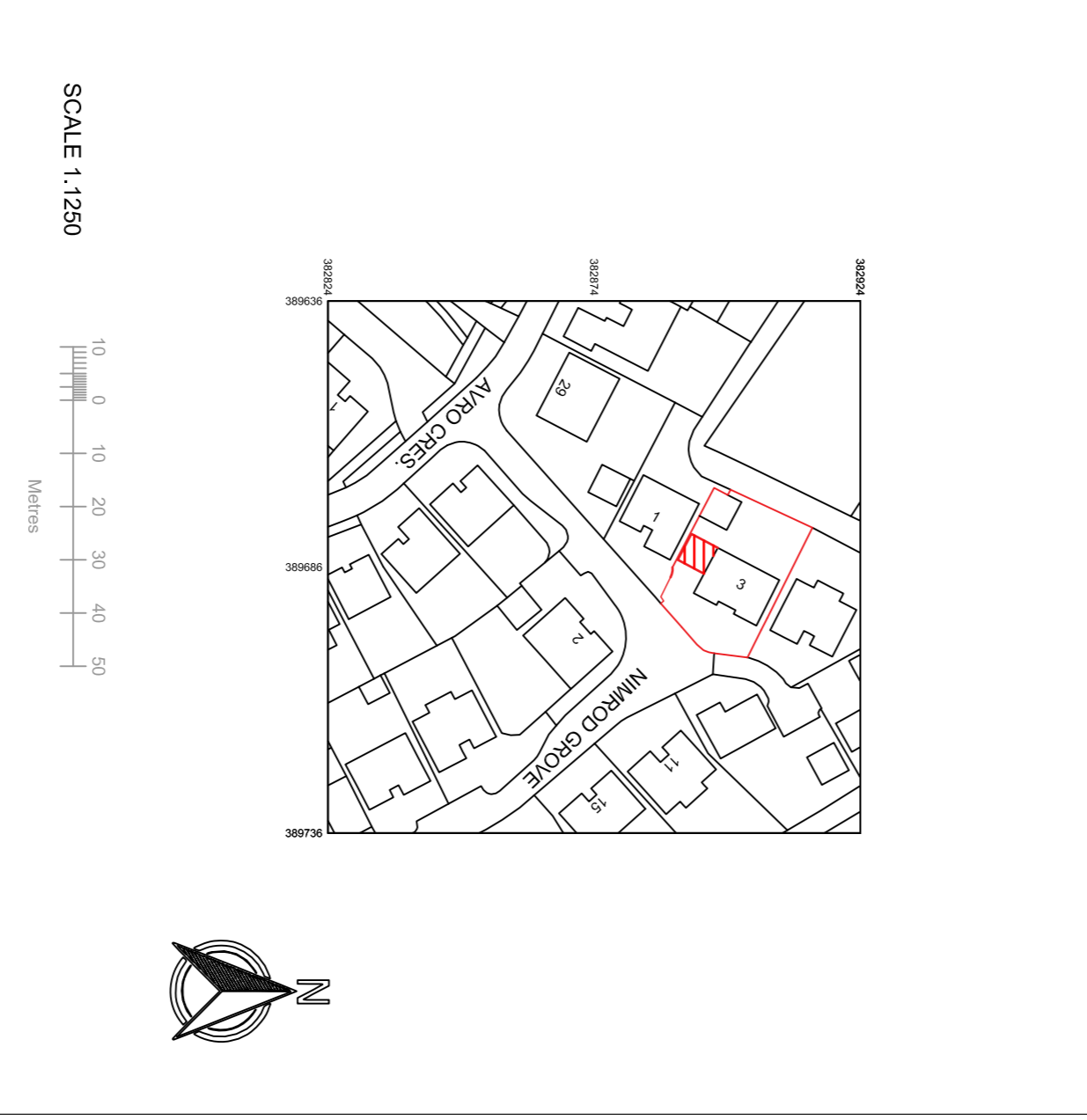
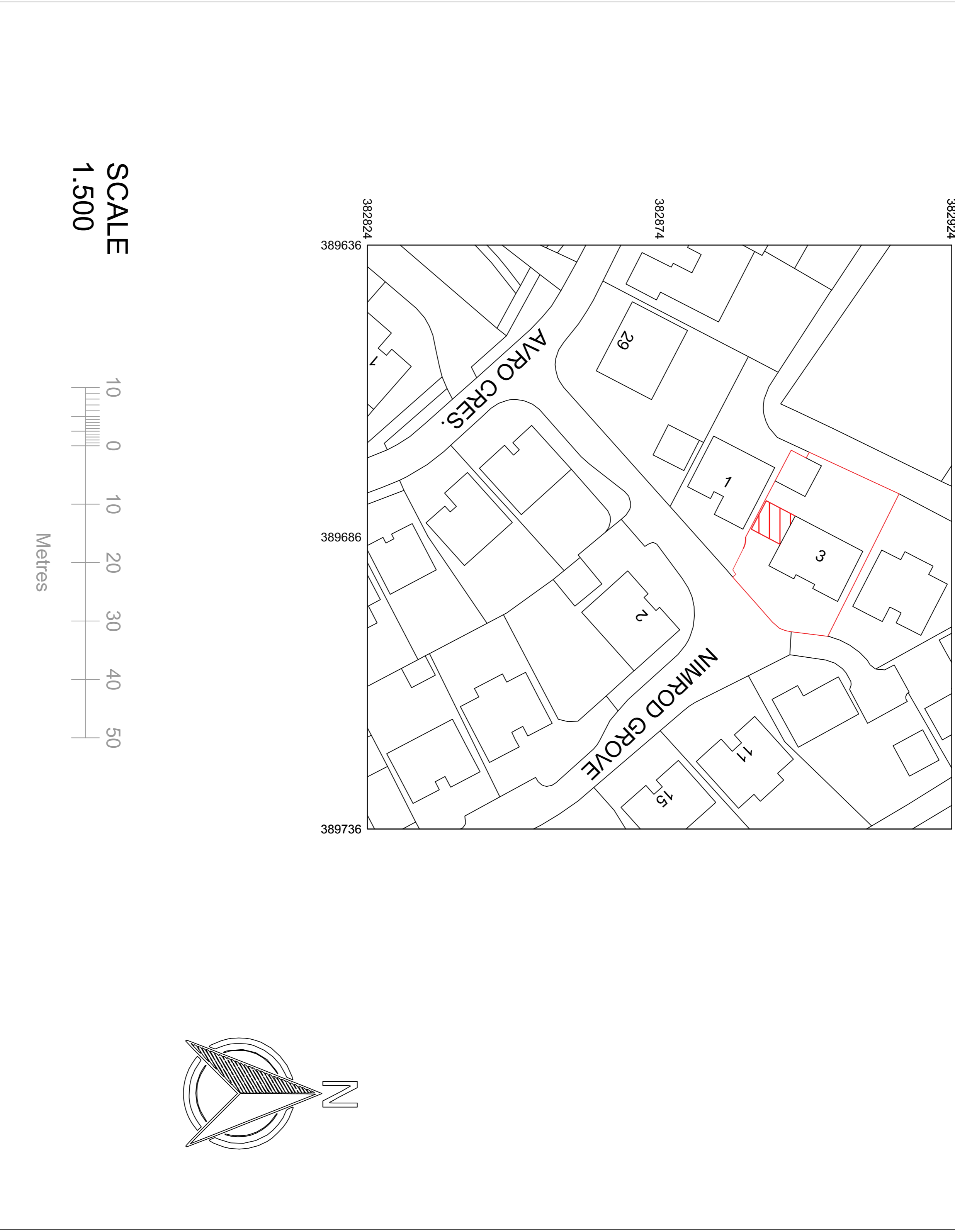

NOTE : Measurements/scale is for guidance only. Contractor should take own measurements on site
 The use of this drawing as a basis for programming or ordering of material shall be at the contractor's own risk
 The Contractor is to inform of any discrepancies between any drawings and with those found on site

Rev	Description	Date

A.F. Architectural Designs
 e-mail: info@afad.co.uk
 Tel: 07980799827
 web : www.afad.co.uk

PROJECT
 3 Nimrod Grove
 Woodford, SK7 1SF

TITLE
 LOCATION PLAN

CLIENT

DRAWN BY	DATE
A.F.J	11/02/24
SCALE (@ A1)	
as noted	
DRAWING NUMBER	REV