

Notes:

1. If this drawing has been received electronically it is the recipients responsibility to print the document to the correct scale.
2. All dimensions are in millimeters unless stated otherwise. It is recommended that information is not scaled off this drawing.
3. This drawing should be read in conjunction with all other relevant drawings and specifications.
4. All boundaries, dimensions and levels are to be checked on site before construction and any discrepancies are to be reported to the Architect
5. For the purpose of coordination, all relevant parties must check this information prior to implementation and report any discrepancies to the Architect.

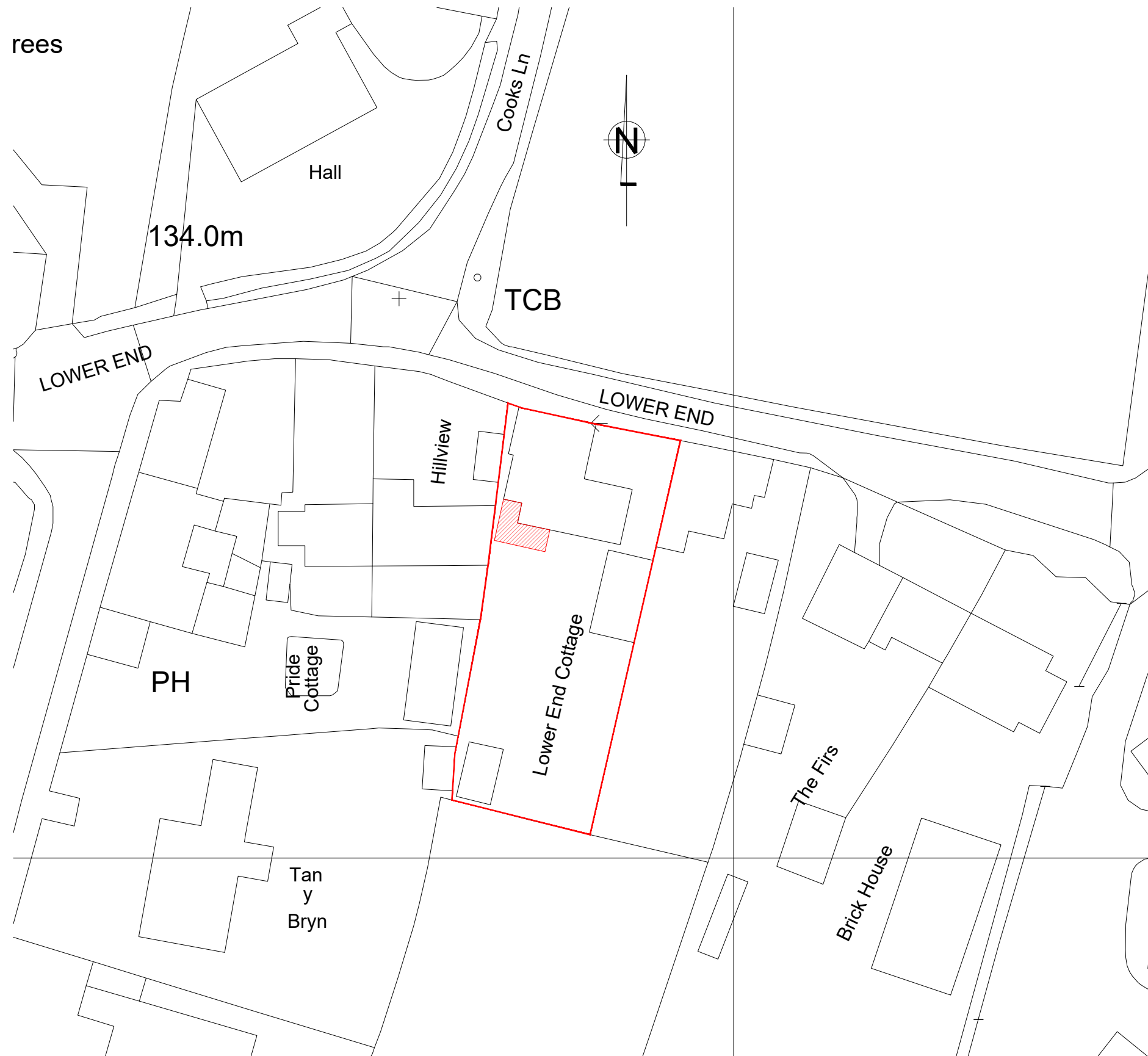

Serial number: 249134

©Crown copyright and database right 2022
 Ordnance Survey licence 100048957
 Reproduction in whole or in part is prohibited
 without the prior permission of Ordnance Survey

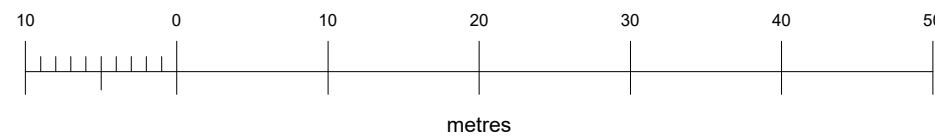

Rev. No	Date	Revision	Drawn by	Checked

Client

Dr & Mrs McKay

Project

Lower End Cottage,
 Lower End, Salford, Chipping
 Norton OX7 5YP

Drawing

Site Location Plan

ARCHITECTURE
 DESIGN
 DEVELOPMENT

Studio 3
 The Drive ·
 Kettering
 NN15 7EX

Scale: 1:500@A3 Date: Sept 22 Drawn by: SM Checked by: GN

Job No	Drg No	Rev No
IM704	103	