

Notes

- All dimensions to be checked on site and not scaled from this or any other drawing.
- Drawing to be read in conjunction with all Architect's drawings and other related documentation.
- All works to be notified to the Local Authority and Building Control Officer's Approvals obtained as appropriate during the course of the works.
- Temporary Works: To ensure the stability of the existing building during construction and is to be the contractor's responsibility.
- Steel sections to be mild steel grade S275.
- Concrete for padstones to be 1 : 1½ : 3 nominal mix by volume with 10mm aggregate size.
- Mass concrete to be grade C30 having a minimum crushing strength of 30 N/mm² at 28 days.
- Reinforced concrete to be grade C35 having a minimum crushing strength of 35N/mm² at 28 days.
- Unless noted otherwise, ground bearing pressure required for new foundation works to be 100kN/m² and formation level agreed with BCO
- All structural softwood timbers used are to be treated and have an average moisture content not exceeding 20%. Timber is to be identified as C16 or 24 dry, or KD as part of the grading marking.
- All blockwork to be 3.6 N/mm² in 1 : 6 mortar above and 7N/mm² laid in 1 : 3 mortar below DPC unless otherwise shown.
- All lengths of structural steelwork to be confirmed on site prior to ordering.
NB: Connection details not shown to be fabricator's design and detail to cater for end reactions stated on drawings shown as ??kN (ULT) unless noted.
- All internal structural steelwork to be painted with two coats of zinc rich primer prior to erection and touched in after erection, all external and cavity wall structural steelwork to be galvanised or coated in bitumen paint prior to delivery to site.
- Welds to be 6mm full profile fillet unless otherwise shown. Hit and Miss welds to be 100 'Hit' and 75 'Miss' throughout.
- Cut line above new openings to allow for 25mm minimum semi-dry 3 : 1 sand/cement mortar packing, to be well consolidated between cut face of existing masonry and top of new supporting member.
- Tied Movement Joints (TMJ) to comprise of proprietary wall tie system that provides for lateral movement with plaster beads internally and mastic sealant fill externally.
- Where Resin Anchors are to be fixed into masonry they must be into masonry and NOT mortar joints.
- All proprietary products are to be used and installed in accordance with manufacturer's instructions and/or recommendations.
- Where alternative products are used in substitution for those specified here, then the substitute product must be equivalent to or superior than the specified product.

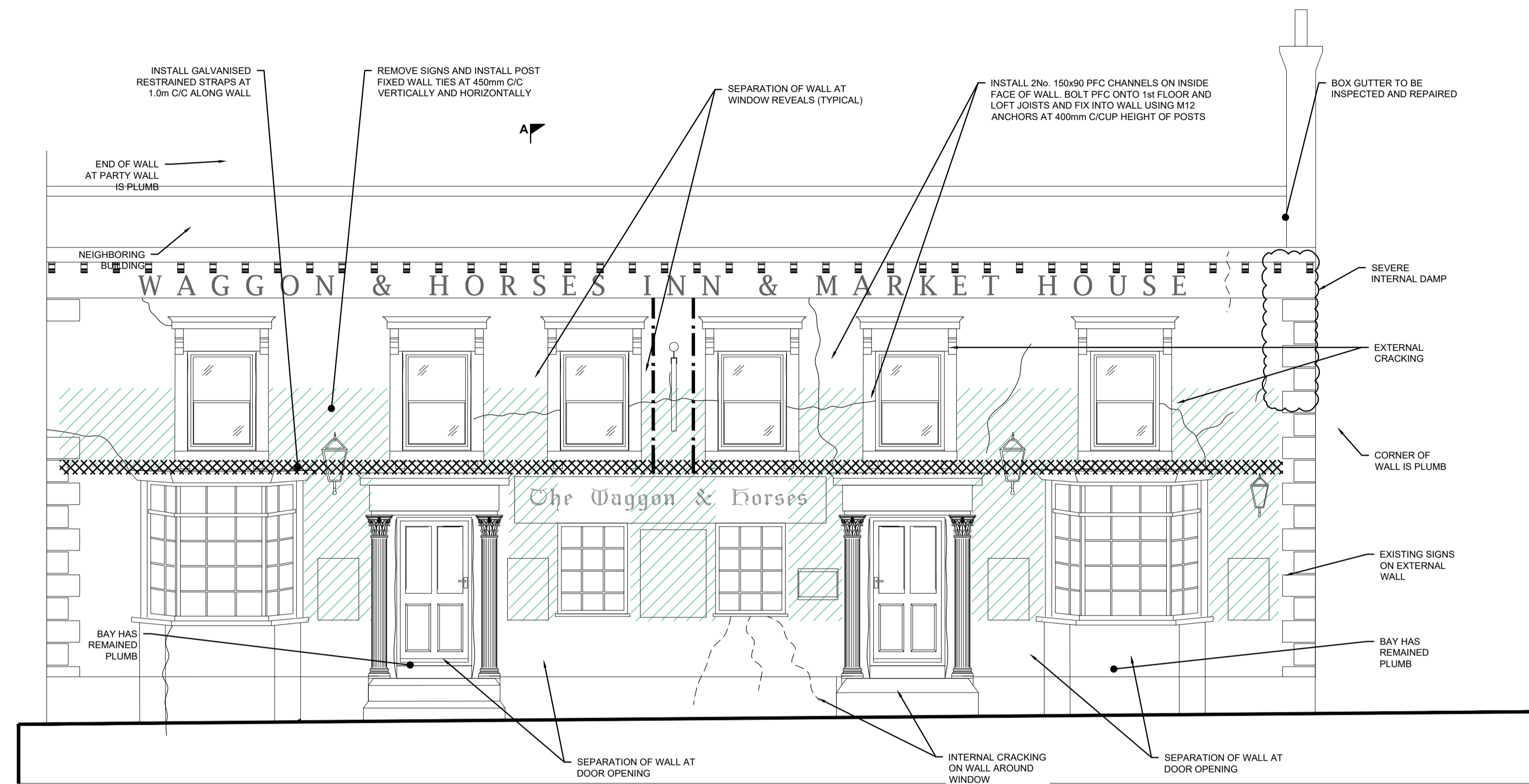

Proposed High Street Elevation

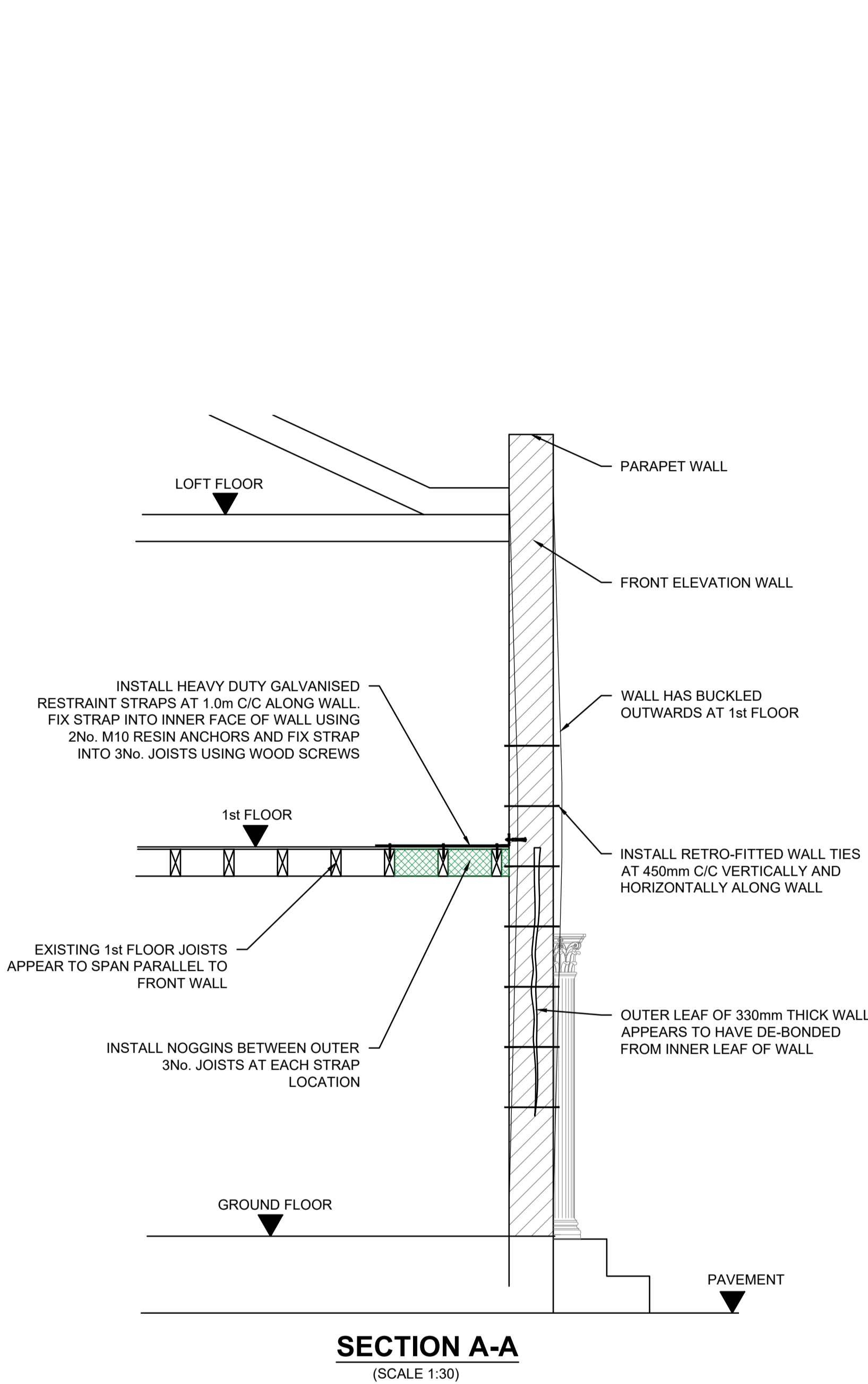
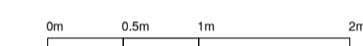

Existing High Street Elevation

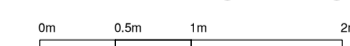

P0	Issued for Information	28/11/2023	AC
Rev	Description	Date	By



☎ 01689 875980
 ✉ design@ktastructures.co.uk
 🌐 ktastructures.co.uk

Client
GREENE KING

Job Title
**THE WAGGON AND HORSES
 NEWMARKET**

Drawing Title
**FRONT ELEVATION
 WALL STRENGTHENING
 DETAIL**

Drawn AC	Scale 1:50 at A1	Date NOV 2023
Drawing No. PR02		Rev -