

PLANNING APPLICATION

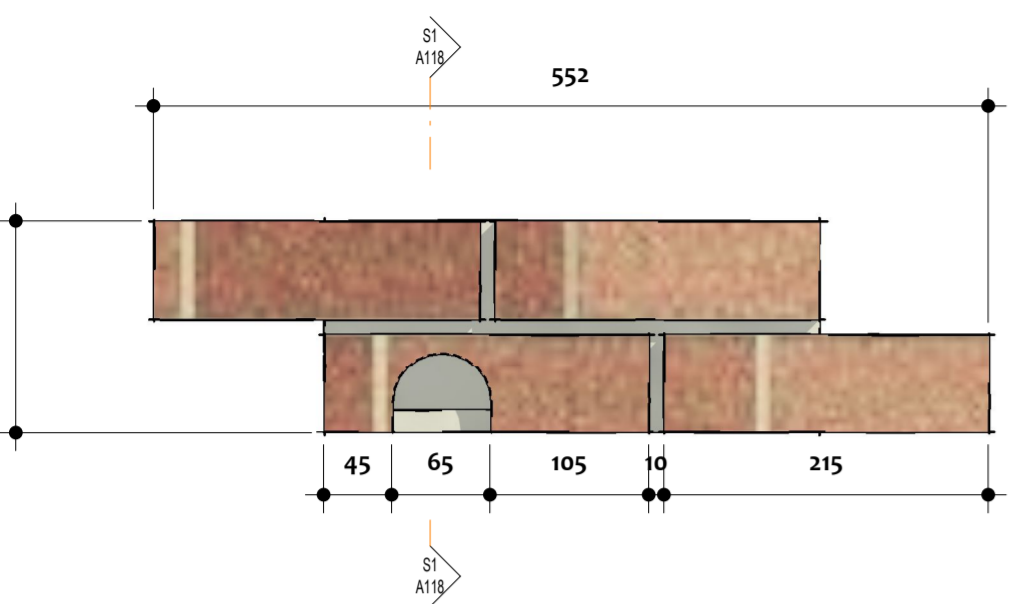

EL NEST ELEVATION
SCALE 1 : 3
SHEET REF: A111

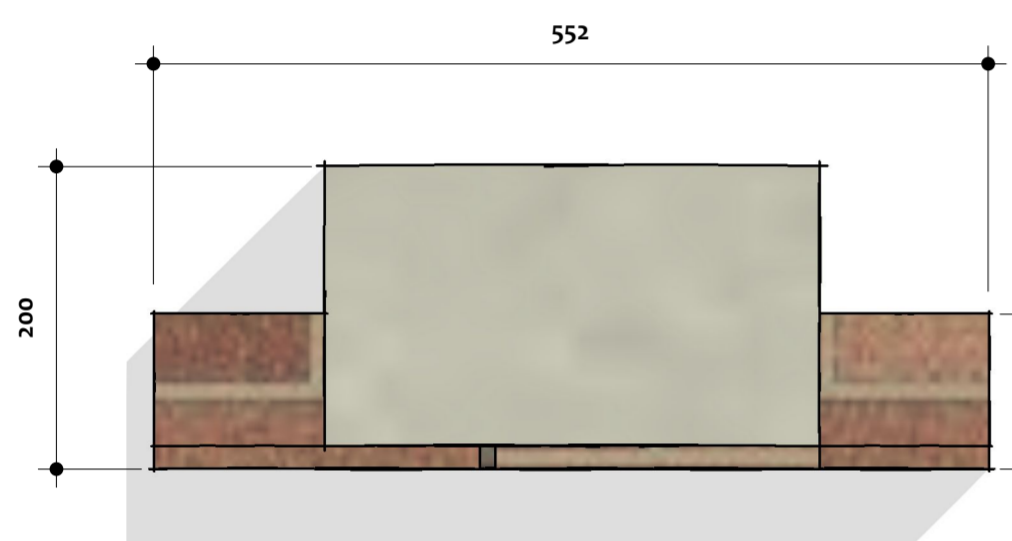

TP NEST TOP VIEW
SCALE 1 : 3

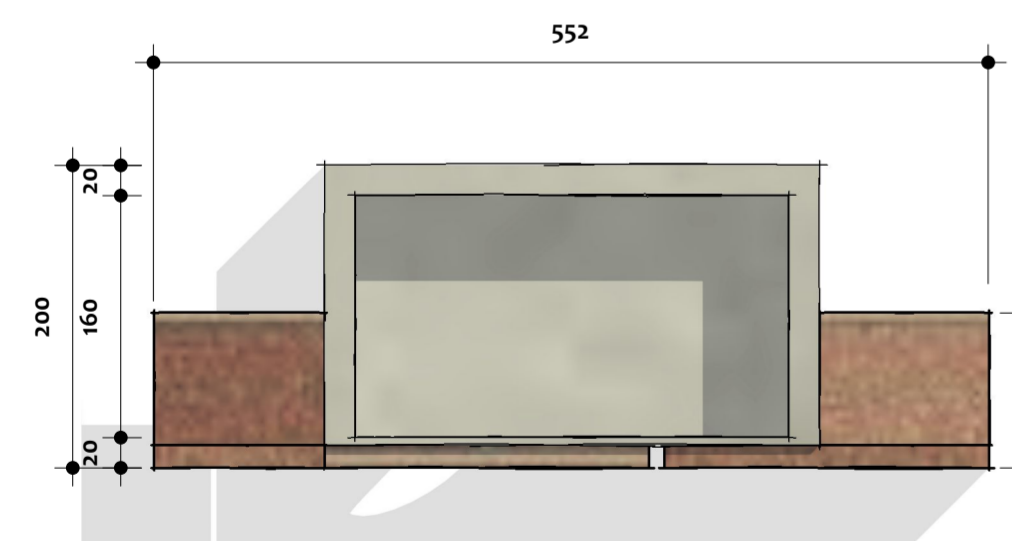

VI NEST CUT VIEW
SCALE 1 : 3

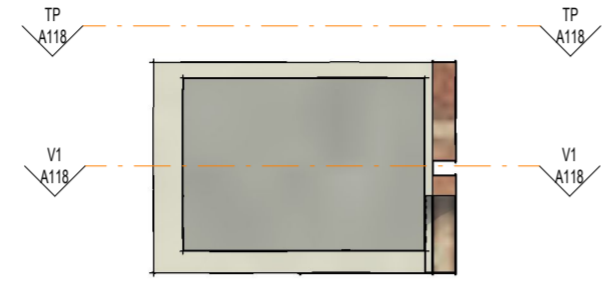

S1 NEST SECTION
SCALE 1 : 3

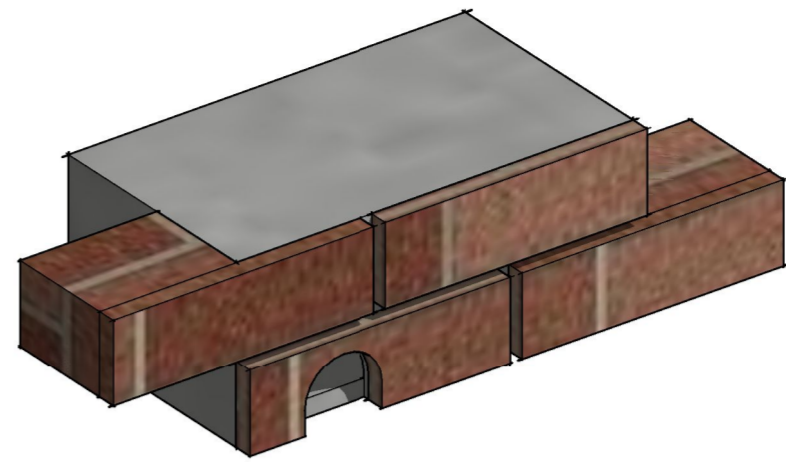

3D 3D BIRDS NEST
SCALE



BIRD BOXES

Wienerberger bird boxes are designed to seamlessly integrate into the façade of the building and fitted during the build stage of a new build project or fitted retrospectively to existing buildings. They can be an attractive feature for your building as well as providing the best possible artificial accommodation for a variety of different birds.

Constructed using insulating concrete block providing an internal roost space, they feature access holes of different sizes depending on the type of bird the bird box is for. The façade of the bird boxes can be clad in any Wienerberger brick from our extensive brick library of over 400 different brick types. We have a number of standard bird box designs and can also offer bespoke bird boxes to order.



Swifts



- Habibat Premium Swift Box**
- **Dimensions** 552mm wide x 140mm high x 200mm deep
 - **Material** Concrete plus facing brick

With its stretcher bond facing detail, the Premium Swift Box can be discreetly integrated into your design. Faced with any brick (from Wienerberger and other manufacturers) of your choice to ensure an aesthetically pleasing finish.



- Habibat Swift Box**
- **Dimensions** 328mm wide x 140mm high x 200mm deep
 - **Material** Concrete plus facing brick



- Habibat Swift Brick**
- **Dimensions** 215mm wide x 65mm high x 275mm deep
 - **Material** Concrete plus facing brick

Sparrows



- Habibat Premium Sparrow Nest Box**
- **Dimensions** 440mm wide x 215mm high x 150mm deep
 - **Material** Concrete plus facing brick



- Habibat Sparrow Nest Box**
- **Dimensions** 215mm wide x 215mm high x 150mm deep
 - **Material** Concrete plus facing brick



- Habibat Terraced Sparrow Box**
- **Dimensions** 665mm wide x 215mm high x 150mm deep
 - **Material** Concrete plus facing brick

