

Semi Mature Tree Pit Excavations

Strip topsoil from the area of the pit and set aside for re-use. Excavate sub-soil to achieve desired width and depth of tree pit and deposit away from site. Any stone, rubble, rubbish and other foreign debris that is exposed in the digging of the tree pits shall be similarly removed from site.

Fork over the base and sides of tree pits to thoroughly loosen the soil and to relieve compaction to a minimum depth of 250mm. All smooth, glazed or compacted sides to tree pits shall be loosened by forking to encourage lateral rooting.

Backfilling of Semi Mature Tree Pits

The lower half of the tree pit (below the rootball) shall be backfilled with:

- 300mm depth of 5 - 7mm diameter pea gravel
 - 300mm depth washed, medium/coarse sand
- (The bottom of the rootball of the tree shall sit within the sand layer and an aeration pipe shall be inserted around the rootball).

The upper section of the tree pit shall be backfilled with 500mm depth site topsoil, ameliorated with compost, fertiliser and sand (500mm depth to the surface).

The backfilling of the upper section of the tree pits shall be in layers using topsoil from site store, or imported topsoil in accordance with the specification.

Each backfill layer shall be 150mm deep and shall be lightly consolidated, thoroughly watered to expel air pockets and with due allowance being made for subsequent settlement.

When backfilling has been completed the Contractor is to mark the centre of the pit with a 1500mm long timber stake to mark pit for subsequent planting - stake to be removed during tree planting works.

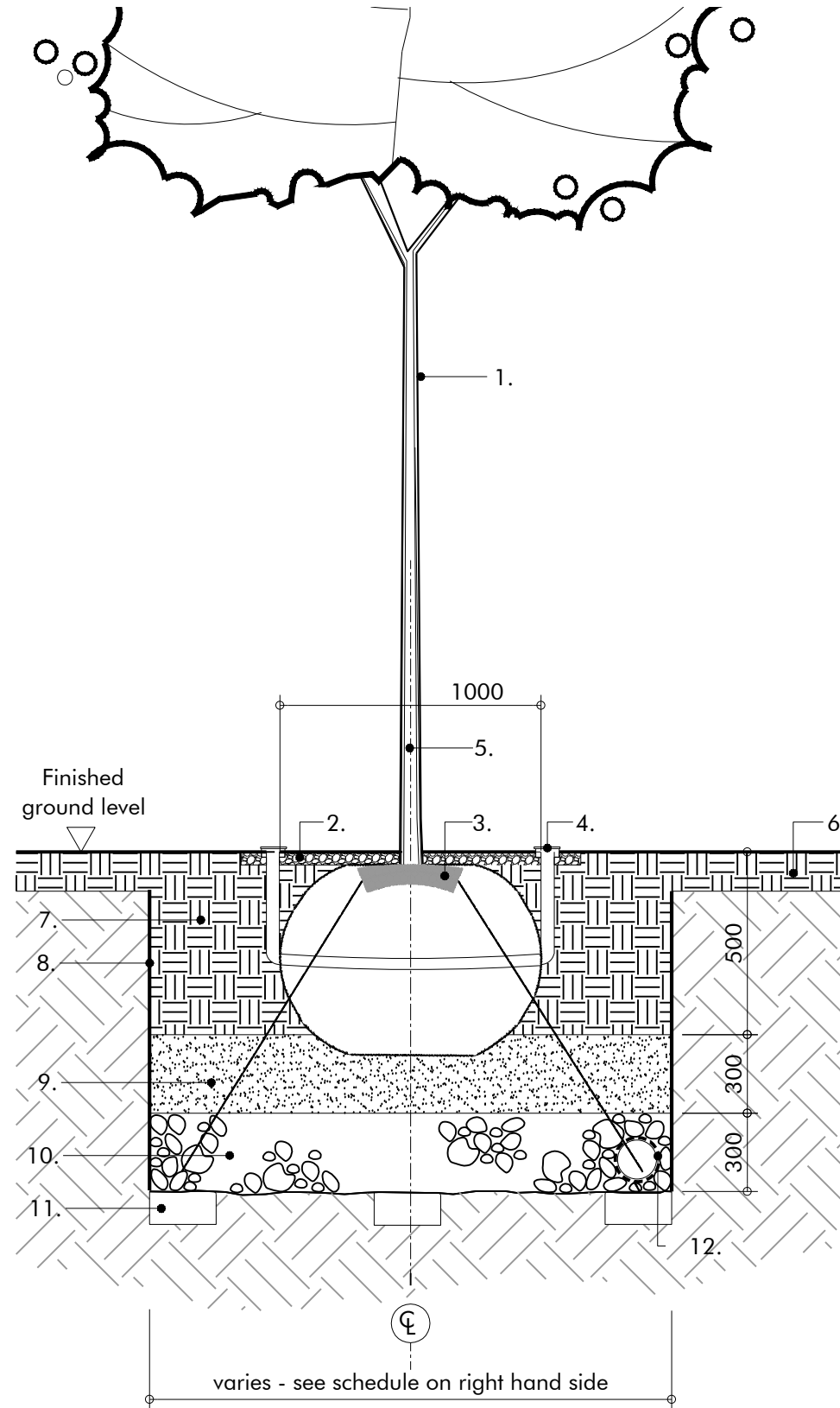

Tree size	Girth	Dimensions of Tree Pit
Semi Mature	25-40cm	1700 x 1700mm square
Semi Mature	2.5 - 4.0m ht multistem	1700 x 1700mm square
Semi Mature	20-25cm girth	1500 x 1500mm square

KEY

1. Semi-mature tree to be supplied and planted in accordance with the specification.
2. 50mm deep Melcourt 'Ornamental Grade Bark Mulch'.
3. Trees to be secured with Platipus 'Platimat' anchoring system fixed to tree anchors, as specified.
4. GreenBlue Urban aeration pipe, or similar approved, as specified.
5. Centre of tree pit to be marked with timber stake (Minimum 1500mm).
6. Topsoil as specified in adjacent planting area. Minimum 150mm deep for turfed areas and minimum 300mm for shrub planting.
7. Topsoil backfill to be laid as per specification: 500mm depth.
8. Sides and base of tree pit to be loosened in accordance with the specification.
9. 300mm medium coarse washed sand, as specified.
10. 300mm pea gravel 5-7mm Ø as specified.
11. "Deadman" anchor.
12. Positive drainage if required, 150mm perforated pipe wrapped with specified geotextile connected to drainage system to Civil Engineers details.

Rev	Description	Dwn by	Chkd by	Date	Notes:
P1	Draft	QZ	LP	10.11.2023	
P2	Draft	QZ	LP	01.12.2023	
P3	Draft	HW	LP	26.01.2024	
P4	For Planning	HW	LP	02.02.2024	

This drawing is protected by copyright. Contractors must check all dimensions on site. Only figure dimensions are to be worked from. Discrepancies must be reported to landscape architect before proceeding.

Macgregor Smith			
		www.macgregorsmith.co.uk 01225 464 690 hello@macgregorsmith.co.uk	
Project	Plot 4200 ARC Oxford	Drawn by	QZ
Status	Planning	Checked by	LP
Title	Tree Pit in Soft	Scale	1:25@A3
Drawing	1389-403	Revision	P4