

Grp No./ Tree No.	Species	Height / Spread	Category	Life Stage	Recommendations
G1	Betula utilis Jacquemontii	11	B2	Early - mature	Group of 3 trees Retain
G2	Tilia cordata	12	B2	Early - mature	Group of 3 trees Retain
G3	Sorbus aria	7	B2	Early - mature	Group of 2 trees Retain westerly tree Easterly tree lost as a result of the development
T4	Pinus nigra 'maritima'	14	B1	Mature	Retain Reduce eastern edge by 1m to accommodate access
G5	Acer pseudoplatanus	14	B2	Mature	Group of 2 off-site trees Retain
T6	Tilia cordata	11	B1	Early - mature	Retain
T7	Pinus nigra 'maritima'	13	B1	Mature	Retain
T8	Sorbus aria	6	C1	Semi - mature	Remove as a result of the development
T9	Tilia cordata	12	B1	Early - mature	Retain
G10	Betula utilis	14	B2	Mature	Group of 3 off-site trees Retain
T11	Tilia cordata	12	B1	Early - mature	Retain
T12	Pinus nigra 'maritima'	13	B1	Mature	Retain
T13	Sorbus aria	6	C1	Semi - mature	Remove as a result of the development
T14	Tilia cordata	10	B1	Early - mature	Retain
S15	Viburnum Tinus	4	C2	Early - mature	Retain Reduce the eastern side by 15m for car parking clearance
T16	Sorbus aria	7	C1	Semi - mature	Retain

Grp No./ Tree No.	Species	Height / Spread	Category	Life Stage	Recommendations
T17	Pyrus Species	7	C1	Semi - mature	Remove as a result of the development
T18	Pinus nigra 'maritima'	14	B1	Mature	Retain
T19	Acer pseudoplatanus	9	C1	Semi - mature	Off-site tree Retain
G20	Tilia cordata	12	B2	Early - mature	Group of 4 trees Retain
T21	Quercus palustris	6	U	Semi - mature	Off-site tree Dead. Remove as part of park maintenance
T22	Prunus Species	7	C1	Semi - mature	Off-site tree Retain
T23	Betula utilis Jacquemontii	11	B2	Early - mature	Group of 3 trees Retain
T24	Prunus Species	7	C1	Semi - mature	Off-site tree Retain
T25	Tilia cordata	12	B2	Early - mature	Retain
G26	Tilia cordata	12	B2	Early - mature	Group of 5 trees Retain. Northern tree in group - reduce NW edge of crown by 1.5m to accommodate construction access
T27	Tilia cordata	12	B2	Early - mature	Remove as a result of the development
G28	Pinus nigra 'maritima'	12	B2	Mature	Group of 2 trees Retain
T29	Pinus nigra 'maritima'	14	B1	Mature	Remove as a result of the development
T30	Tilia cordata	13	B1	Early - mature	Remove as a result of the development
T31	Tilia cordata	10	B1	Early - mature	Remove as a result of the development
T32	Tilia cordata	13	B1	Early - mature	Remove as a result of the development
T33	Pinus nigra 'maritima'	14	B1	Mature	Remove as a result of the development
T34	Pinus nigra 'maritima'	14	B1	Mature	Remove as a result of the development
T35	Cornus Species	4	C2	Mature	Remove as a result of the development

Grp No./ Tree No.	Species	Height / Spread	Category	Life Stage	Recommendations
T36	Carpinus betulus	9	C2	Semi - mature	Remove as a result of the development
T37	Prunus Species	7	C2	Semi - mature	Remove as a result of the development
T38	Cornus Species	4	C2	Mature	Remove as a result of the development
G39	Sorbus aria	8	B2	Early - mature	Group of 3 trees Retain
G40	Sorbus aria	8	B2	Semi - mature	Group of 3 trees Retain
T41	Pinus nigra 'maritima'	14	B1	Mature	Remove as a result of the development
G42	Tilia cordata	9	B2	Early - mature	Group of 3 trees Retain Remove as a result of the development
G43	Tilia cordata	9	B2	Early - mature	Group of 4 trees Retain most westerly tree as a result of the development. Retain other 3 trees. Southern tree in group - reduce western edge of crown to accommodate new access.
G44	Pinus nigra 'maritima'	10	B2	Early - mature	Group of 2 trees Retain

KEY

- Application boundary
- Retained tree
- Extent of root protection area modified due to site condition in line with Aspect Trees 'Tree Constraints Plan'
- Removed tree
- Removed vegetation
- Removed Lawn
- Tree Protection Fencing in accordance with Aspect Trees 'Tree Protection Plan' drawing G5879 TFP 24.10.23. Refer to Macgregor Smith drawing 1389-402 for detail and specification of tree protective fencing.

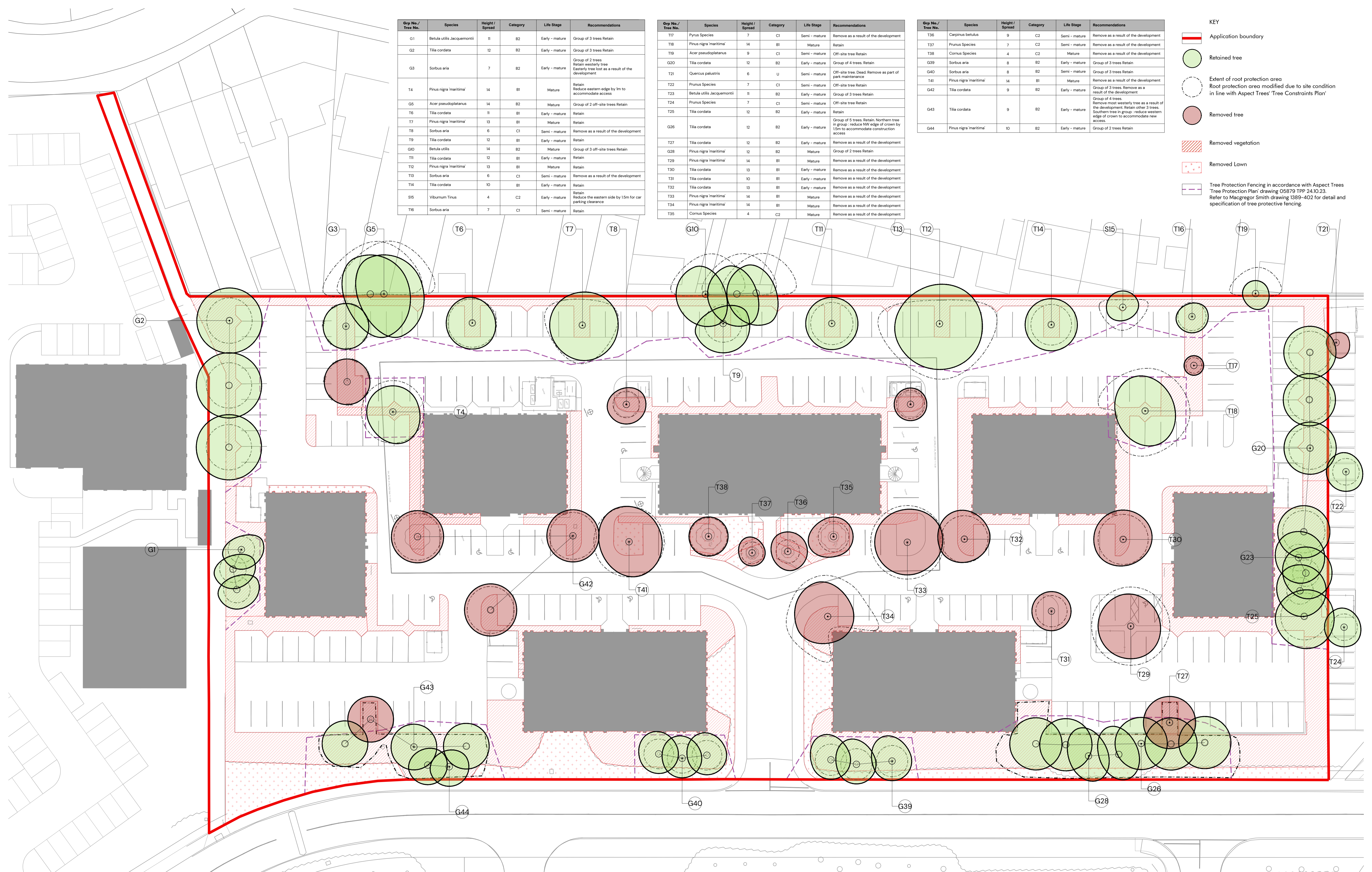

Rev	Description	Dwn by	Chkd by	Date	Notes:
P1	Draft	QZ	LP	10.11.2023	
P2	Draft	CZ	LP	01.12.2023	
P3	Draft	HW	LP	26.01.2024	
P4	For Planning	HW	LP	02.02.2024	

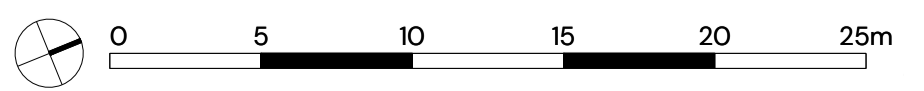

Macgregor Smith

www.macgregorsmith.co.uk
0225 464 690
hello@macgregorsmith.co.uk

Project	Plot 4200 ARC Oxford	Drawn by	QZ
Status	Planning	Checked by	LP
Title	Vegetation Retention and Removal Plan	Scale	1:250@A1
Drawing	1389-003	Revision	P4

This drawing is protected by copyright. Contractors must check all dimensions on site. Only figure dimensions are to be worked from. Discrepancies must be reported to landscape architect before proceeding.