

Figure 11: Illustrative View – Western Car Park



Figure 12: Illustrative View – Southern Terrace Plaza



Figure 13: Proposed Materials

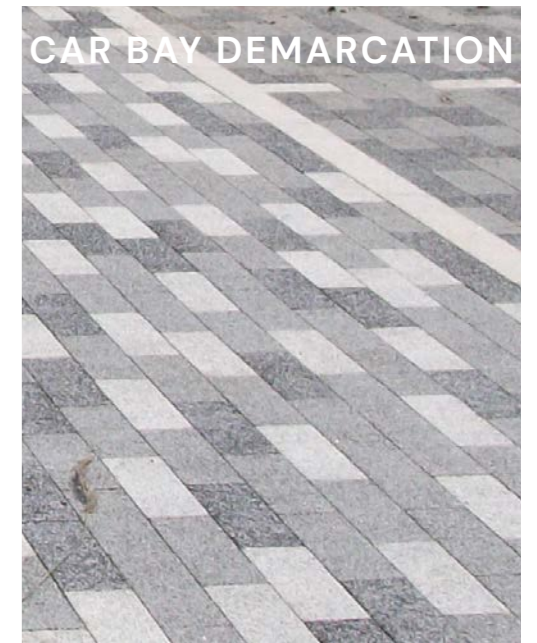
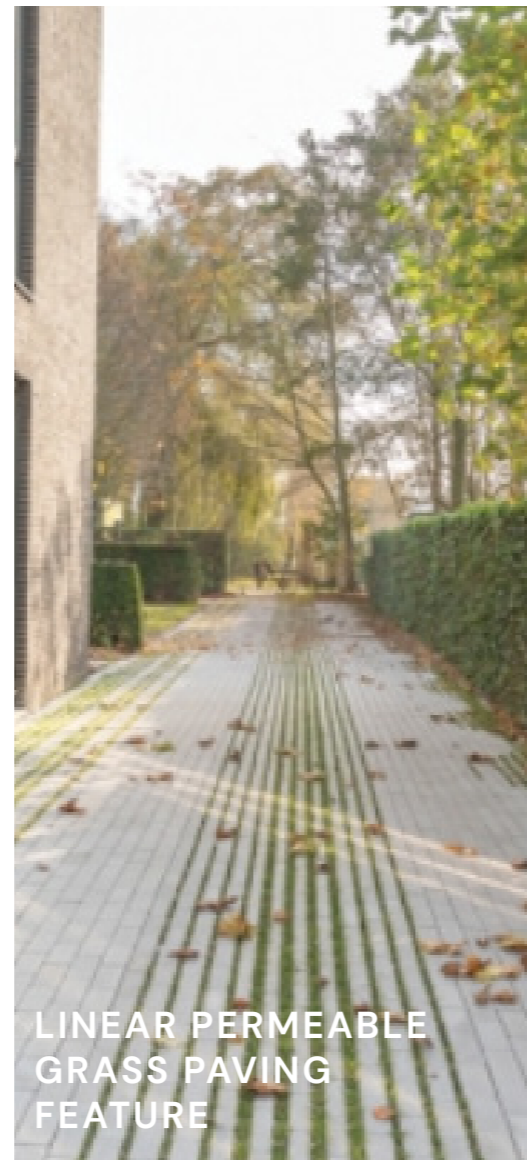

Figure 14: Proposed Materials

- Site Boundary
- Campus Boundary
- Block paviour to match existing to drop-off bay and new pavement
- High quality block paving to plazas and building frontage
Impermeable paved areas
Colour in pedestrian areas: Mix of 3 buff / grey tones in half-lapped staggered bond
Colour in vehicular areas: Blend of two buff tones to match pedestrian surfaces with bay demarcation in colour : light grey
- Permeable block paving to access routes and aisles
Colour: Buff / grey block in herringbone bond
- Permeable block paving to car bays
Mid grey blocks in half-lapped staggered bond
Colour: Light grey blocks to bay demarcation
- Non-Permeable block paving to car bays in RPAS of existing trees
Mid grey blocks in half-lapped staggered bond
Colour: Light grey blocks to bay demarcation
- Permeable linear grass paving feature between car bays
- 1m wide gravel margin at roof level
20-40mm diameter rounded gravel
- Porcelain paviour to roof terrace to match internal floor surface
- Roof level maintenance path
Concrete paving slabs forming 1.6m wide path
Colour: Natural
- Existing macadam to public footpath
- Existing block paving to road side pavement
- Macadam surfacing
Plot entrances
- Tactile units at road crossings
Colour: Dark grey

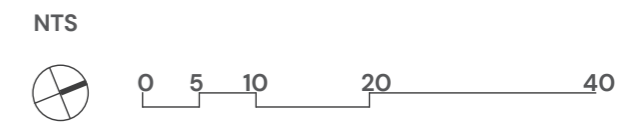
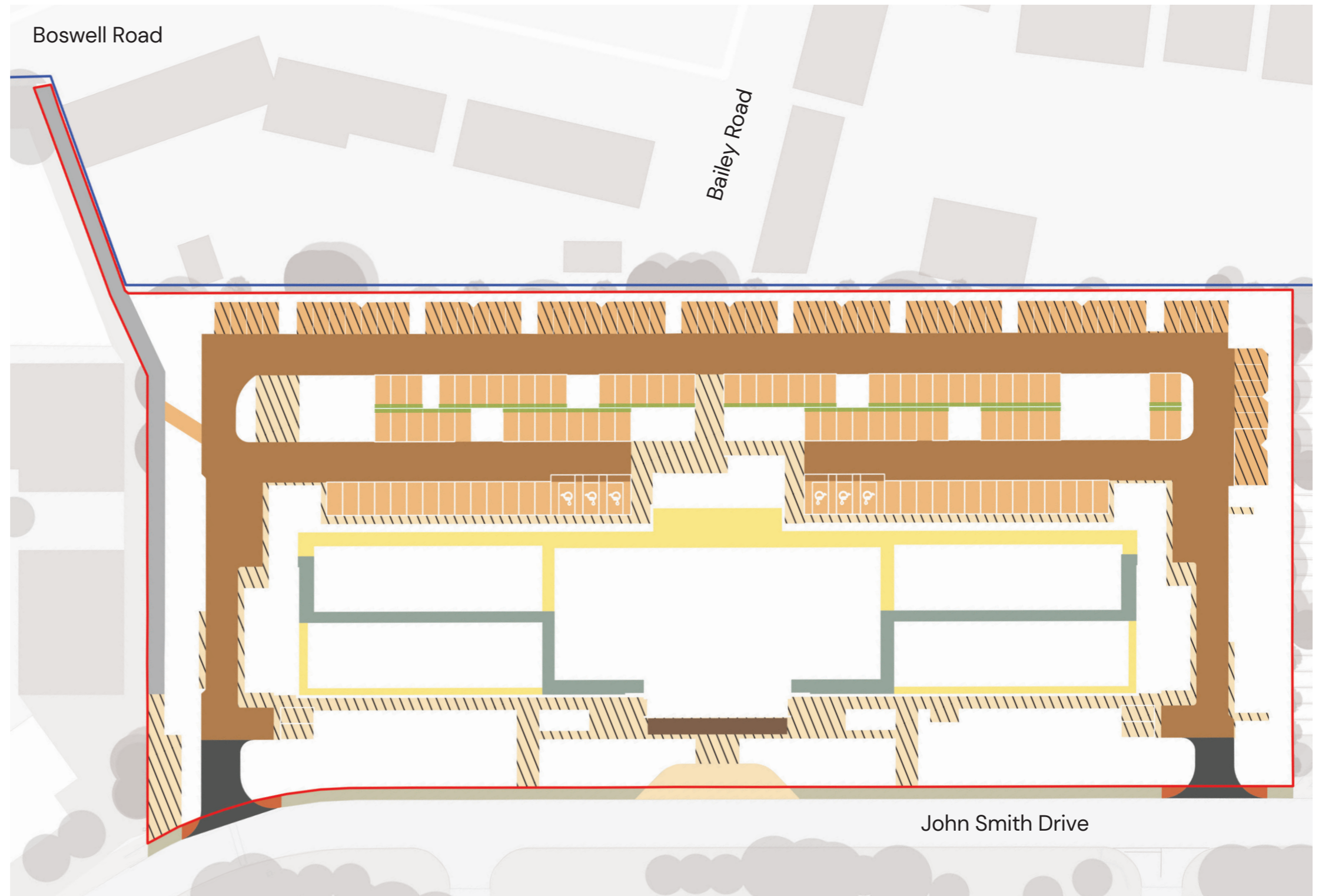

Figure 15: Boundary Conditions – Section A-AA

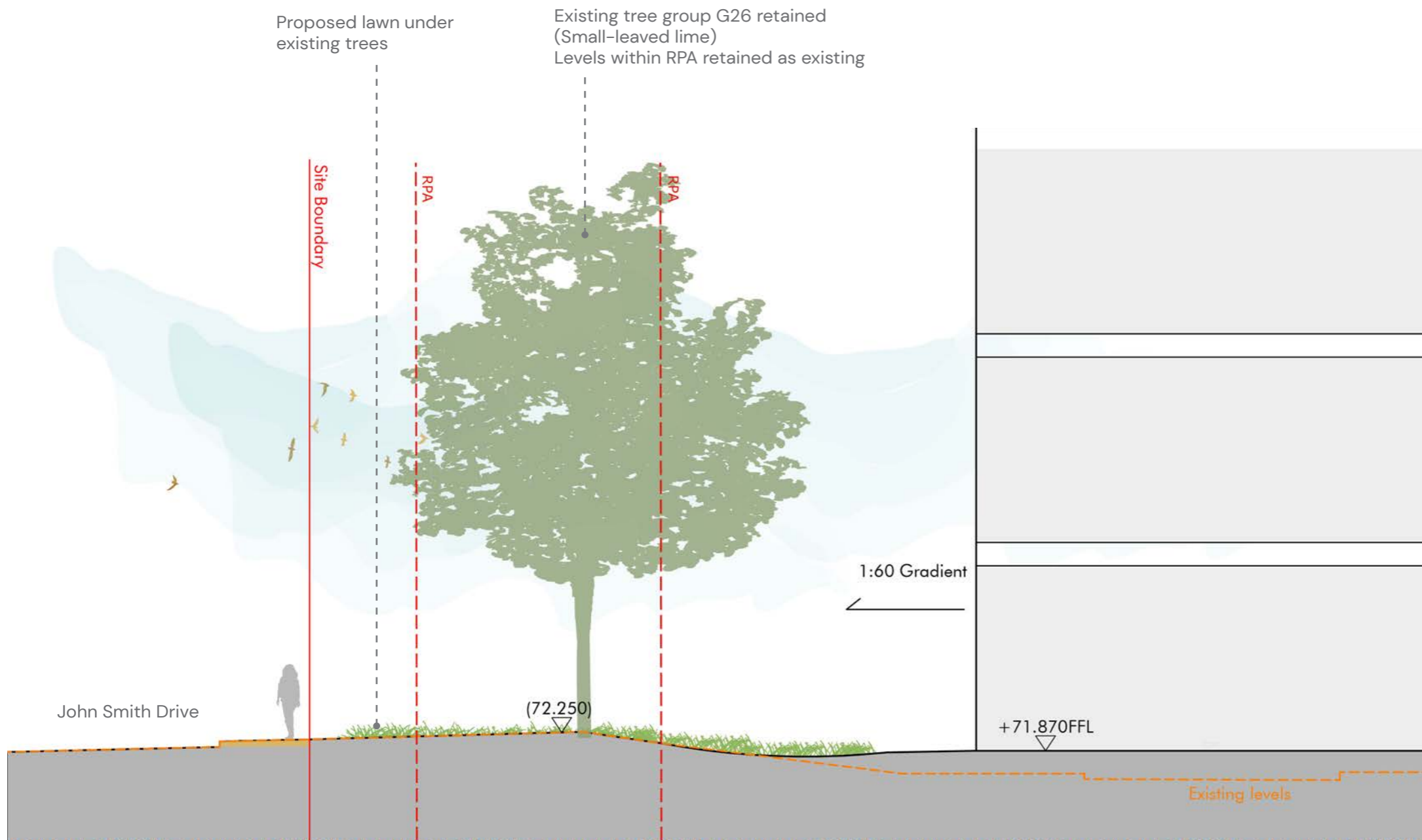
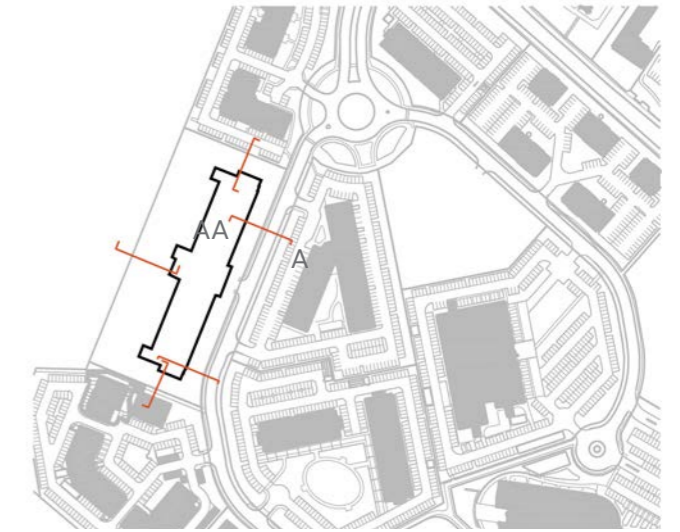

Figure 16: Boundary Conditions- Section B-BB

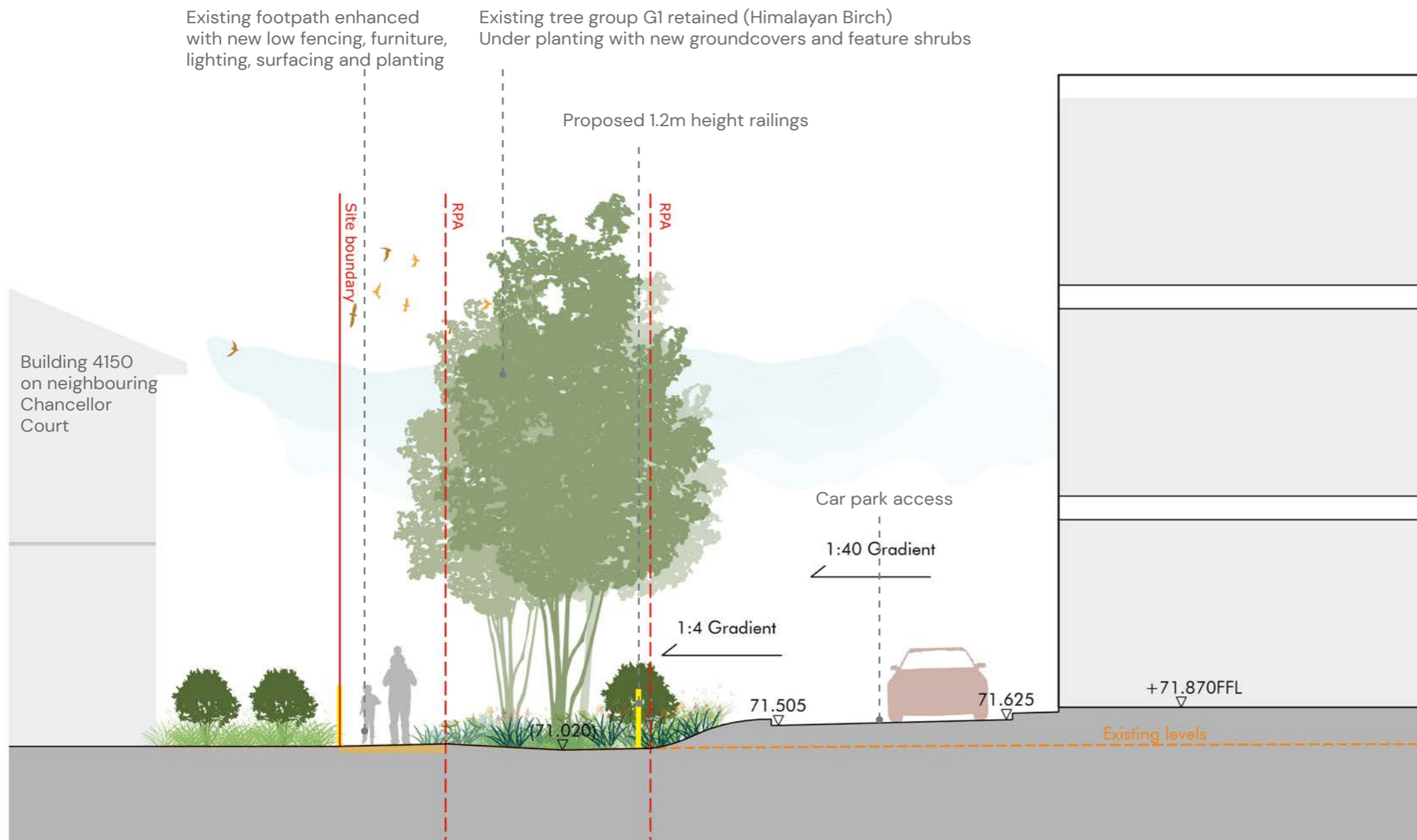
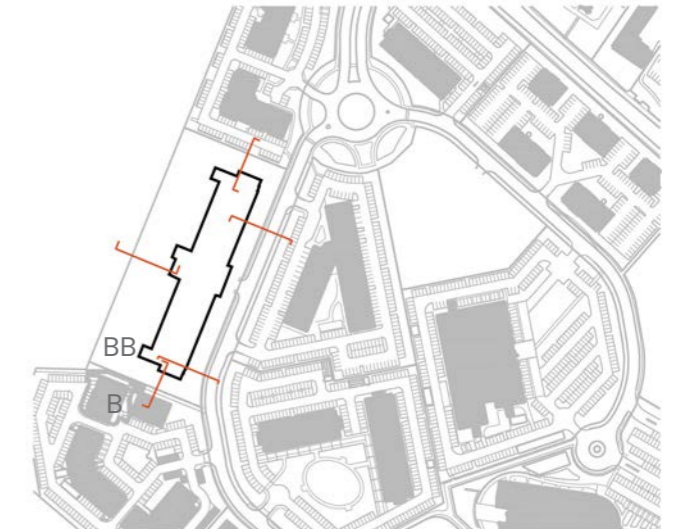
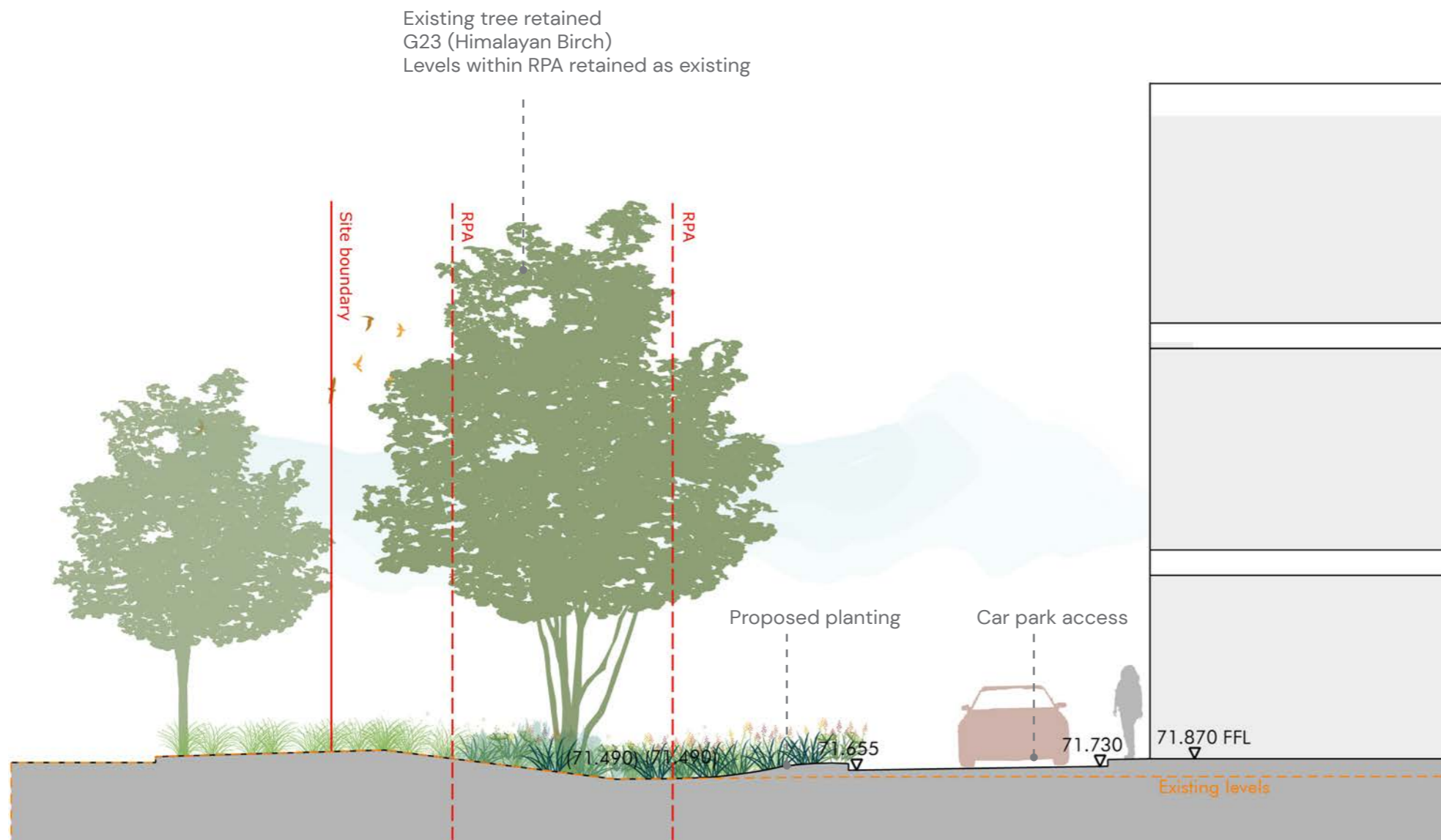
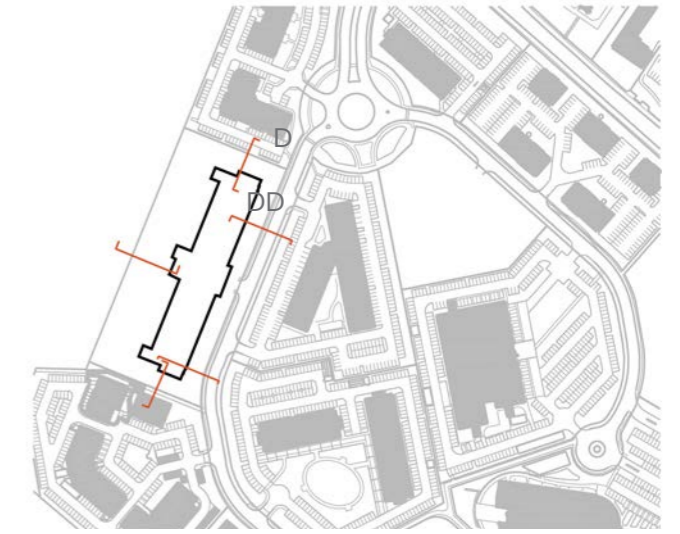

Figure 17: Boundary Conditions- Section C-CC



Figure 18: Boundary Conditions- Section D-DD



Macgregor Smith

Macgregor Smith
Christopher House
11-12 High Street
Bath, BA1 5AQ
01225 464 690

enquiries@macgregorsmith.co.uk
<http://www.macgregorsmith.co.uk>