

6.0 | DETAILED AREAS
6.4 | PUBLIC FOOTPATH AND SOUTHERN PLAZA



6.0 | DETAILED AREAS
6.4 | PUBLIC FOOTPATH AND SOUTHERN PLAZA



7.0 | LANDSCAPE STRATEGIES

7.0 | LANDSCAPE STRATEGIES

7.1 | TREE RETENTION STRATEGY

In collaboration with Spratley and Partners architects, the proposed scheme has been developed to allow for retention of all the site's 41 no. boundary trees, to ensure continuity of the campus' parkland character. This is achieved through careful positioning of the building and the retention of the peripheral car parking bay arrangement to ensure the root protection areas of these boundary trees are protected.

Removal of 20 no. trees within the internal site area will be required to facilitate the development : 13 no. Category B trees and 7 no. Category C trees. However, the car park has been carefully designed to allow for the retention of two existing large Pine trees, Trees T4 and T18, within new planted beds which encompass their root protection areas.

A further 7 no. trees were surveyed which are outside the site but close to application boundary. Tree T21 is dead and recommended for removal. The root protection areas of the remaining six off-site trees in Groups G5, G10 and Tree T22 have been modified due the higher levels beyond the western boundary, so that their root protection areas do not extend into the site area.

The strategy for the retention of the existing trees to the site's western boundary and north-west corner includes the retention of the car bay and edging kerb arrangement. The existing macadam surface will be removed and replaced with new block paving, but the underlying sub-base material will be retained in-situ to minimise root disturbance within the root protection areas of the existing retained trees.

Refer to the submitted Arboricultural Impact Assessment Report, Arboricultural Method Statement and Tree Protection Plan prepared by Aspect Trees for further detail.



- Site Boundary
- Campus Boundary
- Existing tree to be retained
- Existing tree to be removed
- Off-site surveyed trees

7.0 | LANDSCAPE STRATEGIES
7.2 | PLANTING STRATEGY

- Plot frontage and enhanced public footpath**
 - Wide planted beds mark the plot entrances, key amenity spaces and border the enhanced footpath
 - A rich mix of evergreen groundcovers and feature shrubs provide year-round foliage structure
 - Scattered flowering perennials attract pollinators and bring changing colours and forms through the seasons
 - Stands of tall grasses bring a dynamic element, visually connecting with the wider campus landscape
- Rain Garden**
 - Attractive gardens framing the building entrance designed to provide capacity to filter water run-off
 - A robust and adaptive groundcover layer of predominantly evergreen ferns and grasses suited to seasonally wet soils
 - Tall grasses and colourful flowering perennials bring colours, form and nectar sources
 - Feature specimens give structure and seasonal variation
- Car park and site boundaries**
 - Shady woodland character
 - A dense, lush groundcover of ferns and low grasses beneath existing and retained trees
 - Scattered flowering perennials provide seasonal colour and nectar for pollinators
 - Berry-ing plants provide structure and a food source for birds and small mammals
 - Taller shrubs and grasses form an attractive border on the car park's western edge
- Biodiversity Green roof**
 - A diverse open mosaic habitat which supports a wide range of invertebrates, flora and fauna
 - 40% of biodiversity roof area planted with 14 no. species of Sedum plugs
 - Sedum plugs provide a visually rich, drought tolerant groundcover giving instant impact during establishment period
 - 60% of biodiversity roof area planted with 24 no. species of drought tolerant native wildflower plugs

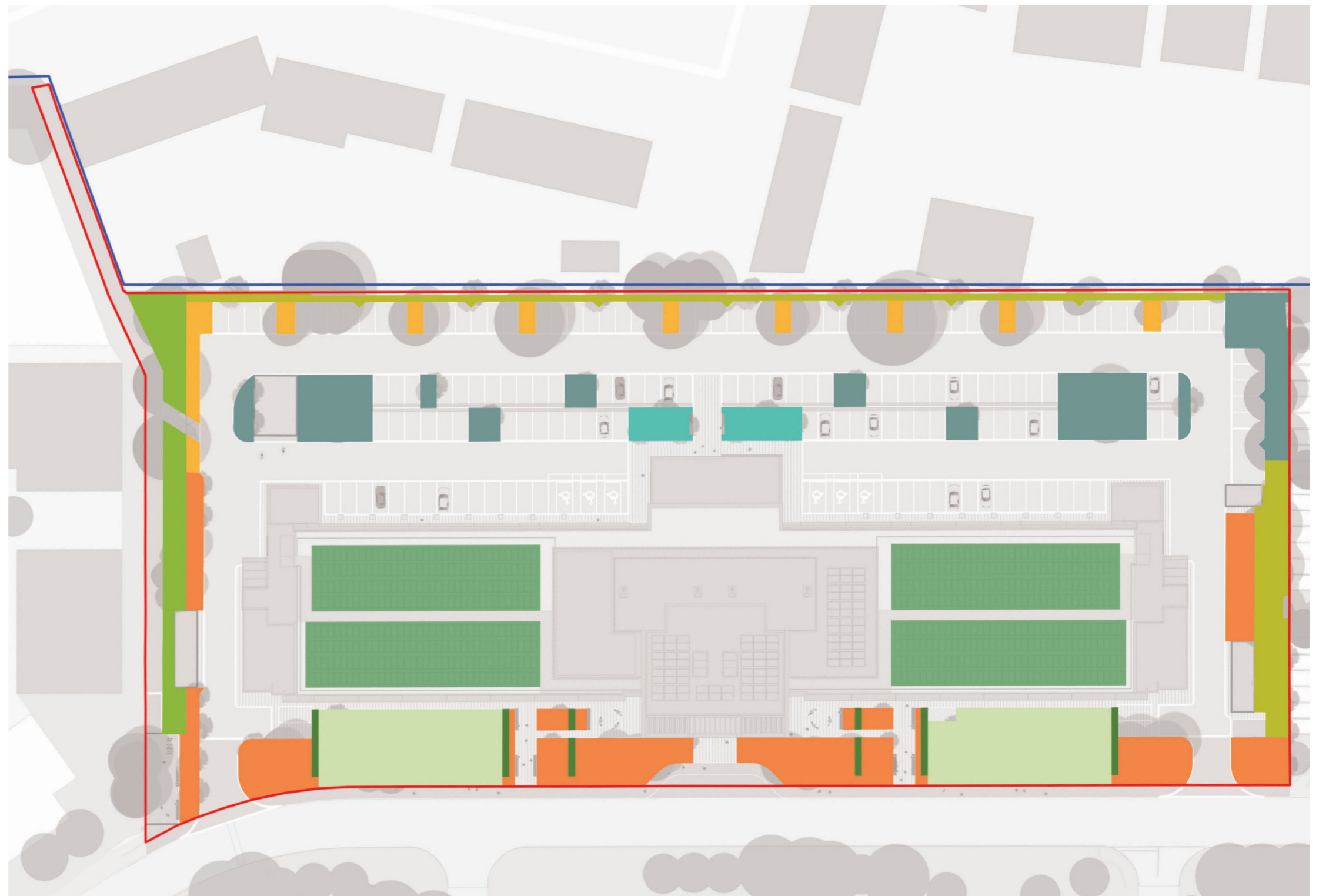

	Site Boundary		Planting Mix 3 – Car park finger beds and borders	NTS 	
	Campus Boundary		Planting Mix 4 – Plot frontage		
	Amenity lawn		Planting Mix 5 – Western and northern boundaries		Planting Mix 7 – Biodiversity Roof
	Planting Mix 1 – Rain Garden		Planting Mix 6 – Enhanced public footpath		
	Planting Mix 2 – Shade-tolerant car park beds		Proposed evergreen hedge		

7.0 | LANDSCAPE STRATEGIES
7.2 | PLANTING STRATEGY

PLANTING MIX 1 – RAIN GARDEN

Feature Specimens

- Amelanchier lamarkii* (15 litre plant)
- Rodgersia aesculifolia* (15 litre plant)

Groundcover layer

2 litre plants at density of 6 no. per m² in a random mix

- 5% *Dryopteris filix-mas*
- 10% *Luzula nivea*
- 10% *Molinia 'Moorhexe'*
- 10% *Polystichum setiferum*
- 15% *Sesleria autumnalis*

Seasonal Change Layer

2 litre plants at density of 6 no. per m² in a random mix

- 5% *Anemathele lessoniana*
- 5% *Anemone x hybrida 'Honorine Jobert'*
- 5% *Astrantia 'White Giant'*
- 10% *Calamagrostis 'Karl Foerster'*
- 10% *Calamagrostis brachytricha*
- 10% *Rudbeckia fulgida var. deamii*
- 5% *Sanguisorba 'Tanna'*



Amelanchier lamarkii



Rodgersia aesculifolia



Dryopteris filix-mas



Anemathele lessoniana



Calamagrostis brachytricha



Rudbeckia fulgida 'Deamii'



Anemone x hybrida 'Honorine Jobert'



Sanguisorba 'Tanna'



Sesleria autumnalis



7.0 | LANDSCAPE STRATEGIES
7.2 | PLANTING STRATEGY

PLANTING MIX 2 – SHADE-TOLERANT CAR PARK BEDS

Groundcover layer

2 litre plants at density of 6 no. per m² in a random mix

- 5% *Asplenium scolopendrium*
- 10% *Hakonechloa macra*
- 5% *Heuchera 'Autumn Bride'*
- 10% *Polystichum setiferum*
- 10% *Melica uniflora albida*
- 15% *Sesleria autumnalis*

Seasonal Change Layer

2 litre plants at density of 6 no. per m² in a random mix

- 5% *Anemone 'Honorine Jobert'*
- 5% *Anemanthele lessoniana*
- 5% *Astrantia 'Large White'*
- 5% *Dryopteris filix-mas*
- 15% *Molinia 'Moorhexe'*
- 10% *Sedum 'Matrona'*

PLANTING MIX 3 – CAR PARK FINGER BEDS AND BORDERS

Groundcover layer

2 litre plants at density of 6 no. per m² in a random mix

- 55% *Sesleria autumnalis*

Seasonal Change Layer

2 litre plants at density of 6 no. per m² in a random mix

- 15% *Polystichum setiferum*
- 15% *Molinia 'Moorhexe'*
- 15% *Sedum 'Matrona'*



Anemanthele lessoniana



Asplenium scolopendrium



Astrantia 'Large White'



Hakonechloa macra



Heuchera 'Autumn Bride'



Molinia 'Moorhexe'



Polystichum setiferum



Sedum 'Matrona'



Melica uniflora albida

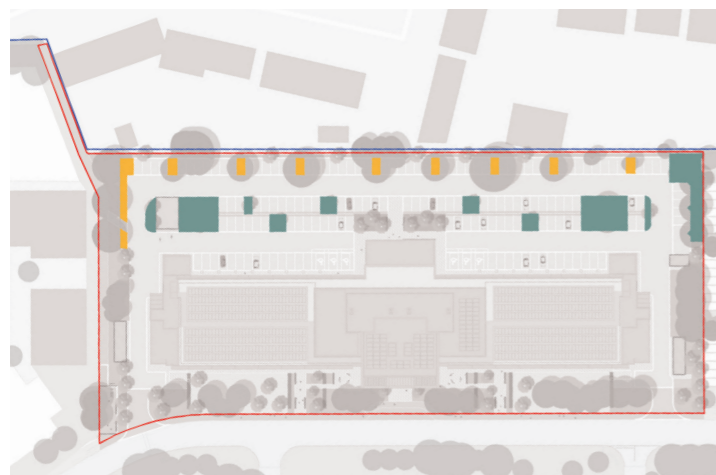

7.0 | LANDSCAPE STRATEGIES
7.2 | PLANTING STRATEGY

PLANTING MIX 4 – PLOT FRONTAGE

Feature Specimens
Hydrangea 'Little Lime' (15 litre plant)
Cornus alba 'Sibirica' (15 litre plant)

Groundcover Layer
 2 litre plants at density of 6 no. per m² in a random mix
 5% *Carex testacea*
 10% *Polystichum setiferum*
 10% *Prunus zabeliana*
 10% *Rosa 'Kent'*
 20% *Sesleria autumnalis*

Seasonal Change Layer
 2 litre plants at density of 6 no. per m² in a random mix
 5% *Achillea 'Terracotta'*
 10% *Calamagrostis 'Karl Foerster'*
 5% *Geum 'Mai Thai'*
 5% *Liatris spicata*
 5% *Perovskia 'Little Spire'*
 10% *Salvia nemorosa 'Caradonna'*
 5% *Verbena bonariensis*

PLANTING MIX 6 – ENHANCED PUBLIC FOOTPATH

Feature Specimens
Dryopteris affinis 'Cristata' (5 litre plant)
Hydrangea 'Little Lime' (15 litre plant)

Groundcover Layer
 2 litre plants at density of 7 no. per m² in a random mix
 10% *Hakonechloa macra*
 10% *Polystichum setiferum*
 10% *Prunus 'Low 'n' Green'*
 25% *Sesleria autumnalis*

Seasonal Change Layer
 2 litre plants at density of 7 no. per m² in a random mix
 5% *Achillea 'Terracotta'*
 15% *Calamagrostis 'Karl Foerster'*
 5% *Geum 'Mai Thai'*
 10% *Salvia 'Caradonna'*
 10% *Verbena bonariensis*

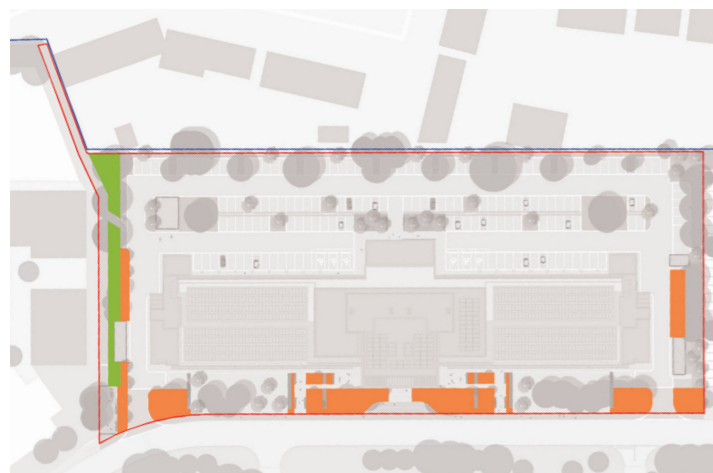

Achillea 'Terracotta'



Sesleria autumnalis



Calamagrostis 'Karl Foerster'



Hydrangea 'Little Lime'



Polystichum setiferum



Salvia nemorosa 'Caradonna'



Verbena bonariensis



Prunus 'Low 'n' Green'



Geum 'Mai Thai'

7.0 | LANDSCAPE STRATEGIES
7.2 | PLANTING STRATEGY

PLANTING MIX 5 – WESTERN AND NORTHERN BOUNDARIES

3 litre shrubs at density of 3 no. per m²

2 litre ferns and grasses at density of 6 no. per m²

15% *Cornus alba 'Sibirica'*

10% *Dryopteris filix-mas*

20% *Luzula sylvatica*

10% *Polystichum munitum*

25% *Pyracantha 'Saphyr Red'*

20% *Miscanthus 'Abundance'*



Dryopteris filix-mas



Cornus alba 'Sibirica'



Luzula sylvatica



Miscanthus 'Abundance'



Polystichum munitum



Pyracantha 'Saphyr Red'

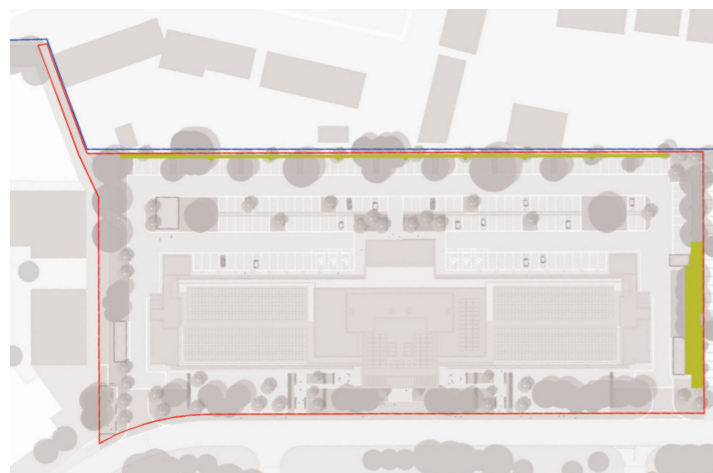

7.0 | LANDSCAPE STRATEGIES

7.2 | PLANTING STRATEGY

Planting Mix 7 – Biodiversity Roof

Succulents
40% of the overall biodiversity roof area is to be plug planted at 20 per m².

14%	Sedum album subspecies/varieties
14%	Sedum spurium subspecies/varieties
14%	Sedum reflexum subspecies/varieties
6%	Sedum acre
6%	Sedum ellacombianum
6%	Sedum hispanicum glaucum or var. minus
4%	Sedum hybridum 'Immergrunchen'
4%	Sedum kamtschaticum subspecies/varieties
4%	Sedum lydium
5%	Sedum oreganum
6%	Sedum reflexum
5%	Sedum sarmentosum
4%	Sedum sexangulare
8%	Sedum spathulifolium subspecies/varieties

Native Wildflowers
60% of the overall biodiversity roof area to be plug planted at 20 per m².

5%	Agrimonia eupatoria	Agrimony
5%	Anthyllis vulneraria	Kidney Vetch
5%	Briza media	Quaking grass
3%	Centaurea nigra	Common Knapweed
3%	Echium vulgare	Viper's Bugloss
5%	Galium verum	Lady's Bedstraw
2%	Hypericum perforatum	Perforate St. John's Wort
6%	Knautia arvensis	Field Scabious
5%	Koeleria macrantha	Crested Hair Grass
5%	Leontodon autumnalis	Autumn Hawkbit
5%	Leontodon hispidus	Rough Hawkbit
3%	Leucanthemum vulgare	Oxeye daisy
2%	Linaria vulgaris	Common Toadflax
5%	Lotus corniculatus	Birds-foot Trefoil
3%	Malva moschata	Musk mallow
3%	Origanum vulgare	Wild marjoram
3%	Plantago media	Hoary Plantain
5%	Primula veris	Cowslip
5%	Prunella vulgaris	Selfheal
5%	Ranunculus acris	Meadow Buttercup
5%	Ranunculus bulbosus	Bulbous Buttercup
3%	Reseda lutea	Wild Mignonette
5%	Sanguisorba minor	Salad Burnet
4%	Silene vulgaris	Bladder Campion

