

NOTES:- RESPONSIBILITY IS NOT ACCEPTED FOR ERRORS MADE BY OTHERS IN SCALING FROM THIS DRAWING. ALL CONSTRUCTION INFORMATION SHOULD BE TAKEN FROM FIGURED DIMENSIONS ONLY. ALL DIMENSIONS ARE IN MILLIMETERS

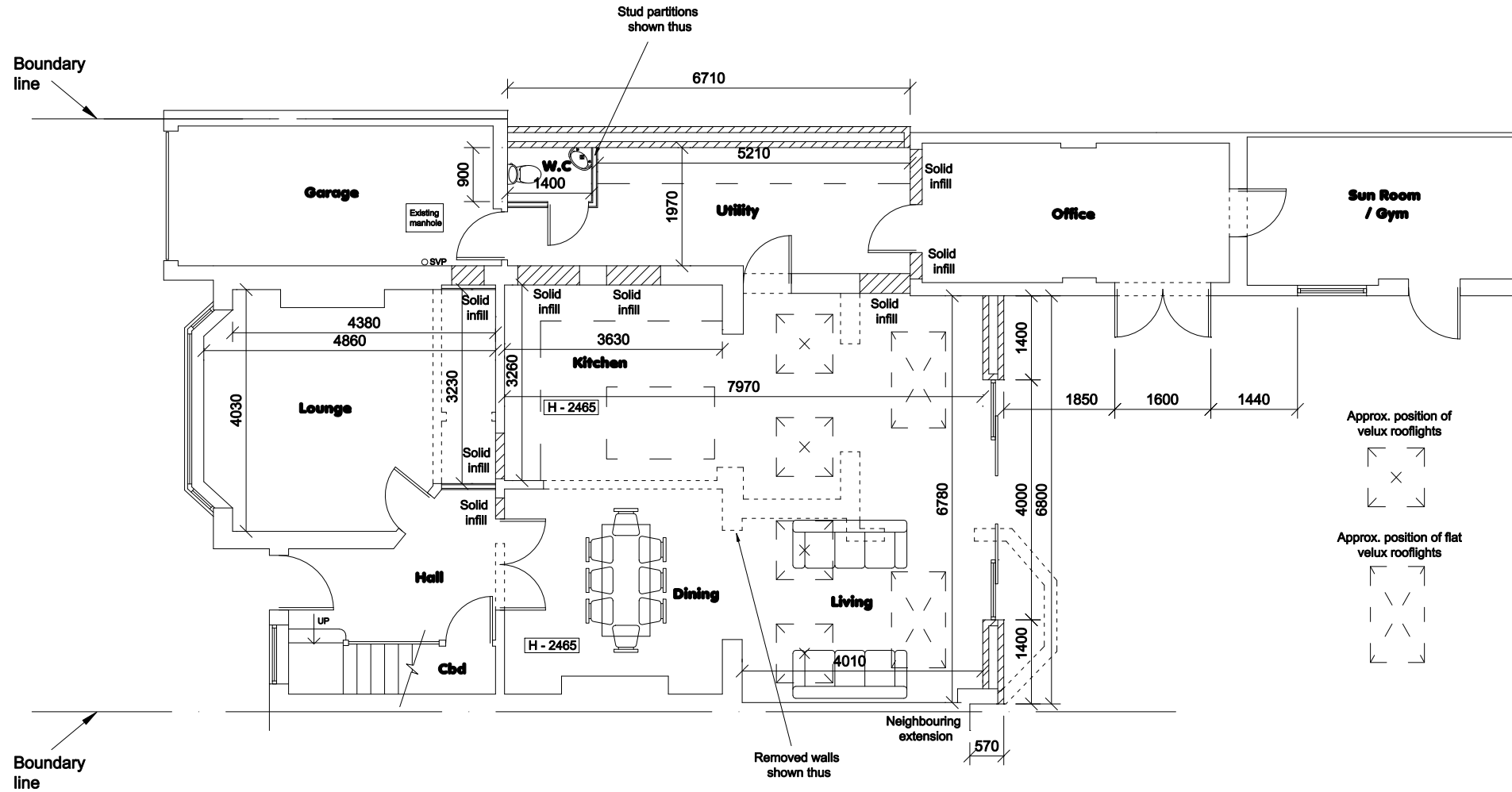

Clifton Design (Bristol)
 17 Lower Redland Road
 Redland
 Bristol
 BS6 6TB
 0117 973 6000

Rev:	Description of Changes:
-	-

Drawn:	Date:
-	-

Client:
Mr F Healy-Brown
Address:
59 Woodland Grove, Stoke Bishop

Postcode:	Drawing Title:
BS9 2BD	Ground Floor Plan - Proposed
Date:	Drawing No:
Feb 2024	59/WG/SB/02/P
Drawn: D.H	Option: -
Rev: -	

