



Below Photos Dated 01/09/2021:







Below Photos Dated 06/09/2021:





Below Photos Dated 08/09/2021:



APPENDIX 3

SCHEDULE OF DISPOSAL WASTE TRANSFER NOTES

JOB_NUMBER	DELIVERY_VEHICLE	DELIVERY_DRIVER	LOAD_DATE	WEIGHT	GOODS_DESCRIPTION	COLLECTION_ADDRESS1	DELIVERY_ADDRESS1	TICKET_NO
78049	NX66 AZA	S HARDY	26/08/2021	20220	SPOIL	PARSONS DEPOT	EBCHESTER	Notes: 1002033294
78050	NX66 AZA	S HARDY	26/08/2021	19220	SPOIL	PARSONS DEPOT	EBCHESTER	Notes: 1002033848
78051	NX66 AZA	S HARDY	26/08/2021	19020	SPOIL	PARSONS DEPOT	EBCHESTER	Notes: 1002034356
78052	NK17 VXA	M ROBERTS	26/08/2021	20000	SPOIL	PARSONS DEPOT	EBCHESTER	Notes: 75314 1002033323
78053	NK17 VXA	M ROBERTS	26/08/2021	20000	SPOIL	PARSONS DEPOT	EBCHESTER	Notes: 1002033958
78054	NK17 VXA	M ROBERTS	26/08/2021	20000	SPOIL	PARSONS DEPOT	EBCHESTER	Notes: 1002034485
78055	NX66 AZA	S HARDY	26/08/2021	19620	SPOIL	PARSONS DEPOT	EBCHESTER	Notes: 1002035055
78056	NK17 VXA	M ROBERTS	26/08/2021	20000	SPOIL	PARSONS DEPOT	EBCHESTER	Notes: 1002035133
78231	NX66 AZA	S HARDY	26/08/2021	19420	HARDCORE	PARSONS DEPOT	Biffa Washington	Notes: 51388
78328	NX66 AZA	S HARDY	26/08/2021	18340	SPOIL	PARSONS DEPOT	Biffa Washington	Notes:
79392	NJ70 ABX	S MILLER	08/09/2021	18740	SPOIL	PARSONS DEPOT	EBCHESTER	Notes: 1002061130
79499	NK20XWB	N BURNETT	08/09/2021	20000	SPOIL	PARSONS DEPOT	EBCHESTER	Notes: 61703
79500	NK20XWB	N BURNETT	08/09/2021	20000	SPOIL	PARSONS DEPOT	EBCHESTER	Notes: 62333
79501	NK20XWB	N BURNETT	08/09/2021	20000	SPOIL	PARSONS DEPOT	EBCHESTER	Notes: 62992
79507	NX66 AZA	S HARDY	09/09/2021	18580	SPOIL	PARSONS DEPOT	EBCHESTER	Notes: 1002064858
79508	NX66 AZA	S HARDY	09/09/2021	19280	SPOIL	PARSONS DEPOT	EBCHESTER	Notes: 1002065414
79509	NX66 AZA	S HARDY	09/09/2021	19880	SPOIL	PARSONS DEPOT	EBCHESTER	Notes: 1002066064
79511	NX66 AZA	S HARDY	08/09/2021	19320	SPOIL	PARSONS DEPOT	EBCHESTER	Notes: 1002061721
79512	NX66 AZA	S HARDY	08/09/2021	18780	SPOIL	PARSONS DEPOT	EBCHESTER	Notes: 1002062364
79513	NX66 AZA	S HARDY	08/09/2021	19180	SPOIL	PARSONS DEPOT	EBCHESTER	Notes: 1002061178
79515	NX66 AZA	S HARDY	08/09/2021	19880	SPOIL	PARSONS DEPOT	EBCHESTER	Notes: 1002063070
79516	NX68 NEF	I GALLACHE	09/09/2021	19200	SPOIL	PARSONS DEPOT	EBCHESTER	Notes: 1002064938
79517	NK20XWB	N BURNETT	08/09/2021	20000	SPOIL	PARSONS DEPOT	EBCHESTER	Notes: 61145
79519	NX19 NWK	R HIBBERT	08/09/2021	18440	SPOIL	PARSONS DEPOT	EBCHESTER	Notes: 61499
79520	NX19 NWK	R HIBBERT	08/09/2021	18570	SPOIL	PARSONS DEPOT	EBCHESTER	Notes: 62041
79521	NX65 BUA	G JONES	08/09/2021	18860	SPOIL	PARSONS DEPOT	EBCHESTER	Notes: 1002061714
79523	NX19 NWK	R HIBBERT	08/09/2021	19400	SPOIL	PARSONS DEPOT	EBCHESTER	Notes: 63224
79524	NX65 BUA	G JONES	08/09/2021	18580	SPOIL	PARSONS DEPOT	EBCHESTER	Notes: 1002061163
79525	NX19 NWK	R HIBBERT	08/09/2021	19180	SPOIL	PARSONS DEPOT	EBCHESTER	Notes: 63518
79528	NX16 AAZ	A KNIGTON	08/09/2021	19040	SPOIL	PARSONS DEPOT	EBCHESTER	Notes: 1002061190
79529	NX65 BUA	G JONES	08/09/2021	19400	SPOIL	PARSONS DEPOT	EBCHESTER	Notes: 1002062353
79530	NX65 BUA	G JONES	08/09/2021	18880	SPOIL	PARSONS DEPOT	EBCHESTER	Notes: 1002063058
79670	NJ70 ABX	S MILLER	08/09/2021	19240	SPOIL	PARSONS DEPOT	EBCHESTER	Notes: 1002061691
79671	NJ70 ABX	S MILLER	08/09/2021	19040	SPOIL	PARSONS DEPOT	EBCHESTER	Notes: 1002062326
79672	NJ70 ABX	S MILLER	08/09/2021	18640	SPOIL	PARSONS DEPOT	EBCHESTER	Notes: 1002062972
79673	NX16 AAZ	A KNIGTON	08/09/2021	18460	SPOIL	PARSONS DEPOT	EBCHESTER	Notes: 1002061734
79674	NX16 AAZ	A KNIGTON	08/09/2021	18660	SPOIL	PARSONS DEPOT	EBCHESTER	Notes:
79675	NX16 AAZ	A KNIGTON	08/09/2021	18960	SPOIL	PARSONS DEPOT	EBCHESTER	Notes: 1002063033
79824	NX66 AZA	S HARDY	09/09/2021	19980	SPOIL	PARSONS DEPOT	EBCHESTER	Notes: 1002064241
79825	NX19 NWK	R HIBBERT	09/09/2021	18280	SPOIL	PARSONS DEPOT	EBCHESTER	Notes: 81787
79826	NX68 NEF	I GALLACHE	09/09/2021	19800	SPOIL	PARSONS DEPOT	EBCHESTER	Notes: 1002064319
79827	NK18 WHG	D BURNETT	09/09/2021	20000	SPOIL	PARSONS DEPOT	EBCHESTER	Notes: 2064345

79828 NX19 NWK	R HIBBERT	09/09/2021	19280 SPOIL	PARSONS DEPOT	EBCHESTER	Notes: 64919
79829 NX19 NWM	G DALGLISH	09/09/2021	18200 SPOIL	PARSONS DEPOT	EBCHESTER	Notes: 1002065038
79830 NX19 NWM	G DALGLISH	09/09/2021	18300 SPOIL	PARSONS DEPOT	EBCHESTER	Notes: 1002064370
79831 NX19 NWM	G DALGLISH	09/09/2021	18040 SPOIL	PARSONS DEPOT	EBCHESTER	Notes: 1002065600
79832 NX19 NWM	G DALGLISH	09/09/2021	18200 SPOIL	PARSONS DEPOT	EBCHESTER	Notes: 1002066350
79869 NJ70 ABX	S MILLER	08/09/2021	17740 SPOIL	PARSONS DEPOT	EBCHESTER	Notes: 1002063482
79870 NK20XWB	N BURNETT	08/09/2021	20000 SPOIL	PARSONS DEPOT	EBCHESTER	Notes: 63497
79871 NK18 WHG	D BURNETT	09/09/2021	20000 SPOIL	PARSONS DEPOT	EBCHESTER	Notes: 2064967
79872 NK18 WHG	D BURNETT	09/09/2021	20000 SPOIL	PARSONS DEPOT	EBCHESTER	Notes: d burnett
79873 NK18 WHG	D BURNETT	09/09/2021	20000 SPOIL	PARSONS DEPOT	EBCHESTER	Notes: 2066655
79874 NK18 WHG	D BURNETT	09/09/2021	20000 SPOIL	PARSONS DEPOT	EBCHESTER	Notes:
79875 NJ70 ABX	S MILLER	13/09/2021	18820 SPOIL	PARSONS DEPOT	EBCHESTER	Notes: 1002071581
79876 NX66 AZA	S HARDY	09/09/2021	19680 SPOIL	PARSONS DEPOT	EBCHESTER	Notes: 1002066738
79877 NX19 NWK	R HIBBERT	09/09/2021	18540 SPOIL	PARSONS DEPOT	EBCHESTER	Notes: 65402
79878 NX19 NWK	R HIBBERT	09/09/2021	18580 SPOIL	PARSONS DEPOT	EBCHESTER	Notes: 66132
79879 NX19 NWK	R HIBBERT	09/09/2021	17980 SPOIL	PARSONS DEPOT	EBCHESTER	Notes: 66747
79880 NX68 NEF	I GALLACHE	09/09/2021	19180 SPOIL	PARSONS DEPOT	EBCHESTER	Notes: 1002065435
79881 NX68 NEF	I GALLACHE	09/09/2021	19180 SPOIL	PARSONS DEPOT	EBCHESTER	Notes: 1002066157
79882 NJ70 ABZ	J WATSON	13/09/2021	18560 SPOIL	PARSONS DEPOT	EBCHESTER	Notes: 1002071433
79885 NX16 AAZ	A KNIGHTON	08/09/2021	18960 SPOIL	PARSONS DEPOT	EBCHESTER	Notes: 1002063504
79893 NX65 BUA	G JONES	08/09/2021	18880 SPOIL	PARSONS DEPOT	EBCHESTER	Notes: 1002063512
79894 NX66 AZA	S HARDY	08/09/2021	18780 SPOIL	PARSONS DEPOT	EBCHESTER	Notes: 1002063522
79940 NX68 NEJ	M WOODHOUS	09/09/2021	20120 SPOIL	PARSONS DEPOT	EBCHESTER	Notes: 10020647307
79941 NX68 NEJ	M WOODHOUS	09/09/2021	19320 SPOIL	PARSONS DEPOT	EBCHESTER	Notes: 1002064931
79942 NX68 NEJ	M WOODHOUS	09/09/2021	19320 SPOIL	PARSONS DEPOT	EBCHESTER	Notes: 1002065427
79943 NX68 NEJ	M WOODHOUS	09/09/2021	19320 SPOIL	PARSONS DEPOT	EBCHESTER	Notes: 1002066153
79955 NK18 WHG	D BURNETT	10/09/2021	20000 SPOIL	PARSONS DEPOT	EBCHESTER	Notes:
79956 NK18 WHG	D BURNETT	10/09/2021	20000 SPOIL	PARSONS DEPOT	EBCHESTER	Notes: 2068298
79975 NK20XWB	N BURNETT	10/09/2021	20000 SPOIL	PARSONS DEPOT	EBCHESTER	Notes: 67665
79976 NX68 NEJ	M WOODHOUS	10/09/2021	20620 SPOIL	PARSONS DEPOT	EBCHESTER	Notes: 1002067595
79977 NX19 NWM	G DALGLISH	10/09/2021	18400 SPOIL	PARSONS DEPOT	EBCHESTER	Notes: 1002067577
79978 NX68 NEF	I GALLACHE	10/09/2021	19500 SPOIL	PARSONS DEPOT	EBCHESTER	Notes: 1002067603
79979 NX19 NWK	R HIBBERT	10/09/2021	20000 SPOIL	PARSONS DEPOT	EBCHESTER	Notes: 67676
79980 NK18 WHG	D BURNETT	10/09/2021	20000 SPOIL	PARSONS DEPOT	EBCHESTER	Notes:
80019 NK18 WHG	D BURNETT	10/09/2021	20000 SPOIL	PARSONS DEPOT	EBCHESTER	Notes: 2069566
80020 NX68 NEJ	M WOODHOUS	10/09/2021	19320 SPOIL	PARSONS DEPOT	EBCHESTER	Notes: 1002069753
80021 NX68 NEJ	M WOODHOUS	10/09/2021	19320 SPOIL	PARSONS DEPOT	EBCHESTER	Notes: 1002068255
80022 NX68 NEJ	M WOODHOUS	10/09/2021	19320 SPOIL	PARSONS DEPOT	EBCHESTER	Notes: 1002069204
80023 NX19 NWM	G DALGLISH	10/09/2021	18380 SPOIL	PARSONS DEPOT	EBCHESTER	Notes: 1002068248
80024 NX19 NWM	G DALGLISH	10/09/2021	18200 SPOIL	PARSONS DEPOT	EBCHESTER	Notes: 1002068708
80025 NX19 NWM	G DALGLISH	10/09/2021	18000 SPOIL	PARSONS DEPOT	EBCHESTER	Notes: 1002069597
80026 NX68 NEF	I GALLACHE	10/09/2021	20200 SPOIL	PARSONS DEPOT	EBCHESTER	Notes: 1002068263
80027 NX68 NEF	I GALLACHE	10/09/2021	19180 SPOIL	PARSONS DEPOT	EBCHESTER	Notes: 1002069207

80028 NX68 NEF	I GALLACHE	10/09/2021	19180 SPOIL	PARSONS DEPOT	EBCHESTER	Notes: 10020069754
80029 NX19 NWK	R HIBBERT	10/09/2021	20000 SPOIL	PARSONS DEPOT	EBCHESTER	Notes: 68348
80030 NX19 NWK	R HIBBERT	10/09/2021	20380 SPOIL	PARSONS DEPOT	EBCHESTER	Notes: 68904
80031 NX19 NWK	R HIBBERT	10/09/2021	20000 SPOIL	PARSONS DEPOT	EBCHESTER	Notes: 69665
80102 NK20XWB	N BURNETT	10/09/2021	20000 SPOIL	PARSONS DEPOT	EBCHESTER	Notes: 68334
80103 NK20XWB	N BURNETT	10/09/2021	20000 SPOIL	PARSONS DEPOT	EBCHESTER	Notes: 68888
80104 NK20XWB	N BURNETT	10/09/2021	20000 SPOIL	PARSONS DEPOT	EBCHESTER	Notes: 69641
80105 NK20XWC	J DUNNING	13/09/2021	20000 SPOIL	PARSONS DEPOT	EBCHESTER	Notes: 1002071505
80106 NJ19 AWN	T HOWARD	13/09/2021	20000 SPOIL	PARSONS DEPOT	EBCHESTER	Notes:
80107 NX16 ACZ	D PEART	13/09/2021	19000 SPOIL	PARSONS DEPOT	EBCHESTER	Notes: 1002072137
80173 NU17 KXR	J CURTS	10/09/2021	20000 SPOIL	PARSONS DEPOT	EBCHESTER	Notes:
80174 NX18 NNR	J RUSSELL	10/09/2021	20000 SPOIL	PARSONS DEPOT	EBCHESTER	Notes:
80175 NK66 LMV	N KING	10/09/2021	20000 SPOIL	PARSONS DEPOT	EBCHESTER	Notes:
80176 NX65 BUA	G JONES	10/09/2021	18880 SPOIL	PARSONS DEPOT	EBCHESTER	Notes: 1002070013
80211 NU17 KYR	A DUNCAN	13/09/2021	20000 SPOIL	PARSONS DEPOT	EBCHESTER	Notes: 1002071519
80212 NK17 VXB	A CHAPMAN	10/09/2021	18860 SPOIL	PARSONS DEPOT	EBCHESTER	Notes: 1002070022
80226 NJ70 ABZ	J WATSON	14/09/2021	18260 SPOIL	PARSONS DEPOT	EBCHESTER	Notes: 1002075218
80227 NJ70 ABZ	J WATSON	14/09/2021	18060 SPOIL	PARSONS DEPOT	EBCHESTER	Notes: 1002074621
80228 HIRE	J DUNNING	14/09/2021	20000 SPOIL	PARSONS DEPOT	EBCHESTER	Notes: 1002074730
80231 NX16 ACZ	D PEART	14/09/2021	18440 SPOIL	PARSONS DEPOT	EBCHESTER	Notes: 1002077384
80232 NX66 AZA	S HARDY	13/09/2021	18280 SPOIL	PARSONS DEPOT	EBCHESTER	Notes: 1002071459
80236 NJ70 ABZ	J WATSON	13/09/2021	19160 SPOIL	PARSONS DEPOT	EBCHESTER	Notes: 1002071943
80237 NJ70 ABZ	J WATSON	13/09/2021	19060 SPOIL	PARSONS DEPOT	EBCHESTER	Notes: 1002072427
80238 NJ70 ABZ	J WATSON	13/09/2021	18660 SPOIL	PARSONS DEPOT	EBCHESTER	Notes: 1002073048
80239 NX66 AZA	S HARDY	13/09/2021	18280 SPOIL	PARSONS DEPOT	EBCHESTER	Notes: 1002071982
80240 NJ70 ABZ	J WATSON	13/09/2021	19260 SPOIL	PARSONS DEPOT	EBCHESTER	Notes: 1002073601
80242 NK20XWC	J DUNNING	13/09/2021	20000 SPOIL	PARSONS DEPOT	EBCHESTER	Notes: 1002073671
80243 NK20XWC	J DUNNING	13/09/2021	20000 SPOIL	PARSONS DEPOT	EBCHESTER	Notes: 1002073165
80244 NK20XWC	J DUNNING	13/09/2021	20000 SPOIL	PARSONS DEPOT	EBCHESTER	Notes: 1002072478
80245 NX66 AZA	S HARDY	13/09/2021	18380 SPOIL	PARSONS DEPOT	EBCHESTER	Notes: 1002072444
80246 NK20XWC	J DUNNING	13/09/2021	20000 SPOIL	PARSONS DEPOT	EBCHESTER	Notes: 1002072002
80248 NX66 AZA	S HARDY	13/09/2021	18680 SPOIL	PARSONS DEPOT	EBCHESTER	Notes: 1002073103
80249 NX16 ACZ	D PEART	13/09/2021	18120 SPOIL	PARSONS DEPOT	EBCHESTER	Notes: 1002073456
80250 NX66 AZA	S HARDY	13/09/2021	18680 SPOIL	PARSONS DEPOT	EBCHESTER	Notes: 1002073649
80251 NX16 ACZ	D PEART	13/09/2021	18440 SPOIL	PARSONS DEPOT	EBCHESTER	Notes: 1002072642
80252 NX16 ACZ	D PEART	14/09/2021	18640 SPOIL	PARSONS DEPOT	EBCHESTER	Notes: 1002076883
80253 NX16 ACZ	D PEART	14/09/2021	18640 SPOIL	PARSONS DEPOT	EBCHESTER	Notes: 1002076177
80256 NU17 KYR	A DUNCAN	13/09/2021	20000 SPOIL	PARSONS DEPOT	EBCHESTER	Notes: 1002073708
80257 NU17 KYR	A DUNCAN	13/09/2021	20000 SPOIL	PARSONS DEPOT	EBCHESTER	Notes: 1002073190
80258 NU17 KYR	A DUNCAN	13/09/2021	20000 SPOIL	PARSONS DEPOT	EBCHESTER	Notes: 1002072555
80259 NU17 KYR	A DUNCAN	13/09/2021	20000 SPOIL	PARSONS DEPOT	EBCHESTER	Notes: 1002072048
80260 NX16 ACZ	D PEART	14/09/2021	19140 SPOIL	PARSONS DEPOT	EBCHESTER	Notes: 1002075578
80261 NJ19 AWN	T HOWARD	13/09/2021	20000 SPOIL	PARSONS DEPOT	EBCHESTER	

80263	NJ19 AWN	T HOWARD	13/09/2021	20000 SPOIL	PARSONS DEPOT	EBCHESTER	Notes:
80264	NJ19 AWN	T HOWARD	13/09/2021	20000 SPOIL	PARSONS DEPOT	EBCHESTER	Notes:
80267	NJ70 ABX	S MILLER	13/09/2021	17900 SPOIL	PARSONS DEPOT	EBCHESTER	Notes: 1002073440
80268	NJ70 ABX	S MILLER	13/09/2021	18820 SPOIL	PARSONS DEPOT	EBCHESTER	Notes: 1002072639
80269	NJ70 ABX	S MILLER	13/09/2021	18420 SPOIL	PARSONS DEPOT	EBCHESTER	Notes: 1002072102
80270	NJ19 AWN	T HOWARD	13/09/2021	20000 SPOIL	PARSONS DEPOT	Biffa Washington	Notes:
80271	NX66 AZA	S HARDY	14/09/2021	18280 SPOIL	PARSONS DEPOT	EBCHESTER	Notes: 1002075847
80272	NX66 AZA	S HARDY	14/09/2021	19160 SPOIL	PARSONS DEPOT	EBCHESTER	Notes: 1002075306
80273	NJ70 ABX	S MILLER	14/09/2021	18220 SPOIL	PARSONS DEPOT	EBCHESTER	Notes: 1002075554
80275	NJ19 AWN	T HOWARD	14/09/2021	20000 SPOIL	PARSONS DEPOT	EBCHESTER	Notes:
80276	NJ19 AWN	T HOWARD	14/09/2021	20000 SPOIL	PARSONS DEPOT	EBCHESTER	Notes:
80465	NX66 AZA	S HARDY	14/09/2021	19080 SPOIL	PARSONS DEPOT	EBCHESTER	Notes: 1002074635
80466	NX66 AZA	S HARDY	14/09/2021	18980 SPOIL	PARSONS DEPOT	EBCHESTER	Notes: 1002076601
80467	NX66 AZA	S HARDY	14/09/2021	18680 SPOIL	PARSONS DEPOT	EBCHESTER	Notes: 1002077185
80469	NJ70 ABZ	J WATSON	14/09/2021	18760 SPOIL	PARSONS DEPOT	EBCHESTER	Notes: 1002075770
80470	NJ70 ABZ	J WATSON	14/09/2021	19260 SPOIL	PARSONS DEPOT	EBCHESTER	Notes: 1002076553
80471	NJ70 ABZ	J WATSON	14/09/2021	19260 SPOIL	PARSONS DEPOT	EBCHESTER	Notes: 1002077719
80473	HIRE	J DUNNING	14/09/2021	20000 SPOIL	PARSONS DEPOT	EBCHESTER	Notes: 1002075379
80474	HIRE	J DUNNING	14/09/2021	20000 SPOIL	PARSONS DEPOT	EBCHESTER	Notes: 1002075913
80475	HIRE	J DUNNING	14/09/2021	20000 SPOIL	PARSONS DEPOT	EBCHESTER	Notes: 1002076643
80476	HIRE	J DUNNING	14/09/2021	20000 SPOIL	PARSONS DEPOT	EBCHESTER	Notes: 1002077215
80478	NJ19 AWN	T HOWARD	14/09/2021	20000 SPOIL	PARSONS DEPOT	EBCHESTER	Notes:
80479	NJ19 AWN	T HOWARD	14/09/2021	20000 SPOIL	PARSONS DEPOT	EBCHESTER	Notes:
80482	NJ70 ABX	S MILLER	14/09/2021	18120 SPOIL	PARSONS DEPOT	EBCHESTER	Notes: 1002076159
80483	NJ70 ABX	S MILLER	14/09/2021	19020 SPOIL	PARSONS DEPOT	EBCHESTER	Notes: 1002076876
80484	NJ70 ABX	S MILLER	14/09/2021	18520 SPOIL	PARSONS DEPOT	EBCHESTER	Notes: 1002077381
80551	NK20XWB	N BURNETT	15/09/2021	20000 SPOIL	PARSONS DEPOT	Biffa Washington	Notes: 53217 concrete
80552	NK20XWB	N BURNETT	15/09/2021	20000 SPOIL	PARSONS DEPOT	Biffa Washington	Notes: 53245 concrete
80553	NK20XWB	N BURNETT	15/09/2021	20000 SPOIL	PARSONS DEPOT	Biffa Washington	Notes: 53278
80554	NK20XWB	N BURNETT	15/09/2021	20000 SPOIL	PARSONS DEPOT	Biffa Washington	Notes: 53303
80555	NK20XWB	N BURNETT	15/09/2021	20000 SPOIL	PARSONS DEPOT	Biffa Washington	Notes: 53333
80556	NK20XWB	N BURNETT	15/09/2021	20000 SPOIL	PARSONS DEPOT	Biffa Washington	Notes: 53368
80557	ND68 WOX	M BAKER	15/09/2021	15040 SPOIL	PARSONS DEPOT	Biffa Washington	Notes: 63224 hA/core
80558	NJ19 AWO	M CUMINGS	15/09/2021	15600 SPOIL	PARSONS DEPOT	Biffa Washington	Notes: 53230
80559	NJ19 AWO	M CUMINGS	15/09/2021	15900 SPOIL	PARSONS DEPOT	Biffa Washington	Notes: 53258
80560	NJ19 AWO	M CUMINGS	15/09/2021	16760 SPOIL	PARSONS DEPOT	Biffa Washington	Notes: 53292
80561	NJ19 AWO	M CUMINGS	15/09/2021	17700 SPOIL	PARSONS DEPOT	Biffa Washington	Notes: 53316
80562	NJ19 AWO	M CUMINGS	15/09/2021	14500 SPOIL	PARSONS DEPOT	Biffa Washington	Notes: 53351
80564	ND68 WOX	M BAKER	15/09/2021	16700 SPOIL	PARSONS DEPOT	Biffa Washington	Notes: 53250 h/core
80565	ND68 WOX	M BAKER	15/09/2021	18600 SPOIL	PARSONS DEPOT	Biffa Washington	Notes: 53295 h/core
80566	ND68 WOX	M BAKER	15/09/2021	15740 SPOIL	PARSONS DEPOT	Biffa Washington	Notes: 53318 h/core
80567	ND68 WOX	M BAKER	15/09/2021	15900 SPOIL	PARSONS DEPOT	Biffa Washington	Notes: 53353 h/core
80569	NX16 AAZ	A KNIGTON	15/09/2021	14280 SPOIL	PARSONS DEPOT	Biffa Washington	Notes: 53220

80570 NX16 AAZ	A KNIGTON	15/09/2021	20000 SPOIL	PARSONS DEPOT	Biffa Washington	Notes: 53252
80571 NX16 AAZ	A KNIGTON	15/09/2021	16660 SPOIL	PARSONS DEPOT	Biffa Washington	Notes: 53281
80572 NX16 AAZ	A KNIGTON	15/09/2021	16040 SPOIL	PARSONS DEPOT	Biffa Washington	Notes: 53305
80573 NX16 AAZ	A KNIGTON	15/09/2021	16380 SPOIL	PARSONS DEPOT	Biffa Washington	Notes: 53334
80575 NK66 LMU	B BARKER	15/09/2021	13700 SPOIL	PARSONS DEPOT	Biffa Washington	Notes: 53225
80576 NK66 LMU	B BARKER	15/09/2021	16400 SPOIL	PARSONS DEPOT	Biffa Washington	Notes: 53254 hardcore
80577 NK66 LMU	B BARKER	15/09/2021	14300 SPOIL	PARSONS DEPOT	Biffa Washington	Notes: 53287 hardcore
80578 NK66 LMU	B BARKER	15/09/2021	16240 SPOIL	PARSONS DEPOT	Biffa Washington	Notes: 53307 hardcore
80579 NK66 LMU	B BARKER	15/09/2021	14660 SPOIL	PARSONS DEPOT	Biffa Washington	Notes: 53348 hardcore
80581 ND68 WOV	M RAMAGE	15/09/2021	20000 SPOIL	PARSONS DEPOT	Biffa Washington	Notes: 53232
80582 ND68 WOV	M RAMAGE	15/09/2021	20000 SPOIL	PARSONS DEPOT	Biffa Washington	Notes: 53260
80583 ND68 WOV	M RAMAGE	15/09/2021	20000 SPOIL	PARSONS DEPOT	Biffa Washington	Notes: 53291
80584 ND68 WOV	M RAMAGE	15/09/2021	20000 SPOIL	PARSONS DEPOT	Biffa Washington	Notes: 53311
80585 ND68 WOV	M RAMAGE	15/09/2021	20000 SPOIL	PARSONS DEPOT	Biffa Washington	Notes: 53347
80806 NK20XWB	N BURNETT	16/09/2021	20000 SPOIL	PARSONS DEPOT	EBCHESTER	Notes: 82004
80807 NK20XWB	N BURNETT	16/09/2021	20000 SPOIL	PARSONS DEPOT	EBCHESTER	Notes: 82627
80808 NK20XWB	N BURNETT	16/09/2021	20000 SPOIL	PARSONS DEPOT	EBCHESTER	Notes: 83153
80809 NK20XWB	N BURNETT	16/09/2021	20000 SPOIL	PARSONS DEPOT	EBCHESTER	Notes: 83830
80810 NK20XWB	N BURNETT	16/09/2021	20000 SPOIL	PARSONS DEPOT	EBCHESTER	Notes: 184414
80811 ND68 WOX	M BAKER	16/09/2021	18280 SPOIL	PARSONS DEPOT	EBCHESTER	Notes: 1002081886
80812 ND68 WOX	M BAKER	16/09/2021	17780 SPOIL	PARSONS DEPOT	EBCHESTER	Notes: 1002082578
80813 ND68 WOX	M BAKER	16/09/2021	18680 SPOIL	PARSONS DEPOT	EBCHESTER	Notes: 1002083249
80814 ND68 WOX	M BAKER	16/09/2021	18180 SPOIL	PARSONS DEPOT	EBCHESTER	Notes: 1002083953
80815 ND68 WOX	M BAKER	16/09/2021	17880 SPOIL	PARSONS DEPOT	EBCHESTER	Notes: 1002084484
80816 NK66 LMU	B BARKER	16/09/2021	18580 SPOIL	PARSONS DEPOT	EBCHESTER	Notes: 1002081984
80817 NK66 LMU	B BARKER	16/09/2021	17740 SPOIL	PARSONS DEPOT	EBCHESTER	Notes: 1002082648
80818 NK66 LMU	B BARKER	16/09/2021	17780 SPOIL	PARSONS DEPOT	EBCHESTER	Notes: 1002083216
80819 NK66 LMU	B BARKER	16/09/2021	18580 SPOIL	PARSONS DEPOT	EBCHESTER	Notes: 1002073871
80820 NK66 LMU	B BARKER	16/09/2021	18440 SPOIL	PARSONS DEPOT	EBCHESTER	Notes: 1002084494
80821 NK20XWB	N BURNETT	17/09/2021	20000 SPOIL	PARSONS DEPOT	EBCHESTER	Notes: 85411
80822 ND68 WOX	M BAKER	17/09/2021	17980 SPOIL	PARSONS DEPOT	EBCHESTER	Notes: 1002085505
80823 NK66 LMU	B BARKER	17/09/2021	16680 SPOIL	PARSONS DEPOT	EBCHESTER	Notes: 1002085494
80824 NU17 KXR	J CURTS	17/09/2021	20000 SPOIL	PARSONS DEPOT	EBCHESTER	Notes:
80825 NU17 KYR	A DUNCAN	17/09/2021	20000 SPOIL	PARSONS DEPOT	EBCHESTER	Notes: 1002085526
80826 NJ19 AWO	M CUMINGS	16/09/2021	18340 SPOIL	PARSONS DEPOT	EBCHESTER	Notes: 1002081955
80827 NJ19 AWO	M CUMINGS	16/09/2021	18040 SPOIL	PARSONS DEPOT	EBCHESTER	Notes: 1002082611
80828 NJ19 AWO	M CUMINGS	16/09/2021	15420 HARDCORE	PARSONS DEPOT	Biffa Washington	Notes: 53484
80829 NU17 KXR	J CURTS	17/09/2021	20000 SPOIL	PARSONS DEPOT	EBCHESTER	Notes:
80831 NX16 AAZ	A KNIGTON	16/09/2021	18040 SPOIL	PARSONS DEPOT	EBCHESTER	Notes: 1002081984
80904 NX16 AAZ	A KNIGTON	16/09/2021	17740 SPOIL	PARSONS DEPOT	EBCHESTER	Notes: 1002082648
80905 NX16 AAZ	A KNIGTON	16/09/2021	18440 SPOIL	PARSONS DEPOT	EBCHESTER	Notes: 1002083216.
80906 NX16 AAZ	A KNIGTON	16/09/2021	18340 SPOIL	PARSONS DEPOT	EBCHESTER	Notes: 1002083933
80907 NX16 AAZ	A KNIGTON	16/09/2021	18440 SPOIL	PARSONS DEPOT	EBCHESTER	Notes: 1002084494

80998	NK17	VXB	A CHAPMAN	16/09/2021	18380	SPOIL	PARSONS DEPOT	EBCHESTER	Notes: 1002082072
80999	NX66	AZA	S HARDY	16/09/2021	18780	SPOIL	PARSONS DEPOT	EBCHESTER	Notes: 1002082025
81000	NX19	NWM	G DALGLISH	17/09/2021	17800	SPOIL	PARSONS DEPOT	EBCHESTER	Notes: 1002085557
81001	NK18	MGX	N KING	16/09/2021	1900	SPOIL	PARSONS DEPOT	EBCHESTER	Notes: 1002082101
81002	NU17	KXR	J CURTS	16/09/2021	20000	SPOIL	PARSONS DEPOT	EBCHESTER	Notes:
81003	NJ19	AWN	T HOWARD	16/09/2021	20000	SPOIL	PARSONS DEPOT	EBCHESTER	Notes:
81052	NK20XWB		N BURNETT	15/09/2021	20000	SPOIL	PARSONS DEPOT	EBCHESTER	Notes:
81053	NJ19	AWO	M CUMINGS	15/09/2021	1804	SPOIL	PARSONS DEPOT	EBCHESTER	Notes: 1002989770
81054	ND68	WOX	M BAKER	15/09/2021	18220	SPOIL	PARSONS DEPOT	EBCHESTER	Notes: 1002080806
81055	NK66	LMU	B BARKER	15/09/2021	18580	SPOIL	PARSONS DEPOT	EBCHESTER	Notes: 100280794
81056	NX19	NWK	S DONNLEY	16/09/2021	20000	SPOIL	PARSONS DEPOT	EBCHESTER	Notes: 2082142
81057	NK18	WHG	D BURNETT	16/09/2021	20000	SPOIL	PARSONS DEPOT	EBCHESTER	Notes: 2082121
81074	NX16	AAZ	A KNIGTON	15/09/2021	20000	SPOIL	PARSONS DEPOT	EBCHESTER	
81119	NU17	KXR	J CURTS	16/09/2021	20000	SPOIL	PARSONS DEPOT	EBCHESTER	Notes:
81120	NU17	KXR	J CURTS	16/09/2021	20000	SPOIL	PARSONS DEPOT	EBCHESTER	Notes:
81168	NK18	MGX	N KING	16/09/2021	1800	SPOIL	PARSONS DEPOT	EBCHESTER	Notes: 1002083606
81169	NK18	MGX	N KING	16/09/2021	1900	SPOIL	PARSONS DEPOT	EBCHESTER	Notes:
81171	NJ70	ABZ	S MILLER	16/09/2021	18720	SPOIL	PARSONS DEPOT	EBCHESTER	Notes: 1002083707
81172	NJ70	ABZ	S MILLER	16/09/2021	18900	SPOIL	PARSONS DEPOT	EBCHESTER	Notes: 1002084437
81173	NJ70	ABZ	S MILLER	16/09/2021	20000	SPOIL	PARSONS DEPOT	EBCHESTER	
81174	NX16	ACZ	D PEART	16/09/2021	18740	SPOIL	PARSONS DEPOT	EBCHESTER	Notes: 1002083721
81175	NX16	ACZ	D PEART	16/09/2021	19840	SPOIL	PARSONS DEPOT	EBCHESTER	Notes: 1002084422
81184	NJ19	AWO	M CUMINGS	16/09/2021	16300	HARDCORE	PARSONS DEPOT	Biffa Washington	Notes: 53511
81185	NJ19	AWO	M CUMINGS	16/09/2021	15900	HARDCORE	PARSONS DEPOT	Biffa Washington	Notes: 53525
81186	NJ19	AWO	M CUMINGS	16/09/2021	15620	HARDCORE	PARSONS DEPOT	Biffa Washington	Notes: 53540
81270	NK20XWB		N BURNETT	17/09/2021	15420	SPOIL	PARSONS DEPOT	Biffa Washington	Notes: 11153614
81271	NK20XWB		N BURNETT	17/09/2021	15420	SPOIL	PARSONS DEPOT	EBCHESTER	Notes: 86683
81272	NK20XWB		N BURNETT	17/09/2021	15420	SPOIL	PARSONS DEPOT	EBCHESTER	Notes: 87368
81274	ND68	WOX	M BAKER	17/09/2021	17880	SPOIL	PARSONS DEPOT	EBCHESTER	Notes: 1002086454
81275	ND68	WOX	M BAKER	17/09/2021	18080	SPOIL	PARSONS DEPOT	EBCHESTER	Notes: 1002087715
81278	NK66	LMU	B BARKER	17/09/2021	17880	SPOIL	PARSONS DEPOT	EBCHESTER	Notes: 1002086492
81279	NK66	LMU	B BARKER	17/09/2021	18340	SPOIL	PARSONS DEPOT	EBCHESTER	Notes: 1002087716
81284	NU17	KYR	A DUNCAN	17/09/2021	15420	SPOIL	PARSONS DEPOT	Biffa Washington	Notes: 53618
81291	NX19	NWM	G DALGLISH	17/09/2021	18100	SPOIL	PARSONS DEPOT	EBCHESTER	Notes: 1002087315
81429	NU17	KYR	A DUNCAN	17/09/2021	15420	SPOIL	PARSONS DEPOT	EBCHESTER	Notes: 1002086912
81501	NU17	KYR	A DUNCAN	17/09/2021	15420	SPOIL	PARSONS DEPOT	EBCHESTER	Notes: 1002087775
81572	ND68	WOX	M BAKER	20/09/2021	17880	SPOIL	PARSONS DEPOT	EBCHESTER	Notes: 1002090595
81573	NK66	LMU	B BARKER	20/09/2021	16580	SPOIL	PARSONS DEPOT	EBCHESTER	Notes: 1002090615
81574	NJ19	AWP	E TELFORD	20/09/2021	18900	SPOIL	PARSONS DEPOT	EBCHESTER	Notes: 1002090488
81583	NJ19	AWN	T HOWARD	20/09/2021	15420	SPOIL	PARSONS DEPOT	EBCHESTER	Notes:
81585	NJ71	ECD	M HENDERSO	20/09/2021	18980	SPOIL	PARSONS DEPOT	EBCHESTER	Notes: 1002091444
81586	NK66	LMU	B BARKER	20/09/2021	17980	SPOIL	PARSONS DEPOT	EBCHESTER	Notes: 1002091627
81587	NK18	MGX	A RIDDLE	20/09/2021	19300	SPOIL	PARSONS DEPOT	EBCHESTER	

81588	NK18	MGX	A RIDDLE	20/09/2021	19010	SPOIL	PARSONS DEPOT	EBCHESTER	
81688	NX19	NWM	G DALGLISH	21/09/2021	17900	SPOIL	PARSONS DEPOT	EBCHESTER	Notes: 1002092641
81689	ND68	WOX	M BAKER	21/09/2021	17880	SPOIL	PARSONS DEPOT	EBCHESTER	Notes: 1002093546
81690	NK66	LMU	B BARKER	21/09/2021	17980	SPOIL	PARSONS DEPOT	EBCHESTER	Notes: 1002093586
81691	NX19	NWL	S HERRON	21/09/2021	18480	SPOIL	PARSONS DEPOT	EBCHESTER	Notes: 1002093479
81703	NJ19	AWP	E TELFORD	20/09/2021	18300	SPOIL	PARSONS DEPOT	EBCHESTER	Notes: 1001091503
81725	NK66	LMU	B BARKER	21/09/2021	17780	SPOIL	PARSONS DEPOT	EBCHESTER	Notes: 1002092783
81729	ND68	WOX	M BAKER	21/09/2021	17880	SPOIL	PARSONS DEPOT	EBCHESTER	Notes: 1002092808
81733	NX19	NWL	S HERRON	21/09/2021	18080	SPOIL	PARSONS DEPOT	EBCHESTER	Notes: 1002092878
81734	NX19	NWL	S HERRON	21/09/2021	18460	SPOIL	PARSONS DEPOT	EBCHESTER	Notes: 1002094440
100848	NX19	NWM	G DALGLISH	17/02/2022	14760	HARDCORE	PARSONS DEPOT	BIFFA WASHINGTON	Notes: 64959
100849	NX19	NWM	G DALGLISH	17/02/2022	20000	CLAY	PARSONS DEPOT	IBSTOCK	Notes: waste transfer - 83122
100850	NX19	NWM	G DALGLISH	17/02/2022	20000	CLAY	PARSONS DEPOT	IBSTOCK	Notes: waste transfer - 83123
100851	NX19	NWM	G DALGLISH	17/02/2022	20000	CLAY	PARSONS DEPOT	IBSTOCK	Notes: waste transfer - 83124
100852	NX19	NWM	G DALGLISH	17/02/2022	20000	CLAY	PARSONS DEPOT	IBSTOCK	Notes: waste transfer - 83125
101110	NJ19	AWN	S REED	18/02/2022	20000	CLAY	PARSONS DEPOT	IBSTOCK	79910
101111	NJ19	AWN	S REED	18/02/2022	20000	CLAY	PARSONS DEPOT	IBSTOCK	79911
101112	NJ19	AWN	S REED	18/02/2022	20000	CLAY	PARSONS DEPOT	IBSTOCK	79912
101113	NJ19	AWN	S REED	18/02/2022	20000	CLAY	PARSONS DEPOT	IBSTOCK	79913
101114	NJ19	AWN	S REED	18/02/2022	20000	CLAY	PARSONS DEPOT	IBSTOCK	79914
101355	NX19	NWM	G DALGLISH	21/02/2022	20000	CLAY	PARSONS DEPOT	IBSTOCK	Notes: waste transfer - 80246
101356	NX19	NWM	G DALGLISH	21/02/2022	20000	CLAY	PARSONS DEPOT	IBSTOCK	Notes: waste transfer - 80247
101357	NX19	NWM	G DALGLISH	21/02/2022	20000	CLAY	PARSONS DEPOT	IBSTOCK	Notes: waste transfer - 80248
101358	NX19	NWM	G DALGLISH	21/02/2022	20000	CLAY	PARSONS DEPOT	IBSTOCK	Notes: waste transfer - 80249
101359	NX19	NWM	G DALGLISH	21/02/2022	20000	CLAY	PARSONS DEPOT	IBSTOCK	Notes: waste transfer - 80250
101360	NX19	NWM	G DALGLISH	21/02/2022	20000	CLAY	PARSONS DEPOT	IBSTOCK	Notes: waste transfer - 85151
111634	NJ22	CVV	T HOWARD	13/04/2022	20000	CLAY	PARSONS DEPOT	IBSTOCK	Notes: 91245
111635	NJ22	CVV	T HOWARD	13/04/2022	20000	CLAY	PARSONS DEPOT	IBSTOCK	Notes: 91246
111636	NJ22	CVV	T HOWARD	13/04/2022	20000	CLAY	PARSONS DEPOT	IBSTOCK	Notes: 91247
111637	NJ22	CVV	T HOWARD	13/04/2022	20000	CLAY	PARSONS DEPOT	IBSTOCK	Notes: 91249
111638	NJ22	CVV	T HOWARD	13/04/2022	20000	CLAY	PARSONS DEPOT	IBSTOCK	Notes: 91250
111639	NJ22	CVV	T HOWARD	13/04/2022	20000	CLAY	PARSONS DEPOT	IBSTOCK	Notes: 91250
111640	NJ22	CVV	T HOWARD	14/04/2022	20000	CLAY	PARSONS DEPOT	IBSTOCK	Notes: 48804
111641	NJ22	CVV	T HOWARD	14/04/2022	20000	CLAY	PARSONS DEPOT	IBSTOCK	Notes: 48805
112012	NJ22	CVV	T HOWARD	14/04/2022	20000	CLAY	PARSONS DEPOT	IBSTOCK	Notes: 48806
112013	NJ22	CVV	T HOWARD	14/04/2022	20000	CLAY	PARSONS DEPOT	IBSTOCK	Notes: 48807
113018	NJ19	AWO	M CUMINGS	22/04/2022	18000	SPOIL	PARSONS DEPOT	IBSTOCK	Notes: 091679
113019	NJ19	AWO	M CUMINGS	22/04/2022	18000	SPOIL	PARSONS DEPOT	IBSTOCK	Notes: 091680
113020	NJ19	AWO	M CUMINGS	22/04/2022	18000	SPOIL	PARSONS DEPOT	IBSTOCK	Notes: 091681
113021	NX19	NWK	R HIBBARD	25/04/2022	20000	CONCRETE WASTE	PARSONS DEPOT	BIFFA WASHINGTON	091591/69734
113022	NX19	NWK	R HIBBARD	25/04/2022	20000	CONCRETE WASTE	PARSONS DEPOT	BIFFA WASHINGTON	091592/69747
113023	NX19	NWK	R HIBBARD	25/04/2022	20000	CONCRETE WASTE	PARSONS DEPOT	BIFFA WASHINGTON	091593/69752
113527	NX19	NWK	R HIBBARD	25/04/2022	17620	CONCRETE WASTE	PARSONS DEPOT	BIFFA WASHINGTON	Notes: 91590

113528	NX19	NWK	R HIBBARD	25/04/2022	17620	CONCRETE WASTE	PARSONS DEPOT	BIFFA WASHINGTON	Notes: 91589
114256	NJ22	CVR	S HERRON	27/04/2022	14400	CONCRETE WASTE	PARSONS DEPOT	BIFFA WASHINGTON	Notes: 69932
114259	NJ22	CVR	S HERRON	27/04/2022	19000	CLAY	PARSONS DEPOT	IBSTOCK	Notes:
114260	NJ22	CVR	S HERRON	27/04/2022	19000	CLAY	PARSONS DEPOT	IBSTOCK	Notes:
114426	NJ22	CVR	S HERRON	27/04/2022	19000	CLAY	PARSONS DEPOT	IBSTOCK	Notes:
116005	NX19	NWM	G DALGLISH	09/05/2022	19000	CLAY	PARSONS DEPOT	IBSTOCK	Notes: waste transfer - 93703
116006	NX19	NWM	G DALGLISH	09/05/2022	19000	CLAY	PARSONS DEPOT	IBSTOCK	Notes: waste transfer - 93704
116007	NX19	NWM	G DALGLISH	09/05/2022	19000	CLAY	PARSONS DEPOT	IBSTOCK	Notes: waste transfer - 93705
116008	NX19	NWM	G DALGLISH	09/05/2022	17820	CLAY	PARSONS DEPOT	BIFFA WASHINGTON	Notes: 70639
116009	NX19	NWM	G DALGLISH	09/05/2022	17860	CLAY	PARSONS DEPOT	BIFFA WASHINGTON	Notes: 70645
116780	NJ19	AWP	C YOUNG	13/05/2022	20000	CLAY	PARSONS DEPOT	IBSTOCK	Notes: 89752
116781	NJ19	AWP	C YOUNG	13/05/2022	20000	CLAY	PARSONS DEPOT	IBSTOCK	Notes: 89751
116782	NJ19	AWP	C YOUNG	13/05/2022	20000	CLAY	PARSONS DEPOT	IBSTOCK	Notes: 89753
116783	NJ19	AWP	C YOUNG	13/05/2022	20000	CLAY	PARSONS DEPOT	IBSTOCK	Notes: 89754
116784	NJ19	AWP	C YOUNG	13/05/2022	20000	CLAY	PARSONS DEPOT	IBSTOCK	Notes: 89755
118427	NJ22	CVR	S HERRON	23/05/2022	19000	CLAY	PARSONS DEPOT	IBSTOCK	Notes:
118428	NJ22	CVR	S HERRON	23/05/2022	19000	CLAY	PARSONS DEPOT	IBSTOCK	Notes:
118429	NJ22	CVR	S HERRON	23/05/2022	20000	CLAY	PARSONS DEPOT	IBSTOCK	Notes:
118430	NJ22	CVR	S HERRON	23/05/2022	19000	CLAY	PARSONS DEPOT	IBSTOCK	Notes:
118605	NJ22	CVR	S HERRON	23/05/2022	19000	CLAY	PARSONS DEPOT	IBSTOCK	Notes:
118607	NJ22	CVR	S HERRON	23/05/2022	19000	CLAY	PARSONS DEPOT	IBSTOCK	Notes:
118608	NJ22	CVR	S HERRON	23/05/2022	19000	CLAY	PARSONS DEPOT	IBSTOCK	Notes:
118609	NX19	NWK	R HIBBARD	23/05/2022	18200	CLAY	PARSONS DEPOT	IBSTOCK	Notes: 95189
119567	NX19	NWM	G DALGLISH	30/05/2022	17800	CLAY	PARSONS DEPOT	EBCHESTER	Notes: 1002638747
119568	NX19	NWM	G DALGLISH	30/05/2022	20000	CLAY	PARSONS DEPOT	IBSTOCK	Notes: waste transfer - 86232
119569	NX19	NWM	G DALGLISH	30/05/2022	20000	CLAY	PARSONS DEPOT	IBSTOCK	Notes: waste transfer - 86233
119570	NX19	NWM	G DALGLISH	30/05/2022	20000	CLAY	PARSONS DEPOT	IBSTOCK	Notes: waste transfer - 86234
119571	NX19	NWM	G DALGLISH	30/05/2022	20000	CLAY	PARSONS DEPOT	IBSTOCK	Notes: waste transfer - 86235
119572	NX19	NWM	G DALGLISH	30/05/2022	20000	CLAY	PARSONS DEPOT	IBSTOCK	Notes: waste transfer - 86236
120153	NK20XWC		J DUNNING	01/06/2022	18560	CLAY	PARSONS DEPOT	EBCHESTER	Notes: 1002643777
120154	NK20XWC		J DUNNING	01/06/2022	20000	CLAY	PARSONS DEPOT	IBSTOCK	Notes:
120155	NK20XWC		J DUNNING	01/06/2022	20000	CLAY	PARSONS DEPOT	IBSTOCK	Notes:
120156	NK20XWC		J DUNNING	01/06/2022	20000	CLAY	PARSONS DEPOT	IBSTOCK	Notes:
123825	NX68	NEF	I GALLACHE	21/06/2022	17420	CLAY	PARSONS DEPOT	BIFFA WASHINGTON	Notes: 73260
123826	NX68	NEF	I GALLACHE	21/06/2022	15500	CLAY	PARSONS DEPOT	BIFFA WASHINGTON	Notes: 73276
123827	NX68	NEF	I GALLACHE	21/06/2022	14740	CLAY	PARSONS DEPOT	BIFFA WASHINGTON	Notes: 73287
123828	NX68	NEF	I GALLACHE	21/06/2022	13820	CLAY	PARSONS DEPOT	BIFFA WASHINGTON	Notes: 73302
123829	NX68	NEF	I GALLACHE	21/06/2022	16300	CLAY	PARSONS DEPOT	BIFFA WASHINGTON	Notes: 73314
123835	NX68	NEJ	M WOODHOUS	21/06/2022	18420	CLAY	PARSONS DEPOT	BIFFA WASHINGTON	Notes: 73257
123836	NX68	NEJ	M WOODHOUS	21/06/2022	16240	CLAY	PARSONS DEPOT	BIFFA WASHINGTON	Notes: 73273
123837	NX68	NEJ	M WOODHOUS	21/06/2022	17480	CLAY	PARSONS DEPOT	BIFFA WASHINGTON	Notes: 73284
123838	NX68	NEJ	M WOODHOUS	21/06/2022	16140	CLAY	PARSONS DEPOT	BIFFA WASHINGTON	Notes: 73300
123839	NX68	NEJ	M WOODHOUS	21/06/2022	20240	CLAY	PARSONS DEPOT	BIFFA WASHINGTON	Notes: 73313

123931	NX19 NWM	G DALGLISH	21/06/2022	15140 CLAY	PARSONS DEPOT	BIFFA WASHINGTON	Notes: 73249
123932	NJ22 CVU	E TELFORD	20/06/2022	20000 CLAY	PARSONS DEPOT	BIFFA WASHINGTON	
123933	NJ22 CVU	E TELFORD	20/06/2022	20000 CLAY	PARSONS DEPOT	BIFFA WASHINGTON	
123936	NK18 WHG	A TAYLOR	20/06/2022	14400 CONCRETE WASTE	PARSONS DEPOT	BIFFA WASHINGTON	Notes: 100639
123937	NK18 WHG	A TAYLOR	20/06/2022	14400 CONCRETE WASTE	PARSONS DEPOT	BIFFA WASHINGTON	Notes: 100640
123938	NJ22 CVR	S HERRON	20/06/2022	18180 CONCRETE WASTE	PARSONS DEPOT	BIFFA WASHINGTON	Notes: 73199
123939	NJ22 CVR	S HERRON	20/06/2022	18780 CONCRETE WASTE	PARSONS DEPOT	BIFFA WASHINGTON	Notes: 73212
123940	NJ22 CVU	E TELFORD	18/06/2022	19120 CONCRETE WASTE	PARSONS DEPOT	BIFFA WASHINGTON	Notes: 97710 / 73217
123941	NJ22 CVU	E TELFORD	18/06/2022	14600 CONCRETE WASTE	PARSONS DEPOT	BIFFA WASHINGTON	Notes: 97711 / 73222
123945	NK18 WHG	A TAYLOR	20/06/2022	14400 CONCRETE WASTE	PARSONS DEPOT	BIFFA WASHINGTON	Notes: 100641
123946	NK18 WHG	A TAYLOR	20/06/2022	14400 CONCRETE WASTE	PARSONS DEPOT	BIFFA WASHINGTON	Notes: 100642
123954	NJ22 CVR	S HERRON	20/06/2022	16340 CONCRETE WASTE	PARSONS DEPOT	BIFFA WASHINGTON	Notes: 73227
124207	NX68 NEF	I GALLACHE	22/06/2022	19060 CLAY	PARSONS DEPOT	EBCHESTER	Notes: 1002682120
124208	NX68 NEF	I GALLACHE	22/06/2022	18560 CONCRETE WASTE	PARSONS DEPOT	BIFFA WASHINGTON	Notes: 73384
124209	NX68 NEF	I GALLACHE	22/06/2022	17540 CONCRETE WASTE	PARSONS DEPOT	BIFFA WASHINGTON	Notes: 73396
124210	NX68 NEF	I GALLACHE	22/06/2022	16760 CONCRETE WASTE	PARSONS DEPOT	BIFFA WASHINGTON	Notes: 73414
124211	NX68 NEF	I GALLACHE	22/06/2022	14680 CONCRETE WASTE	PARSONS DEPOT	BIFFA WASHINGTON	Notes: 73428
124216	NX68 NEF	I GALLACHE	22/06/2022	16100 CONCRETE WASTE	PARSONS DEPOT	BIFFA WASHINGTON	Notes: 73444
124217	NX68 NEJ	M WOODHOUS	22/06/2022	20040 HARDCORE	PARSONS DEPOT	EBCHESTER	Notes: 1002682108
124218	NX68 NEJ	M WOODHOUS	22/06/2022	19880 HARDCORE	PARSONS DEPOT	BIFFA WASHINGTON	Notes: 73382
124219	NX68 NEJ	M WOODHOUS	22/06/2022	17340 HARDCORE	PARSONS DEPOT	BIFFA WASHINGTON	Notes: 73395
124220	NX68 NEJ	M WOODHOUS	22/06/2022	17420 HARDCORE	PARSONS DEPOT	BIFFA WASHINGTON	Notes: 73413
124221	NX68 NEJ	M WOODHOUS	22/06/2022	15240 HARDCORE	PARSONS DEPOT	BIFFA WASHINGTON	Notes: 73426
124226	NX68 NEJ	M WOODHOUS	22/06/2022	17640 HARDCORE	PARSONS DEPOT	BIFFA WASHINGTON	Notes: 73442
124262	NX68 NEJ	M WOODHOUS	21/06/2022	19200 CONCRETE WASTE	PARSONS DEPOT	IBSTOCK	Notes: 097520
124263	NX68 NEJ	M WOODHOUS	21/06/2022	19200 CONCRETE WASTE	PARSONS DEPOT	IBSTOCK	Notes: 097521
124266	NX68 NEF	I GALLACHE	21/06/2022	19000 CONCRETE WASTE	PARSONS DEPOT	IBSTOCK	Notes:
124267	NX68 NEF	I GALLACHE	21/06/2022	18900 CONCRETE WASTE	PARSONS DEPOT	IBSTOCK	Notes:
124300	NX19 NWM	G DALGLISH	22/06/2022	12720 HARDCORE	PARSONS DEPOT	BIFFA WASHINGTON	Notes: 73364
124301	NX19 NWM	G DALGLISH	22/06/2022	18260 HARDCORE	PARSONS DEPOT	BIFFA WASHINGTON	Notes: 73354
124302	NX19 NWM	G DALGLISH	21/06/2022	16480 HARDCORE	PARSONS DEPOT	BIFFA WASHINGTON	Notes: 73335
127041	NJ22 CVO	J DUNNING	01/07/2022	18600 HARDCORE	PARSONS DEPOT	BIFFA WASHINGTON	Notes: 74182
127042	NK20XWC	A TAYLOR	01/07/2022	20000 HARDCORE	PARSONS DEPOT	BIFFA WASHINGTON	Notes: 102758
127043	NK66 LMU	J ATKINSON	01/07/2022	20000 HARDCORE	PARSONS DEPOT	BIFFA WASHINGTON	Notes: 101512
127087	NX16 ACZ	S DONNLEY	04/07/2022	14860 HARDCORE	PARSONS DEPOT	BIFFA WASHINGTON	Notes:
127381	NX16 ACZ	S DONNLEY	04/07/2022	13200 HARDCORE	PARSONS DEPOT	BIFFA WASHINGTON	Notes:
127705	NK18 WHG	I WHYTE	05/07/2022	14860 HARDCORE	PARSONS DEPOT	BIFFA WASHINGTON	102091/74382
127727	NJ22 CVO	J DUNNING	05/07/2022	18680 HARDCORE	PARSONS DEPOT	BIFFA WASHINGTON	Notes: 74372
127728	NJ22 CVO	J DUNNING	05/07/2022	18500 HARDCORE	PARSONS DEPOT	BIFFA WASHINGTON	Notes: 74379
129866	NJ22 CVU	E TELFORD	13/07/2022	17600 HARDCORE	PARSONS DEPOT	BIFFA WASHINGTON	Notes: 102145 / 75138
130990	NJ22 CVP	N BURNETT	18/07/2022	20000 SPOIL	PARSONS DEPOT	BIFFA WASHINGTON	Notes: 75482
131356	ND68 WOX	S REED	20/07/2022	20000 SPOIL	PARSONS DEPOT	BIFFA WASHINGTON	
134367	NK17 VXA	D JEFFERSO	03/08/2022	20000 SPOILS&STONE 17-05-04	PARSONS DEPOT	BIFFA WASHINGTON	

134438	NX19	NWL	D.BROWN	03/08/2022	20000 SPOILS&STONE 17-05-04	PARSONS DEPOT	BIFFA WASHINGTON	
134596	NJ19	AWO	D BROWN2	03/08/2022	20000 SPOIL	PARSONS DEPOT	IBSTOCK	Notes:
134800	NK20XWC		J ATKINSON	03/08/2022	20000 SPOIL	PARSONS DEPOT	IBSTOCK	Notes: 099512
135891	NK20XWC		A TAYLOR	09/08/2022	20000 HARDCORE	PARSONS DEPOT	BIFFA WASHINGTON	Notes: 079460
135928	NX68	NEF	I GALLACHE	09/08/2022	18640 SPOIL	PARSONS DEPOT	BIFFA WASHINGTON	Notes: 76936
136395	NX68	NEJ	AGENCY	10/08/2022	20000 SPOIL	PARSONS DEPOT	IBSTOCK	
136396	NJ19	AWO	D BROWN2	10/08/2022	20000 SPOIL	PARSONS DEPOT	IBSTOCK	Notes:
136422	NJ22	CVR	S HERRON	11/08/2022	18800 SPOIL	PARSONS DEPOT	BIFFA WASHINGTON	Notes: 77098
136423	NJ22	CVR	S HERRON	11/08/2022	18500 SPOIL	PARSONS DEPOT	IBSTOCK	Notes:
136707	NJ22	CVR	S HERRON	11/08/2022	18500 SPOIL	PARSONS DEPOT	IBSTOCK	Notes:
137791	NJ22	CVV	T HOWARD	17/08/2022	18100 HARDCORE	PARSONS DEPOT	BIFFA WASHINGTON	Notes: 107404
138232	NJ22	CVT	D BURNETT	18/08/2022	20000 SPOIL	PARSONS DEPOT	BIFFA WASHINGTON	Notes: 77570
138233	NJ22	CVT	D BURNETT	18/08/2022	20000 SPOIL	PARSONS DEPOT	BIFFA WASHINGTON	Notes: 77577
139303	NJ22	CVV	T HOWARD	24/08/2022	20000 SPOIL	PARSONS DEPOT	IBSTOCK	Notes: 107430
139304	NJ70	ABZ	A KNIGHTON	23/08/2022	18800 HARDCORE	PARSONS DEPOT	BIFFA WASHINGTON	Notes: 77838
139368	NJ70	ABZ	A KNIGHTON	23/08/2022	18600 HARDCORE	PARSONS DEPOT	BIFFA WASHINGTON	Notes: 77848
139369	NJ70	ABZ	A KNIGHTON	23/08/2022	18720 HARDCORE	PARSONS DEPOT	BIFFA WASHINGTON	Notes: 77863
142384	NJ19	AWP	A RIDDLE	06/09/2022	20000 SPOIL	PARSONS DEPOT	BIFFA WASHINGTON	
152909	NJ70	ABZ	A KNIGHTON	23/08/2022	18720 HARDCORE	PARSONS DEPOT	IBSTOCK	104476
161693	NJ22	CVR	S HERRON	25/11/2022	18500 SPOILS&STONE 17-05-04	PARSONS DEPOT	IBSTOCK	Notes:
161694	NX19	NWM	S REED	25/11/2022	20000 SPOILS&STONE 17-05-04	PARSONS DEPOT	IBSTOCK	Notes: 120635
167424	NK17	VXB	B JONES	19/12/2022	20000 CLAY	PARSONS DEPOT	EBCHESTER	Notes: 126276
167425	NK17	VXB	B JONES	19/12/2022	20000 CLAY	PARSONS DEPOT	EBCHESTER	Notes: 126277
167426	NK17	VXB	B JONES	19/12/2022	20000 CLAY	PARSONS DEPOT	EBCHESTER	Notes: 126278
167427	NK17	VXB	B JONES	19/12/2022	20000 CLAY	PARSONS DEPOT	EBCHESTER	Notes: 126279
167429	NX65	BUA	SAM	19/12/2022	17900 CLAY	PARSONS DEPOT	EBCHESTER	Notes: 122296
167430	NX65	BUA	SAM	19/12/2022	17100 CLAY	PARSONS DEPOT	EBCHESTER	Notes: 122297
167431	NX65	BUA	SAM	19/12/2022	18000 CLAY	PARSONS DEPOT	EBCHESTER	Notes: 122299
167434	NK66	LMU	ALLAN	19/12/2022	20000 CLAY	PARSONS DEPOT	EBCHESTER	Notes: 119747
167435	NK66	LMU	ALLAN	19/12/2022	20000 CLAY	PARSONS DEPOT	EBCHESTER	Notes: 119748
167436	NK66	LMU	ALLAN	19/12/2022	20000 CLAY	PARSONS DEPOT	EBCHESTER	Notes: 119749
167437	NK66	LMU	ALLAN	19/12/2022	20000 CLAY	PARSONS DEPOT	EBCHESTER	Notes: 119750
167494	ND68	WOV	J ATKINSON	19/12/2022	19520 CLAY	PARSONS DEPOT	EBCHESTER	Notes: 128153
167495	ND68	WOV	J ATKINSON	19/12/2022	20000 CLAY	PARSONS DEPOT	EBCHESTER	Notes: 128154
167497	ND68	WOV	J ATKINSON	19/12/2022	13840 HARDCORE	PARSONS DEPOT	BIFFA WASHINGTON	Notes: 128156
167810	NK20XWB		D JEFFERSO	20/12/2022	18380 CLAY	PARSONS DEPOT	EBCHESTER	Notes: 127382
167811	NK20XWB		D JEFFERSO	20/12/2022	18700 CLAY	PARSONS DEPOT	EBCHESTER	Notes: 127383
167812	NK20XWB		D JEFFERSO	20/12/2022	18000 CLAY	PARSONS DEPOT	EBCHESTER	Notes: 127384
167813	NK20XWB		D JEFFERSO	20/12/2022	18860 CLAY	PARSONS DEPOT	EBCHESTER	Notes: 127385
167815	NK20XWC		G CLARK	20/12/2022	20000 CLAY	PARSONS DEPOT	EBCHESTER	Notes: 126623
167816	NK20XWC		G CLARK	20/12/2022	20000 CLAY	PARSONS DEPOT	EBCHESTER	Notes: 126624
167817	NK20XWC		G CLARK	20/12/2022	20000 CLAY	PARSONS DEPOT	EBCHESTER	Notes: 126625
167821	ND68	WOX	C MORTON	20/12/2022	20000 CLAY	PARSONS DEPOT	EBCHESTER	Notes: 126676

167822 ND68 WOX	C MORTON	20/12/2022	18500 CLAY	PARSONS DEPOT	EBCHESTER	Notes: 126677
167823 ND68 WOX	C MORTON	20/12/2022	18440 CLAY	PARSONS DEPOT	EBCHESTER	Notes: 126678
167824 ND68 WOX	C MORTON	20/12/2022	18420 CLAY	PARSONS DEPOT	EBCHESTER	Notes: 126679
167827 NX19 NWK	R HIBBARD	20/12/2022	18660 CLAY	PARSONS DEPOT	EBCHESTER	Notes: 3051394/119226
167828 NX19 NWK	R HIBBARD	20/12/2022	18580 CLAY	PARSONS DEPOT	EBCHESTER	Notes: 3051839/119227
167829 NX19 NWK	R HIBBARD	20/12/2022	18360 CLAY	PARSONS DEPOT	EBCHESTER	Notes: 3052331/119228
167830 NX19 NWK	R HIBBARD	20/12/2022	17920 CLAY	PARSONS DEPOT	EBCHESTER	Notes: 3052850/119230
167902 NJ70 ABX	D JEFFERSO	21/12/2022	18400 CLAY	PARSONS DEPOT	EBCHESTER	Notes: q27386
167903 NX19 NWM	C MORTON	21/12/2022	18880 CLAY	PARSONS DEPOT	EBCHESTER	Notes: 126680
167904 NK20XWB	G CLARK	21/12/2022	20000 CLAY	PARSONS DEPOT	EBCHESTER	Notes: 128307
167997 NJ22 CVT	D BURNETT	20/12/2022	20000 CLAY	PARSONS DEPOT	EBCHESTER	Notes:
168170 ND68 WOV	J ATKINSON	21/12/2022	18660 CLAY	PARSONS DEPOT	EBCHESTER	Notes: 128168
168171 ND68 WOV	J ATKINSON	21/12/2022	18440 CLAY	PARSONS DEPOT	EBCHESTER	Notes: 128169
168172 ND68 WOV	J ATKINSON	21/12/2022	18300 CLAY	PARSONS DEPOT	EBCHESTER	Notes: 128170
168173 ND68 WOV	J ATKINSON	21/12/2022	18320 CLAY	PARSONS DEPOT	EBCHESTER	Notes: 128171
168175 NK20XWB	G CLARK	21/12/2022	20000 CLAY	PARSONS DEPOT	EBCHESTER	Notes: 128308
168227 NJ70 ABX	D JEFFERSO	21/12/2022	18340 CLAY	PARSONS DEPOT	EBCHESTER	Notes: 127387
168228 NJ70 ABX	D JEFFERSO	21/12/2022	18360 CLAY	PARSONS DEPOT	EBCHESTER	Notes: 127388
168229 NJ70 ABX	D JEFFERSO	21/12/2022	18360 CLAY	PARSONS DEPOT	EBCHESTER	Notes: 127389
168231 NX19 NWM	C MORTON	21/12/2022	18880 CLAY	PARSONS DEPOT	EBCHESTER	Notes: 126681
168232 NX19 NWM	C MORTON	21/12/2022	19000 CLAY	PARSONS DEPOT	EBCHESTER	Notes: 126682
168233 NX19 NWM	C MORTON	21/12/2022	18800 CLAY	PARSONS DEPOT	EBCHESTER	Notes: 126683
168247 NJ22 CVS	J WATSON	20/12/2022	18440 CLAY	PARSONS DEPOT	EBCHESTER	Notes: 1003052882/128467
168263 NJ22 CVV	A DUNCAN	20/12/2022	18660 CLAY	PARSONS DEPOT	EBCHESTER	Notes: 1003052864/121385
177265 NJ22 CVO	J DUNNING	07/02/2023	20000 CLAY	PARSONS DEPOT	IBSTOCK	Notes:
177266 NJ22 CVO	J DUNNING	07/02/2023	20000 CLAY	PARSONS DEPOT	IBSTOCK	Notes:
177267 NJ22 CVO	J DUNNING	07/02/2023	20000 CLAY	PARSONS DEPOT	IBSTOCK	Notes:
177268 NJ22 CVO	J DUNNING	07/02/2023	20000 CLAY	PARSONS DEPOT	IBSTOCK	Notes:
177269 NJ22 CVO	J DUNNING	07/02/2023	20000 CLAY	PARSONS DEPOT	IBSTOCK	Notes:
177270 NJ22 CVO	J DUNNING	07/02/2023	20000 CLAY	PARSONS DEPOT	IBSTOCK	Notes:
177568 NJ22 CVO	J DUNNING	07/02/2023	20000 CLAY	PARSONS DEPOT	IBSTOCK	Notes:
177602 NJ22 CVU	A TAYLOR	07/02/2023	20000 CLAY	PARSONS DEPOT	IBSTOCK	Notes: 117416
177603 NJ22 CVU	A TAYLOR	07/02/2023	20000 CLAY	PARSONS DEPOT	IBSTOCK	Notes: 117417.
177724 ND68 WOV	J ATKINSON	08/02/2023	18100 CLAY	PARSONS DEPOT	IBSTOCK	Notes: 116396
177725 ND68 WOV	J ATKINSON	08/02/2023	18300 CLAY	PARSONS DEPOT	IBSTOCK	Notes: 116397
177881 NK17 VXB	B JONES	08/02/2023	20000 Hardcore	PARSONS DEPOT	BIFFA WASHINGTON	Notes: 126031
177882 NX68 NEF	I GALLACHE	08/02/2023	19000 CLAY	PARSONS DEPOT	IBSTOCK	Notes:
177883 NK17 VXB	B JONES	08/02/2023	20000 CLAY	PARSONS DEPOT	IBSTOCK	Notes: 126030
178021 NK17 VXB	B JONES	08/02/2023	20000 Hardcore	PARSONS DEPOT	BIFFA WASHINGTON	Notes: 126032
178060 NX68 NEF	I GALLACHE	09/02/2023	16340 HAZARDOUS MATERIAL	PARSONS DEPOT	AUGEAN WASTE MANAGEMENT	Notes: 503207

APPENDIX 4

TREATMENT OF BELOW GROUND TANKS

APPENDIX 4.1

METHOD STATEMENT AND JOB COMPLETION NOTE



LEES INDUSTRIAL SERVICES

THE MANUFACTURERS OF BRITFOAM®

A Member of the L.I.S Group
Unit 11 Haydock Lane, Haydock Lane Ind. Estate, St. Helens, Merseyside
WA11 9UY.

Telephone No: 01942 722244 Email: info@lisgroup.co.uk
Website: www.leesindustrialservices.co.uk

Generic Method Statement

Tank Decommissioning with BritFoam®

<u>Main Contractor/Customer Name:</u> WO Silmon Limited ✓ 15/2/22	<u>Site Name and Address:</u> Esh Construction, Parsons Depot, Parsons Road, Parsons Industrial Estate, Washington, NE37 1EQ	<u>Document Identification No:</u> MS/001/LEES/6390
<u>Approved by the Main Contractor /Customer:</u> Name: Signature:	<u>Effective Date and Time:</u> Tuesday 15 th February 2022 <u>Personnel:</u> Kevin Lees	<u>Author:</u> S.L Harrington <u>Prepared:</u> Linda Stinton <u>Vehicle:</u> YX11 DWG
<u>Objective:</u> To attend site for the purpose of decommissioning 3No. ²⁵⁰⁰⁰ 250,000 litre below ground diesel storage tank, associated pipework *see note below and 3No. standard depth manhole chambers with BritFoam®, a resin based hardfoam, using an approved decommissioning procedure in accordance with the guidelines set out in APEA/IP's Design, Construction, Modification, Maintenance and Decommissioning of Filling Stations, 4th Edition, Revised June 2018 (The "Blue Book"). <u>Note:</u> Tank pipe work and vents can only be foam filled/decommissioned where the tank pipe work is accessible and practically possible.		
<u>Area Of Work</u>	Tank Farm <i>came on lorry</i>	
<u>Personnel</u>	Only trained Lees Industrial Services Limited personnel shall carry out the tasks identified on this Method Statement. Training records and certificates are held in L.I.S Head Office. One driver per foaming vehicle unless confined spaces advised, in which case a 2 man crew will be deployed specifically for that site.	

<u>Training and Certification</u>	<ul style="list-style-type: none"> • ADR • UKPIA • CSCS • Utility SHEA (Gas) Passport • Current LGV License • Confined Space Entry Training ID Card <div style="text-align: right;">  <u>Kevin</u> </div>
<u>Documentation</u>	<ol style="list-style-type: none"> 1. Work Instruction Sheet 2. Delivery Note
<u>Sub-Contractors</u>	<p>None of the tasks detailed in this Method Statement shall be Sub-contracted to any other party.</p>
<u>Safety Equipment</u>	<ol style="list-style-type: none"> 1. Foaming vehicle (Used by qualified Lees' Personnel only) 2. Diesel Compressor fitted with Spark Arrestor and Chalwyn Valve (integrated into foaming vehicle) 3. Emergency Spillage Kit 4. Emergency eyewash bottles 5. Fire Extinguishers 6. Traffic Cones 7. Safety Torches 8. Tape for Cordoning off Work Area 9. First Aid Kit
<u>Emergency Contacts</u>	<ol style="list-style-type: none"> 1. <u>Police/Fire/Ambulance</u> – Dial 999 for assistance 2. <u>As dictated by Main Contractor/Customer</u> 3. Office Contact: Linda Stinton, Operations Manager, Lees Industrial Services Limited, Unit 11, Haydock Lane, Haydock Lane Industrial Estate, St. Helens, Merseyside, WA11 9UY Telephone No: 01942 722244 <u>Outside Authority (If applicable)</u> To be notified by WO Silmon Limited

<p><u>P.P.E</u></p>	<ol style="list-style-type: none"> 1. Fully protective cotton overalls. 2. Gloves 3. Safety Glasses/Goggles 4. Steel toe capped boots 5. Hard Hat 6. Ear Defenders (when appropriate) 7. Anti-Static High Visibility Clothing
<p><u>Tools and Equipment</u></p>	<ol style="list-style-type: none"> 1. Foaming vehicle (Used by qualified Lees Personnel only) 2. Diesel Compressor fitted with Spark Arrestor and Chalwyn Valve (integrated into foaming vehicle) 3. Extension Hoses, Various lengths 4. 3 in 1 Scientific Meter (Gas Monitor) 5. Various fittings 6. Various hand tools
<p><u>Possible Hazards</u></p>	<ol style="list-style-type: none"> 1. Manual handling/lifting of manhole chamber covers 2. Trip hazards 3. Other Contractors and vehicles on site 4. General Public and Pedestrians 5. Vapour from tank/vent 6. Open manholes 7. Adverse Weather Conditions 8. Daylight Saving Time, if applicable
<p><u>Precaution to Reduce Hazards</u></p>	<ol style="list-style-type: none"> 1. All personnel have CSCS and UKPIA Safety Passport Training 2. The working area to be sectioned off to prevent any unauthorised access. 3. Fire extinguishers to be readily available adjacent to the work area. 4. Strictly NO Smoking on site designated smoking areas to be used. 5. Warning signage to be fixed in prominent position. 6. Constant checks of the work area to be carried out throughout taking into account changes in the environment/weather conditions. These changes may stop the works and may need an additional assessment. 7. Gas Monitoring to be carried out at regular intervals throughout the work within the specified hazardous zone area. 8. Good housekeeping to be observed within the work area at all times.

<u>Reference Sources</u>	
	<ol style="list-style-type: none"> 1. Guidance for the Design, Construction, Modification and Maintenance of Petrol Filling Stations 4th Edition, Revised June 2018 (The Blue Book) 2. HSC Approved Code of Practice for Design and construction of vented, non-pressure road tankers used for the carriage of flammable liquids 3. Health & Safety at Work Act 1974 4. Personal Protective Equipment at Work Regulations 1992 5. ADR 2007 6. Environmental Protection Act 1990 7. Environmental Permitting (England and Wales) Regulations 2007 8. Confined Spaces Regulations 1997 9. Road Vehicles (Construction and Use) 1986 10. Control of Substances Hazardous to Health Regulations 2002

Tank preparatory works REQUIRED prior to our arrival on site: To be carried out by WO Silmon Limited

Adequate access and ventilation into tank must be given; both the flange and internal to be removed by the Main Contractor/Customer or their nominated Sub-Contractor before any decommissioning can take place.

Please note that the tank pipework can only be foam filled/decommissioned if the Pump(s) has/have been removed and a 2 inch adapter(s) has/have been fitted onto the Pump riser(s) to enable our operative to connect onto the pipe work.

Tank pipework and vents can only be foam filled/decommissioned where tank pipework is accessible and it is practically possible.

Site Arrival

On arrival to site Lees Industrial Services' Personnel to:

1. Safely park the vehicle and put on all required PPE as you exit the cab.
2. Report to the site office to book in and carry out site induction as required.
3. Liaise with the Main Contractor/Customer with regard to the traffic management plan to ensure safe parking of the vehicle onsite.

4. Issue the Main Contractor/Customer with Method Statement and Risk Assessment.
5. Discuss the programme of works and any other works ongoing that may affect our operation.
6. Confirm acceptance of this Method Statement by the Main Contractor/Customer and amend as necessary to site specific items.
7. Once the vehicle has been safely parked, ensure the entire working area has been cleared of any obstructions.
8. Good housekeeping to be observed within the work area at all times.

Site Set Up

1. When the foaming vehicle has been safely parked, ensure entire working area has been cleared of any obstructions.
2. Ensure Main Contractor/Customer has supplied sufficient barriers and fencing.
3. Ensure only authorised personnel within the safe working area.
4. Carry out visual site assessment in order to verify compliance with the Method Statement / Risk Assessment and amend if necessary by agreement and signature from all parties
5. Vents to be checked to ensure they are not blocked.
6. Clothing must not be put on or taken off in any hazardous areas in order to avoid static electricity.

No works under any circumstances to commence until the Main Contractor/Customer has control of the site; the necessary inductions; Method Statements and Risk Assessments have been reviewed and approved.

Sequence of Works: Foam filling of tanks with BritFoam®

- Carry out last minute assessment of the site and working area. Amend Risk Assessment and Method Statement if required to do so
- Check tank label for tank number, capacity and product information.

- Once the chamber covers have been removed, using a gas monitor check that there is a safe working atmosphere (LEL less than 5%) if not cease work and ventilate naturally until suitable levels are achieved.
- Once access is gained into the tank, manually dip to ensure the tank have been completely emptied.
- Ensure the tank is adequately vented, temporary vent to be used if required.
- Gas monitoring be carried out at regular intervals as conditions dictate
- Proceed to inject tank with Britfoam, a resin based hardfoam until the tank becomes full.
- Periodic sampling of the Britfoam will take place via a small valve in the feed pipe. These samples will be taken throughout the injection operation to ensure quality and consistency of the Britfoam.
- Replace manhole chamber lid.
- Finally, our applicator will disconnect hoses and clear immediate vicinity of any debris.
- A delivery ticket will be completed and will include.
 1. Tank Number
 2. Tank Size
 3. Date of decommission
 4. Full site Details
 5. Amount of Britfoam used
- A copy of our delivery note to be left on site/handed to the Main Contractor/Customer for their records.
- Leave site clean and tidy.

Variations to Standard

In the event that the tank manhole connections are at one end of the tank then reverse foaming may be required. This is achieved by placing a pipe inside the tank to ensure that the far reaches are filled to avoid tank voids.

Amendment to Method Statement

L.I.S.

Main Contractor/Customer Name:

.....

Signature:

.....

Date: Tuesday 15th February 2022

Lees Industrial Services' Operative Name

.....

Signature:

.....

Date: Tuesday 15th February 2022



LEES INDUSTRIAL SERVICES
THE MANUFACTURERS OF BRITFOAM®

A Member of the L.I.S Group
Unit 11 Haydock Lane, Haydock Ind. Estate, St. Helens, Merseyside, WA11 9UY.

Telephone No: 01942 722244 email: info@lisgroup.co.uk
website: www.leesindustrialservices.co.uk

JOB COMPLETION NOTE

Operatives :	<i>Team</i>	Site arrival :	<i>08:00</i>
Date :	<i>15-02-22</i>	Site departure :	<i>12:00</i>
Customer Name :	<i>WJ Silman Ltd.</i>		
Site Address :	<i>ESU Construction, Council Depot, Parsons Depot, Parsons Road East, Washington.</i>		

TANK INFORMATION

Tank Number	Contents	Tank Capacity Litres/Gallons	Suction Line where accessible	Offset Fill where accessible	Vent	Manhole Chamber Standard/Deep	Foam Type	m3 dispensed
<i>1</i>	<i>Den</i>	<i>22,000</i>	<i>D</i>	<i>DF</i>	<i>D</i>	<i>✓</i>	BritFoam®	
<i>2</i>	<i>Den</i>	<i>22,000</i>	<i>D</i>	<i>DF</i>	<i>D</i>	<i>✓</i>	BritFoam®	
<i>3</i>	<i>Gen Oil</i>	<i>22,000</i>	<i>D</i>	<i>DF</i>	<i>D</i>	<i>✓</i>	BritFoam®	
<i>4</i>	<i>Gen Oil</i>	<i>22,000</i>	<i>D</i>	<i>DF</i>	<i>D</i>	<i>✓</i>	BritFoam®	
<i>5</i>							BritFoam®	
<i>6</i>							BritFoam®	
<i>7</i>							BritFoam®	
<i>8</i>							BritFoam®	
TOTAL :								<i>104m³</i>

Fittings used :	
Pipework prep carried out by : <i>Silman Engineer</i>	Uplift of tank contents carried out by : <i>Silman Engineer</i>
Other information : <i>Good Access + Venting</i>	
Print : <i>X</i> <i>AC</i>	Petroleum Officer Present : YES / NO
Sign : <i>X</i> <i>[Signature]</i>	PO's Name and Authority :
Customer's Company Name : <i>WJ Silman Ltd.</i>	

APPENDIX 4.2

VERIFICATION REPORT FOR TREATMENT OF BELOW GROUNND TANKS

SITE INSPECTION RECORD

PROJECT REFERENCE NUMBER:-	3955	PARTIES:-	
SITE VISIT REFERENCE NUMBER:-	3955SIR01	Esh Construction WO Silmon Lees Industrial Services FWS Consultants Ltd	
PROJECT NAME:-	Parsons Yard		
CLIENT:-	Esh Construction Esh House Bowburn North Industrial Estate Bowburn Durham DH6 5PF		
DATE:-	15 February 2022	Sheet No.	1 of 6
WEATHER:-	Dry, light breeze, cloud cover 7/8, 4°C.		
JC (FWS) attended site to undertake a supervisory visit during decommissioning of tanks at the Parsons Yard site to confirm the works were undertaken in accordance with the method statement (provided by Lees Industrial Services).			
SITE INSPECTION (15 February 2022)			
Record of Site Visit			
<u>Plant onsite</u>			
Lees Industrial Services lorry with foaming equipment			
WO Silmon personnel with hand pumps for final emptying of tank(s)			
<u>Personnel onsite</u>			
Esh Construction, WO Silmon, Lees Industrial Services, FWS Consultants			
<u>Health and Safety</u>			
No issues reported during site visit. Working area taped off.			
<u>Information Provided to FWS</u>			
'Generic Method Statement – Tank Decommissioning with BritFoam' by Lees Industrial Services			
<u>Decommissioning Works</u>			
The works were undertaken by Lees Industrial Services personnel under the supervision of WO Silmon.			
Prior to decommissioning, a fourth tank had been identified and emptied, and so four tanks were to be decommissioned rather than the originally planned three. The fourth tank was reported to have contained red diesel or heating oil.			
WO Silmon had emptied all tanks prior to the filling works and arrival of the foaming lorry on site, as per the method statement. No spillages or surface staining were observed. Tanks were reported to be 25,000 litres rather than the 250,000 litres stated in the method statement.			
Certification of the Lees Industrial Services personnel matched those required in the method statement.			

Tank 4 (southernmost) was filled first. Filling was observed by FWS personnel to confirm compliance with the method statement. The tank was filled with pink BritFoam foam 'cement' to surface. The manhole was to be filled at the end, flush to the underside of the inspection cover (all four to be done at once).

FWS also observed the beginning of the filling of Tank 3. FWS were satisfied that the tanks were filled in general accordance with the method statement.

Information Requested

- FWS request a copy the site records for the tank decommissioning that should have been provided to Esh by WO Silmon, for incorporation into the Validation Report.

PHOTOGRAPHS

Photograph 1: WO Silmon emptying the last of Tank 4 (contents shown in IBC containers and barrels).



Photograph 2: Filled containers



Photograph 3: Filling pipework attached to Tank 4.



Photograph 4: Filling equipment and pipework on lorry.



Photograph 5: Foam reaching surface level as tank is filled.



Photograph 6: Completed Tank 4 fill.



Photograph 7: Label on Tank 3 indicating 22,000 litre capacity.



NAME:-	Jennifer Paterson	SIGNATURE:-	
---------------	-------------------	--------------------	---

NOTES ON LIMITATIONS

- 1 FWS Consultants Ltd (“FWS”) has prepared this report solely for the use of the client and/or his agent (the “Client”) on the basis of exchange(s) of written proposals and instructions, and FWS accepts no responsibility or liability:-
 - a) for use of this report by any party other than the person for whom it was commissioned, or;
 - b) for the consequences of the report being used for any purpose other than that for which FWS was instructed to prepare it.

Should any third party wish to use or rely upon the contents of the report, written approval from FWS must be sought.

- 2 All information supplied by the Client, the Client’s staff and professional advisers, local authorities, other statutory bodies, investigation agencies and publicly accessible databases, shall be provided to FWS in writing, and is accepted as being correct unless otherwise specified in writing by the discloser of the information.
- 3 The conclusions and recommendations in this report represent the professional opinions of FWS derived from currently accepted industry practices, and through the exercising of reasonable skill and care to be expected of a professional geosciences and environmental consultancy of similar size and experience. The assessments and judgments given in this report are directed by and limited to both the finite data on which they are based and the proposed works to which they are addressed.
- 4 Environmental and geotechnical desk studies comprise a study of available information obtained from various identified sources, authorities and parties. The information reviewed cannot be exhaustive and has been accepted in good faith as providing representative and true data pertaining to site conditions. For clarity, no independent verification of this data is carried out by FWS and it is accepted at face value. Any identified risks in desk study reports are perceived risks based on the information available at the time. Actual risks can only be assessed after carrying out a thorough physical investigation of the site that serves to validate such identified risks.
- 5 Data acquisition during site investigations is subject to the limitations of the methods of investigation used, site conditions and access constraints. Exploratory holes undertaken during fieldwork, particularly boreholes and/or trial pits, investigate a small volume of ground in relation to the size of the site and thus can only provide an indication of site conditions. The opinions provided and recommendations given in this report are based on the desk study information and ground conditions apparent at the site of each of the exploratory holes. There may be ground conditions elsewhere onsite that have not been disclosed by the investigation and which therefore have not been taken into account in this report. FWS will take all due care and make commentary on the adequacy of data collection and therefore the ability to highlight the presence or otherwise of exceptional conditions.
- 6 Owing to the natural variation of the systems that are being investigated, and the anthropological impact similarly changing through time, the findings and opinions in this report are relevant to the dates of the site works and should not be relied upon to represent conditions after a reasonable passing of time. Site conditions will change over time due to natural variations and human activities. The comments made on groundwater, surface water and soil gas conditions are based on observations made at the time that the site work was carried out. It should be noted that these conditions will vary owing to seasonal, tidal and meteorological effects. Variation in the types and concentrations of contaminants and variations in their flow paths may occur due to seasonal water table fluctuations, past disposal practices, the passage of time, or subsequent developments or activities on the site or adjacent area.
- 7 The scope of the investigation, as agreed between FWS and the Client, was undertaken based on the specific development proposals of the Client and may be inappropriate to another form of development or scheme.
- 8 The opinions expressed in this report regarding contamination, geotechnical and/or waste assessments are based on simple statistical analysis and comparison with available guidance values. No liability can be accepted for the retrospective effects of any changes or amendments to these values.

APPENDIX 5

HOTSPOT LOCATION PLAN AND POST-EXCAVATION PHOTOGRAPHIC RECORD

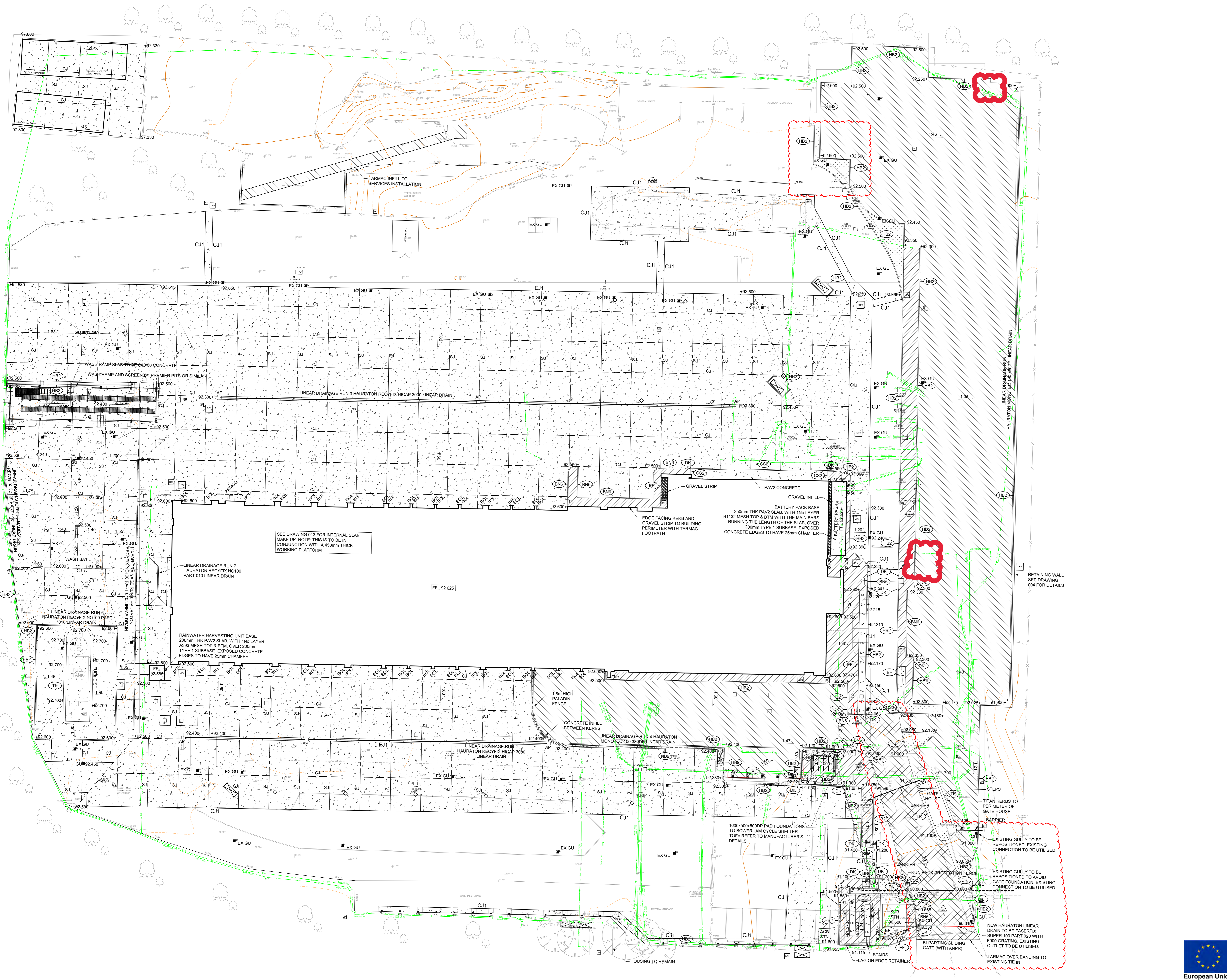

Health and Safety Notes:
 The following key residual health and safety risks have not been eliminated by design and are identified below:
 - Refer to Design Risk Assessment: 2021002-ORA
 Safe methods and systems of work remain the responsibility of the contractor

This drawing shall be read in conjunction with the following specification: 2021002/SP002 Site Preparation and Earthworks
 This drawing shall be read in conjunction with the following specification: 2021002/SP004 External Concrete Slabs

LEGEND

	TARMAC - CAR PARK -30mm SMA SURFACE COURSE -70mm DBM BINDER -225mm TYPE 1 SUB-BASE
	TARMAC - ROADWAY 50mm HRA SURF 40/60 60mm AC20 DENSE BINDER 40/60 150mm AC32 DENSE BASE 40/60 EXISTING SUBBASE. SUBBASE TO BE INSPECTED AND ANY SUSPECT AREAS REMOVED
	TARMAC - FOOTPATH -20mm AC6 SURF 100/150 -50mm DENSE BINDER 100/150 -150mm TYPE 1 SUBBASE
	CONCRETE - NEW BUILD -200mm THK PAV2 CONCRETE (BRUSHED FINISH) WITH A32 MESH REINFORCEMENT -1200g MEMBRANE -300mm TYPE 1 SUBBASE
	SAW CUT
	EXPANSION JOINT
	CONSTRUCTION JOINT
	PROPOSED LEVEL
	HB2 HALF BATTERED KERB 125 x 255
	BNE BULLNOSE KERB 125 x 150 6mm UPSTAND
	CS2 SQUARE CHANNEL BLOCK 150 x 125
	EF FLAT TOP EDGING 50 x 150
	DK DROP KERB 1:12 GRADIENT
	TK TRANSITION KERB FROM HALF BATTER TO BULLNOSE
	HB2 DENOTES DOUBLE STACKED HB2 KERB WITH +250mm TOTAL UPSTAND
	CP2 CHARGING POINT KIOSK
	CP4 DENOTES FUTURE CHARGING PYLONS ON CONCRETE BASES. ELECTRIC CONNECTION TO BE CAPPED AT GROUND LEVEL FOR FUTURE CONNECTION
	DP DENOTES DRAW PIT. 600x600
	DP DENOTES DRAW PIT. 900x900
	DP DENOTES DRAW PIT. 1200x1200
	DP DENOTES DRAW PIT. 450x450

NOTE: SEE DRAWINGS 005 & 006 FOR DETAILS

NOTE: KERB RADI LESS THAN 12m SHALL BE FORMED USING PRE-FORMED RADIUS KERBS. OTHERWISE STRAIGHTS OF NOT LESS THAN 300mm LONG SHOULD BE USED WITH MITRE CUTS.

KERBS SHALL BE BUTT JOINTED.
 KERBS SHALL BE LAID TO THE DESIGN LEVEL +/- 6mm.

FULL LENGTHS OF KERB PIECES SHALL BE USED WHERE POSSIBLE. IF PIECING UP IS REQUIRED UNITS SHALL NOT BE CUT TO LESS THAN HALF THEIR LENGTH.

TOLERANCES
 SUB-BASE TO RECEIVE BASE ROAD-BASE +/- 0/-30mm.
 BASE (ROADBASE) TO RECEIVE BINDER COURSE +/- 15mm.
 BINDER COURSE TO RECEIVE SURFACE COURSE +/- 6mm.
 SURFACE COURSE +/- 6mm.

THE SUM OF THE DEVIATIONS IN THE LEVELS OF DIFFERENT PAVEMENTS LAYERS SHALL NOT RESULT IN A REDUCTION OF THE REQUIRED DESIGN THICKNESS BY MORE THAN 8.5% OR IN THE OVERALL SURFACE COURSE THICKNESS BY MORE THAN 5mm.

P	Entrance resurfacing added as clouded	BG	MG	MG	07/12/22
N	Issued for As Built Mark Up	DS	MG	MG	27/09/22
M	Cycle store area revised.	BG	MG	MG	22/06/22
L	Additional concrete and works added to suit on BG site discussions. Gates configuration adjusted. Cycle store area revised.	BG	MG	MG	14/06/22
K	Future charging points revised to draw pits	BG	MG	MG	04/03/22
J	Web layout updated. Charging points & draw pits updated. Saw cuts updated.	BG	MG	MG	03/03/22
H	Substation and access footpath area revised. Concrete pour revised. Levels & site added.	BG	MG	MG	10/02/22
G	Model updated to coordinates. Revised to suit M&E layout.	BG	MG	MG	10/12/21
F	Revised to suit new layout as clouded	BG	MG	MG	08/11/21
E	Issued for Construction	BG	MG	MG	31/03/21
D	Issued for Construction	BG	MG	MG	30/03/21
C	Updated to suit revised site layout	BG	MG	MG	23/02/21
B	Fuel tank relocated, sliding gate introduced, gatehouse repositioned, sub-station repositioned.	BG	MG	MG	10/09/20
A	Fuel bund updated. Car park changed to permeable tarmac. Kerbs updated, fencing, bollards, armco edge added. concrete yard details added.	BG	MG	MG	18/08/20
O	Initial issue	BG	MG	MG	28/07/20

Portland consulting engineers
 10 Barkside, The Watermark, Gateshead, Tyne & Wear, NE11 9BY
 T: 0191 4819770 W: www.portlandconsulting.co.uk
 F: 0191 4003028 E: info@portlandconsulting.co.uk

Client
ESH CONSTRUCTION

Project
Parsons Depot Washington Sunderland City Council

Drawing Title
External Works Layout

Scale: 1:200 Sheet Size: A0
 Drawn By: BG Checked By: MG Approved By: MG Date: 27/07/20
 Drawing Status: Construction

Project No: 2021002 Drawing No: 002 Revision: P

This drawing and design for use only in connection with the above project. This drawing is the copyright of Portland Consulting Engineers and shall not be without the written consent of Portland Consulting Engineers. All dimensions and setting out shall be checked on site before construction. Do not scale from this drawing. This drawing is to be read in conjunction with all other information relevant to the project. Any apparent discrepancy shall be brought to the attention of Portland Consulting Engineers.

European Union
 European Regional Development Fund

ISO 9001
 REGISTERED FIRM





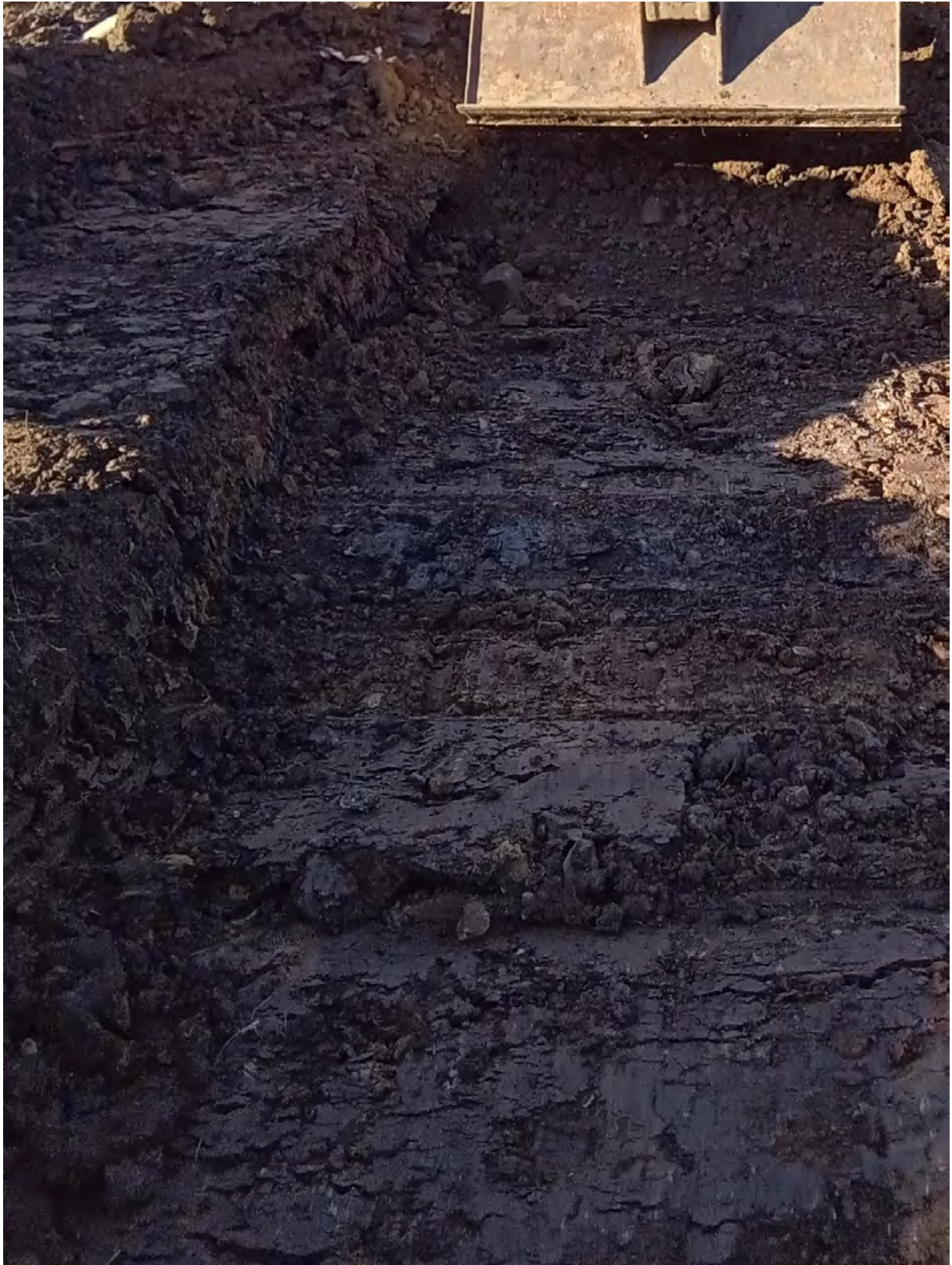

APPENDIX 6

WASTE TRANSFER NOTES FOR DISPOSAL OF EXCAVATED HOTSPOT MATERIAL



Port Clarence Site
Off Huntsman Drive
Middlesbrough TS2 1UE
tel. 01642 546836

ADVICE/WASTE TRANSFER NOTE TICKET NO:

503207 Permit : EPR/YF3234XR/VO07

<p>CUSTOMER: C003989 Groundwork Services (Durham) L Thistle Road Littleburn Industrial Estate Langley Moor Durham DH7 8HJ</p> <p>ORDER NO: GWS/PD/BJ/23-001 SOURCE: 256 North East</p>	<p>HAULIER: C003733 North East Tippers Ltd (Haulie Groundwork Servies (Durham) Lt Littleburn Industrial Estate Durham</p> <p>VEH. TYPE: TIPP TIPPER VEH. REG NO: NK67NEF CARRIER NO: CBDU191566 TRANSFER NO: GROUND00001</p>
---	---

WASTE TYPE:

WASTE CATEGORY: L170503 - Contaminated Soils

CONTAINER: **GRID REF:** SP15Q - **Job No. :** L230120100001

GROSS TARE NET	WEIGHT KG'S	SEQ. NO	DATE	TIME
MEASURE				16.34 Tonne

<p>PRINT NAME: PC-WEIGHBRIDGE</p>	<p>SIGNATURE ON BEHALF OF CUSTOMER: <i>[Signature]</i></p>
<p>SIGNATURE FOR AUGEAN: <i>[Signature]</i></p>	

The Hazardous Waste Regulations 2005: Consignment Note

29340



Environment Agency

PRODUCER'S/HOLDER'S/CONSIGNOR'S COPY (Delete as appropriate)

PART A Notification details

- 1 Consignment note code: **GROGWD/00001**
- 2 The waste described below is to be removed from (name, address, postcode, telephone, e-mail, facsimile):
**PARSONS DEPOT
WASHINGTON
NE37 1EQ**
- 3 The waste will be taken to (name, address and postcode):
**AUGAN, PORT CLARANCA,
OFF HUNTSMAN DRIVE, TS2 1UE**
- 4 The waste producer was (if different from 2) (name, address, postcode, telephone, e-mail, facsimile):
**ESH CONSTRUCTION
ESH HOUSE, BOWBURN NORTH, DURHAM
DH6 5PF**

PART B Description of the waste

If continuation sheet used, tick here

- 1 The process giving rise to the waste(s) was: _____ 2 SIC (2007) for the process giving rise to the waste: **42.9901**
- 3 WASTE DETAILS (where more than one waste type is collected all of the information given below must be completed for each EWC identified)

Description of waste	List of wastes (EWC code)(6 digits)	Quantity (kg)	The chemical/biological components in the waste and their concentrations are:		Physical form (gas, liquid, solid, powder, sludge or mixed)	Hazard code(s)	Container type, number and size
			Component	Concentration (% or mg/kg)			
SOILS & STONES HAZARDOUS	170503	19,000	TOP SOIL	>2000 mg/kg	SOLID	H7H11	8WH

The information given below is to be completed for each EWC identified

EWC code	UN identification number(s)	Proper shipping name(s)	UN class(es)	Packing group(s)	Special handling requirements

PART C Carrier's certificate

PART D Consignor's certificate

(If more than one carrier is used, please attach schedule for subsequent carriers. If schedule of carriers is attached tick here.)

I certify that I today collected the consignment and that the details in A2, A3 and B3 are correct and I have been advised of any specific handling requirements.

Where this note comprises part of a multiple collection the round number and collection number are:

1

1 Carrier name: **NORTH EAST TIPPLES**
On behalf of (name, address, postcode, telephone, e-mail, facsimile):
**LITTLEBURN IND ESTATE, LANGRICE MOOR
DURHAM DH7 8J5**

2 Carrier registration no./reason for exemption: **CB04191566**

3 Vehicle registration no. (or mode of transport, if not road):

Signature: *[Signature]*
Date: **09022023** Time: **0600**

I certify that the information in A, B and C has been completed and is correct, that the carrier is registered or exempt and was advised of the appropriate precautionary measures. All of the waste is packaged and labelled correctly and the carrier has been advised of any special handling requirements.

I confirm that I have fulfilled my duty to apply the waste hierarchy as required by Regulation 12 of the Waste (England and Wales) Regulations 2011.

1 Consignor name: **TOM GUNTER**
On behalf of (name, address, postcode, telephone, e-mail, facsimile):
**ESH CONSTRUCTION
ESH HOUSE
DURHAM
DH6 5PF**

Signature: *[Signature]*
Date: **09022023** Time: **0602**

PART E Consignee's certificate (where more than one waste type is collected all of the information given below must be completed for each EWC)

Individual EWC code(s) received	Quantity of each EWC code received (kg)	EWC code accepted/rejected	Waste management operation (R or D code)
170503	16340		D09

1 I received this waste at the address given in A3 on: Date **09022023** Time **0730**

2 Vehicle registration no. (or mode of transport if not road): **NUG8NEF**

3 Where waste is rejected please provide details:

Name: **DForeman**
On behalf of (name, address, postcode, telephone, e-mail, facsimile):

I certify that waste permit/exempt waste operation number:

Y83234XN0007

authorises the management of the waste described in B at the address given in A3.

Where the consignment forms part of a multiple collection, as identified in Part C, I certify that the total number of consignments forming the collection are:

AS43

Signature: *[Signature]*
Date: **09022023** Time: **0600**