

Steps  
Riser - Cotswold natural stone  
Treads - Riven natural stone



Existing opening filled in. New section  
of wall to tie in with existing

Metal handrail

Steps  
Riser - Cotswold natural stone  
Treads - Riven natural stone

Cotswold drystone retaining wall  
Coping - Riven natural stone

**KEY**

-  EXISTING TREE
-  PROPOSED TREE

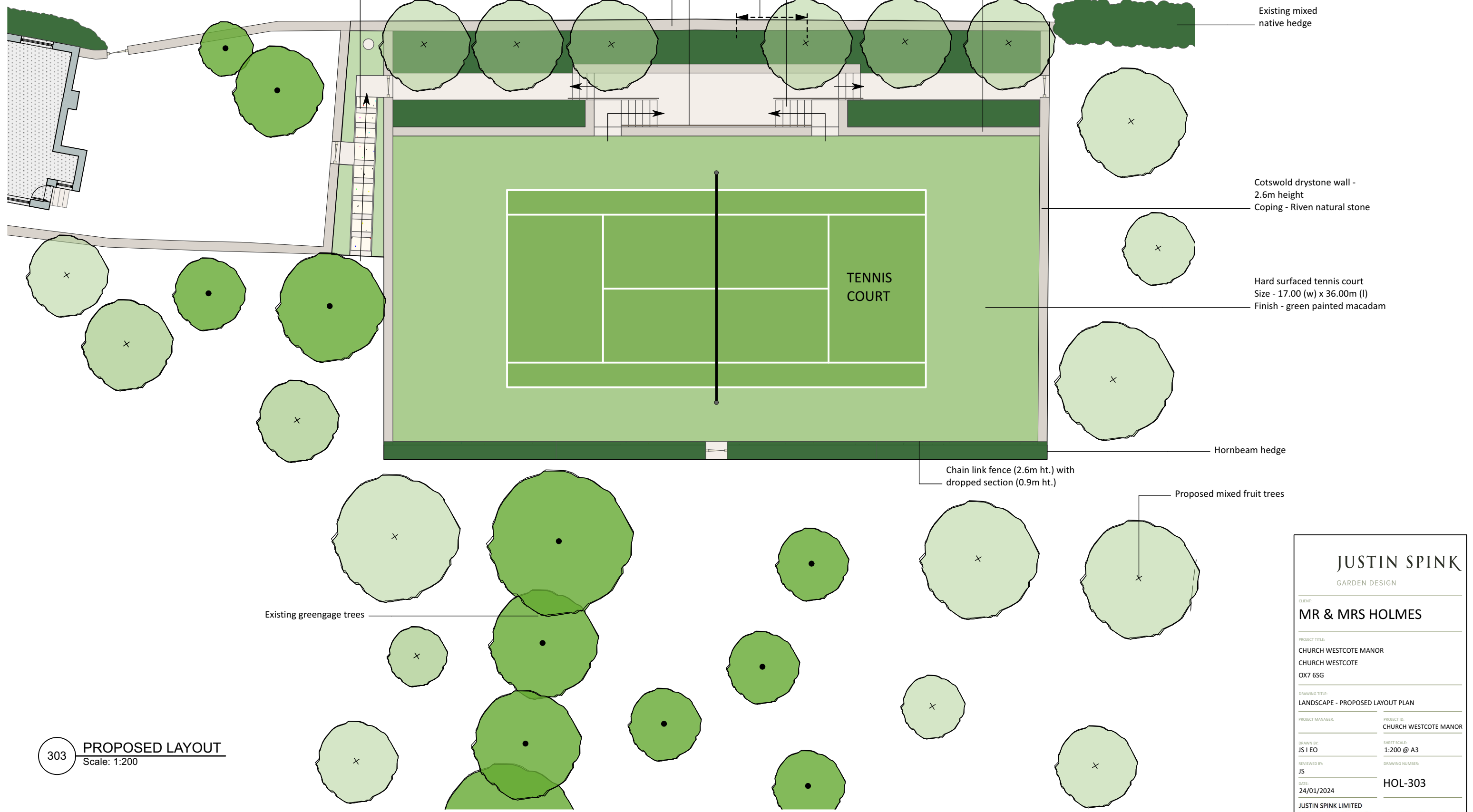

Existing mixed native hedge

Cotswold drystone wall - 2.6m height  
Coping - Riven natural stone

Hard surfaced tennis court  
Size - 17.00 (w) x 36.00m (l)  
Finish - green painted macadam

Hornbeam hedge

Chain link fence (2.6m ht.) with  
dropped section (0.9m ht.)

Proposed mixed fruit trees

Existing greengage trees

**303** PROPOSED LAYOUT  
Scale: 1:200

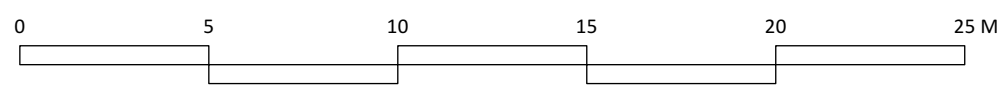

**JUSTIN SPINK**  
GARDEN DESIGN

CLIENT: **MR & MRS HOLMES**

PROJECT TITLE: **CHURCH WESTCOTE MANOR**  
CHURCH WESTCOTE  
OX7 6SG

DRAWING TITLE: **LANDSCAPE - PROPOSED LAYOUT PLAN**

PROJECT MANAGER: \_\_\_\_\_ PROJECT ID: **CHURCH WESTCOTE MANOR**

DRAWN BY: **JS I EO** SHEET SCALE: **1:200 @ A3**

REVIEWED BY: **JS** DRAWING NUMBER: \_\_\_\_\_

DATE: **24/01/2024** **HOL-303**

JUSTIN SPINK LIMITED  
WOOLSTONE MILL HOUSE, FARINGDON, OXON, SN7 7QL  
T: +44 (0)1367 821032, INFO@JUSTINSPINK.COM  
WWW.JUSTINSPINK.COM