

ARTICULATED VEHICLE SWEPT PATH  
SCALE 1:500

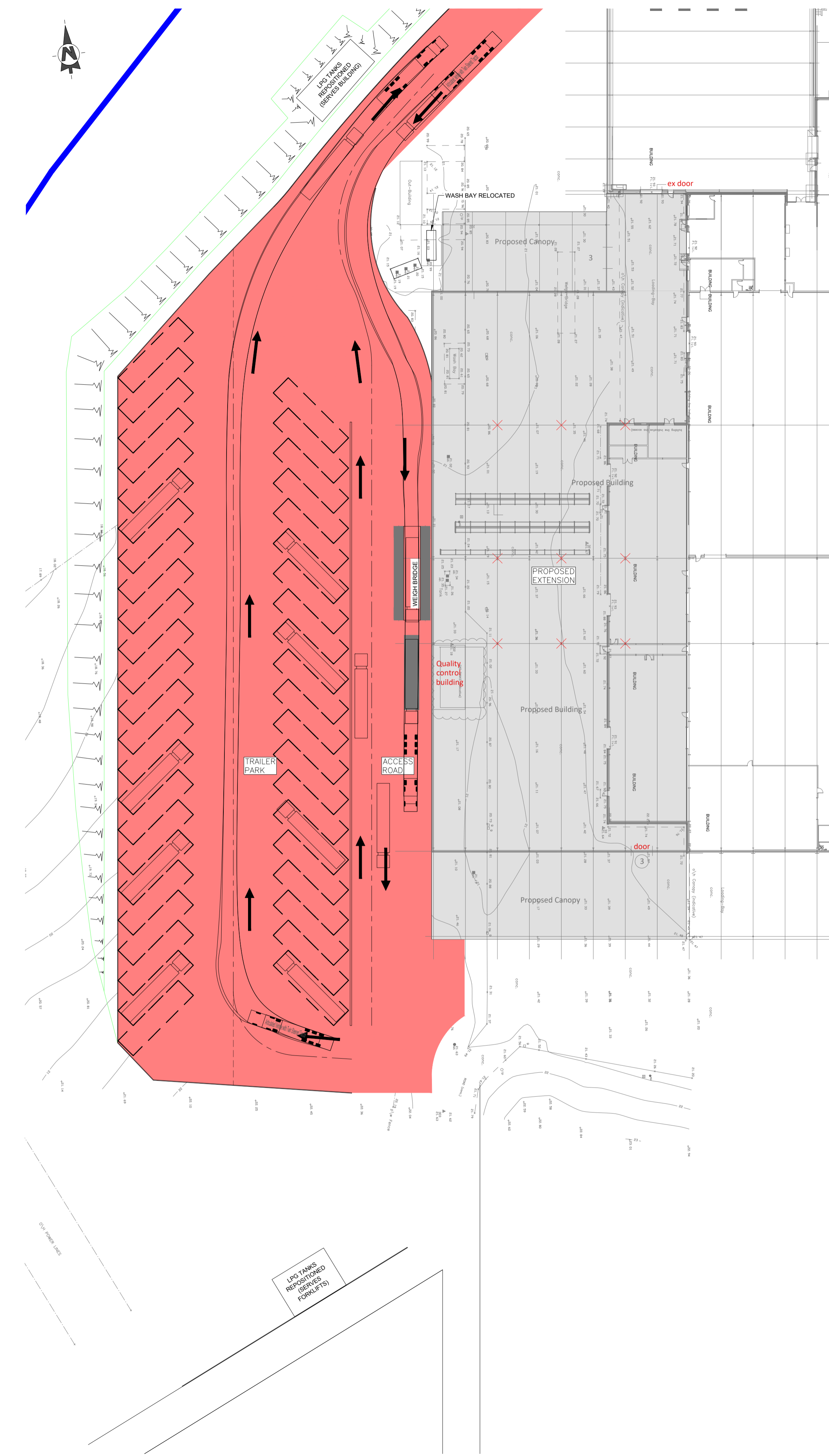

ARTICULATED VEHICLE SWEPT PATH  
SCALE 1:500

**DO NOT SCALE**  
Use figured dimensions only. If in doubt - Ask the Engineer

- NOTES**
- This drawing is to be read in conjunction with all other relevant drawings, notes and specifications issued by the Engineer, Architect, M&E Consultant.
  - All dimensions to be checked on site and the Engineer notified of any discrepancies prior to commencement of work. All dimensions are in meters (unless otherwise stated). Do not scale from this drawing or the computer digital data, only figured dimensions are to be used.
  - All levels are in meters above Ordnance Datum.
  - Topographical survey information taken from [TO BE ADVISED].
  - Prior to commencement of excavation works with mechanical plant, the Contractor shall confirm the location and depth of below ground services. Reference should be made to Statutory Authority records and available private service record plans, with sub-surface scanning and trial pits to confirm location, depth and extent of existing services.
  - Road geometry within the site is based upon requirements of the Scots National Roads Development Guide, with tracking of a refuse vehicle to validate suitability of geometry.
  - For determining visibility splay lengths and junction spacing, the following has been assumed with reference to the Highland Council Roads guidelines Table 5.3: (i) the existing Station Road would not be classified above a Major Residential Street; (ii) all development roads would be classified as Minor Residential Streets or lesser.

**ACCESS STRATEGY KEY**

- ROAD CHANNEL LINE/ FOOTWAY EDGING
- 4.0x16.0m LORRY BAY EXTENTS
- EXTENT OF PRIVATE CONCRETE ROAD AND TRAILER PARK

Articulated Vehicle with Twin Steered Tractor

Overall Length	16.500m
Overall Width	2.550m
Overall Body Height	3.691m
Min Body Ground Clearance	0.425m
Max Track Width	2.500m
Lock to lock time	6.00s
Kerb to Kerb Turning Radius	6.987m

A	UPDATED LAYOUT TO MATCH VE-TECH	09.02.24
Rev.	Description	Date

Status **PLANNING**

Client **ALBERT BARTLETT**

Project  
**EXTENSION & CANOPY TO EXISTING FACTORY/PROPOSED TRAILER PARK 251 STIRLING ROAD, AIRDRIE ML6 7SP**

Drawing Title  
**ACCESS STRATEGY**

Date	Scale	Size	Drawn	Checked
FEB 2024	1:500	A1	KT	NMcC

Mission Hall, 2A Waterloo Road, Prestwick Ayrshire KA9 2AA

01292 737224  
info@mccolm-design.com  
www.mccolm-design.com

Drawing No: **5852.ABL-001** Rev: **A**