

DO NOT SCALE

Use figured dimensions only. If in doubt - Ask the Engineer

NOTES

- This drawing is to be read in conjunction with all other relevant drawings, notes and specifications issued by the Engineer, Architect, M&E Consultant.
- All dimensions to be checked on site and the Engineer notified of any discrepancies prior to commencement of work. All dimensions are in meters (unless otherwise stated). Do not scale from this drawing or the computer digital data, only figured dimensions are to be used.
- All levels are in meters above Ordnance Datum.
- Topographical survey information taken from [TO BE ADVISED].
- Prior to commencement of excavation works with mechanical plant, the Contractor shall confirm the location and depth of below ground services. Reference should be made to Statutory Authority records and available private service record plans, with sub-surface scanning and trial pits to confirm location, depth and extent of existing services.
- Overflow connection to the existing public drainage is subject to Scottish Water approval.
- RWP locations to be confirmed by Architect.
- Drainage to be surveyed to identify location line and depth of existing sewers.
- Connection to existing on-site drainage network subject to capacity of existing pipes and wetland.
- New roof area of 6560m² to be tied into existing surface water system and drained into existing lagoon.
- Surface water runoff from trailer park handstanding, with an area of 11,170m², to be drained treat by an oil interceptor and filter trench before being attenuated in the existing wetland. Surface water is then allowed to naturally drain in the wetland, and if the wetland reaches its maximum capacity the water will be discharged through the existing overflow pipe and into the existing Scottish Water sewer system.
- Location and levels of all water mains and gas pipes to be confirmed by M&E consultant.

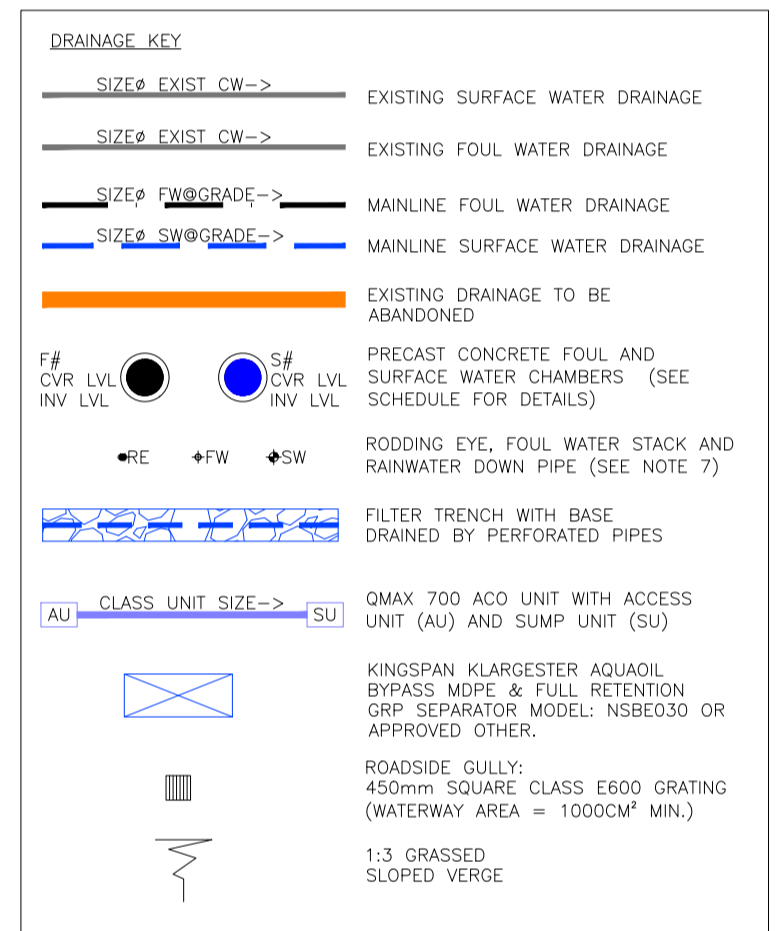

Rev	Description	Date
B	UPDATED TO MATCH VE-TECH LAYOUT	09.02.24
A	ADDED DIVERTED WATER MAINS	08.02.24

Status: **PLANNING**

Client: **ALBERT BARTLETT**

Project: **EXTENSION & CANOPY TO EXISTING FACTORY/PROPOSED TRAILER PARK 251 STIRLING ROAD, AIRDRIE ML6 7SP**

Drawing Title: **DRAINAGE STRATEGY**

Date	Scale	Size	Drawn	Checked
FEB 2024	1:500	A1	KT	NMcC



Drawing No: **5852.ABL-003** Rev: **B**

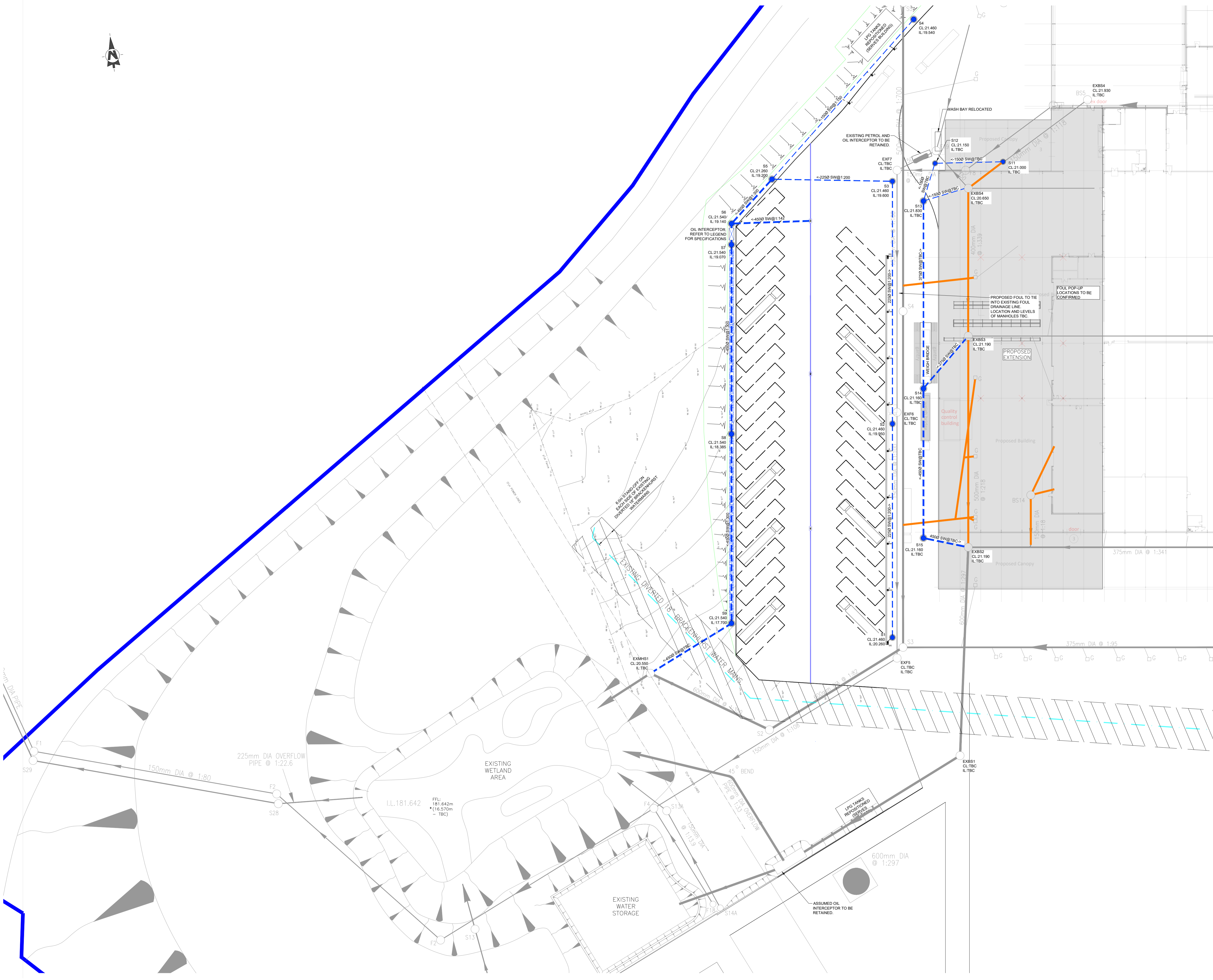

THIS DRAWING MAY NOT BE COPIED, REPRODUCED OR TRANSMITTED IN ANY FORM OR BY ANY MEANS WITHOUT THE EXPRESS PERMISSION OF THE AUTHOR