

dowling avenue

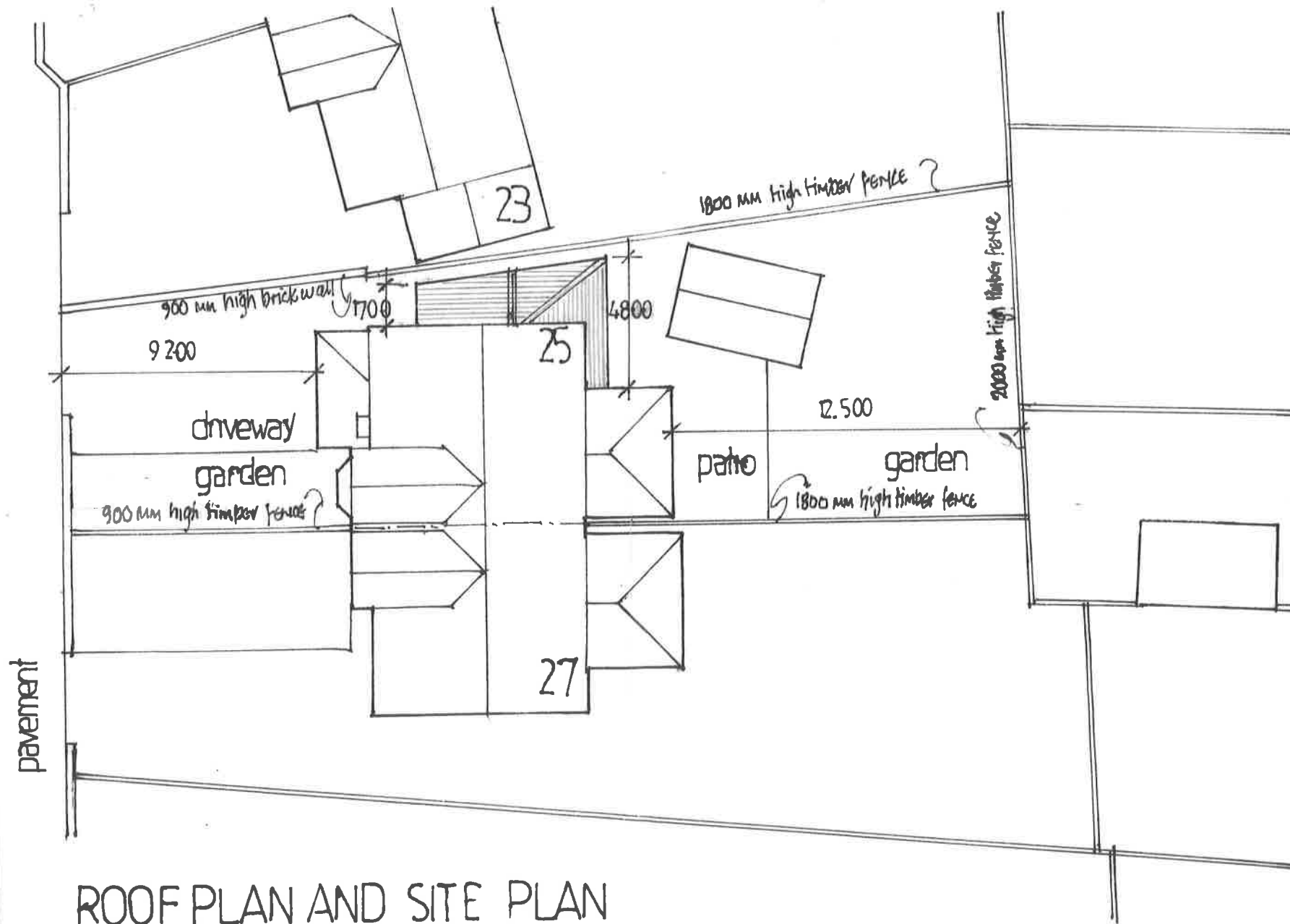

ROOF PLAN AND SITE PLAN

PROPOSED ALTERATIONS, 25 DOWLING AVENUE,
WHITLEY BAY, TYNE AND WEAR
FOR MR CHOWDHURY

IAN M. COOK DIP ARCH **ARCHITECT**
TEL (0191) 259 0590 Email ianmcook39@gmail.com
7 LOVAINE PLACE, NORTH SHIELDS, NE29 0BW

Scale: 1:200@A3	262919
Drawn: cook	
Date: January 2024	

♦ This drawing is copyright. All dimensions to be checked on site.