

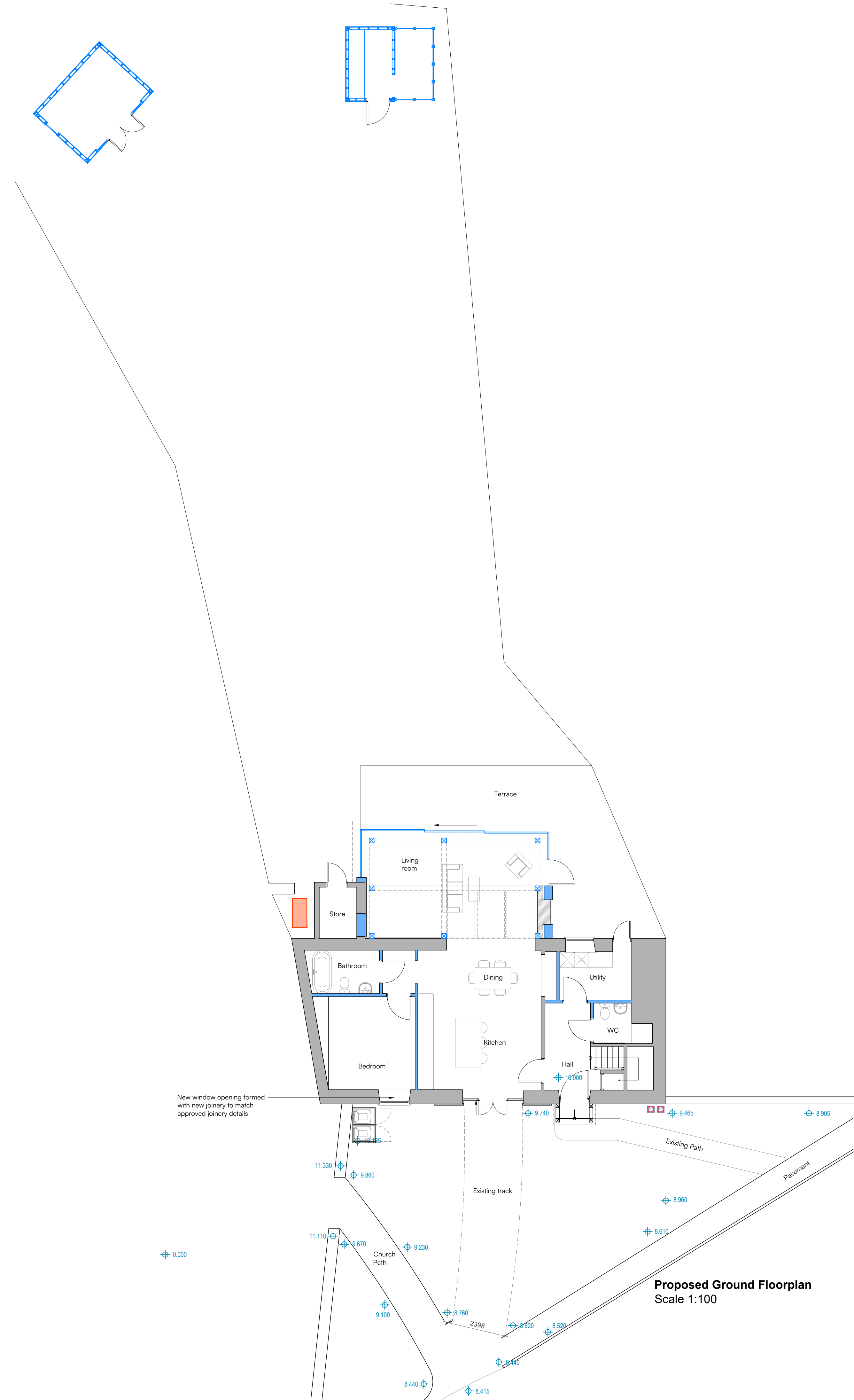

Existing Ground Floorplan as approved
Scale 1:100

- KEY**
- Existing Walls
 - Previously approved proposed works (2023/10/17/FUL & 2023/10/18/LBA)



Proposed Ground Floorplan
Scale 1:100

Project Name:

New Window

Project Address:

6 The Street,
South Luffenham
LE15 8NX

Client:

Mr & Mrs P
Hallewell

Project:

1689

Drg No:

20

Revision:

Drawing Title:

Existing and Proposed
Plans

Scale:

1:100

Paper size:

@A1

Drawn: RJ

Checked: Initial

Issue:

PLANNING