

CALLOUT 1 (ACCESS)
SCALE 1:250

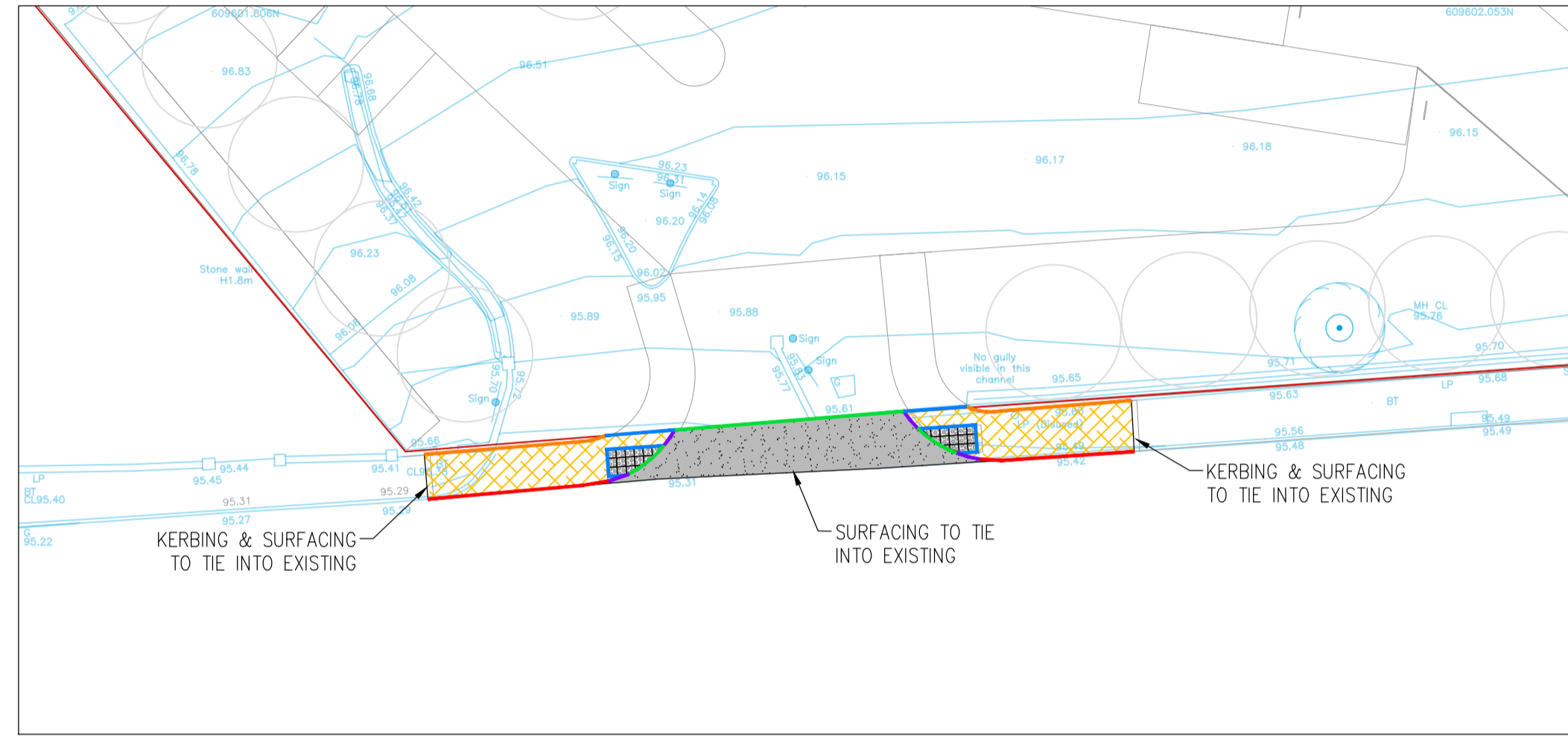

CALLOUT 2 (EGRESS)
SCALE 1:250

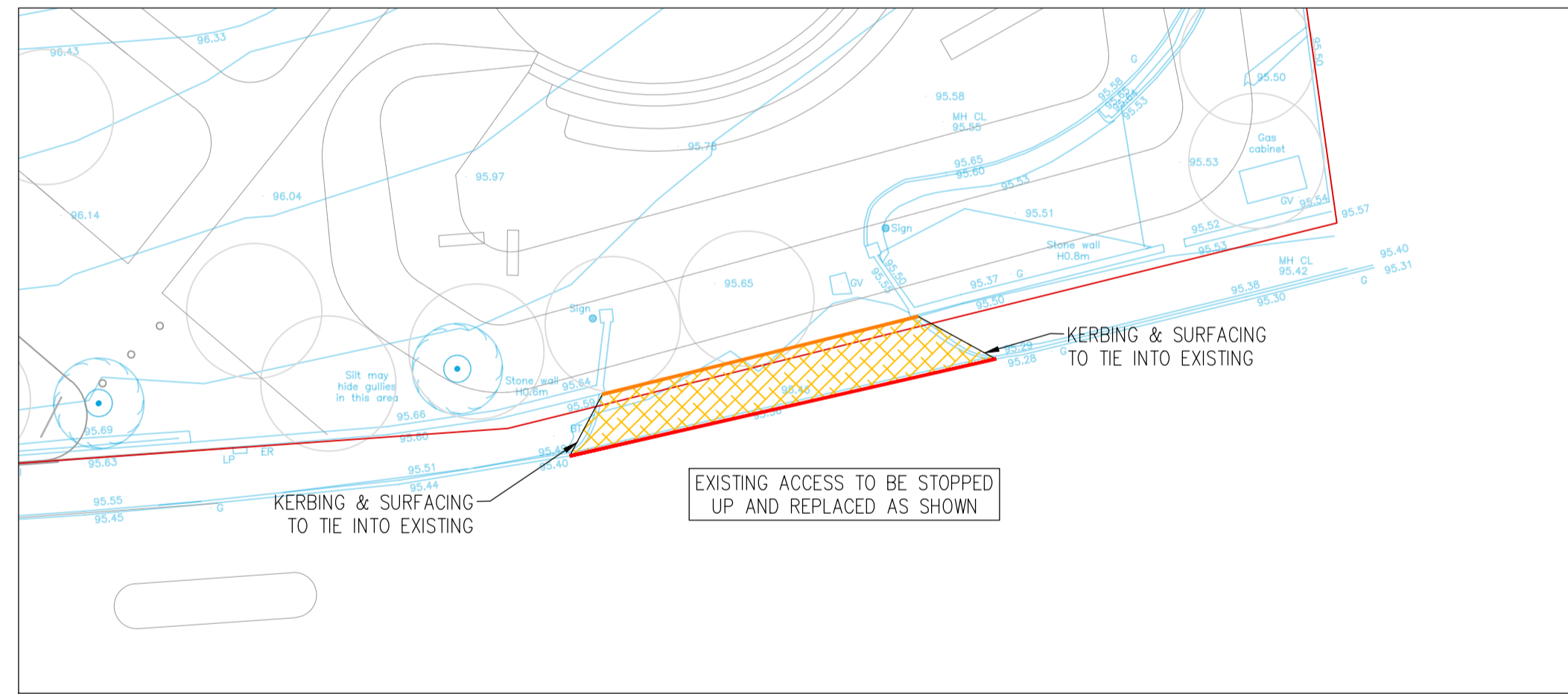

CALLOUT 3 (EXISTING ACCESS STOPPING UP)
SCALE 1:250

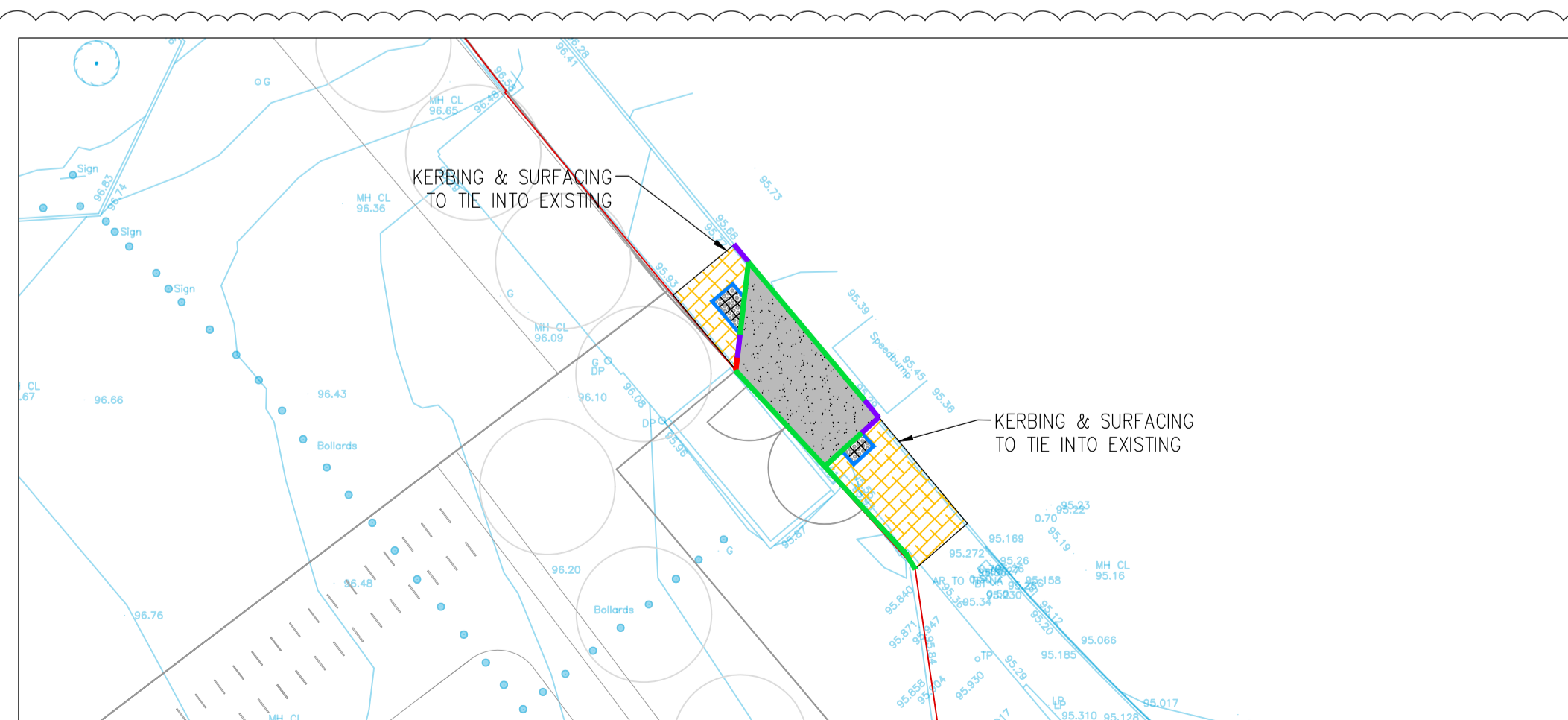

CALLOUT 4 (CADEET CENTRE ACCESS/EGRESS)
SCALE 1:250

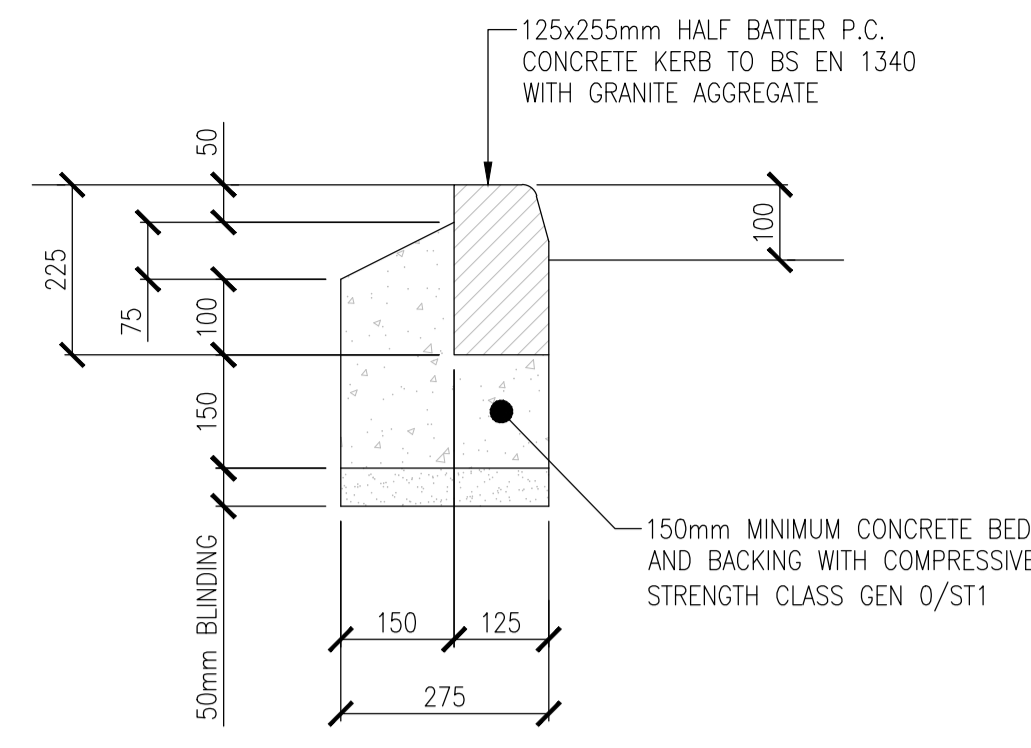

TYPICAL HALF BATTER KERB DETAIL
SCALE 1:10

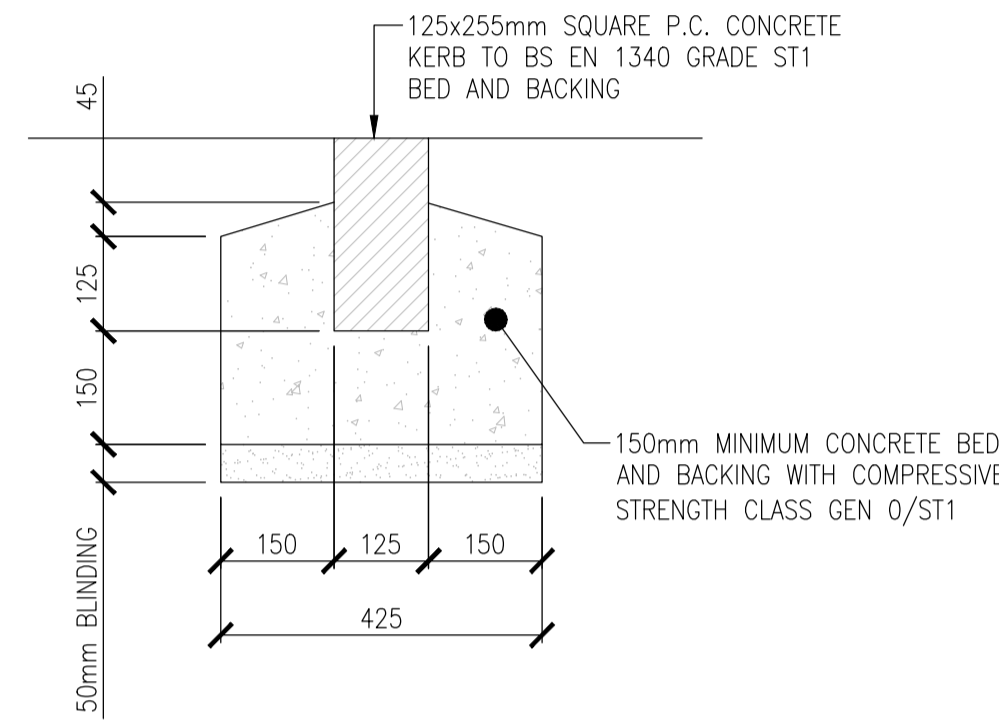

TYPICAL FLAT TOP KERB DETAIL
SCALE 1:10

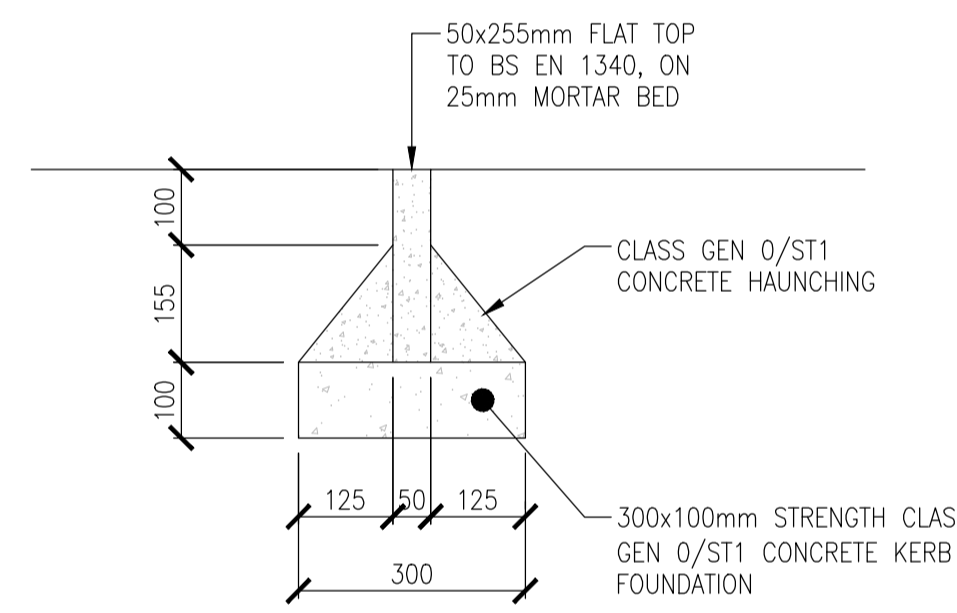

TYPICAL FLAT TOP KERB DETAIL
SCALE 1:10

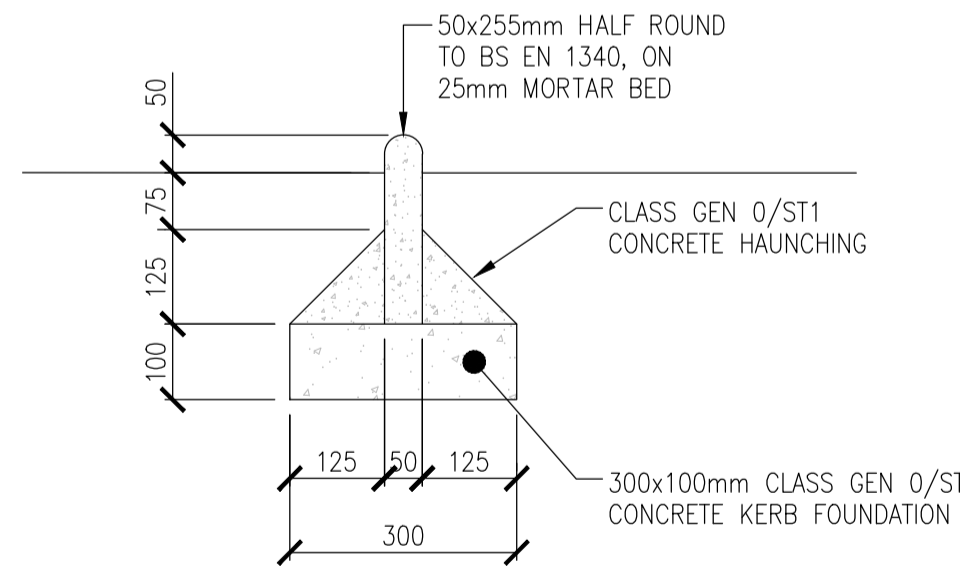

TYPICAL ROUND TOP UPSTAND KERB DETAIL
SCALE 1:10

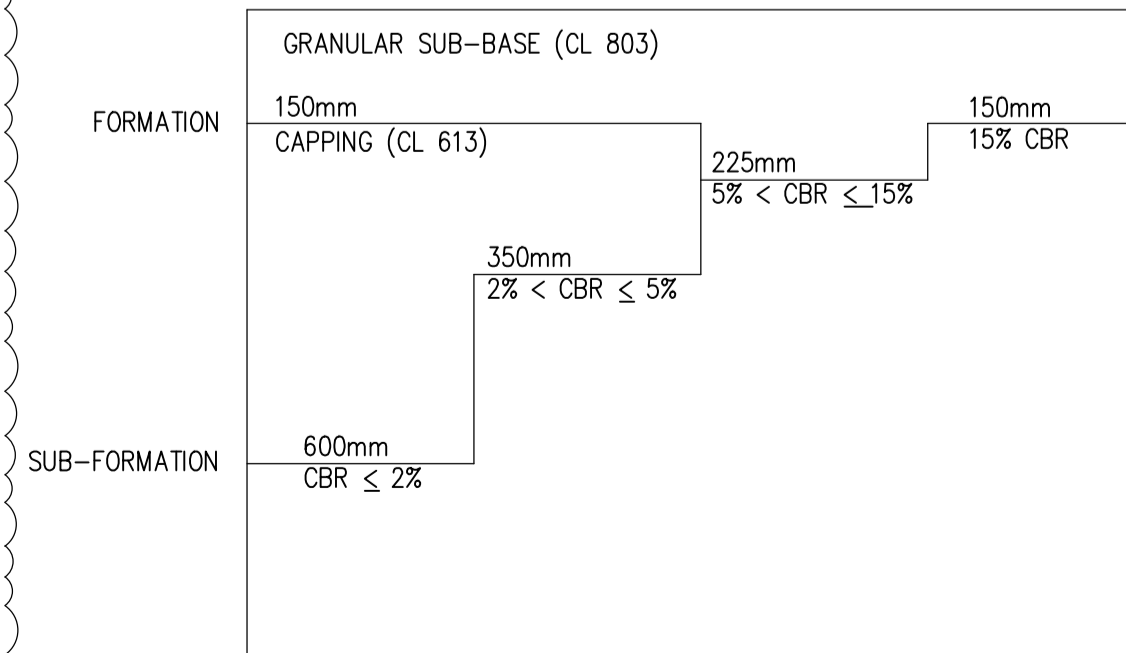

CAPPING LAYER REQUIREMENTS: SUBJECT TO FROST SUSCEPTIBILITY

NOTE:
IF CBR VALUES ARE LESS THAN 5% A CAPPING LAYER TO CLAUSE NO. 613 WILL BE REQUIRED - REFER TO TABLE FOR DETAILS OF SUB-BASE AND CAPPING LAYER THICKNESS CONFIRMED BY INSITU CBR TESTING.

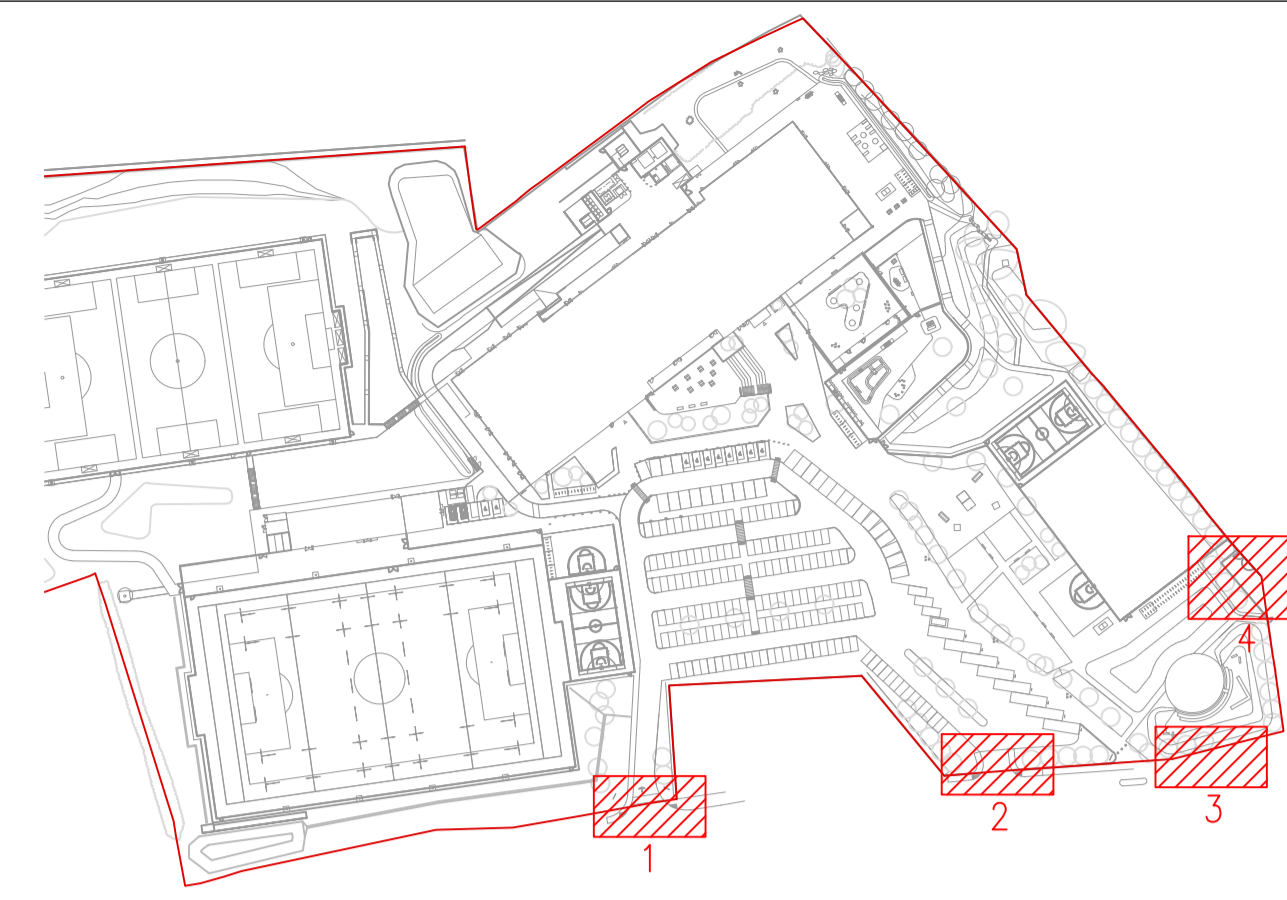

KEY PLAN
SCALE 1:2500

REFER TO DRAWING MAY-BHK-ZZ-ZZ-DR-C-04420 FOR TACTILE/DROP KERB/TIE-IN DETAILS

CLAUSE REFERENCES ARE AS PER MANUAL OF CONTRACT DOCUMENTS FOR HIGHWAY WORKS, VOLUME 1, SPECIFICATION FOR HIGHWAY WORKS.

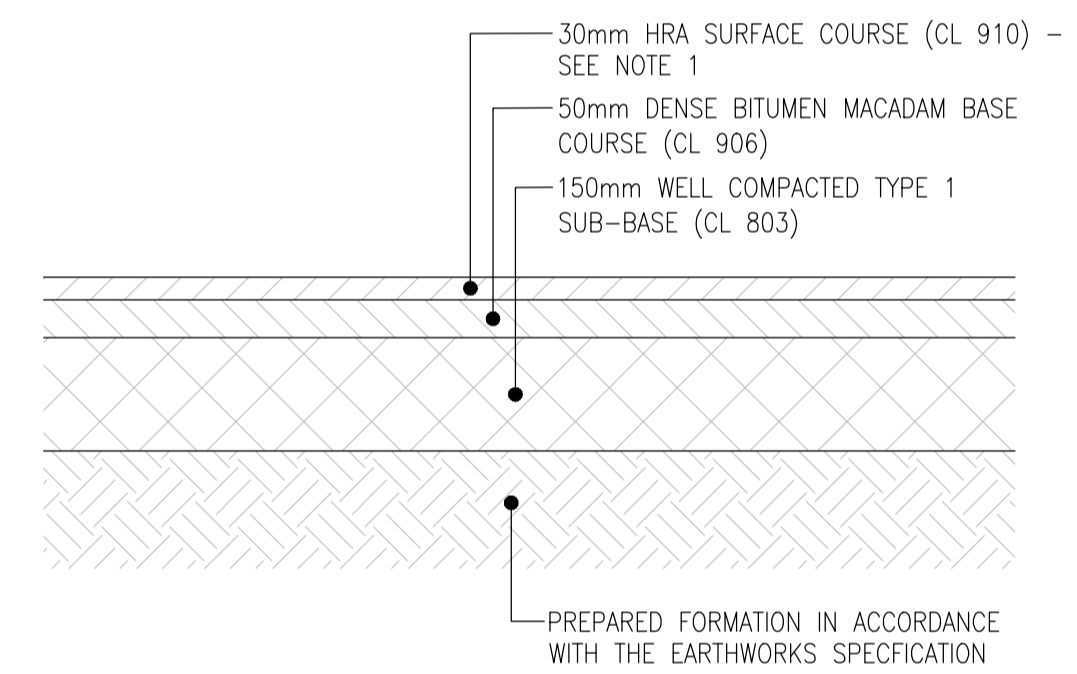

NOTE:
1. PRIOR TO COMPACTION, 6mm OR 10mm LIMESTONE OR OTHER APPROVED CHIPPINGS SHALL BE APPLIED TO THE SURFACE AT A NOMINAL RATE OF 1kg/m².

TYPICAL HOT ROLLED ASPHALT (HRA) FOOTPATH CONSTRUCTION DETAIL
SCALE 1:10

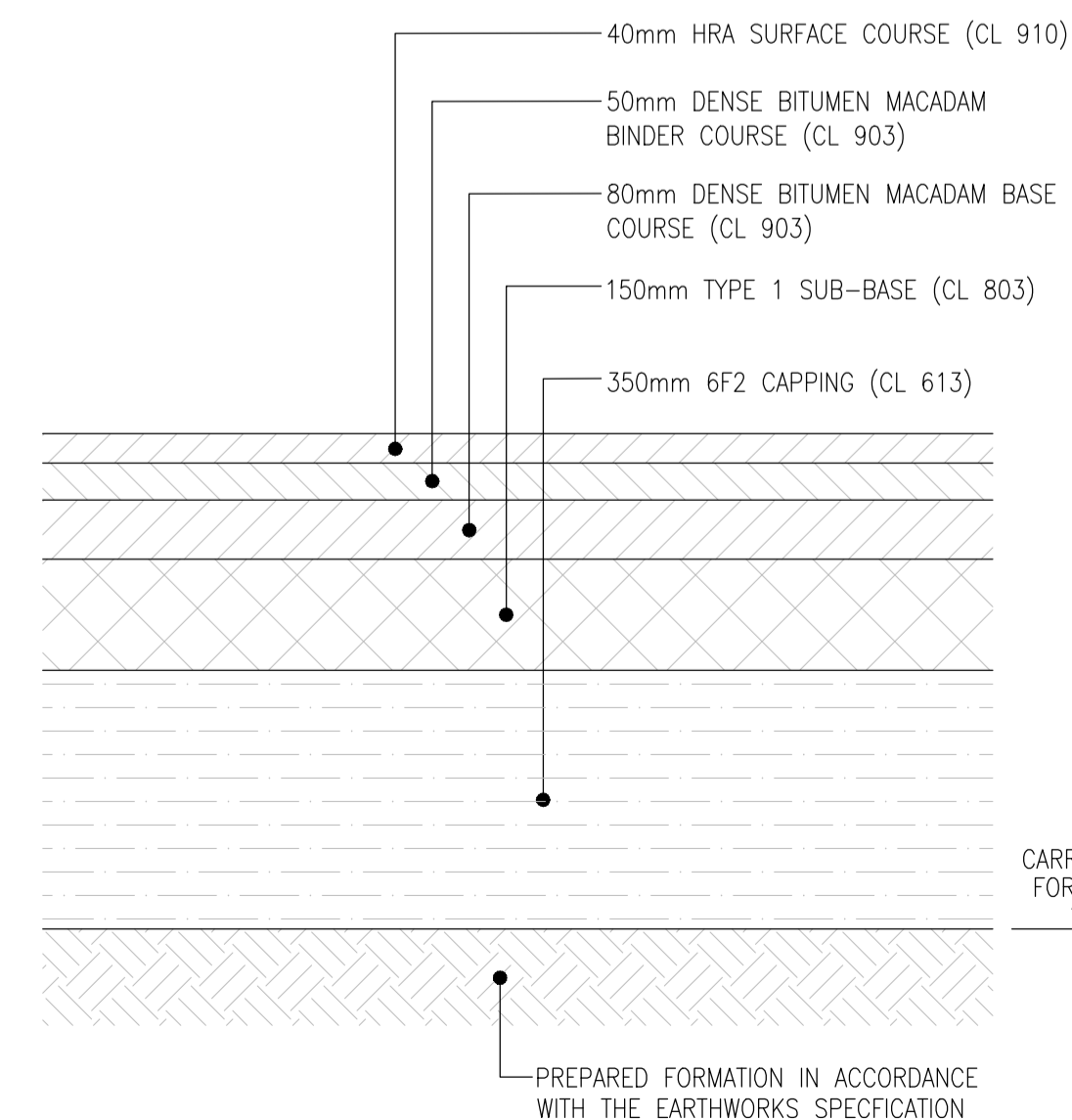

TYPICAL HOT ROLLED ASPHALT (HRA) CARRIAGEWAY CONSTRUCTION DETAIL
SCALE 1:10

GENERAL NOTES:

- ALL BAKERHICKS DRAWINGS ARE TO BE READ IN CONJUNCTION WITH THE RELEVANT BAKERHICKS SPECIFICATIONS AND ALL RELEVANT ARCHITECTS AND SERVICE ENGINEER'S DRAWINGS AND SPECIFICATION.
- ALL LEVELS ARE IN METRES ABOVE ORDINANCE DATUM. ALL DIMENSIONS ARE IN MILLIMETRES UNLESS NOTED OTHERWISE.
- DO NOT SCALE ANY ENGINEERING DRAWINGS. IF IN DOUBT WORK TO FIGURED DIMENSIONS ONLY. ANY DISCREPANCIES IN DIMENSIONS ARE TO BE REFERRED TO ENGINEER BEFORE WORK IS PUT TO HAND.
- THE CONTRACTOR MUST ADVISE THE ARCHITECT AND ENGINEER OF ANY DISCREPANCIES BETWEEN THE CONTRACT DRAWINGS AND/OR SITE CONDITIONS / DIMENSIONS AT THE EARLIEST POSSIBLE OPPORTUNITY.
- REVISION NOTES ARE FOR GUIDANCE ONLY. FOR SPECIFIC DETAILS, REFER TO CLOUDED AREAS ON DRAWINGS FOR MOST RECENT AMENDMENTS.
- ALL DIMENSIONS AND LEVELS ARE TO BE CHECKED ON SITE BY THE CONTRACTOR OR HIS SUB-CONTRACTOR PRIOR TO PREPARING ANY WORKING DRAWINGS OR COMMENCING ON SITE.
- ALL WORK HAS TO BE CARRIED OUT WITH THE REQUIREMENTS OF THE RELEVANT STATUTORY AUTHORITIES AND REGULATIONS.
- ALL METHOD STATEMENTS SHOULD BE SUBMITTED TO THE ARCHITECT / PRINCIPAL DESIGNER AND ENGINEER FOR REVIEW AT LEAST TWO WEEKS BEFORE CARRYING OUT THE SAID WORKS.
- ALL ROAD MARKINGS ALONG THE ENTIRE SITE FRONTAGE TO BE REFRESHED.

KEY:

- PEDESTRIAN FOOTWAY - HOT ROLLED ASPHALT CONSTRUCTION
- CARRIAGEWAY - ASPHALT
- TACTILE PAVING
- HALF BATTER KERB
- FLAT TOP KERB (FLUSH, 125mm WIDE)
- FLAT TOP KERB (FLUSH, 50mm WIDE)
- FLAT TOP KERB (50mm WIDE, 50mm UPSTAND)
- TRANSITION KERB

NOTES:

- THIS DRAWING SHOULD BE READ IN CONJUNCTION WITH THE LANDSCAPE ARCHITECTS PROPOSALS.

P02	19/01/2024	CADET ACCESS INGRESS/EGRESS ADDED AS CLOUDED	LMcG	NS / SP
P01	24/05/2022	FIRST ISSUE	LMcG	NS / GJ
Revision	Date	Description	Drawn	Checked / Approved

Project
MAYBOLE COMMUNITY CAMPUS

Title
SECTION 56 APPLICATION LAYOUTS & DETAILS

Scale	AS SHOWN	Drawn	LMcG	Checked	NS	Approved	GJ
(when plotted @ A1)	Date	23/05/2022	Date	23/05/2022	Date	23/05/2022	
CAD Ref	S:\scotland\Projects\30002056 Maybole Community Campus\09_CAD\03_BH\04_cad\Model Information (MP)						

BakerHicks.

BakerHicks
Trinity One
11 Woodhall
Eurocentral
Motherwell
ML1 4YT
T. 01698 738 600
www.baker-hicks.com

Sheet number	MAY-BHK-ZZ-ZZ-DR-C-04470		
Project number	30002056	Suitability	S2
Revision		Checked	P02