

PROPOSED FLOOR PLAN

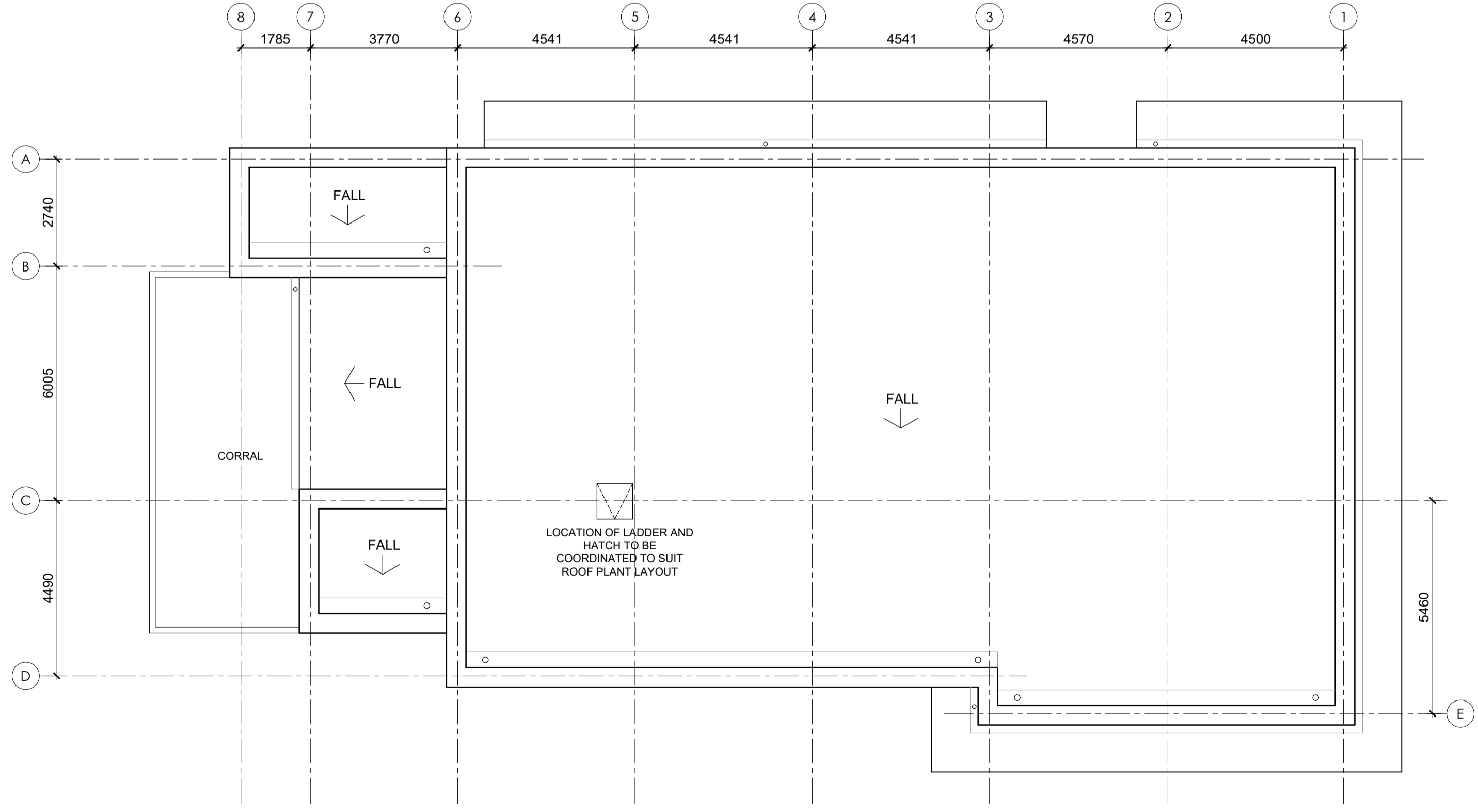

PROPOSED ROOF PLAN

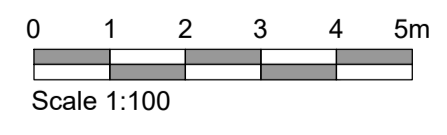

PROPOSED FLOOR AND ROOF PLAN 1:100

- NOTES**
- All dimensions and levels are to be checked on site.
 - Any discrepancies are to be reported to the architect before any work commences.
 - This drawing shall not be scaled to ascertain any dimensions. Work to figured dims only.
 - This drawing shall not be reproduced without express written permission from AEW.
 - Title overlay drawings and ownership boundaries are produced using all reasonable endeavours. AEW cannot be responsible for the accuracy or scale discrepancy of base plans supplied to them.
 - All works are to be undertaken in accordance with Building Regulations and the latest British Standards.
 - All proprietary materials and products are to be used strictly in accordance with the manufacturers recommendations.

CDM 2015

Client notified of duties: **At Design Workshops**
 Principal Designer: **CSS**

Unless noted below, all known hazards have been highlighted on the drawing:

Notes:
 All drawings to be read in conjunction with all other drawings as noted on issue sheet.

REV	Date	Drawn by:-	Checked by:-
A	09/02/24	AF	EOH
COLLECT WINDOW REPOSITIONED. COURIER AREA REDUCED AND WINDOW OMITTED. COLD ROOMS INCREASED. BOH ACCESS TO CORRAL ADDED. CYCLE STORAGE ADDED			
-	02/02/24	AF	EOH
INITIAL ISSUE			
Status Purpose of Issue			
S2 For Information			
drawing stage STAGE 1			
client McDonald's Restaurants Ltd			

project	store
MONIFIETH DUNDEE	1006
drawing title PROPOSED FLOOR AND ROOF PLAN	

date **02.02.2024** drawn **AF**
 scale@A1 **1:100** checked **EOH**

PLANNING
IRLX