

Ordnance Survey, (c) Crown Copyright 2022. All rights reserved. Licence number 100022432

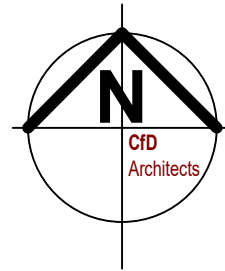

PS1	24/01/2024	Planning Submission
P2	14/02/2022	Boundary lines revised
Rev.	Date	Description

18 Belle Vue Road, Saltash. PL12 6ES
tel: 01752 297421

Planning

office@cf-d-architects.co.uk
www.cf-d-architects.co.uk

DRAWING REVISIONS: Revisions are by **Project**.
This means that all drawing sheets with the same revision letter reflect the same state of the project.
Consequently some drawing sheets may skip a letter.

- No Construction / tender issue
- No Building Control issue

client:
Stephen and Christina O'Brien

project:
1 Glencairn

drawing:
Location plan

project no.
2203

scale at A4 **1 : 1250**

drawing no. **101** rev. **PS1**



RIBA chartered practice no. 00099910

CFD Architects Ltd 24/01/2024