

# Philip Renouf Architectural Design

info@pr-architecture.co.uk  
tel: 07923 810363

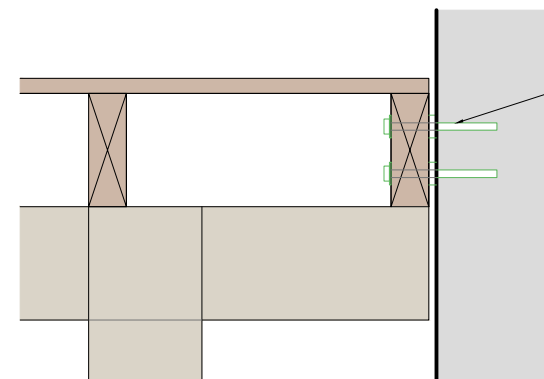
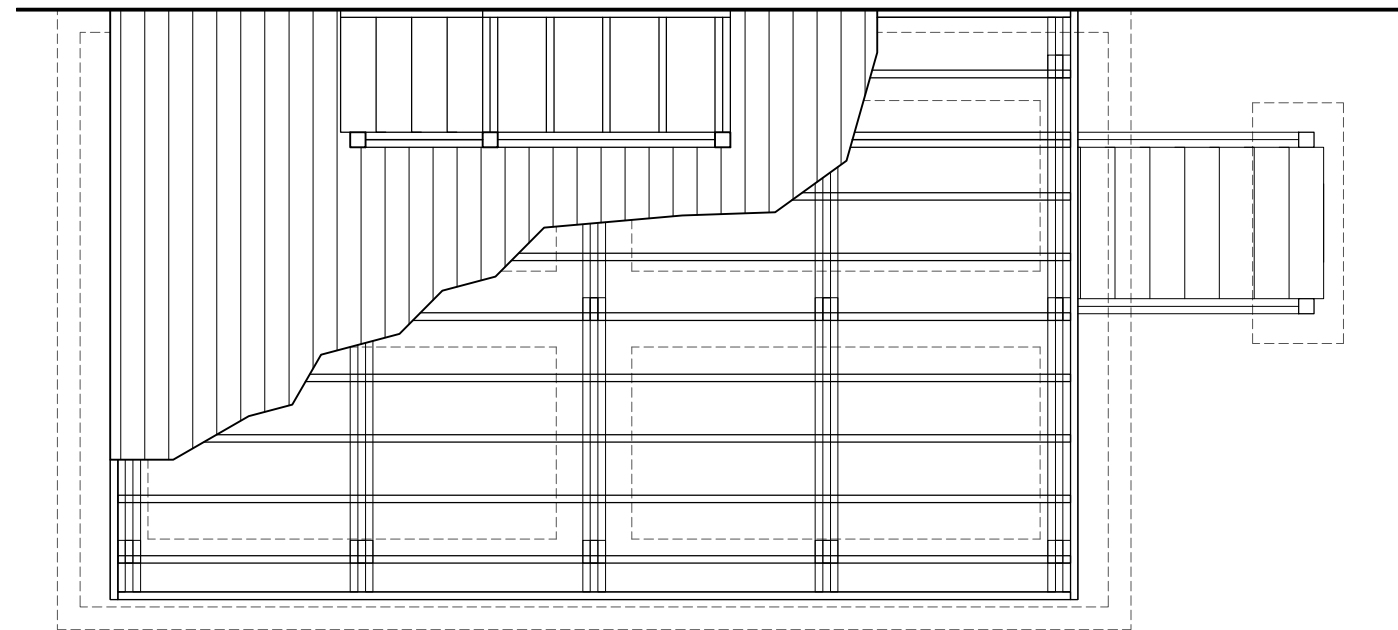
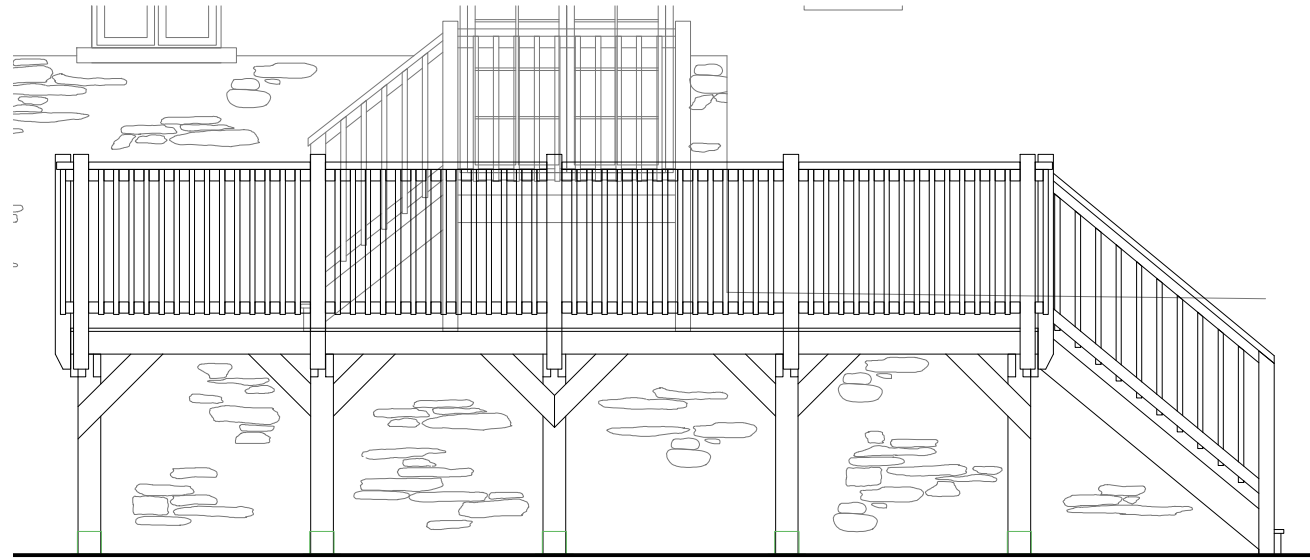

Joists at both upper and lower deck levels fixed at staggered centres using resin-bound M10 bolts @ 600mm c/c

**Material:** Pressure-treated pine structure and decking, on powder coated square steel post brackets, on concrete raft per engineers specification.



Constructors to check all dimensions on site prior to commencement. Any discrepancies should be highlighted to Philip Renouf Architectural Design.

Copyright remains the property of Philip Renouf Architectural Design. Permission should be obtained prior to reproduction.

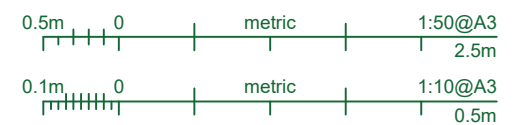

Client: **Pagett**

Site Address: **Abbotsford  
The Bury  
Thorverton, Devon**

Drawing No/Rev: **P5.7 \_ Rev J**

Drawing Title: **Decking Design**

By: **PR** Date: **26.02.2024**