

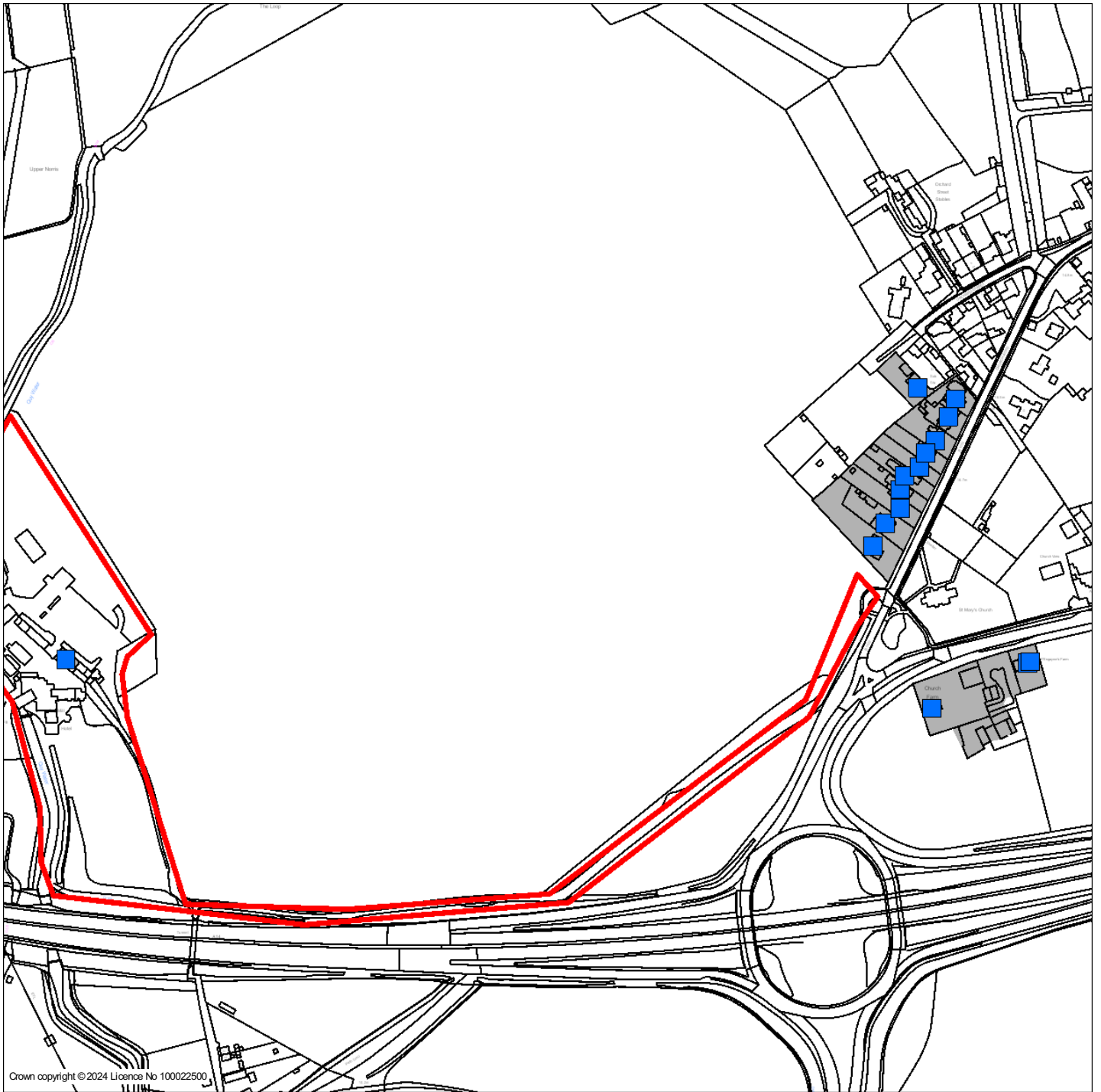



# Map of notified neighbours for 24/00688/LBC



 Site boundary     Neighbour Address Point     Neighbour Address Extent  
(if available)

**LPA:** South Cambridgeshire District Council

**Date Valid:** 26/02/2024

**Neighbours notified:** 16

**Validated by:** Ian Papworth

**Case Officer:** Nick Yager

**Notification sent:** 29/02/2024

**The following addresses have been notified:**

<b>Address</b>	<b>Sent</b>	<b>Expiry</b>
Staff Accommodation Quy Mill Hotel Church Road Stow Cum Quy Cambridgeshire CB25 9AF	29/02/2024	21/03/2024
16 Church Road Stow Cum Quy Cambridgeshire CB25 9AF	29/02/2024	21/03/2024
18 Church Road Stow Cum Quy Cambridgeshire CB25 9AF	29/02/2024	21/03/2024
Church Farm Newmarket Road Stow Cum Quy Cambridgeshire CB25 9AQ	29/02/2024	21/03/2024
Church Farmhouse Church Farm Newmarket Road Stow Cum Quy Cambridgeshire CB25 9AQ	29/02/2024	21/03/2024
36 Church Road Stow Cum Quy Cambridgeshire CB25 9AF	29/02/2024	21/03/2024
28 Church Road Stow Cum Quy Cambridgeshire CB25 9AF	29/02/2024	21/03/2024
22 Church Road Stow Cum Quy Cambridgeshire CB25 9AF	29/02/2024	21/03/2024
Annexe D Engaynes Farm Newmarket Road Stow Cum Quy Cambridgeshire CB25 9AQ	29/02/2024	21/03/2024
23 Orchard Street Stow Cum Quy Cambridgeshire CB25 9AE	29/02/2024	21/03/2024
34 Church Road Stow Cum Quy Cambridgeshire CB25 9AF	29/02/2024	21/03/2024
32 Church Road Stow Cum Quy Cambridgeshire CB25 9AF	29/02/2024	21/03/2024
30 Church Road Stow Cum Quy Cambridgeshire CB25 9AF	29/02/2024	21/03/2024
26 Church Road Stow Cum Quy Cambridgeshire CB25 9AF	29/02/2024	21/03/2024
24 Church Road Stow Cum Quy Cambridgeshire CB25 9AF	29/02/2024	21/03/2024
D Engaynes Farm Newmarket Road Stow Cum Quy Cambridgeshire CB25 9AQ	29/02/2024	21/03/2024

Notifications are carried out in accordance with our [Statement of Community Involvement](#).