

0m 20m 1/200 (A1)

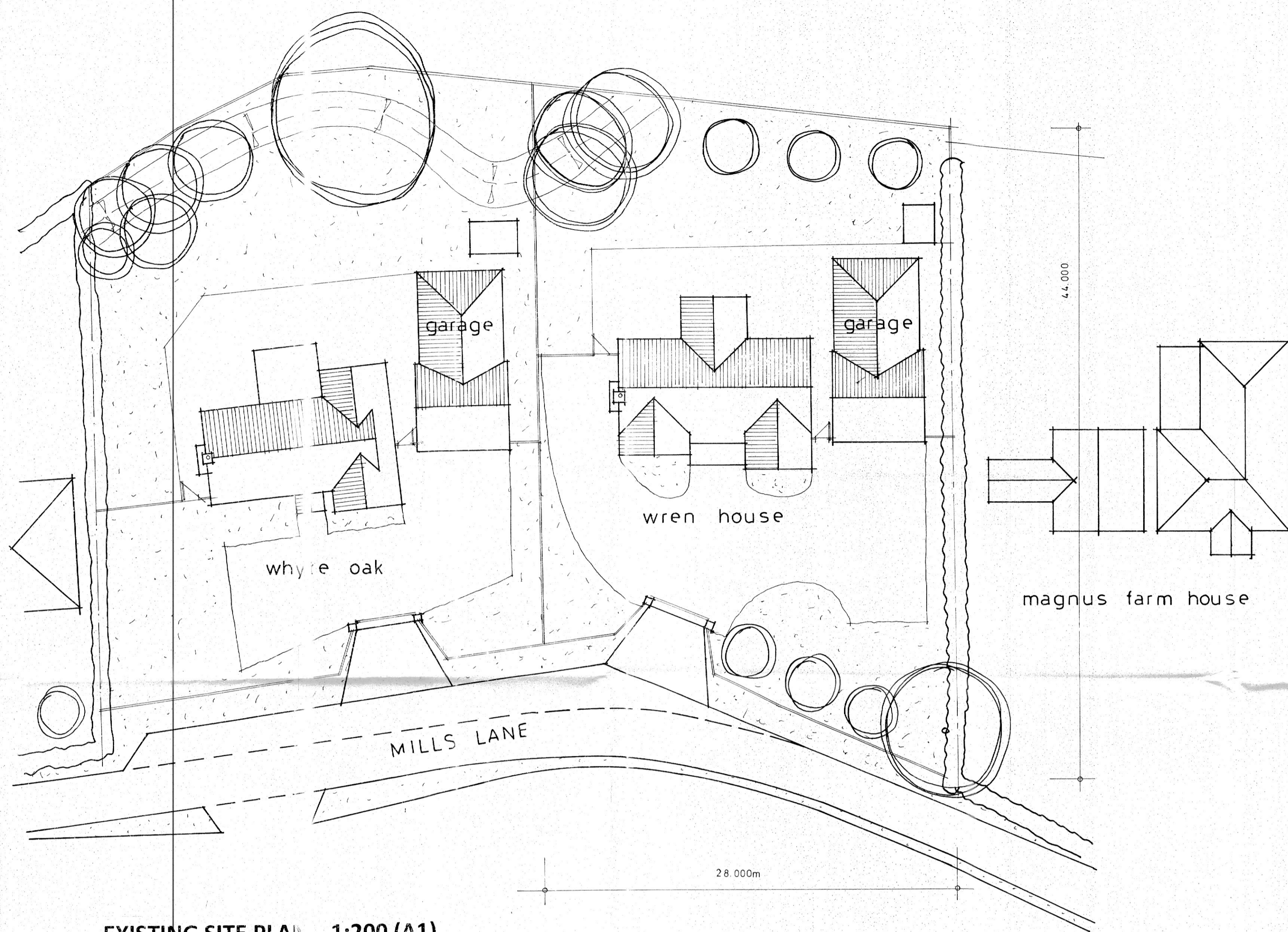

EXISTING SITE PLAN 1:200 (A1)

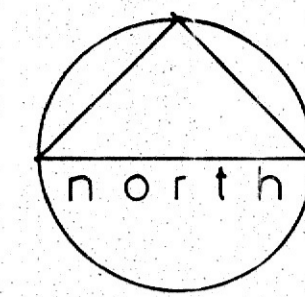

0m 20m 1/200 (A1)

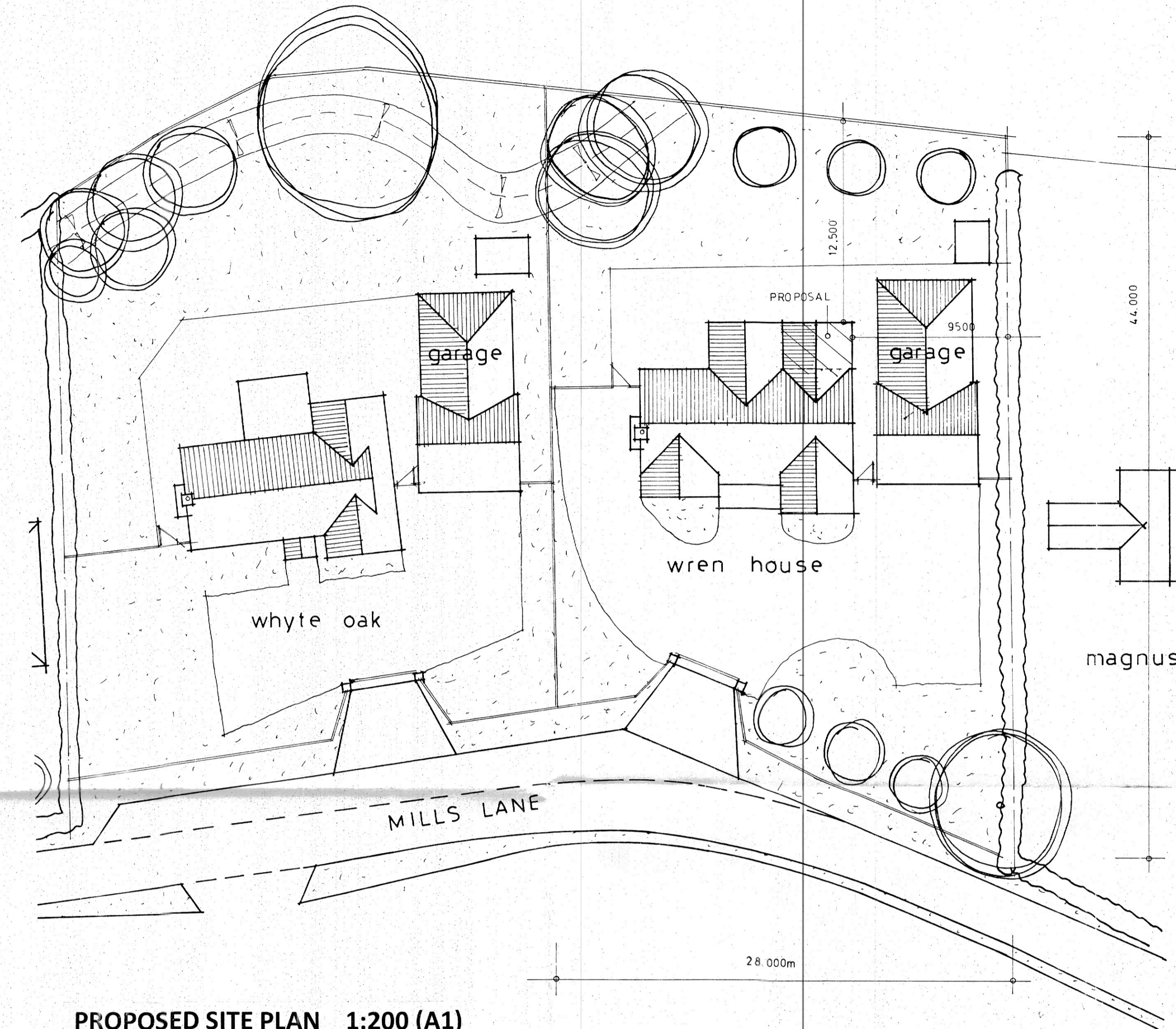

PROPOSED SITE PLAN 1:200 (A1)

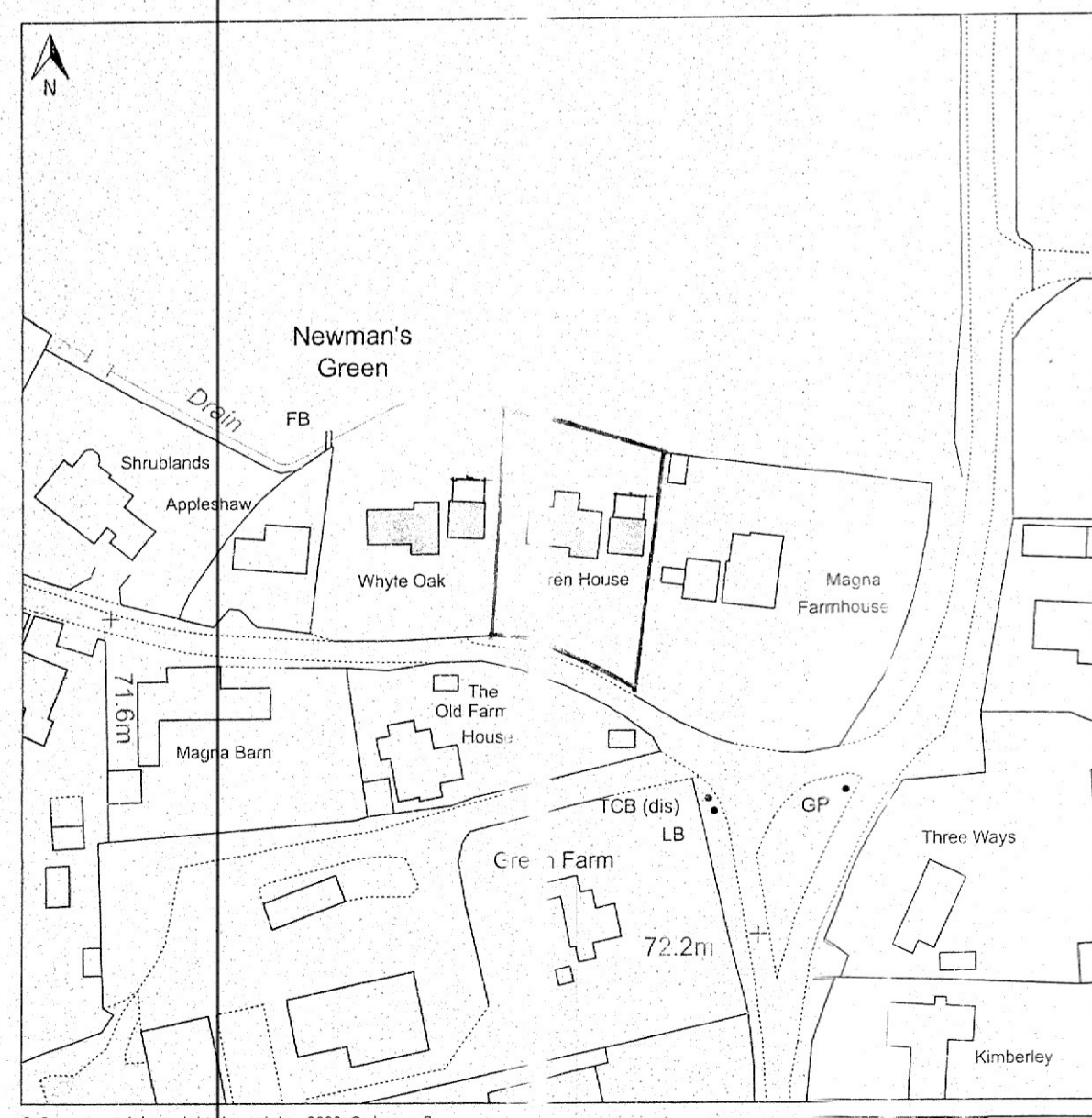

Scale: 1:1250 Paper Size: A4

dean jay pearce architectural design & planning ltd 2 / 3 Milestone, Hall Street, Long Melford Sudbury, Suffolk, CO10 9HZ T: 01787-378797 E: dean.pearce@ljw.co.uk		
Project: PROPOSED TWO-STORY REAR EXTENSION TO EXISTING DWELLING		
Site Address: WREN HOUSE, MILLS LANE, NEWMANS GREEN, ACTON, SUFFOLK, CO10 0AB		
Applicant: Mr & Mrs Dew		
Drawing title: EXISTING / PROPOSED SITE PLAN		
scales: 1: 200 (A1)	drg no:	rev:
date: 02 / 2024	24 / 12 / 01	
drawn:		
checked:		
<small>Do not scale this drawing. Use figured dimensions only. Contractor to set out all of the works prior to commencement and report any omissions / discrepancies immediately. Scales shown on this drawing are at A1 sheet size.</small>		
<small>This drawing & information are Copyright. ©</small>		