

NOTES:
 COPYRIGHT RETAINED BY AGENT
 THIS DRAWING MUST NOT BE SCALED
 ALL DIMENSIONS TO BE CHECKED ON SITE BY
 CONTRACTOR PRIOR TO COMMENCING WORK OR
 ORDERING ANY MATERIALS.
 ANY DISCREPANCIES TO BE NOTIFIED IMMEDIATELY.

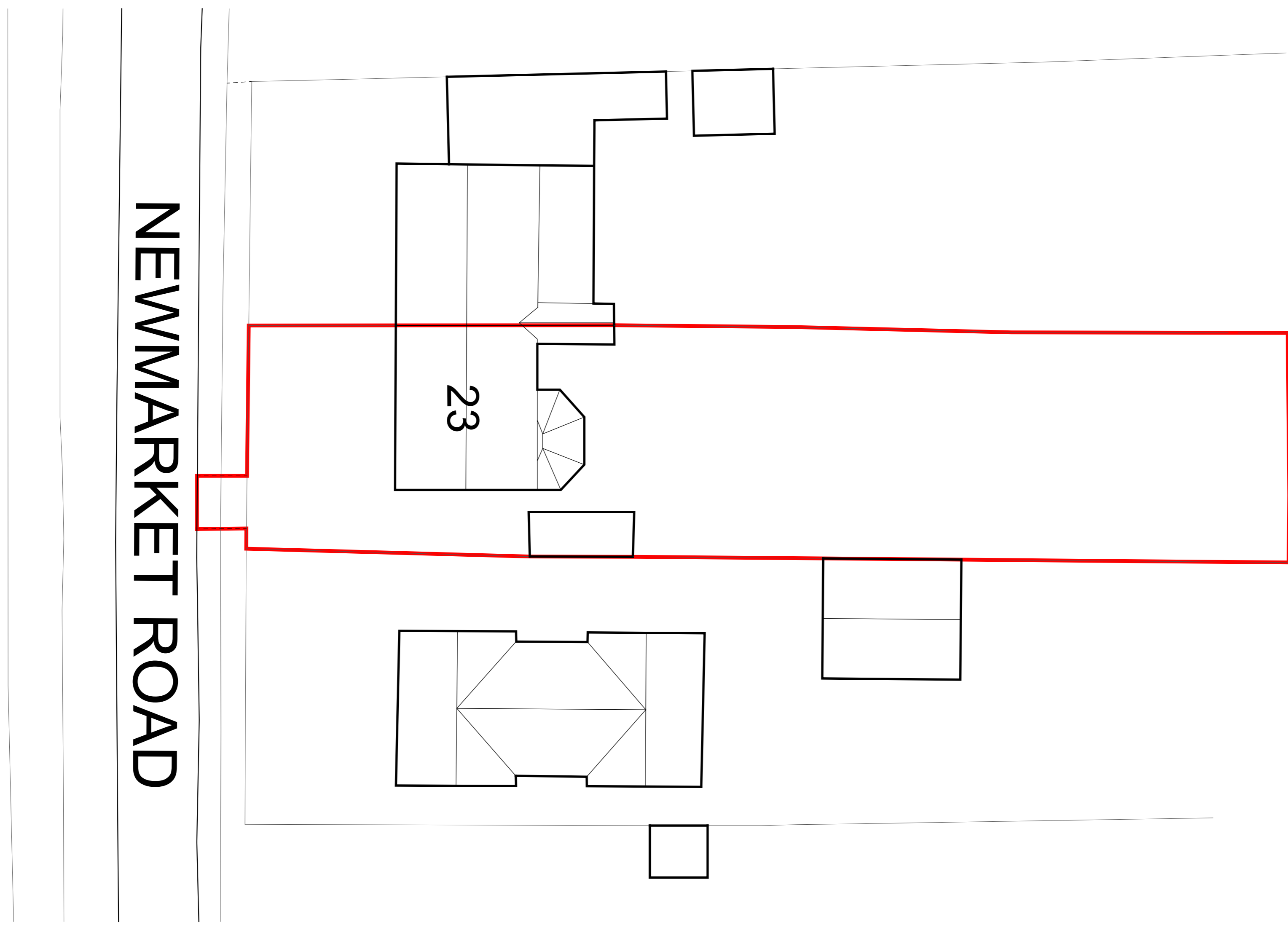

E x i s t i n g B l o c k P l a n

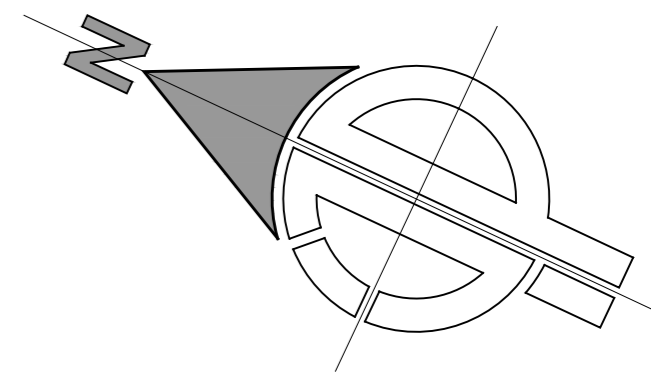
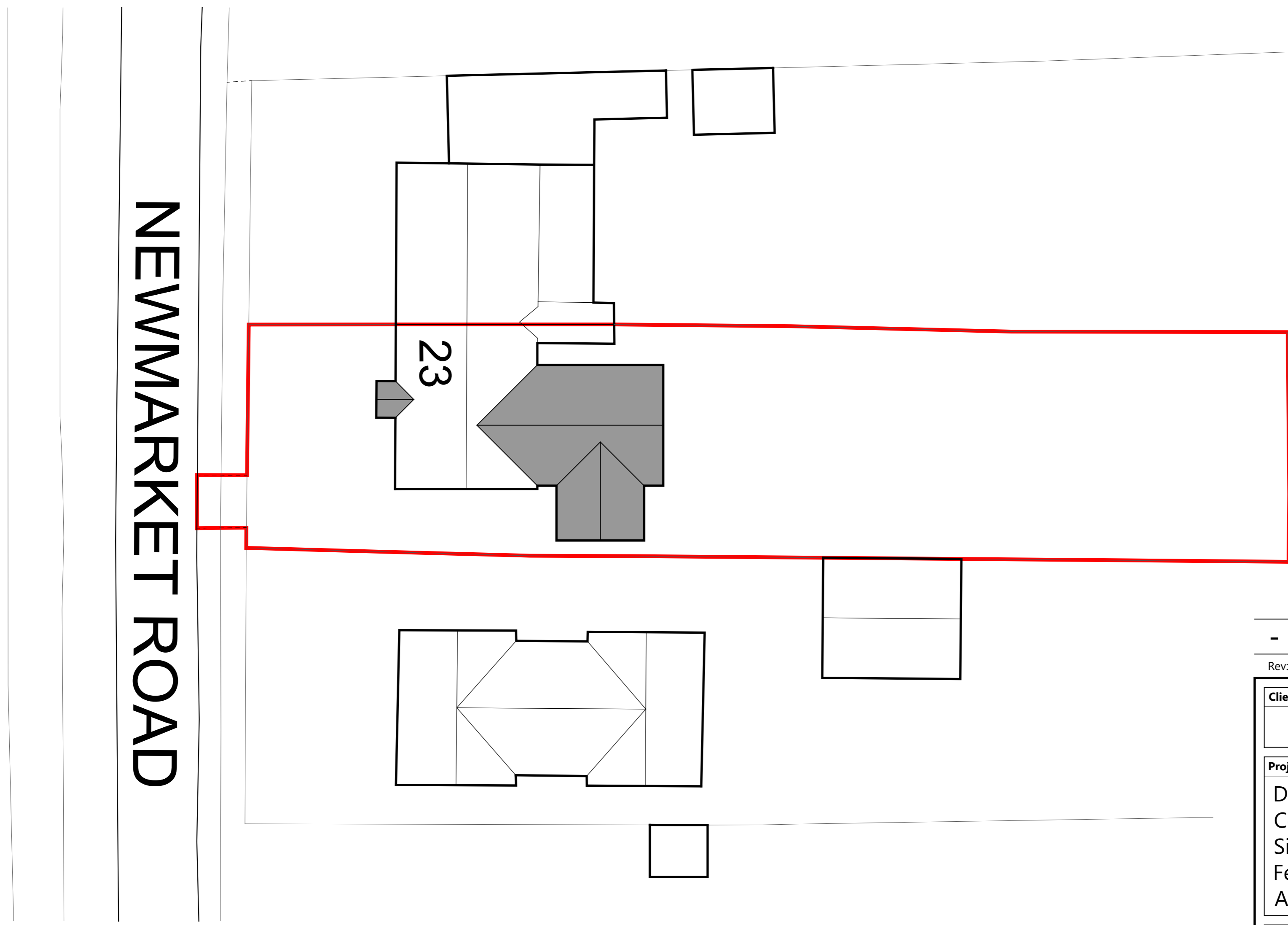

P r o p o s e d B l o c k P l a n

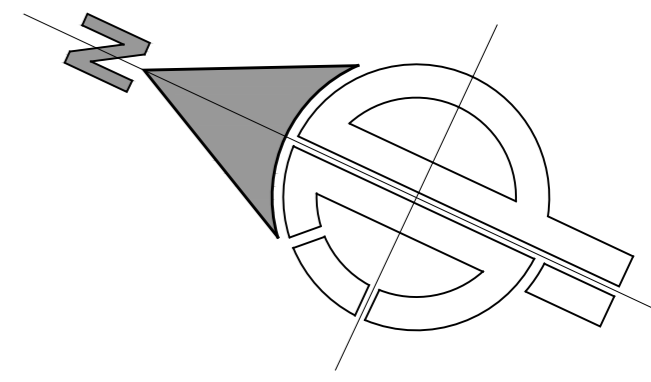

-	PLANNING PORTAL SUBMISSION	29.02.2024
Rev:	Notes:	Date:

Client:
 Mr. & Mrs. G. Cobb

Project Reference:
 Demolition of Existing Garage & Conservatory allowing Erection of Single Storey Rear & Side Extensions, Fenestration and Internal Additions & Alterations & New Front Porch.

Drawing Number: JP-2023-042-3 **Rev.:** -

Drawing Name:
 Existing & Proposed Block Plans

Address:
 23 Newmarket Road,
 Moulton,
 Suffolk,
 CB8 8QP.

	Jamie Palmer Architectural Design Services Ltd 131a Brook Street, Soham, Cambridgeshire, CB7 5AE e-mail: jamie.palmer@jp-ads.co.uk mobile: 0777 111 1979	Scale: 1:200
		Paper Size: A1

1:2500	0	25m	50m	100m	200m
1:1250	0	12.5m	25m	50m	100m
1:500	0	5m	10m	20m	40m
1:200	0	2m	4m	8m	12m
1:100	0	1m	2m	4m	8m
1:50	0	0.5m	1m	2m	4m
1:20	0	0.2m	0.4m	0.8m	1.6m
1:10	0	0.1m	0.2m	0.4m	0.8m